

One software  
for IOS and Android  
APP installation instructions:

- 1 IOS: Search for the 《LotusLamp X》 app in the Apple Store.
- 2 Android: Search for LotusLamp X' in 'Google'

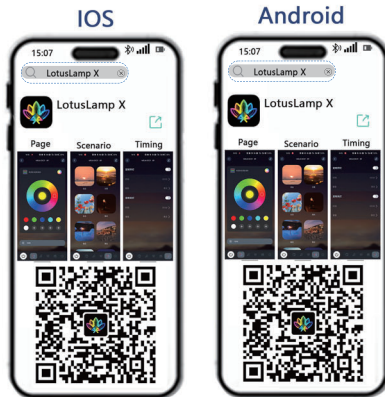

Scan the QR code to download the free LotusLamp X app.

- 1 Off
- 2 Circulation mode
- 3 On
- 4 Brightness-
- 5 Brightness+
- 6 Static Mode
- 7 Mode+/-
- 8 Music sensitivity adjustment+/-
- 9 Velocity+/-
- 10 Timer function
- 11 Music Mode Adjustment

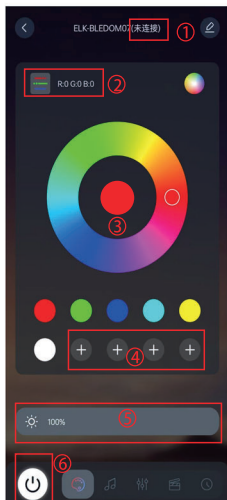
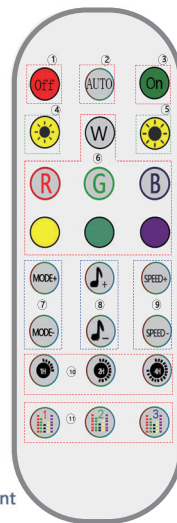

1. Device connection state, including unconnected/ empty (representing connected)
2. Color tray, used to change the device color.
3. RGB color value, click can set the RGB color value to more accurately select the color.
4. Customize the color to save your favorite color. After selection, slide the color plate above, long press can be deleted.
5. Brightness adjustment, sliding can set the brightness of the device.
6. Switch, used for turning the lights on/ off.

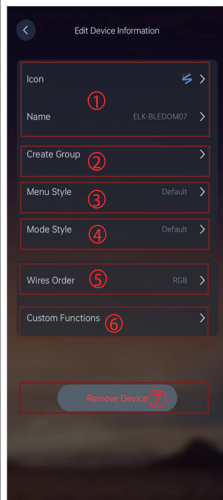

1. Modify the device icon and name
2. Create groups, a similar type of devices support creating groups, you can control multiple devices simultaneously.
3. Menu style, you can modify the page style.
4. Mode style, you can modify the mode you like. Line order can be corrected when the device color is not consistent with the setting color.
5. Custom functions, you can adjust the use of buttons according to your own habits.
6. Remove the device and remove the device from my device list.

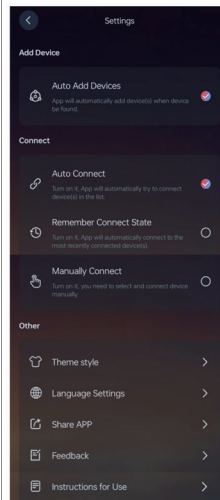

1. Automatically add devices. After checking the theme off, the APP will automatically search for nearby devices and add them to my device list.
2. linkage: Automatic connection: After checking, it will automatically connect to my device list. Memory connection: When checked, the most recently connected device is automatically connected. Manual connection: after checking, you need to manually click on the corresponding device to connect.
3. other: Change the background: you can customize the APP background map. Multi-lingual: you can switch to the APP language and follow the mobile phone system by default. Share the APP: Download the QR code for the same series of APP. Problem feedback: Problems can be feedback by email. About: APP version introduction.

**FCC Warning:**

This equipment has been tested and found to comply with the limits for a Class B digital device, pursuant to part 15 of the FCC Rules. These limits are designed to provide reasonable protection against harmful interference in a residential installation. This equipment generates, uses and can radiate radio frequency energy and, if not installed and used in accordance with the instructions, may cause harmful interference to radio communications. However, there is no guarantee that interference will not occur in a particular installation. If this equipment does cause harmful interference to radio or television reception, which can be determined by turning the equipment off and on, the user is encouraged to try to correct the interference by one or more of the following measures:

- Reorient or relocate the receiving antenna.
- Increase the separation between the equipment and receiver.
- Connect the equipment into an outlet on a circuit different from that to which the receiver is connected.
- Consult the dealer or an experienced radio/TV technician for help.

**Caution:** Any changes or modifications to this device not explicitly approved by manufacturer could void your authority to operate this equipment.

This device complies with part 15 of the FCC Rules. Operation is subject to the following two conditions:

(1) This device may not cause harmful interference, and (2) this device must accept any interference received, including interference that may cause undesired operation.

This equipment complies with FCC radiation exposure limits set forth for an uncontrolled environment. This equipment should be installed and operated with minimum distance 0cm between the radiator and your body.