

# TR11

2.4G

## Remote-Controlled Boat Manual

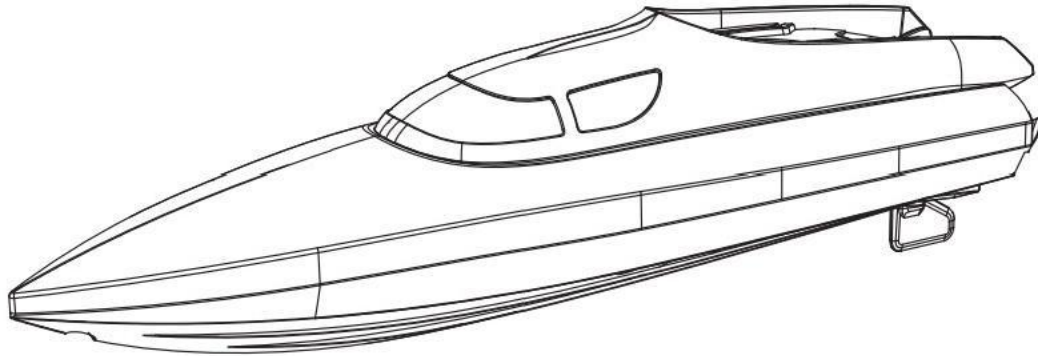

### NOTIFICATION BEFORE OPERATION:

1. Turn on the remote controller, put the boat in the water (the boat will automatically power on); it will automatically be paired.
2. Remote control distance is 50 meters. Please keep it within the effective distance to avoid loss of control.
3. Over-distance warning: The remote control will keep beeping when the boat is running out of control range.
4. The boat can run for about 25 minutes with fully a charged battery. Please bring it back before it runs out of power.
5. Low-power warning: When the model is in the lower power, the remote controller will make alarm sounds. Please get the boat back immediately; otherwise you may lose it.
6. The boat does not have function of self-righting; please don't flip it or crash into obstacles during operation.
7. Please avoid aquatic plants which may get entangled with the propeller.
8. The rudder direction must be adjusted manually.

**PLEASE KEEP MANUAL FOR REFERENCE**

### RC boat main structure diagram

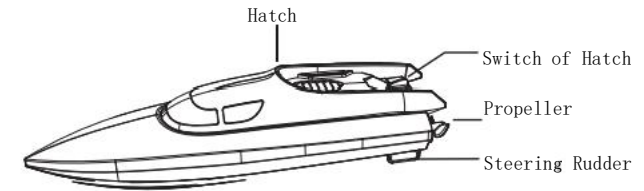

### Remote control functions

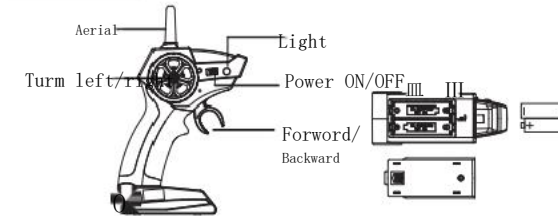

Inserting controller batteries: remove the battery cover and insert 2 "AA" alkaline batteries. Making sure batteries are put to the polarity (AA batteries are not included).

### Charging the model battery

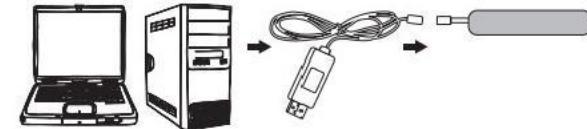

Time to charge is about 60-90 minutes. The red indicator goes out when it is under charging and turns on when charging is finished.

### BATTERY SAFETY INFORMATION

1. Install the battery with the correct polarity.
2. Don't mix old and new batteries.
3. Don't mix batteries.
4. DO NOT charge batteries that can not be charged.
5. Rechargeable batteries must be charged under adult supervision.
6. The power terminal must not be short circuited.
7. DO NOT connect more power than recommended.
8. USB cable can only be used with the manufacturer to recharge the supply, USB is not the model.
9. Remove discharged batteries from toys.

## Inserting battery into the boat

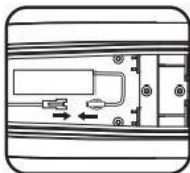

Put the battery in the boat; then mount the battery holder. Please make sure to insert the battery the right way round.

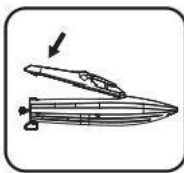

Tilt the cabin cover to the hull at a slight angle, push it forward, and fasten the lock key.



Note: To prevent water leak, the cabin cover is rather tight; please remove or cover it with a proper way.

## PAIRING BOAT WITH TRANSMITTER

1. Turn the remote control, the remote control LED indicator will be flashing; then put the boat in the water, the remote control LED indicator will turn constant, which means the boat is paired successfully.

2. If the remote and the boat is not paired successfully, the LED indicator of the remote control will keep flashing.

Note: the boat will automatically power on when it is in water, and the lights on the boat will turn on automatically. When the boat gets out of water, the boat will turn off automatically.

## Functions

Forward

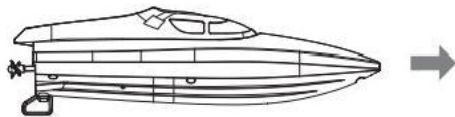

Backward

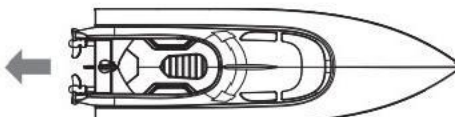

Turn right

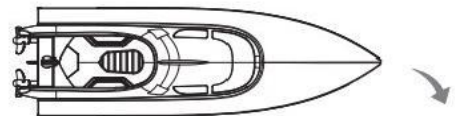

Turn left

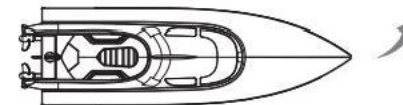

Rudder: Adjust this to control the boat's direction. When sailing straight, manually adjust to the right if drifting left, and adjust to the left if drifting right.

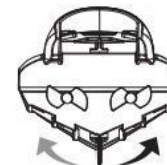

## Maintenance

1. If the boat is not being used, remove the battery.
2. The surface of the boat should be protected from prolonged exposure to the sun to prevent paint peeling. When the boat is finished, it should be wiped down with a dry cloth.
3. If the remote will not be used for a long time, make sure to turn it off and remove the batteries.

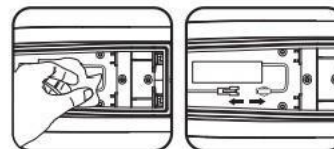

**NB:** After play, use the dry cloth blot up the moisture inside the cabin. And add some desiccant, to ensure that the hull is dry.

## Light Mode

This rc boat has 4 light modes.

When the boat is in the water and successfully paired with the remote controller, the lights on the boat will constantly light on.

1. Short press the Light button, the lights will start to flashing quickly.
2. Short press the Light button again, the lights will be flashing slowly.
3. Short press the Light button 3 times, the lights will quickly flashing twice continually.
4. Short press again, the lights will be turn off.

## NOTICE&WARNNG

### FCC Notice:

This device complies with Part 15 of the FCC Rules.

Operation is subject to the following two conditions:

- (1)This device may not cause harmful interference,and
- (2)This device must accept any interference received,including interference that may cause undesired operation.

NOTE:This equipment has been tested and found to comply with the limits for a Class B digital device,pursuant to Part 15 of the FCC Rules.These limits are designed to provide reasonable protection against harmful interference in a residential installation.This equipment generates uses and can radiate radio frequency energy and,if not installed and used in accordance with the instructions,may cause harmful interference to radio communications.However,there is no guarantee that interference will not occur in a particular installation.If this equipment does cause harmful interference to radio or television reception,which can be determined by turning the equipment off and on,the user is encouraged to try to correct the interference by one or more of the following measures:

- Reorient or relocate the receiving antenna.
- Increase the distance between the equipment and receiver.
- Connect the equipment into an outlet on a circuit different from that to which the receiver is connected.
- Consult the dealer or an experienced radio/TV technician for help.

WARNING:Changes or modifications not expressly approved by the party responsible for compliance could void the user's authority to operate the equipment.

### RFExposure

The device has been evaluated to meet general RF exposure requirement. The device can be used in portable exposure condition without restriction.

## Warning

- 1.This product only used for age over 6 years od,children play must be under adults supervision.
- 2.Wait for the battery to cool before recharging when boat is finished.
- 3.When sailing,make sure no one is in the water to avoid injury.There must be no weeds or debris on the surface of the water to prevent the propeller from being entangled or damaged.
- 4.Remote control distance is about 50 meters.Please do not exceed the effective control distance in case the boat is out of control.
- 5.The product contains small parts,please do not swallow parts to avoid suffocation risk.
- 6.Please keep a safe distance from the high-speed rotating propeller to avoid the risk of strangulation.

## Specification

Operating Time:~25 minutes

Running Speed:15K M/Hour

Dimensions:25X7X7cm

Battery Type:3.7V800mAh Li-po Battery

Charging Time:90 minutes

Max Control Distance:50 meter

Battery for Remote Control:1.5V AA Battery Operating Temperature:32°

to 104°F<0°to 40°C>

## Warranty

- 1.All Product carries a 100%satisfaction guarantee.
- 2.Stay up-to-date on what'new from TOLLCY.
- 3.All the products are covered by unconditional lifetime warranty when you complete the registration process by scanning the code



Customer Service: [tollcytech@outlook.com](mailto:tollcytech@outlook.com)

Manufacturer: SHANTOU HANNUOWEI ELECTRONIC TECHNOLOGY CO.,LTD.  
Address:NO.10,LANE 5,GUANSHAN SHUZAI GARDEN,CHENGHUA STREET,  
CHENGHAI DISTRICT,SHANTOU CITY,GUANGDONG,CHINA.  
FCC ID:QV7-GC88752-33



**Made in China**

