



Power on/off

Power on - Press and hold the button for 3 seconds until  LED lights flash and a beep is heard.

Power off - Press button repeatedly until the card displays , press and hold for 3 seconds until  flash, release then press and hold the button again for 3 seconds.

LED Display in Sequence



Scan me for App



www.mycard.love

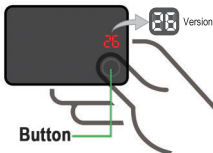

Reset to Factory

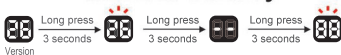

Permission Authorization

Make sure your phone can access to the Internet and grant the necessary permissions as shown in the image below.

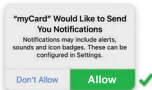
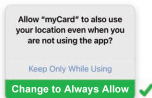
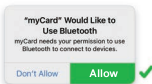
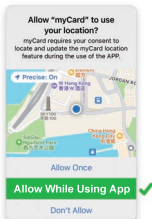

Notes: iOS 12.0 or later | Android 8.0 or later

Card Activation

Please confirm the card is powered on first.

1

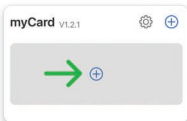

2



Searching for new myCard...

I have a share code

4

- Connected to myCard s...
- SN retrieved successfully
- Hardware version retrie...
- Verification service ready

3

myCard



Enter device name



Device password (6 digits)

I have a share code

Continue

5

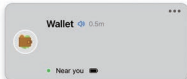

Menu Function List

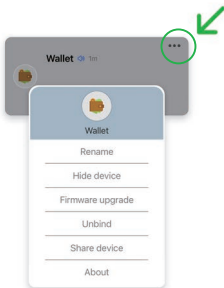

Rename - Modify the name of a card.

Hide device - The card will not appear in the main interface, find it in the settings menu.

Firmware upgrade - Update the firmware via Bluetooth.

Unbind - Clear card data and reset.

Share device - Share the card with up to three people.

About - Card activation date and serial number.

Map Interface instructions

Remote locating uses crowdsourced network technology. The more phones around the device, the faster the location updates.

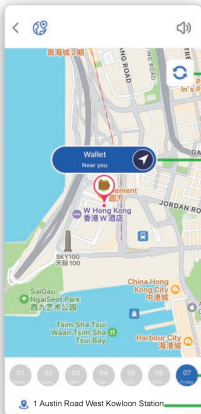

Refresh Location

Navigation

Historical data

Detailed address

* Turning off your phone's Bluetooth will not affect remote tracking.

Find nearby

This function only works when the card is within the phone's Bluetooth range.

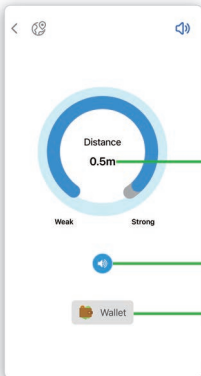

Approx. distance

Play sound

Selected card

* The working range of nearby search is often less than 15 meters (depending on the actual environment).

Ways to add a card

Click the "+" symbol to add a card in the top right corner of the main interface.

After getting a share code, tap "🔄" and enter the code to add the card.

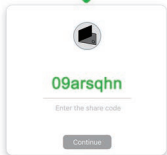
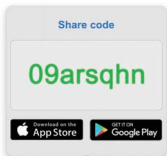
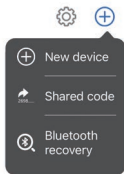

🔍 Restore activated cards after reinstalling the app or switching to a new phone.

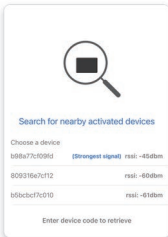

FAQ

1. App Installation Issues

Some phone protection modes (Huawei Pure Mode, Xiaomi Security Mode) may block the installation process. Please disable these modes and try again.

2. Failed to Add Card

Ensure Bluetooth is enabled and the card is powered on. If activation fails, check your network connection.

3. No Location Data

Check if the card is powered on. If it is, try moving to a more crowded area for better signal detection.

4. Retrieve Card After Changing Phones

Use the "+" Bluetooth recovery feature in the app to retrieve your card.

5. Location Offset

The device uses a crowdsourced network, not GPS. Location offsets may occur due to indoor environments or high-speed movement. Please check historical location data for more accurate results.

6. No Response in Nearby Search

Ensure Bluetooth permissions are enabled and the device is powered on. A gray beeping icon indicates the device is out of range. If the battery is low, only location tracking may be available, playing sound will not work.

FCC Warning:

This equipment has been tested and found to comply with the limits for a Class B digital device, pursuant to part 15 of the FCC Rules. These limits are designed to provide reasonable protection against harmful interference in a residential installation. This equipment generates, uses and can radiate radio frequency energy and, if not installed and used in accordance with the instructions, may cause harmful interference to radio communications. However, there is no guarantee that interference will not occur in a particular installation. If this equipment does cause harmful interference to radio or television reception, which can be determined by turning the equipment off and on, the user is encouraged to try to correct the interference by one or more of the following measures:

- Reorient or relocate the receiving antenna.
- Increase the separation between the equipment and receiver.
- Connect the equipment into an outlet on a circuit different from that to which the receiver is connected.
- Consult the dealer or an experienced radio/TV technician for help.

Caution: Any changes or modifications to this device not explicitly approved by manufacturer could void your authority to operate this equipment.

This device complies with part 15 of the FCC Rules. Operation is subject to the following two conditions:

(1) This device may not cause harmful interference, and (2) this device must accept any interference received, including interference that may cause undesired operation.

This equipment complies with FCC radiation exposure limits set forth for an uncontrolled environment. This equipment should be installed and operated with minimum distance 0cm between the radiator and your body.