

EN

User Manual

(English/Italiano/Deutsch/Français/Español)



Dear customers,

Thank you for choosing our mini camera. This user manual is intended to provide you with basic operating instructions. Please read the manual carefully before use. If you have any questions, please feel free to contact us. We provide replacement and warranty for this equipment.

ISED Caution.English:This device contains licence-exempt transmitter(s)/receiver(s) that comply withInnovation, Science and Economic DevelopmentCanada's licence-exempt RSS(s). Operation is subject to the following two conditions:1.This device may not cause interference.2.This device must accept any interference, including interference that may cause undesired operation of the device.This equipment should be installed and operated with minimum distance 20cm between the radiator & your body.French:Cet appareil contient des émetteurs/récepteurs exemptés de licence qui sont conformes aux RSS exemptés de licence d'innovation, sciences et développement économique Canada. Le fonctionnement est soumis aux deux conditions suivantes:1. Cet appareil ne peut pas causer d'interférences.2.Cet appareil doit accepter toute interférence, y compris les interférences qui peuvent causer un fonctionnement indésirable de l'appareil.Cet équipement doit être installé et utilisé à une distance minimale de 20 cm entre le radiateur et votre corps.

Contents

I . Appearance and Buttons.....	1
II . Basic Operations.....	2
III . Watch How It Works.....	3
III . Install App.....	3
IV . Add device to phone & Configure WiFi & Multiple Storage.....	4
V . Share the Device with More Users.....	10
VI . Motion detection alarm setting.....	11
VII . App browsing details.....	12
VIII . Package contents.....	14
IX . QA&Warning.....	14

I . Appearance and Buttons

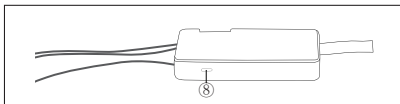
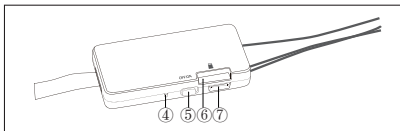
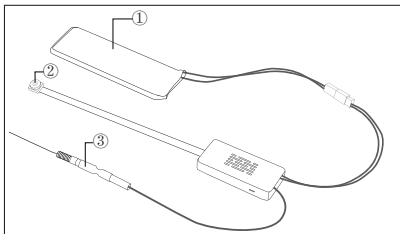

- ①-Battery
- ②-Camera lens
- ③-Antenna
- ④-Reset hole

- ⑤-Power on/off
- ⑥-Micro SD card slot
- ⑦-USB port
- ⑧-Indicator light

II . Basic operations

2.1 Power on:

Press the ON/OFF button to turn on the device, the green and blue light on for 15s, and then the green light on. The camera enters standby mode.

2.2 Power off:

Press the ON/OFF button to turn off the camera, and the indicator light off.

2.3 Reset/factory settings:

Under “power on” status, use the provided pin to press the “reset” button for 5-10 seconds. Then, the camera restarts and go back to the factory state. The reset process takes about 15 seconds. After a successful reset, the blue and green light flash together quickly.

2.4 Charging:

Use USB cable (included) to connect to power supply (DC 5V and below). After fully charged, the camera support 5-7 hour standby time. The camera takes about 4 hours to fully charge. After connecting the phone, you can check the battery capacity on the App.

2.5 Micro SD Card Installation:

Please power off the camera before install or remove the SD card. Under “power off” status, find the SD card port, insert the SD card (chip-side downwards) into the card slot.

Press the card lightly with your fingernail until it clicks into place. To remove the card, press it lightly with your fingernail.

III. Watch How It Works

Use your phone camera to scan the QR code to watch the video Please refer to the video.



III. Install app

Download the app:

- scanning below QR Code.
- Search for the app "HDLivecam" in IOS store and google play.

International version



IOS App store :HDLivecam
Google play

The APP may be updated at any time, there will be a reminder after entering the APP, just click update.

Allow access permissions for apps

Whether you're using an Android or iPhone, you must allow permissions when an app uses your smartphone's functions.

(*The display will differ depending on the OS of your device.)

- ① Before use, please allow access for the app on this unit.
- ② Before use, please turn on location information for the app on this unit.

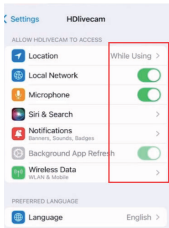
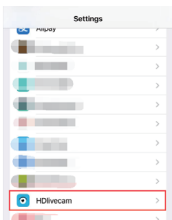

IV. Add device to phone&Configure WiFi&Multiple Storage

Add device to phone:

4.1 Power on the camera,the green and blue indicator lights will stay on for 15 seconds, and then the green indicator will stay on. The camera enters standby mode.

4.2 Open the APP, then register. (refer to image-1)

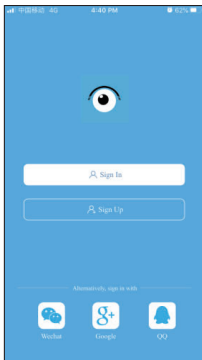

image-1

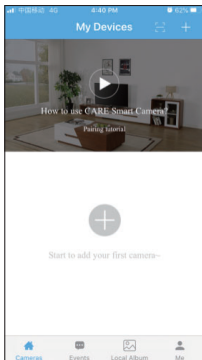

image-2

4.3 Open APP “HDlivecam” and click “+” (refer to image-2)

4.4 Click "Add by AP Hotspot" (refer to image-3、4、5)

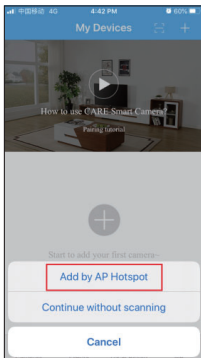

image-3

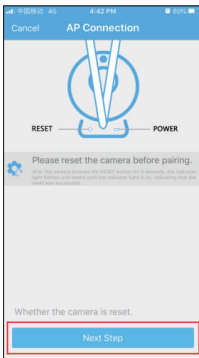

image-4



image-5

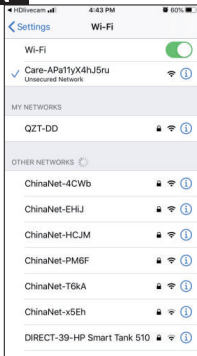

image-6

4.5 Open the “wifi” of your phone, search the camera’s “hotspot” and click connect
 .Camera hotspot name: Care-AP****(refer to image-6).

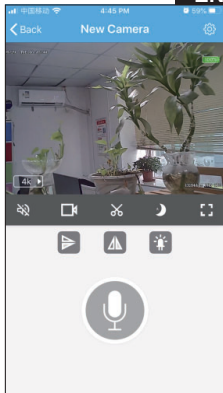

image-7

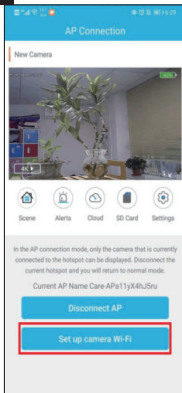

image-8

4.6 Open the APP, you will see the camera is added successfully. Then, you can watch the live video in the app.(refer to image-7)

Note:During the connection process, please ensure the distance between the camera antenna and the battery, do not entangle it, and keep a certain distance from the mobile phone. Otherwise, the signal may be interrupted.

Configure WiFi:

4.7 When you see "online" in the app (refer to image-7)(Note: only wifi config successfully, you can remote control the camera),Click "Back".Then click "Set up camera Wi-Fi" (refer to image-8), and then you will see a WIFI list in the APP.

4.8 Select your WIFI and enter the password. (refer to image-9,10) At this time, the camera indicator light will stay on blue.

If wifi config failed, please reset the camera,repeat Steps"4.3&4.4&4.5"

Note: After the first Wi-Fi configuration is completed, you may need to wait 2-5 minutes to see the camera again! The better the network signal, the shorter the waiting time.(The machine needs time to configure only when it is used for the first time.)

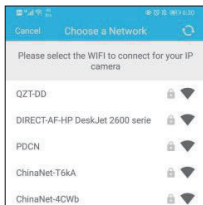

image-9

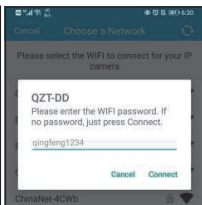

image-10

4.9 You can name the camera , swipe down to refresh the APP , and you can watch the video after the camera configuration is completed.

Multiple Storage:

1. Local Storage:

Without inserting an SD card, once you record the video/pictures, they will be save to the local of your phone.

2. SD Card Storage:

After inserting the SD card, the camera will start recording immediately, once the videos/pictures are recorded, they will be saved in the SD card storage in a circular format. When the storage space is full, the new files will overwrite the old files. Files recorded on SD card can be viewed & played back by APP.

Note: The recording time will syconixed with the local current time only after the camera configure wifi successfully.

3. Cloud Storage:

This devcie support cloud storage, but the cloud storage is payable. (we do not offer free cloud storage)

V. Share the device with more users

After successfully configuring Wi-Fi, the camera's hotspot will disappear, and no one can connect to the camera except you. You can click the "Share" button to share with your family (refer to image-11,12,13).

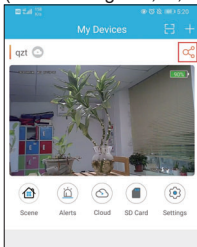

image-11

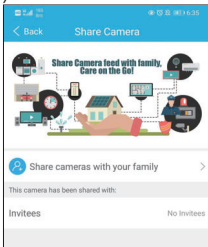

image-12

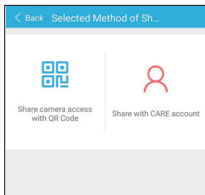

image-13

VI. Motion detection alarm setting

6.1 Click the settings button (refer to image-14)

6.2 Click "alert settings"(refer to image-15) and turn on "motion detection".

6.3 Can be set the Sensitivity & Alert Time & Alert Frequency in the APP

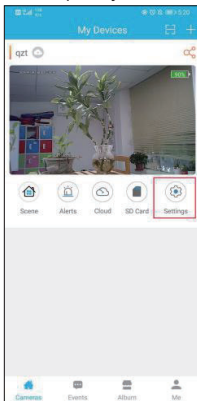

image 14

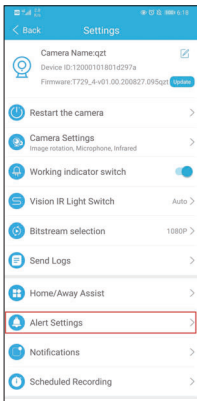
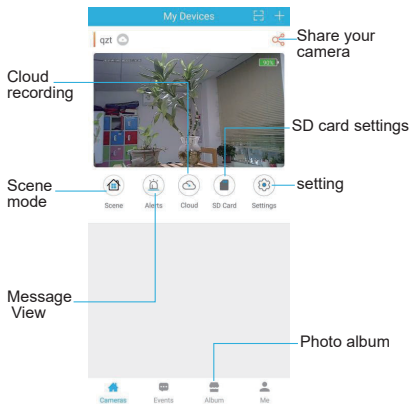
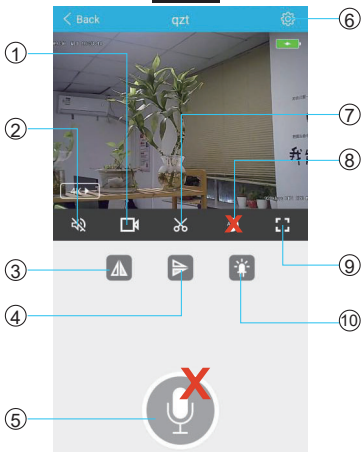

image 15

VII. App browsing details





- | | |
|--|--|
| ① Start recording | ⑥ setting |
| ② speaker | ⑦ Screenshot |
| ③ vertical image | ⑧ Note: This version of the camera has no night vision |
| ④ horizontal image | ⑨ screen zoom in/out |
| ⑤ Note: This version of the camera has no two-way talk function. | ⑩ Turn on/off indicator |

IX. QA&Warning

QA:

1. **Q: Why is there a "ka~ka~" sound when I open the APP to watch the video?**

A: When the battery is low, there will be a slight noise when watching videos, please charge it in time.

2. **Q: Why can't my phone search for hotspots after I reset it several times? what should I do?**

A: Please turn off the device and turn on it again, then use the provided pin to reset the camera, and repeat the steps of "add the device to phone&configure wifi"

3. **Q: Why can't I see my camera in the APP after connecting to WiFi successfully?**

A: The machine needs time to configure when it is first used (about 2-5 minutes). Please wait a few minutes to wait the camera refresh and back to "online".

4. **Q: I inserted a micro SD card while recording, and clicked the recording button in the APP. When I checked the content in the micro SD card, I found that it was garbled.**

A: When inserting or removing the SD card, please turn off the camera. Otherwise, it will cause SD card format error. Correct operation: Please turn off the camera before install or remove the SD card, turn on the camera after install or remove the sd card.

5. Q: I turn on the motion detection alarm function, but why the APP not send me a notification?

A: Please open the mobile phone pop-up window permission to prevent the APP from being disabled or forcibly closed by the mobile phone system in the background.

6. Q: I turned on the mobile phone patrol alarm function, why didn't the APP send a notification?

A: Because the mobile phone has data protection and access danger functions turned on, the user needs to set permissions on the application

Warning:

1. This mini WiFi Camera only supports 2.4G WiFi, not 5G WiFi.
2. The camera lens is exposed and the wire is fragile, do not pull or bend it forcefully, or the lens will get damaged.
3. Before using the Micro SD card for the first time, please make sure to format the memory card. Support max 128GB, FAT32, no less than Class 10.
4. Do not use special symbols in the WiFi password.
5. Please use the power supply (DC 5V and below) when charging, so as not to damage the product battery.
6. When charging the battery, please connect the battery and the camera to the power supply, and turn on the camera so that the battery can get charged.
7. When the video saved to the micro SD card cannot be opened, please try another player (for example: VLC media player).
8. Do not place this product in a humid or high temperature environment.

FCC Warning

This device complies with part 15 of the FCC rules. Operation is subject to the following two conditions: (1) this device may not cause harmful interference, and (2) this device must accept any interference received, including interference that may cause undesired operation.

Changes or modifications not expressly approved by the party responsible for compliance could void the user's authority to operate the equipment.

NOTE: This equipment has been tested and found to comply with the limits for a Class B digital device, pursuant to part 15 of the FCC Rules. These limits are designed to provide reasonable protection against harmful interference in a residential installation. This equipment generates uses and can radiate radio frequency energy and, if not installed and used in accordance with the instructions, may cause harmful interference to radio communications. However, there is no guarantee that interference will not occur in a particular installation. If this equipment does cause harmful interference to radio or television reception, which can be determined by turning the equipment off and on, the user is encouraged to try to correct the interference by one or more of the following measures:

-Reorient or relocate the receiving antenna.

- Increase the separation between the equipment and receiver.

- Connect the equipment into an outlet on a circuit different from that to which the receiver is connected.

- Consult the dealer or an experienced radio/TV technician for help.

Radiation Exposure Statement

This equipment complies with FCC radiation exposure limits set forth for an uncontrolled environment. This equipment should be installed and operated with minimum distance 20cm between the radiator and your body.