

**COOLCRAZY**



## **N8 USER MANUAL**

**⚠** Please note that this product may update without prior notice.

If you have any question while using this product, please contact us: [support@coolcrazycam.com](mailto:support@coolcrazycam.com)

## N8 CONTENT

Linking Process .....	1
Important Notes .....	4
N8 Appearance .....	6
N8 Boot Instructions .....	7
What's in the Box .....	9
N8 Accessoires .....	10
N8 Home Page Status Description .....	11
N8 Setting Interface Description .....	12
N8 Playback Interface .....	13
N8 Installation Guidance .....	19
Introduction to APP Connection .....	20
Dash Cam Hardwire Kit Installation Guide .....	24
N8 Customer Service .....	33

## Linking Process

1, **Android:** Use a browser with QR code scanning function on Android phones(Recommended: Edge, Opera) to scan the QR code and download "Viidure" **while allowing all permissions.**

**IOS:** use the built-in camera on iPhones to scan the QR code, and click the yellow button that pops up below the QR code in the camera interface to download it from the Apple App Store.



2, Viidure app, you can also search and download it by searching for "Viidure" in the Android store or Apple App store **(allow all permissions).**

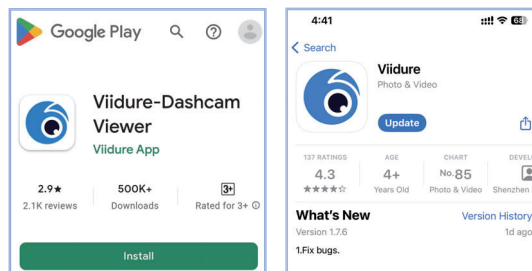

Android (Google play)

IOS (App Store)

3, click the + sign in the upper right corner of the APP homepage, then select next step to link WIFI.

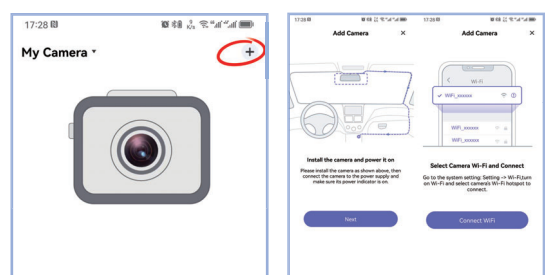

4, Turn on the dash cam, go to settings and enable the Wi-Fi hotspot. On your phone, click to connect to the hotspot signal starting with "N8- \*\*\*\*\*". When a prompt appears stating that the WLAN cannot access the internet, click "Use." After connecting to the hotspot, return to the app's homepage to complete the app connection.

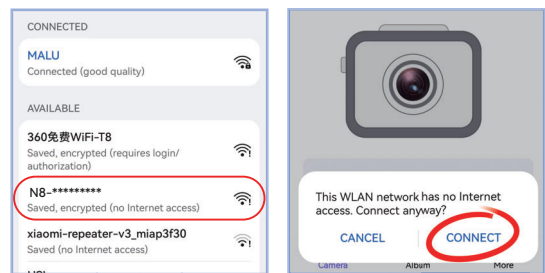



N8 Connect To  
Wifi Operation Guide



N8 Dash Cam  
Installation Video



Hardwire Kit  
Installation Video

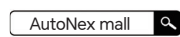

understand the latest updates

## Important Notes

Before installing the dash cam, please remove the protective film from the front and rear lenses, and apply the included static cling film to the car window.

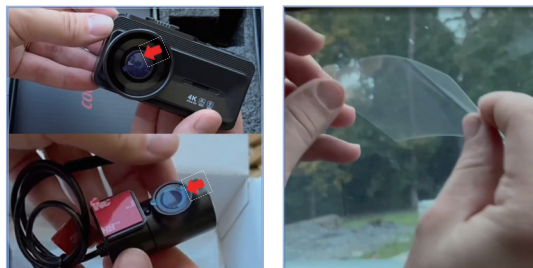

Hardwire Kit (Necessary for the parking monitoring function) (Not included in the package, please purchase separately if needed.)

Hardwire Kit Needed  
Extra Purchase

Asin: B0DHSBH9KS





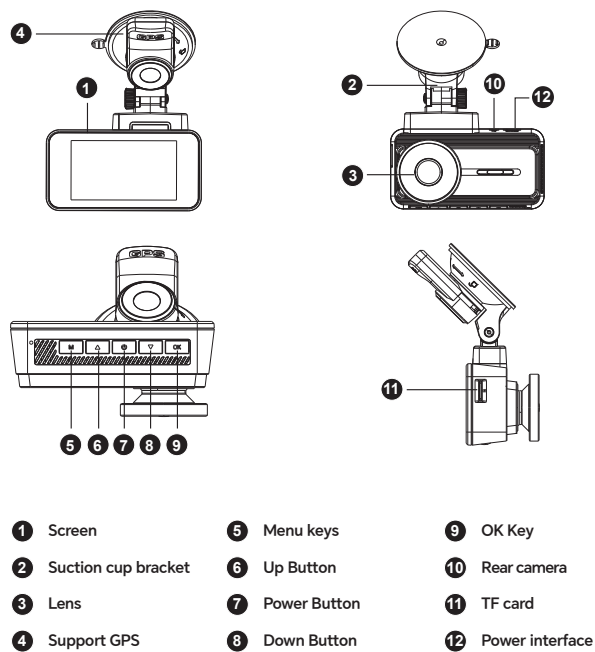

## Performance Parameter

Front image sensor	4K
Rear camera	1080P
Option Language	English/Chinese multiple languages
TF storage card slot	TF
Recording resolution	4K+1080P
Photo resolution	4K+1080P
Storage compression method	H.264
Video Format	MP4
Photo Format	JPG
Storage temperature	-30°C~80°C
Operating temperature	-20°C~65°C
Storage card capacit	Max support 256GB

## N8 Appearance



Button Functions	
Panel Buttons	Function Descriptions
	<ol style="list-style-type: none"> <li>1. In the preview interface, short press the M button to enter the main menu.</li> <li>2. In the main menu, short press the M button to return to the preview interface.</li> <li>3. In the menu settings/file browsing interface, short press the Menu button to return to the previous menu.</li> <li>4. In the preview interface, long press the M button to toggle the WiFi shortcut.</li> </ol>
	<ol style="list-style-type: none"> <li>1. In the preview interface, short press the Up button to enter the file browsing interface.</li> <li>2. In the main menu, short press the Up button to navigate upwards in the menu.</li> <li>3. In the menu settings, short press the Up button to select the previous menu option.</li> <li>4. In the file browsing interface, short press the Up button to select the previous video file.</li> <li>5. While paused during video playback, short press the Up button to switch to the previous video file.</li> <li>6. In the recording interface, short press the Up button to enter video playback.</li> </ol>
	<ol style="list-style-type: none"> <li>1. In the preview interface, short press the Power button to turn the screen on or off.</li> <li>2. While the device is powered on, long press the Power button for 3 seconds to power off the device.</li> <li>3. While the device is powered off, short press the Power button to power on the device.</li> <li>4. In the video playback interface, select a file, then press to delete the file.</li> </ol>

Panel Buttons	Function Descriptions
	<ol style="list-style-type: none"> <li>1. In the preview interface, short press the Down button to enter the file browsing interface.</li> <li>2. In the main menu, short press the Down button to navigate downwards in the menu.</li> <li>3. In the menu settings, short press the Down button to select the next menu option.</li> <li>4. In the file browsing interface, short press the Down button to select the next video file.</li> <li>5. While paused during video playback, short press the Down button to switch to the next video file.</li> <li>6. In the recording interface, short press the Down button to lock the current video.</li> </ol>
	<ol style="list-style-type: none"> <li>1. In the preview interface, short press the Confirm button to toggle between front recording, rear recording, and split-screen display.</li> <li>2. In the menu interface, short press the Confirm button to enter the menu settings.</li> <li>3. In the menu settings, short press the Confirm button to save the settings.</li> <li>4. In the file browsing interface, short press the Confirm button to play the selected video file.</li> <li>5. During video playback, short press the Confirm button to pause the playback.</li> <li>6. While paused during video playback, short press the Confirm button to resume playback.</li> </ol>

# What's in the box

<div>   </div> <div>N8 4K Dash Cam</div>		
<div></div> <div>3M Adhesive</div>	<div></div> <div>Type C Power Cable</div>	<div></div> <div>1080P Rear Camera</div>
<div></div> <div>Car Wire Trim Tool</div>	<div></div> <div>User Manual</div>	<div></div> <div>Dust Free Cloth</div>
<div></div> <div>Electrostatic Sticker</div>	<div></div> <div>Cable Clips</div>	<div></div> <div>TF</div>

## Power Accessories

### 1. Car Charger Cable



### 2. Hardwire Kit (Necessary for the parking monitoring function) (Not included in the package, please purchase separately if needed.)

Hardwire Kit Needed  
Extra Purchase

Asin: B0D2R817C3



## Home Page Status Descriptions

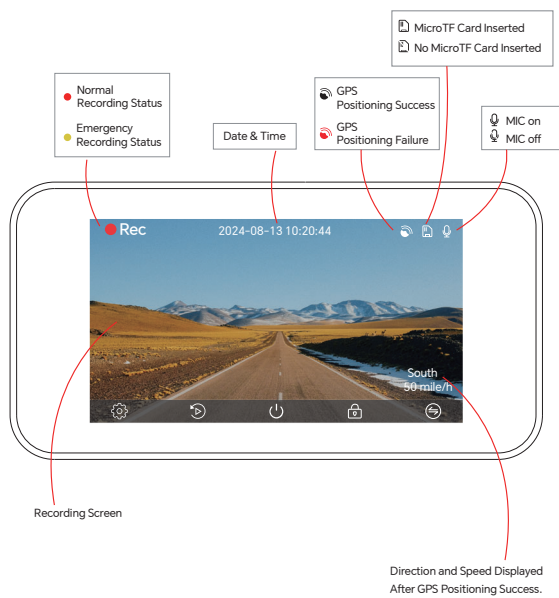

## Startup Guide



### Language Selection

Short press the Up/Down button to select your desired language. After selecting, short press the Confirm button to complete the language setup and automatically proceed to the next screen.



### Time Zone Selection

Short press the Up/Down button to select your desired time zone. After selecting, short press the Confirm button to complete the time zone setup and automatically proceed to the next screen.

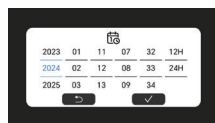

### Date & Time

Short press the Up/Down button to select your desired date and time. After selecting, short press the Confirm button to confirm. Once all data is selected, short press the Menu button to choose confirm or cancel, and then short press the Confirm button to proceed to the next screen.

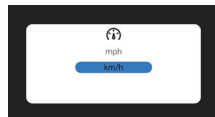

### Speed Unit

Short press the Up/Down button to select your desired speed unit. After selecting, short press the Confirm button to complete the startup guide.

\* If any setup errors are found after completing the startup guide, you can reconfigure the settings through the settings menu or restore the device to factory settings and redo the startup guide.

## Settings Interface Description

Short press the Menu Button on the side of the screen to enter the Setting Interface.

WiFi 1	OFF >
Resolution 2	2K >
Loop Recording 3	1Minute >
Sound Record 4	ON >
Light source frequency 5	60HZ >

### 1 WiFi

This feature allows you to use WiFi. Before using this function, please download the product app.



Universal QR code for Android/iPhone.  
After scanning the code on your Android phone, choose to open it with your browser and download it in your browser.  
After scanning the code on your Apple phone, you will be directly redirected to the Apple APP store, where you can download it.

After the APP download is complete, turn on the WiFi function on the dashcam. The WiFi name and password will be displayed at the bottom of the WiFi screen. Open the app, select "Connect to Dashcam," find the corresponding WiFi name, and enter the password to complete the connection. You can now view recorded videos and parameters on the app.

### 2 Resolution

This feature provides resolution options for the device, supporting 1080P, 2K, and 4K, with a default of 2K. Recording in 4K offers clearer videos but requires more memory. Choose according to your needs.

### 3 Loop Recording

This feature provides loop recording options, supporting 1 minute, 3 minutes, and 5 minutes, with a default of 1 minute. When 1-minute loop recording is selected, the device will automatically save recordings in 1-minute segments.

### 4 Audio Recording

This feature allows you to enable or disable the audio recording function, with the default setting enabled.

### 5 Light Frequency

This feature provides options for light frequency, supporting 50Hz and 60Hz.

Mirror Flip <b>6</b>	ON >
Rear cam Flip <b>7</b>	OFF >
Screen Saver <b>8</b>	OFF >
Volume Setting <b>9</b>	High >
G-sensor <b>10</b>	OFF >

#### **6 Rear Mirror Imaging**

This feature provides options for rear mirror imaging, allowing you to enable or disable the function, with the default setting enabled.

#### **7 Rear Mirror 180° Rotation**

This feature provides options for rear mirror 180° rotation, allowing you to enable or disable the function, with the default setting disabled.

#### **8 Screen Saver**

This feature provides screen saver options, allowing you to set the screen saver to off, 1 minute, 2 minutes, or 3 minutes, with the default setting off. When set to off, the screen will not turn off automatically. When set to 1 minute, the screen will turn off automatically after 1 minute of inactivity.

#### **9 Volume**

This feature provides volume options, allowing you to set the volume to off, low, medium, or high, with the default setting high.

#### **10 G-Sensor**

This feature provides the G-sensor sensitivity options. Enter the gravity sensing interface to select off or choose the sensitivity level when gravity sensing is triggered. You can choose from off, low, medium, and high, with the default setting off.

Language <b>11</b>	English >
Time Setting <b>12</b>	>
Time zone <b>13</b>	UTC +08:00 >
Speed unit <b>14</b>	mile/h >
GPS watermarking <b>15</b>	ON >

#### **11 Language Settings**

This feature provides language settings. Enter the language settings interface, short press the Up/Down button to select the desired language, then short press the Confirm button to complete the language setup.

## 12 Time Settings

This feature provides time settings. Enter the time settings interface, short press the Up/Down button to select the current date and time, then short press the Confirm button to complete the time setup.

## 13 Time Zone

This feature provides time zone options. Enter the time zone interface, short press the Up/Down button to select the desired time zone, and the device will display the time according to that time zone.

## 14 Speed Unit

This feature provides speed unit options. Enter the interface, short press the Up/Down button to select the desired speed unit, either km/h or mph, with the default setting mile/h.

## 15 GPS Watermark

This feature provides GPS watermark options. Enter the GPS watermark interface and choose to enable or disable the GPS watermark, with the default setting enabled.

GPS Information 16	>
Storage 17	>
Format reminder 18	ON >
Reset Setup 19	>
Firmware version 20	>

## 16 GPS Information

This feature provides GPS information. Enter the GPS information interface to view the current GPS signal strength.

## 17 Storage Space

This feature provides storage space options. Enter the interface to view the current TF card usage. After selecting the "Confirm Icon," short press the Confirm button to format the storage card.

\* The TF card is a consumable item, for better recording, please format the TF card regularly and replace it periodically. When choosing an TF card, select a Class 10 or higher-rated card.

## 18 Format Reminder

This feature provides a format reminder option, which can periodically remind you to format the TF card. You can choose to enable or disable this reminder, with the default setting enabled.

#### 19 Restore Factory Settings

factory state. Note: After restoring to factory settings, manually readjust the settings as they will not automatically restore or back up.

#### 20 Software Version

This feature provides software version information. Enter the interface to view the device's current version number.

Storage	>
Format reminder	ON >
Reset Setup	>
Firmware version	>
Installation and warranty 21	>

#### 21 Installation and Warranty

This feature provides installation and warranty options. Enter the interface to scan the QR code for installation help and warranty registration.

## Settings Interface Description (Voltage Reduction Cable)

If you have purchased a voltage reduction cable and connected it for power supply. You can use the parking monitoring function and set its parameters in the settings interface.

Collision Detection <sup>1</sup>	OFF >
Time-lapse Recording duration <sup>2</sup>	OFF >
Time-lapse Recording <sup>3</sup>	1fps >

### <sup>1</sup> Collision Detection

This function provides options for collision detection. Enter the collision detection interface to choose between turning it off or selecting the sensitivity level when a collision is detected. You can choose from Off, Low, Medium, or High, with Off being the default setting.

### <sup>2</sup> Time-Lapse Recording Duration

This function provides options for time-lapse recording duration. You can select the duration for time-lapse recording, with options of Off, 12H, 24H, or 72H, and Off being the default setting.

### <sup>3</sup> Time-Lapse Recording

This function provides options for time-lapse recording. You can select the frame rate for time-lapse recording, with options of 1 frame per second, 2 frames per second, or 5 frames per second, and 1 frame per second being the default setting.

# Playback Interface Description

In the video recording interface, short press the Up button to enter the playback interface.



Playback Menu Icon Descriptions			
1	<b>Video File</b> Blue state indicates selected status White state indicates unselected status	2	<b>Locked Video File</b> Blue state indicates selected status White state indicates unselected status
3	<b>Image File</b> Blue state indicates selected status White state indicates unselected status	4	<b>Front/Rear Switching Icon</b> Click to switch between front and rear recording
5	<b>Multi-selecticon</b> Select this icon to choose multiple files at once	6	<b>Return Icon</b> Select this icon to return to the recording interface

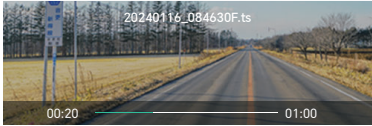

Select the name of the video file, and short press the confirm button to enter the playback interface for that video file. In the playback interface, the video will automatically start playing. Press the confirm button to play/pause the video file. After the video file finishes playing, it will automatically proceed to the next video file. Short press the menu button to return to the playback list interface.

## Installation Guidance Description

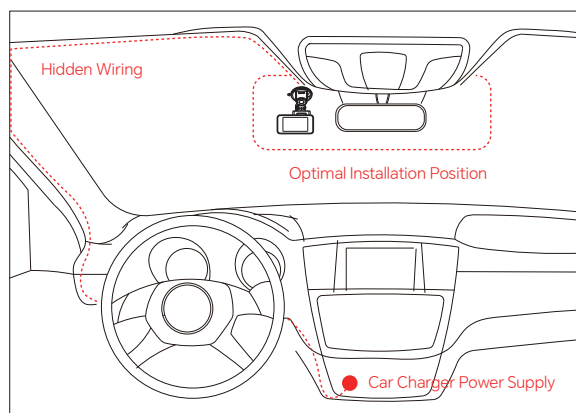

### Important Matters:

1. Before installation, power on the device to check if all functions are normal. Do not forcefully pull the wires during installation. Ensure that the connection terminals are not incorrectly connected, misplugged, or reversed.
2. If the functions and display are normal before installation but abnormal after installation, it is likely due to installation issues. Please check if there is a short circuit in the connection wires or if the pins inside the connection terminals are bent or short-circuited.
3. During the vehicle installation process, it is strictly prohibited to damage or modify the original wiring circuits. If the wiring is damaged during installation, the entire set of new wiring must be replaced and installed before powering on the device.

## APP Interface Introduction

(Interface may be different due to different operating system but it will still work.)

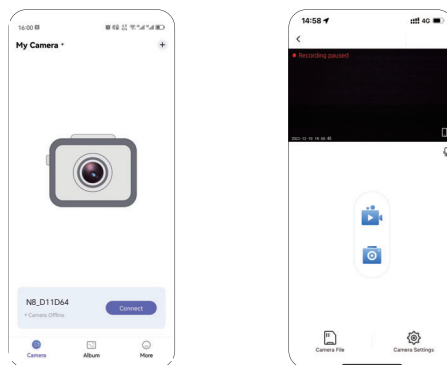

Photograph: Mode for taking pictures, tap 📷 icon to take a photo, Video Recording: Mode for recording video, tap 📹 icon to start recording;

- 📹 Tap to check out the video files
- 📷 Tap to check out the image files
- ⚙️ Tap to enter setting menu
- 📁 Tap to check out video and image files which are downloaded
- 🔗 Into phones; You can share those files with your family and friends on SNS
- 📄 Tap to preview in full screen

### Check out files in dash cam

Tap this icon to enter the main interface of folder, press and hold any video files and then you can edit the video file as below.

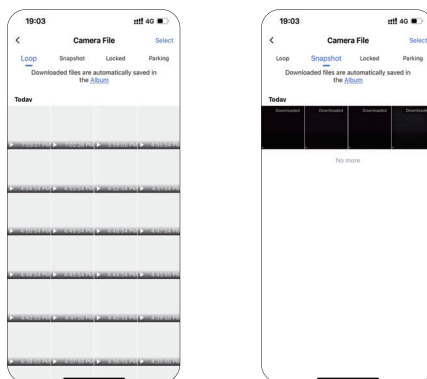

📁 Select an image or video and tap this icon to download it into phone

🗑 Select an image or video and tap this icon to delete it

< Cancel : tap to quit edition;

Tap to enter settings menu

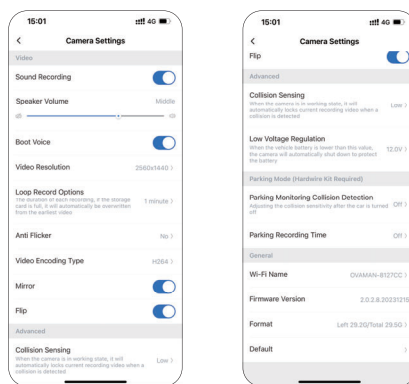

- Audio recording: Tap to turn on/off audio recording while recording video
- Speaker Volume: Move the slider bar to increase or decrease your Speaker Volume
- Startup sound: Tap to turn on/off start up sound
- Video resolution: Tap to select from 4K/2K
- Recording time: Tap to select from 1/3/5 minutes
- Frequency: Tap to select from none or 50/60
- Video encoder format: Tap to select from H264/H265
- Left and right mirroring: Tap to turn on/off left and right mirroring Upside Down: Tap to turn on/off upside down function

Collision sensitivity: Select from Low/Middle/High  
Low-voltage Adjustment: Tap to set a target voltage. (The dash cam will automatically power off to protect car battery while the voltage of car battery is under this voltage.)  
Collision sensitivity while parking: Tap to select sensitivity level or off while parking  
Monitoring time while parking: Tap to select monitoring time or off while parking  
WiFi SSID: Tap to change the WiFi SSID/Name  
Firmware Version: Tap to check out the firmware version  
Memory card formatting: Tap to format the TF card  
Restore factory setting: Tap to restore factory setting

## Dash Cam Hardwire Kit Installation Guide

### Function of the Dash Cam Hardwire Kit

The typical voltage in a car is 12V, while the universal voltage for dash cams is 5V. The Hardwire Kit steps down the voltage from the car's 12V to 5V for use by the dash cam.

Hardwire Kit Power Connection Required for 24 Hours Parking Mode (Collision Detection and Time-Lapse Video Duration)

#### Warning:

Incorrectly connecting the hardwire kit may render parking mode inoperable and damage the car battery. Hardwire Kit installation Method

Connect to the car's constant power fuse.  
Yellow wire->B +Red wire->ACC-> Connect to the positive terminal of the car battery (controlled by the ignition switch)  
Black wire->Ground-> Ground (attach to the screw in the fuse box).

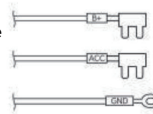

### Hardwire Kit Installation Method

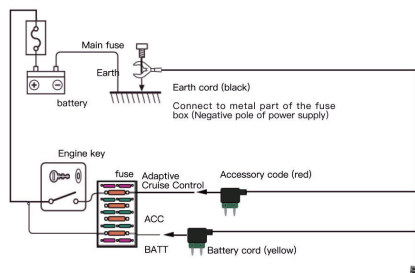

Step 1: When choosing an installation location, ensure the dash cam's hardwire kit can be connected to the car's power source without obstructing the driver's vision or interfering with driving operation

Step 2: Before starting installation, be sure to disconnect the power to prevent electrical malfunctions or vehicle damage.

Step 3: Connect the red wire of the hardwire kit cable to the ACC in the fuse box, the yellow wire to the car's constant power source, and the black wire to ground (use a test pen to confirm connections during the installation process).

Step 4: Reconnect the car's power, start the engine, and ensure the dash cam is functioning properly.

**Note:**

Protect the car's internal wiring during wiring to avoid affecting the normal operation of other devices. If you are unsure about your actions, it is recommended to seek assistance from a qualified professional.

**FQA**

Q1. How to Enable Parking Mode Parking Mode is enabled through the dash cam's settings menu: Enter the dash cam's settings menu and find the "Collision Detection" option and enable it.

Q2. My Dash Cam Doesn't Record Videos After Parking. What Should I Do?

- Check Power Connection: Ensure the hardwire kit is connected correctly and that it is connected to both always-on power (BAT) and ignition power (ACC).
- Check Dash Cam Settings: Confirm that Parking Mode is enabled in the settings menu.
- Voltage Test: Use a multimeter to measure the hardwire kit's output voltage. Ensure the output voltage is stable and meets the dash cam's requirements.

- Hardwire Kit issues: If the above checks are satisfactory, the hardwire kit may need to be replaced.

Q3. How Long Can Parking Mode Recordings Be Saved? Recording time depends on storage card capacity and recording mode. In parking detection and gravity sensing modes, recording only occurs when an event is detected, resulting in longer storage times. In time-lapse videoduration, recording files are smaller and can also be stored for a longer period. It is recommended to use a high-capacity storage card and regularly clean or back up recording files.

Q4. Where Can I View Parking Mode Recordings?

Parking Mode recordings are typically stored on the dash cam's storage card and can be viewed in the following ways:

- Dash Cam Playback: Long-press the menu button to enter the playback interface. Recordings will be stored in a locked file.
- Computer Viewing: Remove the storage card, insert it a card reader connected to a computer, and open the playback folder in the file manager.
- Mobile App: Enable the dash cam's Wi-Fi function, connect to the Wi-Fi on your phone, open the app: viidure, and view playback files.

## **INFRINGEMENT**

The video (audio files recorded by this product cannot be used without the permission of the rights owner, except for personal use.) About the built-in battery (Built-in or not according to model)

### **when you're using product with battery**

**You need to obey the rules blow:**



**DANGER**

- Do not remodify or dismantling the product.
  - Do not heat or put the product into fire
  - Do not put the product long-termly under scorching sun or high temperature environment.
- These behaviours may cause fire disaster and personal injury.

### **When you need dispose built-in battery components**

**You need to obey the rules blow:**



- Do not throw the battery in to fire or water, or heat it.
  - Do not put the battery under the scorching sun.
  - Attach insulating tape to the battery connector.
- These behaviours may cause fire, explosion battery liquid leak, personal injury.







**when you need to dispose of built-in battery components You also need to pay attention that:**









 <b>DANGER</b>	<ul style="list-style-type: none"> <li>● It is not reachable for a child</li> <li>● Seek help from a doctor if the battery liquid contacts one's eyes.</li> </ul> <p>These behaviours may cause fire, explosion, battery liquid leak, personal injury.</p>
--	--







**When you install this product:**

 <b>DANGER</b>	<ul style="list-style-type: none"> <li>⊘ Please do not install this product on vehicles that does not fit DC12V/24V(with earthwire) electronic facility If you connect this product with power port that is not DC12V/24V, it may cause fire and other functional failure</li> <li>⊘ Do not install and wire in a location that block the operation of the airbag This may cause airbag malfunction and lead to fatal accident.</li> <li>⊘ Never use bolts or nuts for car safety parts (steering, brakes, tanks, etc.) This may cause traffic accident</li> <li>⊘ Do not install in places that obstruct visibility or driving, or that may cause danger to passengers</li> </ul>
	<ul style="list-style-type: none"> <li>ⓘ We recommend that you ask help from the professional for installation and wiring Incorrect installation or wiring can cause serious damage to the car and cause a traffic accident.</li> </ul> <p><b>Please do not install this product on vehicles that does not fit DC12V/24V(with earth wire) electronic facility</b></p>



**Please refer to this manual and install it correctly.**

	<ul style="list-style-type: none"><li><p> <b>Before installation, please confirm the position of pipes, tanks, and wiring of vehicle electrical facilities.</b></p><p>Please be careful that do not interfere with pipes tanks, electrical wiring, etc. if you need to screw a hole for installation.</p></li><li><p> <b>Be sure to use the included parts in package or recommended parts.</b></p><p>Other parts may cause accidents, breakdowns, fires</p></li><li><p> <b>If it wraps around the steering wheel, shift lever, brake pedal, etc. it may cause a traffic accident.</b></p></li><li><p> <b>When wiring, please make sure that the cord does not get caught in moving parts such as the car body and seat .</b></p><p>Make sure that the cord does not get caught in moving parts such as the car body and seat .</p></li><li><p> <b>Make sure to insulate the uncovered part of the cord with tape etc.</b></p></li><li><p> <b>Before installation, please connect with the parts of this product and power on to check whether it works properly</b></p><p>This makes you easier to request a refund or free replacement if you find defect or malfunction of this product.</p></li></ul>
---	---

 <b>DANGER</b>	<p> <b>Keep small parts such as screws and memory cards out of the reach of children or babies.</b></p> <p>If babies swallowed these parts, please seek help from a doctor immediately!</p> <p> <b>Please use the power cord with cigarette lighter plug included in the package.</b></p> <p> <b>Make sure the power plug is well connected.</b></p> <p>If not, it may cause product failure, fire, and electric shock.</p> <p> <b>When pulling out the cigar lighter plug please hold the plastic part and pull it out.</b></p> <p>If not, it may cause product failure, fire and electric shock.</p> <p> <b>Please unplug the product if not in use for a long time.</b></p> <p>Depending on the vehicle model, the cigar lighter may not power off even if the engine is turned off. It may cause fire disaster or decrease battery life.</p> <p> <b>Please clear the cigar lighter plug periodically.</b></p> <p>If there is dust on it, it may cause product failure.</p>
	<p> <b>Do not insert or remove the cigar lighter plug with wet hands.</b></p> <p>This may lead to electric shock or product failure,</p>

 <b>DANGER</b>	<p> <b>Do not install in places exposed to water or places with high humidity dust, or oily smoke.</b></p>
	<p> <b>Do not block the ventilation holes or heat sinks of the product.</b></p> <p>Heat may be trapped inside the device, causing a fire or malfunction.</p>
	<p> <b>Be careful with the cord</b></p> <p>Do not damage the cord, pull it forcibly, bend it, twist it, process it, place heavy objects on it, or bring it close to thermal equipment. These behaviors may cause disconnection or short circuit and lead to fire, electric shock, or other accident.</p>
	<p> <b>Do not modify or disassemble this product.</b></p> <p>Do not modify or disassemble this product without the permission of manufacturer or seller, these behaviors may cause product failure and electric shock, fire and other accident.</p>
	<p> <b>Do not allow liquid or foreign matter to get inside the machine.</b></p> <p>If metal, flammable materials, liquids, etc. enter, it may cause product failure, smoke, fire or electric shock.</p>

## About the Micro SD card

 <b>NOTICE</b>	<ul style="list-style-type: none"><li>ⓘ Use the edge of a small coin (or similar object ) to push the memory card into slot if required. Take care that the card has been inserted into slot, a second push inwards will release the memory card.</li><li>ⓘ Do not remove or insert the memory card when the dash cam is turned on.This may damage the memory card.</li><li>ⓘ Periodically reformat the memory card.We recommend that you format the memory card every 2-3 weeks.This will wipe any files from the card and set it up afresh for continued use with your dash cam. Of course, you should only do this after you've downloaded any files from the SD card that you may want to keep, as formatting the card will remove all contents.</li><li>ⓘ Take care when removing the SD card from the dash cam when it is installed in the vehicle. Due to the card slot mechanism, the card will spring from the slot when released.</li><li>ⓘ To format your memory card before using the dash camThis will make sure that the card is structured specifically for your camera.</li><li>ⓘ Press  to enter into the setting and choose the Storage option to follow the on-screen instructions accordingly.</li></ul>
--	---

## Customer Service



Email



Whatsapp

**E-mai:**[support@coolcrazycam.com](mailto:support@coolcrazycam.com)

## FCC WARNING

This device complies with part 15 of the FCC Rules. Operation is subject to the following two conditions: (1) this device may not cause harmful interference, and (2) this device must accept any interference received, including interference that may cause undesired operation. Any changes or modifications not expressly approved by the party responsible for compliance could void the user's authority to operate the equipment.

**NOTE:** This equipment has been tested and found to comply with the limits for a Class B digital device, pursuant to Part 15 of the FCC Rules. These limits are designed to provide reasonable protection against harmful interference in a residential installation. This equipment generates, uses and can radiate radio frequency energy and, if not installed and used in accordance with the instructions, may cause harmful interference to radio communications.

However, there is no guarantee that interference will not occur in a particular installation. If this equipment does cause harmful interference to radio or television reception, which can be determined by turning the equipment off and on, the user is encouraged to try to correct the interference by one or more of the following measures:

- Reorient or relocate the receiving antenna.
- Increase the separation between the equipment and receiver.
- Connect the equipment into an outlet on a circuit different from that to which the receiver is connected.
- Consult the dealer or an experienced radio/TV technician for help.

To maintain compliance with FCC's RF Exposure guidelines, This equipment should be installed and operated with minimum 20cm distance between the radiator and your body: Use only the supplied antenna.