



Instructions

Carplay
M5

CarPlay Connection Guide

Step one: Insert the device into the original car's CarPlay interface.

(This device does not show an interface, which is a normal phenomenon)

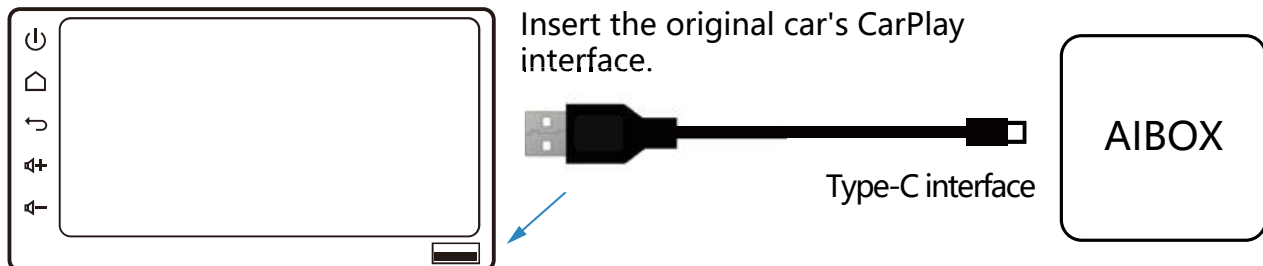

Step two: Use mobile phone to pair the box with Bluetooth smartBox-XXXX. (AIBOX-XXXX)

(The mobile phone WiFi needs to keep on-state condition)

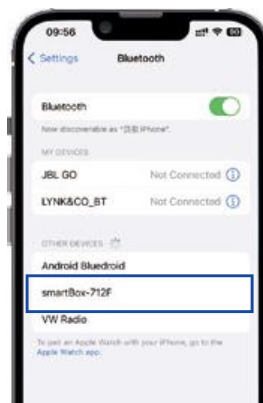

Step three: After successful connection, the cellphone will pop up a CarPlay vehicle-mounted window. Click "Use" to enter the CarPlay interface.

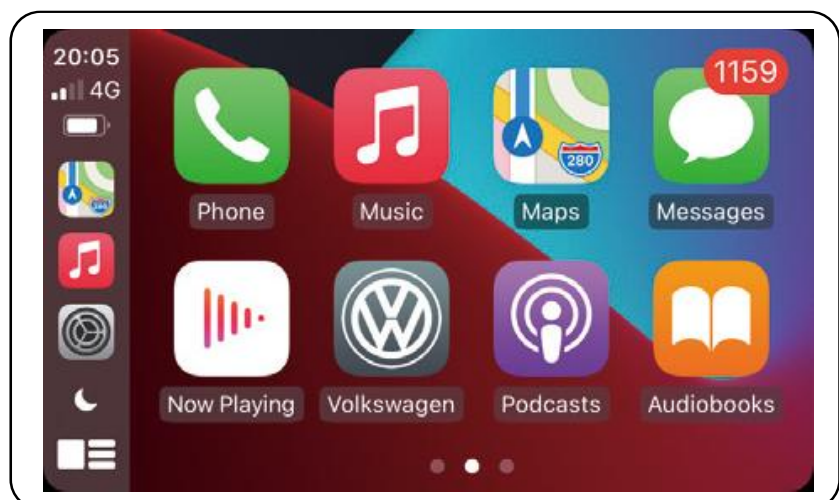

Issue submission and equipment upgrade

Simply plug the product into a USB 5V power supply (as illustrated in following figure). Once the device is powered on, connect your cellphone to the device's WiFi. The WiFi name is "smartBox-XXXX" (AIBOX-XXXX) and the password is "88888888". Then, enter <http://192.168.1.101> in your browser to access the background system.



Use cigarette lighter



Use phone charger



Use original car's Carplay interface (not recommended)

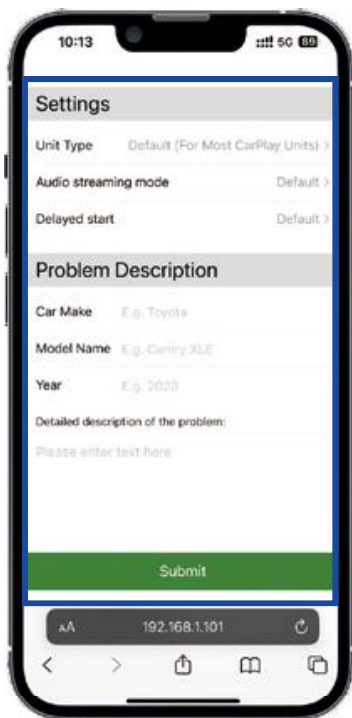

Issue submission

Enter the background system to fill in the problem description. Click "Submit" and take a screenshot of your cellphone. Contact the dealer.

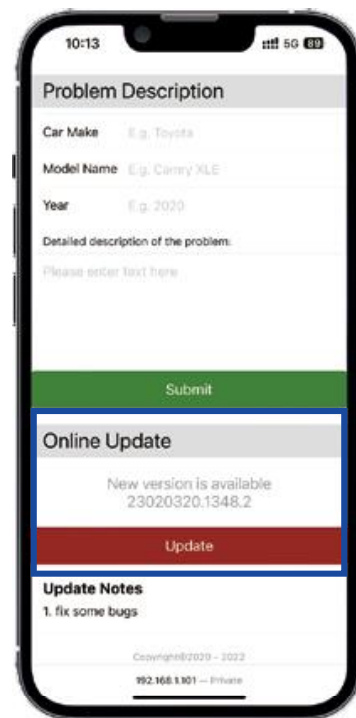

Device Upgrade

Enter the background system and click "Update" to achieve software upgrading.

Android Auto Connection Guidance

Step one: Insert the device into the original car's Android Auto interface.

(This device does not show an interface, which is a normal phenomenon)

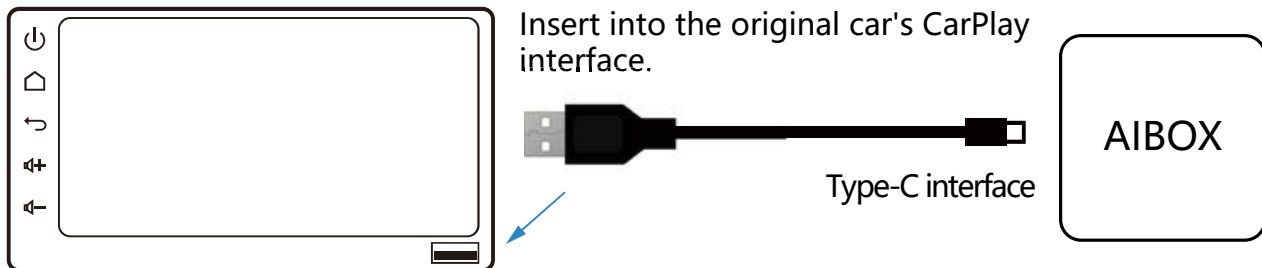

Step two: Pair the box Bluetooth with a cellphone that supports Android Auto. smartBox-XXXX (AIBOX-XXXX) (the mobile phone WiFi also needs to keep on-state condition)

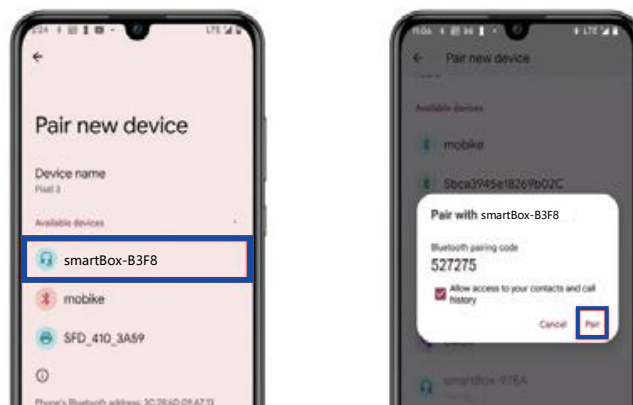

Step three: After successful Bluetooth connection, the device indicator light blinks, click on the original car's central control screen. Android Auto button, you can achieve wireless Android Auto function.

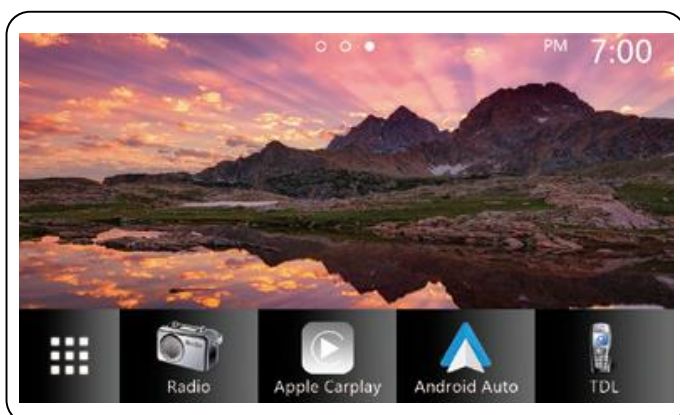

Issue submission and equipment upgrade

- 1 Simply plug the product into a USB 5V power supply (as illustrated in following figure).



Use cigarette lighter



Use phone charger

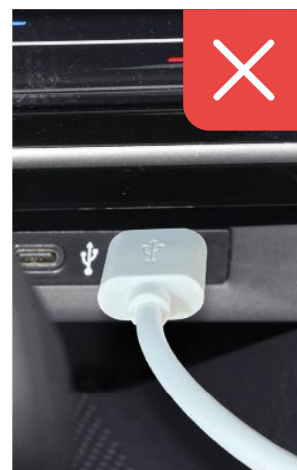

Use original car's Carplay interface (not recommended)

- 2 The mobile phone actively connects to the box's WiFi (equipment name: smartBox-XXXX (AIBOX-XXXX) password: 88888888).

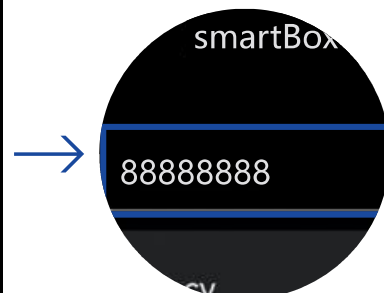
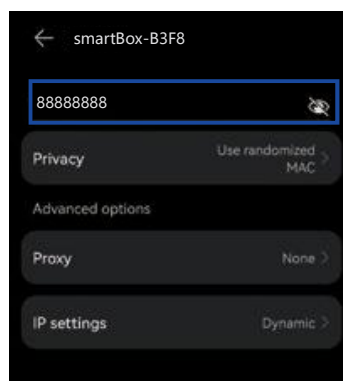
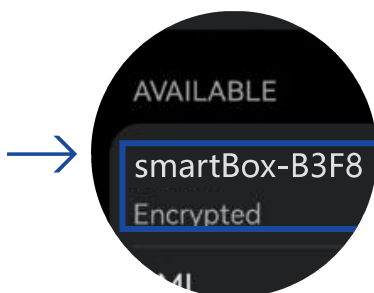
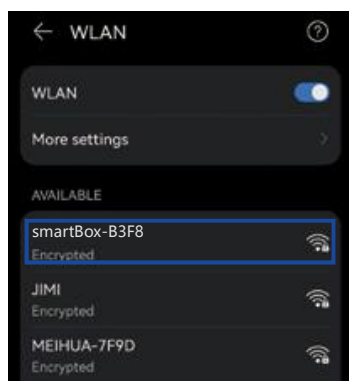

- 3 Open the mobile browser and input the web address: **192.168.1.101** to access the background web page.
- 4 Click on "**Switch P2P**" at the bottom of the web page, and after the successful switchover, click on "OK"!

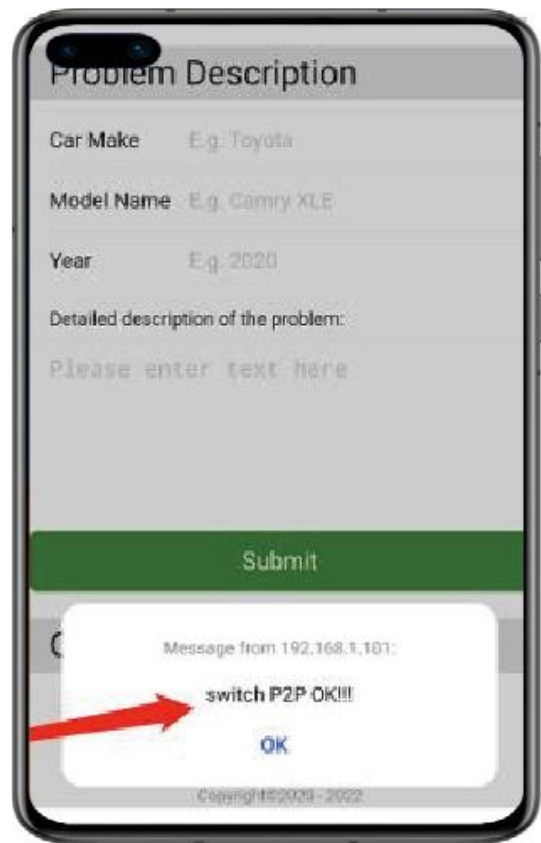

- 5 Go back to the mobile phone interface, open settings > WiFi > smartBox-XXXX (AIBOX-XXXX) , then open the browser again and input the web address: 192.168.1.101 to access the background web page.**



Issue submission

Enter the background system to fill in the problem description. Click "Submit" and take a screenshot of your cellphone. Contact the dealer.

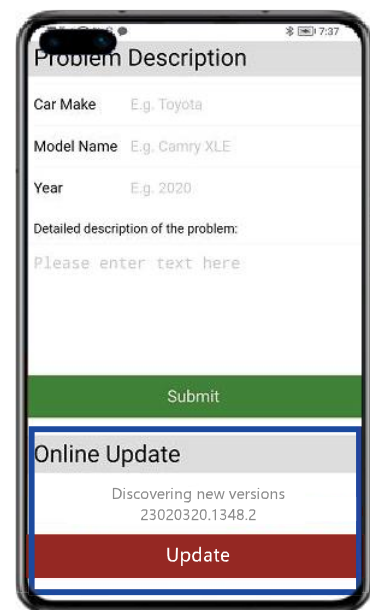

equipment upgrade

Enter the background system and click "Update" to achieve software upgrading.

FCC Warning

This device complies with part 15 of the FCC Rules. Operation is subject to the following two conditions: (1) This device may not cause harmful interference, and (2) this device must accept any interference received, including interference that may cause undesired operation.

Any Changes or modifications not expressly approved by the party responsible for compliance could void the user's authority to operate the equipment.

Note: This equipment has been tested and found to comply with the limits for a Class B digital device, pursuant to part 15 of the FCC Rules. These limits are designed to provide reasonable protection against harmful interference in a residential installation. This equipment generates uses and can radiate radio frequency energy and, if not installed and used in accordance with the instructions, may cause harmful interference to radio communications. However, there is no guarantee that interference will not occur in a particular installation. If this equipment does cause harmful interference to radio or television reception, which can be determined by turning the equipment off and on, the user is encouraged to try to correct the interference by one or more of the following measures:

- Reorient or relocate the receiving antenna.
- Increase the separation between the equipment and receiver.
- Connect the equipment into an outlet on a circuit different from that to which the receiver is connected.
- Consult the dealer or an experienced radio/TV technician for help.

This equipment complies with FCC radiation exposure limits set forth for an uncontrolled environment. This equipment should be installed and operated with minimum distance 20cm between the radiator & your body.