



Model: WWF001

# USER MANUAL

---

EverMount Battery-operated  
Pet Water Fountain

## Table of Contents

---

• Safety Precautions .....	1
• Warranty .....	3
• Product Overview .....	3
• How It Works .....	5
• How To Use .....	6
• Disassembly .....	11
• Indicators & Buttons Overview .....	13
• Care Guide .....	15
• FAQs .....	16
• Specifications .....	17

## Safety Precautions

---

- Dispose of all packaging properly. Keep the polybags away from pets and children as these bags could cause suffocation.
- The product has a built-in lithium battery; do not operate the fountain under high temperatures or high pressure to avoid danger. The built-in rechargeable battery cannot be disassembled.
- Please use a 5V 2A standard adapter for power supply; do not use fast-charging adapters.
- The power plate contains electronic components; do not wash the power plate with water. If cleaning is needed, wipe it with a dry cloth. Do not submerge the power plate in water while in use.
- This drinking fountain is intended for pets only; do not use it for other purposes.
- Do not cover the power plate while the fountain is in use; ensure there are no obstructions within the sensing range to avoid failure to trigger the sensor.
- Keep the power cord concealed to prevent pets from biting and damaging it.
- Do not expose this product to direct sunlight for extended periods.

- Do NOT allow children to play with, in or around the pet water fountain.
- Do NOT allow children around the pet water fountain unsupervised.
- This product contains batteries and electronic components. If there is a need to dispose of this product, please follow proper disposal methods and take it to an officially designated recycling center.
- Only use attachments recommended or sold by the manufacturer. The use of attachments not recommended or sold by the manufacturer may create an unsafe condition.
- Be sure to disconnect the power supply when the product is not in use.
- The power adapter and wire plug must not be flooded during cleaning.
- This product requires clean water to operate properly.
- Replace the filter every 2 weeks or when the waterflow has noticeably reduced.
- Only the stainless steel water tray can be put in the dishwasher. Do NOT put other components in the dishwasher.

## Warranty

- 24-month warranty
- For product assistance or questions about your warranty, please contact our customer support team via email:

support@whiskertons.com

## Product Overview

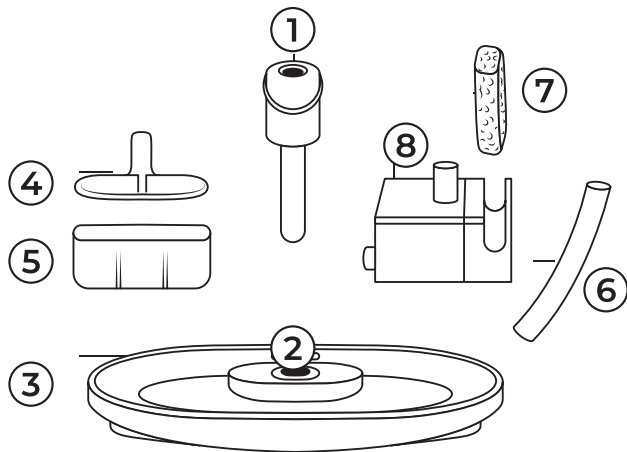

- |                               |                        |
|-------------------------------|------------------------|
| 1. Spout                      | 5. Filter Compartment  |
| 2. Spout Base                 | 6. Water Pipe          |
| 3. Stainless Steel Water Tray | 7. Foam Filter         |
| 4. Filter                     | 8. Wireless Water Pump |

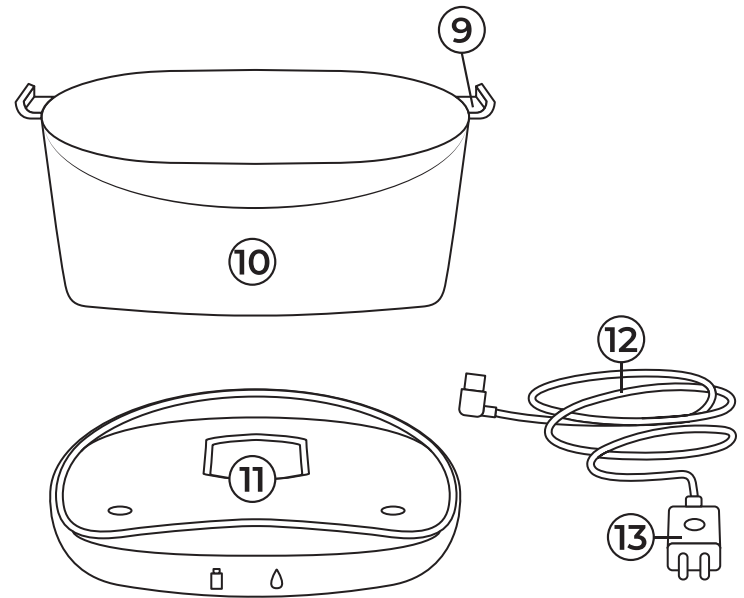

- |                 |                   |
|-----------------|-------------------|
| 9. Lid Clasps   | 12. Power Cord    |
| 10. Water Tank  | 13. Power Adapter |
| 11. Power Plate |                   |

### Note:

Components 9 and 10 are integrated together and are non-detachable.

## How It Works

**Regular Mode:** 24/7 continuous water flow

- This mode is only supported when the external power cord is connected to the fountain and plugged into a power socket.

**Induction Mode:** The water fountain has a built-in sensor that automatically dispenses water for 45 seconds when it detects pet activity within its sensing range (sensing range: up to 19.7" / 50cm)

- During induction mode, if no pets trigger the sensor, then water will still be dispensed once every hour for 45 seconds to keep the water clean.

- Induction Angle: 180° (Includes three sides: front, left, and right sides)

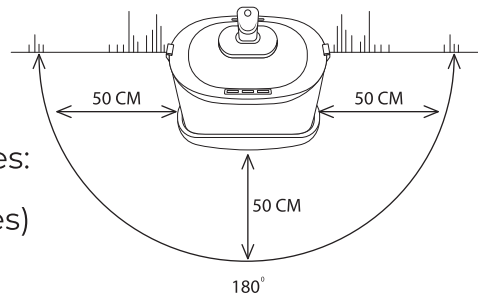

The sensor cannot detect pets from the back side of the fountain, so it's necessary to place the back side of the fountain against a wall to avoid confusion for pets.

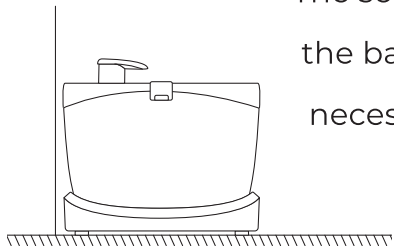

## How To Use

1. Soak the filter in a clean bowl of water for 5 minutes, then rinse the filter thoroughly with water.

- The filter must be fully soaked before usage, otherwise water may not flow smoothly through the filter causing spillage.
- Do not use the water tank to soak the filter in case of any surface dust.

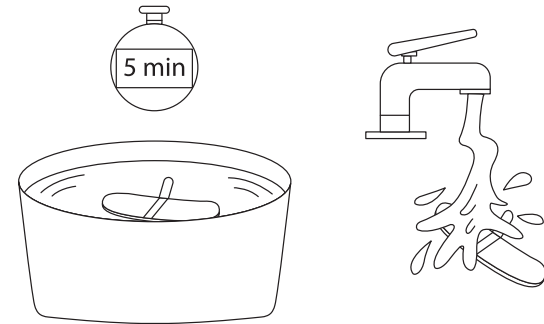

2. Insert the foam filter in the open slot of the water pump, then insert the water pipe onto the wireless water pump outlet.

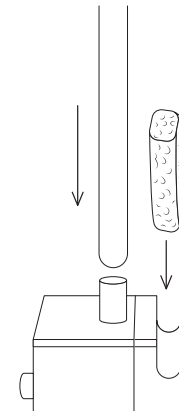

3. Place the pump inside the water tank in the necessary position according to the bottom insertion. (Required for a firm installation)

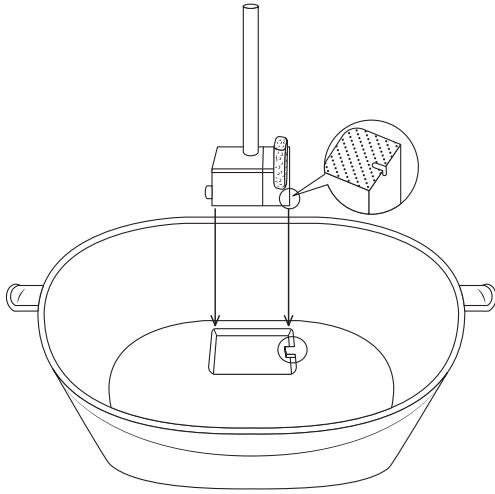

4. Place the filter inside the filter compartment, then hang the filter compartment onto the hook on the inner wall of the water tank.

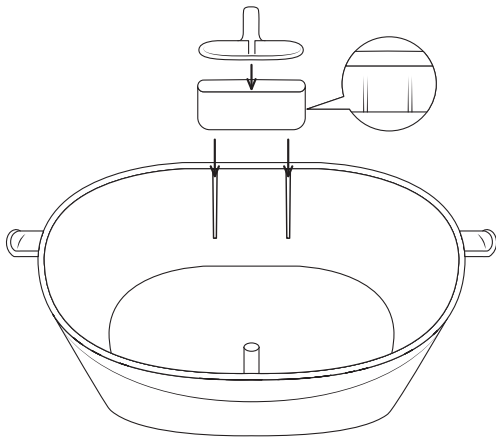

5. Add clean water to the water tank, but do not exceed the maximum water level line.

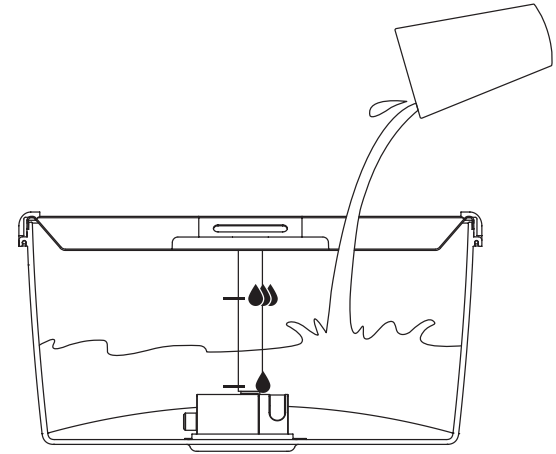

6. Place the stainless steel water tray on top of the water tank, then fasten the buckles on both sides.

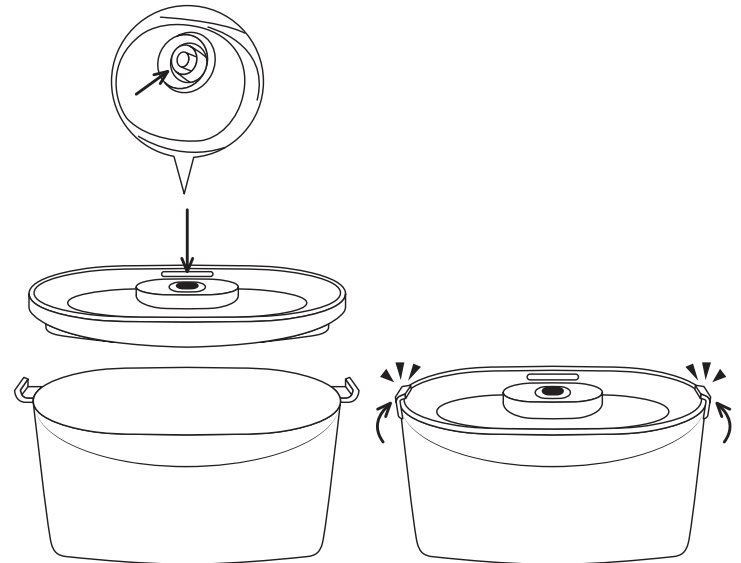

7. Align the water spout with the water pipe, then insert it onto the stainless steel water tray. Press it firmly to secure it.

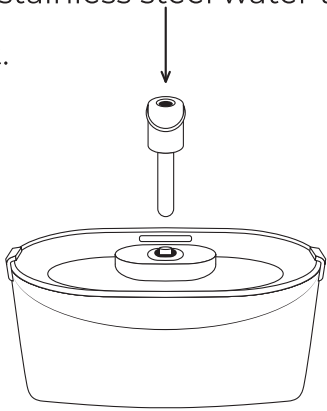

#### 8. Power the fountain

- During regular mode (plugged in):
  - Connect the power supply to the power plate.

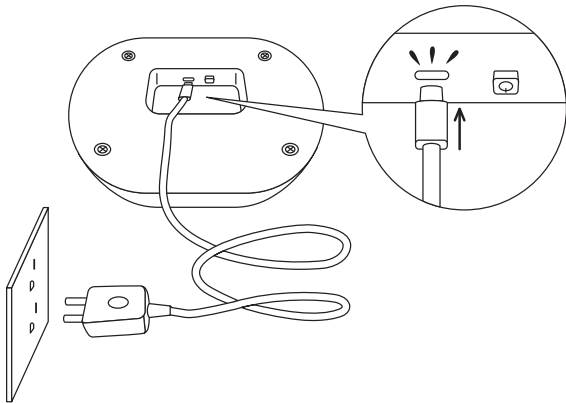

- Turn on the power switch underneath the plate.

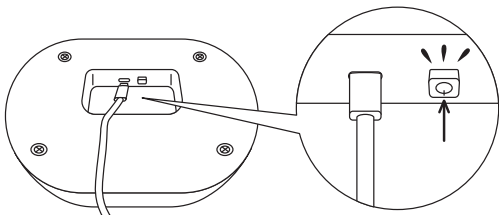

- During induction mode (cordless):
  - Turn on the power switch underneath the plate.

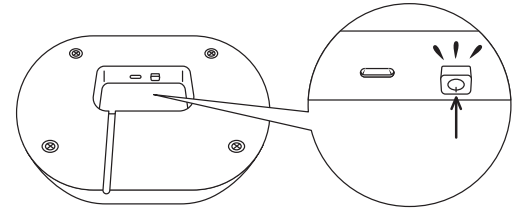

*Note: Upon powering on the fountain, it will automatically pour water for 45 seconds.*

9. Place the water tank on top of the power plate, ensuring that the protruding areas underneath the water tank align with the concave areas on the power plate.

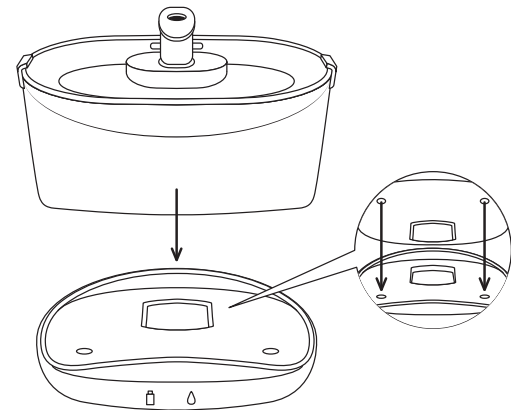

## Disassembly

- Lift the water tank off the power plate.

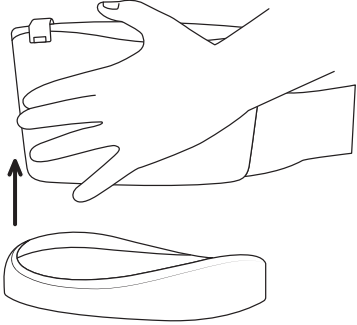

- Unlock the buckles on both sides of the water tank & remove the water spout from the water tray by pulling it upwards.

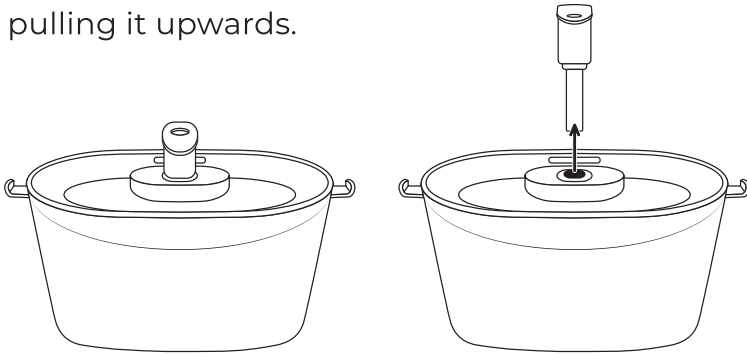

- Use the spout base opening as a gripping point to lift the stainless steel water tray off the water tank.



- Lift the filter compartment off the hook on the inner wall of the water tank. Then, remove the filter from inside the compartment.

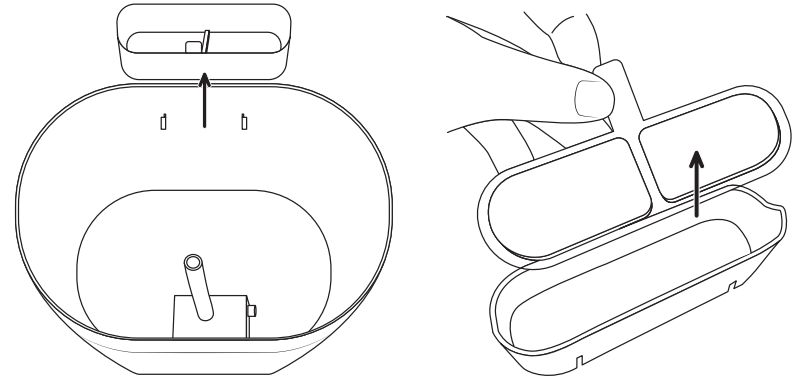

- Gently pull the water pipe off the wireless water pump outlet. Then, remove the foam filter from the open slot of the water pump.

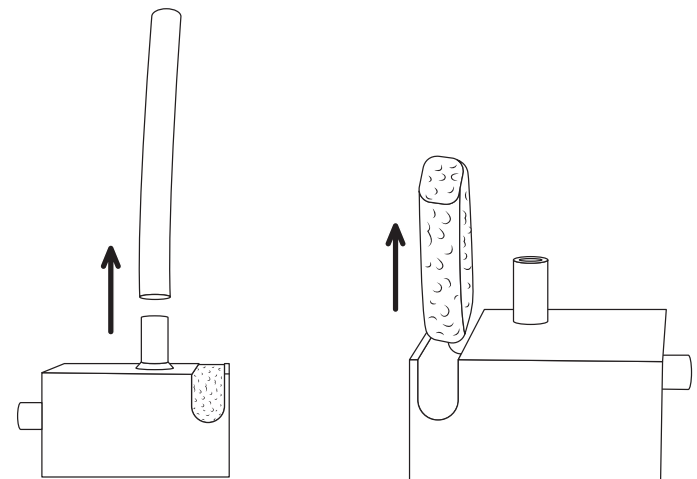



# Indicators & Buttons Overview

Light Icons:

## Battery Indicator

1. Breathing White Light: When the power cord is connected to the plate and the fountain is being charged.
2. Steady White Light: When the power cord is connected to the plate and the battery is fully charged.
3. Steady Red Light: When the power plate is unplugged and the battery is low, needing to be charged.
4. No Light: When the power plate is unplugged and the battery power is sufficient.

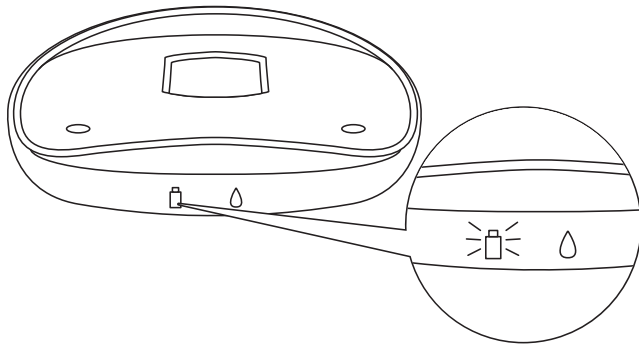

## Water Level Indicator

1. No Light: When the water level inside the tank is sufficient.
2. Steady Red Light: When the water level inside the tank is low and needs to be refilled.

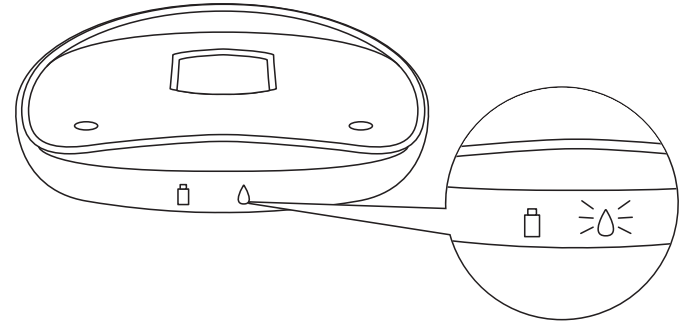

## Power Button

1. Turn On: Press the power button underneath the power plate. The button will lock inwards, and the fountain will turn on.
2. Turn Off: Press the power button underneath the power plate again. The button will unlock, and the fountain will turn off.

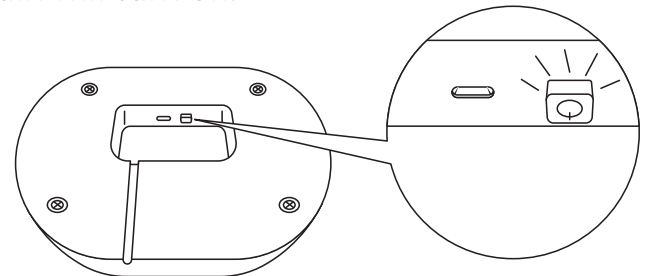

## Care Guide

1. Replace the filter & foam filter once every 2 weeks.  
For 2 or more pets, you may need to replace the filters more frequently to ensure fresh, clean water.
2. Clean the fountain and water pump at least once every 2 weeks.

### How To Clean The Pump

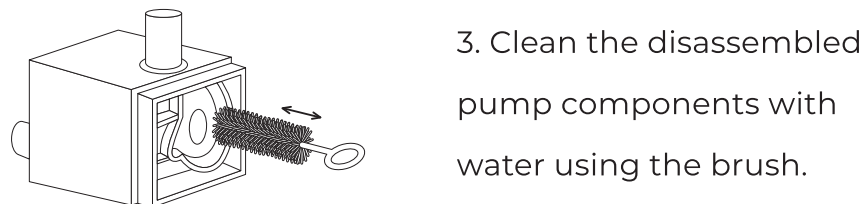
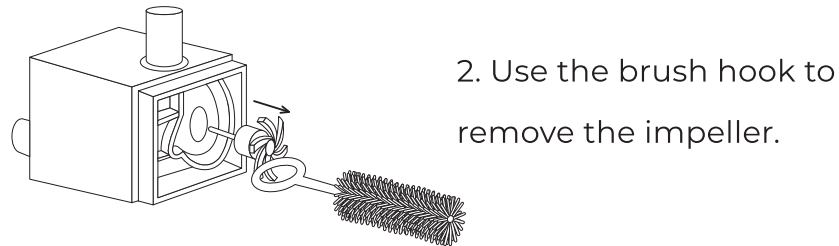
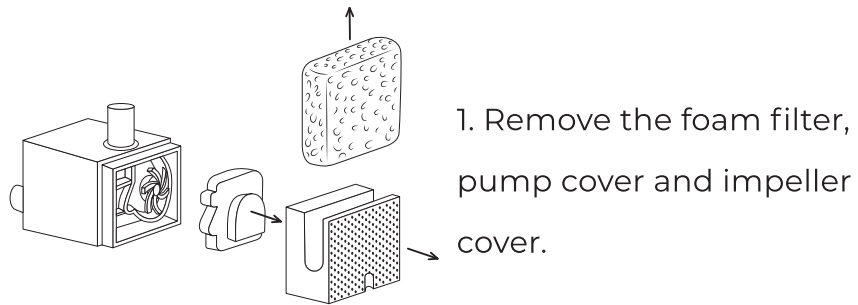

## FAQs

### 1. The fountain is turned on and the water tank is full, but it's not dispensing water.

Double check to make sure that the fountain is actually turned on. Ensure that the wireless pump is installed in the correct position. Check that there are no obstructions in the corresponding areas of the water tank and base, and that they are pressed tightly together. Verify if the battery is charged. Check if the water inlet and outlet of the pump are blocked by hair or other debris. If all the conditions above are normal, then please contact our support team via email:

[support@whiskertons.com](mailto:support@whiskertons.com)

### 2. How often should I change the filters, and where do I get them from?

Replace the filter & foam filter once every 2 weeks. For 2 or more pets, you may need to replace the filters more frequently to ensure fresh, clean water. To purchase more filters, visit our website or contact us at:

[support@whiskertons.com](mailto:support@whiskertons.com)

### 3. Can I let the fountain run all day?

Of course, the wireless water pump is designed to function 24/7. You can –and should– let it run all day and night.

### 4. Where do I fill the fountain up to?

Add water to the tank until it reaches the water level line marked inside the tank.

### 5. Is the fountain dishwasher safe?

Only the stainless steel water tray is dishwasher safe.

#### **Specifications**

- Model: WWF001
- Water Capacity: 3L
- Dimensions: 10.63 x 7.87 x 6.77 inch / 27cm x 20cm x 17.2cm
- Materials: Stainless Steel, ABS
- Power Adapter: Input – 100-240V / Output – 5V 2A
- Battery Capacity: 5000mAh
- Battery Type: Li-Ion Battery Pack



This device complies with part 15 of the FCC Rules. Operation is subject to the following two conditions: (1) This device may not cause harmful interference, and (2) this device must accept any interference received, including interference that may cause undesired operation.

Any Changes or modifications not expressly approved by the party responsible for compliance could void the user's authority to operate the equipment.

**Note:** This equipment has been tested and found to comply with the limits for a Class B digital device, pursuant to part 15 of the FCC Rules. These limits are designed to provide reasonable protection against harmful interference in a residential installation. This equipment generates uses and can radiate radio frequency energy and, if not installed and used in accordance with the instructions, may cause harmful interference to radio communications. However, there is no guarantee that interference will not occur in a particular installation. If this equipment does cause harmful interference to radio or television reception, which can be determined by turning the equipment off and on, the user is encouraged to try to correct the interference by one or more of the following measures:

- Reorient or relocate the receiving antenna.
- Increase the separation between the equipment and receiver.
- Connect the equipment into an outlet on a circuit different from that to which the receiver is connected.
- Consult the dealer or an experienced radio/TV technician for help.

#### FCC Radiation Exposure statement

The device has been evaluatec to meel general RF exposure requirement. The device can be used in portable exposure condition without restriction.