

R-200M

Wireless System

INSTRUCTION MANUAL

Thank you for purchasing this product.
For correct usages and application,
please read this instruction manual carefully.

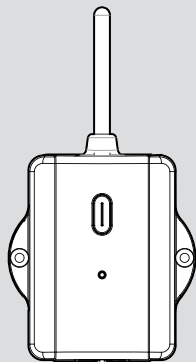

* Design, specifications, and product materials are subject to change without notice

* Changes or modifications not expressly approved by the party responsible for compliance could void the user's authority to operate the equipment*

* The device has been evaluated to meet general RF exposure requirements.

* The device can be used in portable exposure conditions without restriction.



CONTENTS

SAFEGUARD INSTRUCTIONS.....	3
FEATURE.....	5
CONTENTS.....	5
FUNCTION OF EACH PART	6
FUNCTION	7
PAIRING METHOD	10
NOTE	11
CONNECTION.....	12
INSTALLATION.....	13
SPECIFICATION	14



SAFEGUARD INSTRUCTIONS

TVI 10.1" MONITOR

Please read the "Safety Rules" carefully before using this product. Following the safety rules prevents users from damages related with the misuse of the product. It is very important to follow these safety rules. We state "Caution" and "Warning" to clarify any potential risk for a damage associated with the misuse of the product.



NOTICE

This information is for user's reference for better usability.



CAUTION

This information is for preventing damage or shortening the life of the product.



WARNING

This information is for preventing bodily harm or even death and use should follow this safety rules.

CAUTION



Install all components while power is off.
- It may cause electronic shock or malfunction.



Do not connect the product directly to the battery, used switched ignition.
- It may cause battery discharge.



Do not use the product with multi socket or extended adaptor.
- It may cause unexpected heating, fire and malfunction.



When product is not in use for an extended period of time - unplug
- It may cause fire by short circuit due to heating.



Do not place near magnetic devices.
- It may cause malfunction and trouble.

WARNING



Do not install product in direct sunlight, high temperature of humid areas.
- It may cause to electronic shock or malfunction.



Please use this product within the voltage range specified.
- It may cause to electronic shock or malfunction.



Do not locate this product where airbag operation may occur.
- It may cause malfunction of air bag or accident, injury due to hitting monitor by air bag.



Power socket should be clean at all times.
- It may cause electronic shock and fire by bad connection.



When disconnecting power socket please ensure that you disconnect holding each side of the plug. (Not via the cable)
- It may cause cord malfunction, electronic shock and fire.



Do not clean the exterior of the monitor using harsh abrasives or solvents.
- It may cause change of surface, fall of paint, malfunction and fire.



Do not locate this product in high vibration areas without appropriate mounting.
- It may cause damage or malfunction.



Do not insert sharp metal objects such as pins or needles in holes or cracks in the product.
- It may cause electronic shock, fire and malfunction.



If the monitor is emitting smoke or a burning smell please disconnect immediately.
- It may cause fire. Stop to use and make inquiries to supplier.



Do not disassemble, repair or remodel.
- It may cause malfunction and injury, can not get warranty. Make inquiries to agent for repair and checkup.



When the power cable cord touches a metal case, cover it with a friction tape.
- Short circuit or disconnection of wire may cause a fire or accident.

1

FEATURE

WIRELESS SYSTEM

- HD
- **Multiple TX is available on one RX**
 - RX(1):TX(1) / Auto pairing / LED : Red
 - RX(1):TX(4) / Multi pairing / LED : Green
- Easy pairing
- Diecasting case
- Waterproof / IP69K
- Frequency Hopping
- Minimizing image delay
- 100Meters distance reception.

2

CONTENTS

WIRELESS SYSTEM

- Before use this products, Please check contents below. If there is something missing parts, please contact sales agent.



R-200MT
(RX/Receiver)



Installation
Package



5 Key Button
(Option)



Power cable
(Option)



Extension cable
(Option)



Instruction
Manual

* Design, specifications, and product materials are subject to change without notice.

3

FUNCTION OF EACH PART

WIRELESS SYSTEM

RX(Receiver)

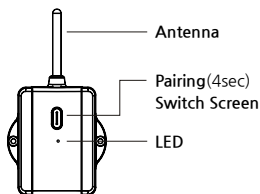

5 Key Button

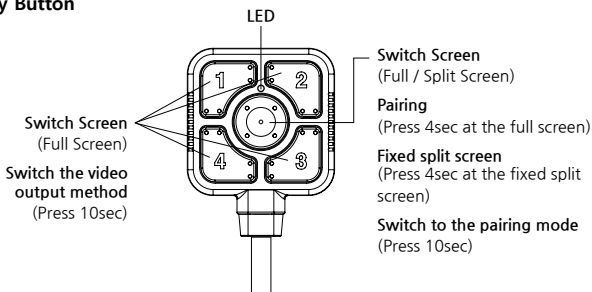

Please do not turn or disassemble the antenna.



Be careful not to press the button except for wireless connection pairing and screen switching.

4

FUNCTION

WIRELESS SYSTEM

1) SWITCH SCREEN (RX(1):TX(4) Multi pairing only / LED : Green)

1) SWITCH SCREEN



or



The screen is switched in order [FULL] - [Split into 2] - [3-division] - [4-division] screen is switched in order upon pressing the center key of the receiver (RX) or 5-key button.

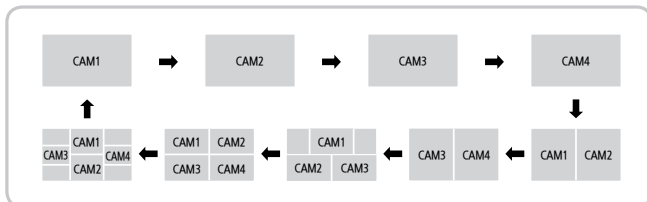

2) SWITCH FULL SCREEN

Pressing keys 1~4 of the 5-key button converts to the FULL screen of the assigned camera.

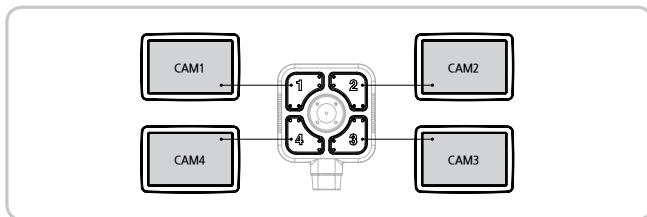

2 SPLIT SCREEN LOCK & UNLOCK (RX(1):TX(4) multi-pairing mode only / LED: Green)

- 1) In the split screen, pressing the center key of the 5 key button for 4 seconds locks the split screen, and pressing the center key of the 5 key button for 4 seconds unlocks the split screen.

e.g.)

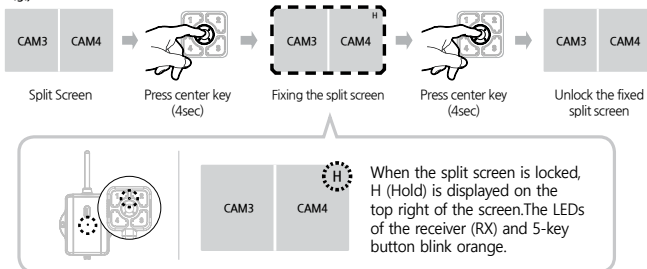

- 2) If you press the 1~4 key in the split screen lock state, the full screen of the assigned camera is converted, and if you press the center key of the 5 key button, the locked split screen is converted.

e.g.)

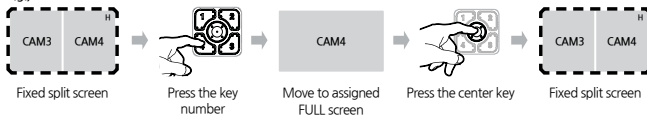

※ The split screen lock and unlock functions are applied only to the split screen.

3 VIDEO OUTPUT METHOD CONVERSION

If you press keys 1 to 4 of the 5-key button for 10 seconds, it will switch to the assigned video output method.

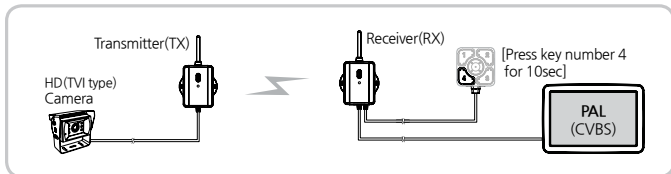
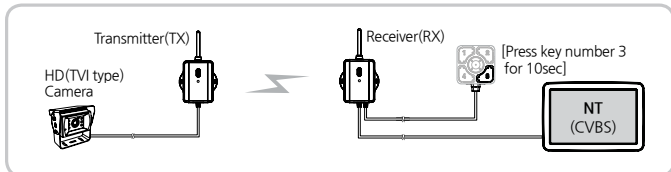
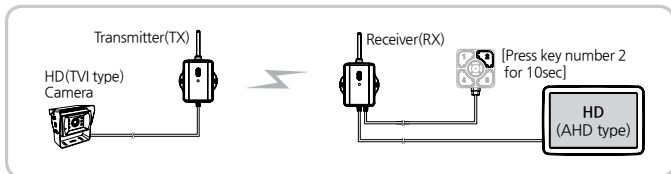
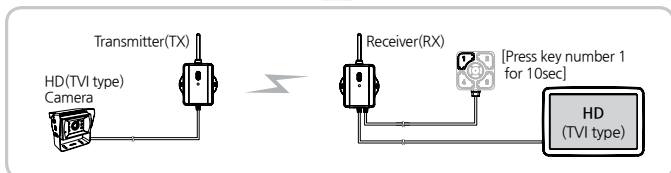
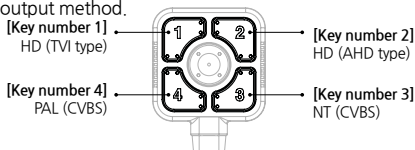

※ Only HD (TVI type) cameras can be connected to the transmitter (TX).

5

PAIRING METHOD

WIRELESS SYSTEM

LED COLOR : RX(1):TX(1) - RED
RX(1):TX(4) - GREEN

1-1. RX(1):TX(1) (Auto pairing) mode

After connecting the receiver (RX) to the monitor, proceed to step.

1-2. RX(1):TX(4) (Multi-pairing) mode

After connecting the receiver (RX) to the monitor, press the button on the receiver (RX) (or 5 key button) to display the full screen of the channel to be connected wirelessly.

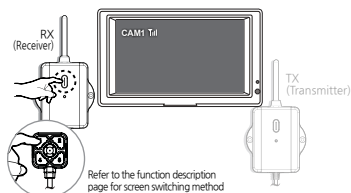

Additional pairing is not available on split screens. Please try pairing when only the channel screen that need to be connected is displayed on the monitor.

2. Press RX button (or center key of 5 key button) until the LED flashes rapidly.

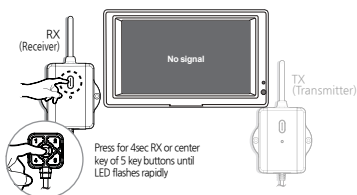

3. After confirming that the LED of the receiver (RX) (or 5-key button) blinks quickly and that the 50-second count screen is displayed on the monitor (Pairing mode), press the button for 4 seconds until the LED on the transmitter (TX) flashes rapidly.

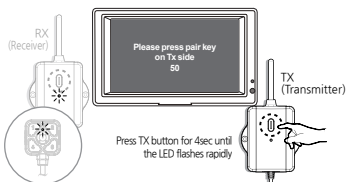

If the button on the transmitter (TX) has not been pressed within 50 seconds or when wireless pairing fails, "TRY AGAIN" message is displayed and returned to the previous screen.

4. When the connection is successful, the receiver (RX) (or 5 key button) and Transmitter (TX) LED blinks at 1-second intervals and the screen of the connected camera to the transmitter (TX) on the monitor will be displayed.

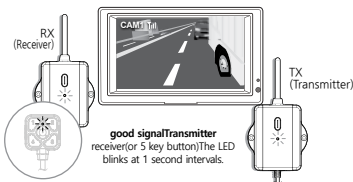

RX(1):TX(4) Multi pairing mode

To connect with another transmitter (TX), repeat the above steps to try wireless connection (Pairing), try wireless connection (Pairing) by repeating the above steps on the FULL screen.

※ RX(1):TX(1) (Auto pairing) mode LED color is 'red', RX(1):TX(4) (Multi-pairing) mode LED color is 'green'. If the LED color of the transmitter/receiver is different from the pairing mode to be used, press the corresponding transmitter/receiver button for more than 10 seconds to change the pairing mode before use.

1 WIRELESS CONNECTION STATUS DISPLAY LED

PAIRING MODE	LED COLOR	When entering pairing mode	wireless connection failure	good reception
RX(1):TX(1) / Auto pairing	Red	Flash rapidly	light on	Blinks at 1 second intervals
RX(1):TX(4) / Multi pairing	Green			

2 LOSS OF WIRELESS CONNECTION BETWEEN TRANSMITTER AND RECEIVER

If the wireless connection is temporarily disconnected, the wireless connection is established again according to each pairing mode.

1) RX(1):TX(1) Auto pairing mode (LED : Red)

For about 30 seconds, it searches for a nearby receiver (RX) or transmitter (TX) and performs automatic wireless connection (Auto pairing) with a nearby product. At this time, the connected product may not be the previously connected product.

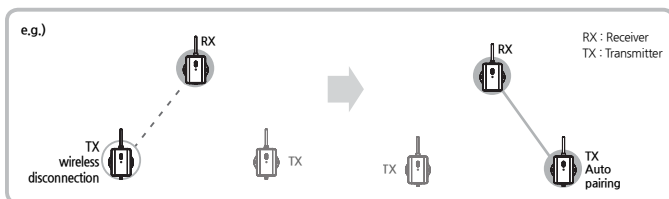

※ If auto pairing is not absolutely necessary, it is recommended to use RX(1):TX(4) multi-pairing mode.

2) RX(1):TX(4) Multi pairing mode (LED : Green)

If the product has already been connected wirelessly, it will reconnect to that product even if the connection is temporarily lost.

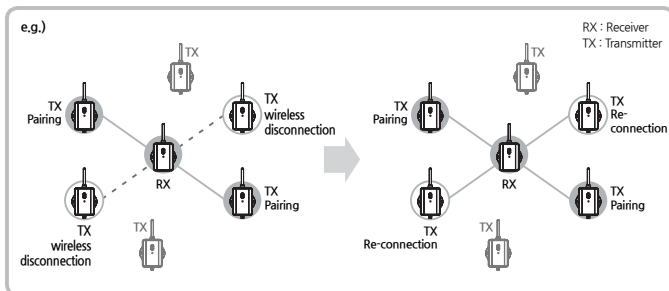

※ RX(1):TX(4) The multipair mode can be connected in (RX:TX) 1:1/1:2/1:3/1:4.

※ Only previously connected products can be reconnected.

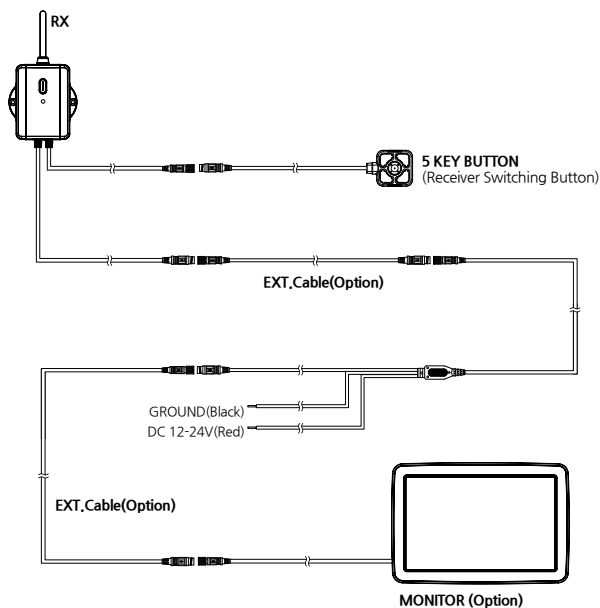
RX + Monitor (Option)

INSTALLATION

FREQUENCY	2400~2483.5MHz
FRAME RATE	30fps
TRANSMISSION RANGE	100m (Open field)
IP	69K
OPERATION TEMPERATURE	-20°C ~ 70°C
SUPPLY VOLTAGE	DC 24V / 300mA
SYSTEM LATENCY	120ms
DIMENSION (W X H X D)	87 X 94 X 25mm
WEIGHT	RX : 330g (w/o bracket)

* Design and Specifications are subject to change without notice.

* This device complies with part 15 of the FCC Rules. Operation is subject to the following two conditions:

- (1) This device may not cause harmful interference, and
- (2) this device must accept any interference received, including interference that may cause undesired operation.

MEMO

INSTRUCTION MANUAL