

# Cubitt Aura Pro 2

*User Guide*

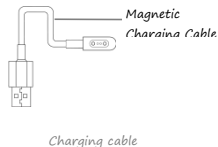

# Your Cubitt Aura Pro 2

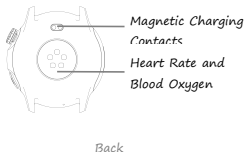

## Steps for Use

You can follow these steps to use Cubitt Aura Pro 2: ① Wear → ② Power On → ③ Set up → ④ Start Using

### ① Wear Your Watch

For optimal data accuracy, please observe the following guidelines while wearing the watch:

1. Wear the watch at a position approximately two finger-widths from your wrist bone.

### ② Power On

Press the Digital Crown until the startup screen appears.



## ③ Wear Your Watch

Step 1: Download the Cubitt Pro app.



Go to the app store on your phone, search for **Cubitt Pro**, and install it.

For Android phones, go to the Google Play.



You can also scan the QR code on the left to quickly go to the Cubitt Pro app in the app

Step 2: Pair with the App

Open the Cubitt Pro app and select "Set Up a Device" on the home page. Follow the instructions to pair your "Cubitt Aura Pro 2" Bluetooth. Then you can start using the **Attentions**:

1. To prevent connection issues between the app and the watch, please do not pair directly within the Bluetooth device list in your phone's system settings.



Search via Bluetooth



## ④ Get Started

Touchscreen Operation

Support full-screen touch (swipe, tap, touch and hold)



- ↑ Swipe up
- ← Swipe left
- Swipe right
- ↓ Swipe down

Crown and Button

**Press**

1. Press the digital crown to wake up the screen.
2. Press the digital crown to enter the app

**Rotate**

1. Scroll through interface views.
2. Adjust settings such as volume and



Rotate the crown

Back button

**Press the back button**

Press to return to the previous screen.

## Core Functions



### AI Voice Assistant

Swipe left on the page, tap the AI button, and try to start a conversation with it. Press the action button for 1 second to instantly activate the AI Voice Assistant.



### Routes

Sync routes via Cubitt Pro for offline route navigation. Tap the Route, or select a route in the settings of running or other outdoor workout modes to enable.



### Offline Music Playback

Sync music to your watch via Cubitt Pro; This device supports playing offline music via Bluetooth headphones or its built-in speaker.



### Workouts

Browse and select your favorite workouts from the training library. Create Workouts in the Cubitt Pro, sync to your watch to start training.

● 20-Minutes Fit Run

## Common Functions



### Notification Center

Swipe down on the watch face screen.



### Control Center

To access the Control Center, swipe up on the watch face screen. Enable features like Silent Mode, Sleep



### Tiles

To switch quickly between the Activity, Heart Rate, Sleep, Weather, or Workout tiles, swipe left or right on



### Change the Watch Face

To change the watch face, press and hold the screen for 1 second to



### Record Workouts

To start your workout recording, access the Workout app and select a specific workout.

For outdoor workouts, wait in an open area until the GPS connects. The blinking icon "📶" shows it's acquiring a location fix and will stop blinking upon success.



### Health Metrics Measurement

When wearing the watch, it automatically measures health data such as heart rate, sleep, stress, and activity. You can also view and

## Install New Watch Faces

In the Cubitt Pro app, navigate to the Face Gallery page to pick up your preferred watch face.



## Charge the Watch

To charge the watch, connect the charging cable to a USB power source. Attach the other end to the charging contact on the back of the watch. The watch will display a charging icon while it is being charged.



*Note:*

Make sure the USB charging plug is at the same side as the crown.

Ensure to use a standard USB power source with an output of 5V=1A or above.

Prior to charging ensure to clean the charging

## Charge the Watch

### Remove band

1. Lift the spring bar from the groove.
2. Push and hold the spring bar.
3. Pull it out gently to remove the band.

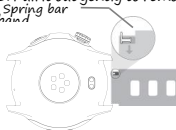

### Install band

1. Insert the metal pin at position "A" in the hole.
2. Push and hold the spring bar.
3. Press the band into the body and release the spring bar.

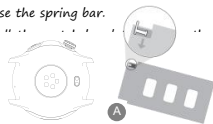

## Wear and Care

- It is advised to remove the watch for approximately one hour daily. If you experience discomfort or irritation like redness, tingling, or a burning sensation, take off the watch and rest your wrist.
- To maintain hygiene, regularly clean your watch and wrist, particularly after workouts and sweating. Avoid using hand soap,

## Design for Comfortable Wearing

The inner sweat grooves of the band are specifically designed to minimize skin irritation resulting from sweat, moisture, and prolonged wear.



<i>Model No.</i>	Cubitt Aura Pro 2
<i>Display</i>	1.48" HD AMOLED /1000nits/24-bit color
<i>Resolution</i>	480 x 480
<i>Battery Capacity</i>	450 mAh
<i>Wireless Connection</i>	Bluetooth 5.3
<i>Water resistance garde</i>	SATM
<i>Satellite positioning</i>	Support GPS\BDS\GAL\GLO\QZS
<i>Geomagnetic sensor</i>	Support compass
<i>Barometer sensor</i>	Supports altitude/barometer
<i>Ambient light sensor (ALS)</i>	Supports auto-brightness
<i>Temperature sensor</i>	Supports skin temperature



## Precautions

- Do not replace the built-in battery yourself as it may pose a safety risk.
- Avoid forcibly opening the watch case, as it may cause short circuits and overheating.
- Keep the watch away from environments exceeding 60°C to prevent battery leakage or explosion.
- While the product complies with SATM waterproof standards, it is not recommended for activities such as bathing, diving, or water skiing that involve high

## Product Manual

You can find the complete product manual in Cubitt Pro app at "Profile → User Guide".

Scan the QR code on the right to access it, or visit [help.CubittPro.com](http://help.CubittPro.com) to browse.



## FCC Requirement

Any changes or modifications not expressly approved by the party responsible for compliance could void the user's authority to operate the equipment. This device complies with Part 15 of the FCC Rules. Operation is subject to the following two conditions:

1. this device may not cause harmful interference, and
2. this device must accept any interference received, including interference that may cause undesired operation.

Note: This equipment has been tested and found to comply with the limits for a Class B digital device, pursuant to Part 15 of the FCC Rules. These limits are designed to provide reasonable protection against harmful interference in a residential installation. This equipment generates, uses, and can radiate radio frequency energy, and if not installed and used in accordance with the instructions, may cause harmful interference to radio communications. However, there is no guarantee that interference will not occur in a particular installation. If this equipment does cause harmful interference to radio or television reception, which can be determined by turning the equipment off and on, the user is encouraged to try to correct the interference by one or more of the following measures:

- Reorient or relocate the receiving antenna.
  - Increase the separation between the equipment and receiver.
  - Connect the equipment into an outlet on a circuit different from that to which the receiver is connected.
  - Consult the dealer or an experienced radio/TV technician for help.
- product's upgrade instructions.

## ISED

This device contains licence-exempt transmitter(s)/receiver(s) that comply with Innovation, Science and Economic Development Canada's licence-exempt RSS(s). Operation is subject to the following two conditions:

1. This device may not cause interference.
2. This device must accept any interference, including interference that may cause undesired operation of the device.

L'émetteur/récepteur exempt de licence contenu dans le présent appareil est conforme aux

CNR d'Innovation, Sciences et Développement économique Canada applicables aux appareils radio exempts de licence. L'exploitation est autorisée aux deux conditions suivantes :

1. L'appareil ne doit pas produire de brouillage;
2. L'appareil doit accepter tout brouillage radioélectrique subi, même si le brouillage est susceptible d'en compromettre le fonctionnement.