

Manage Your Light via Magic-Lantern App



Instructions for use

USB interface, you can connect it directly to the computer, or add an adapter and plug it into the socket.

Control buttons on the USB cable: controls light color, turn on/off the light.

QR code on the USB cable: Scan to download the smart app. With App control on your phone, you can more easily adjust the color, flash mode and brightness to your liking. For example: 1. Music Mode: Music mode will make the led mirror synchronously change color and beat with the

melody of the music, which is very suitable for music parties. 2. Timing

Function: Smart time the on and off of your personalized LED mirror to match your daily routine.

For more specific usage, please refer to the instructions in the app.

QR code: Scan to download the control app

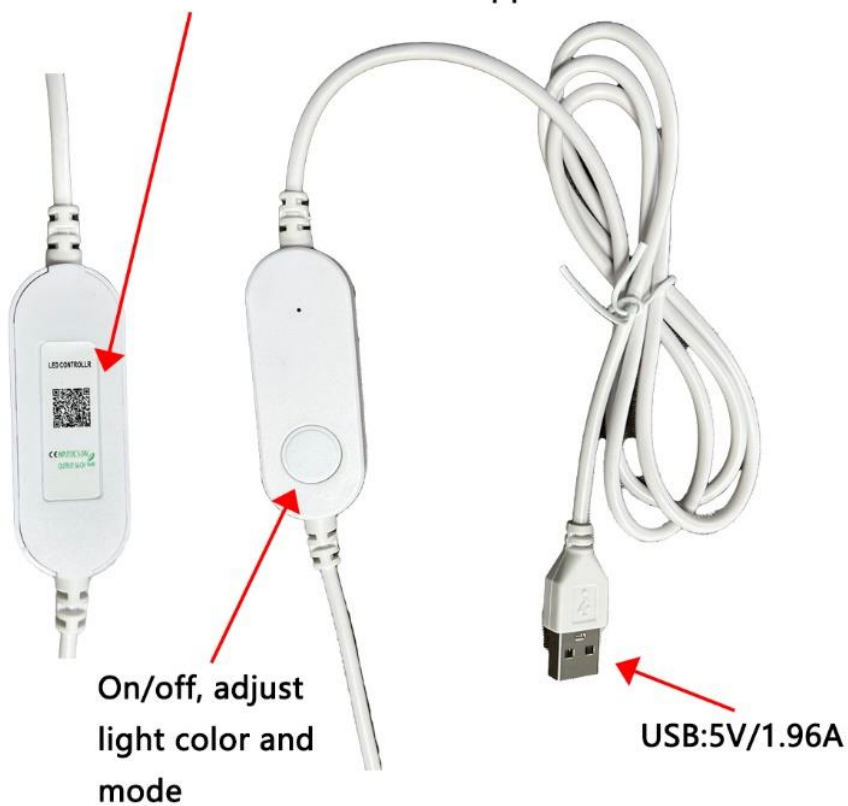

Working temperature: -20~60℃

Rated voltage: 5V/1.96A

Remote control distance: 8~15 meters

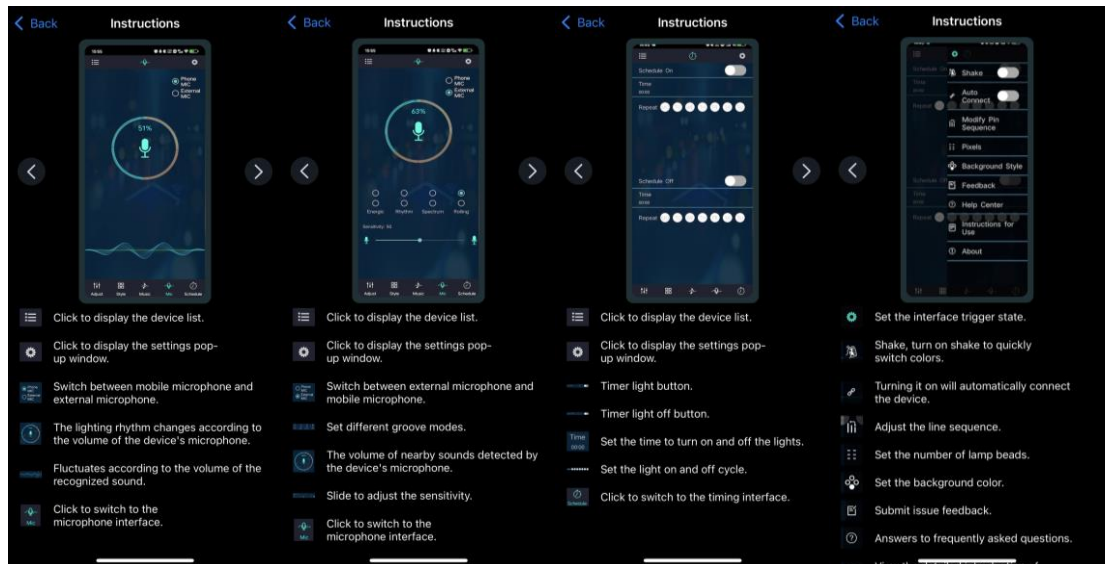
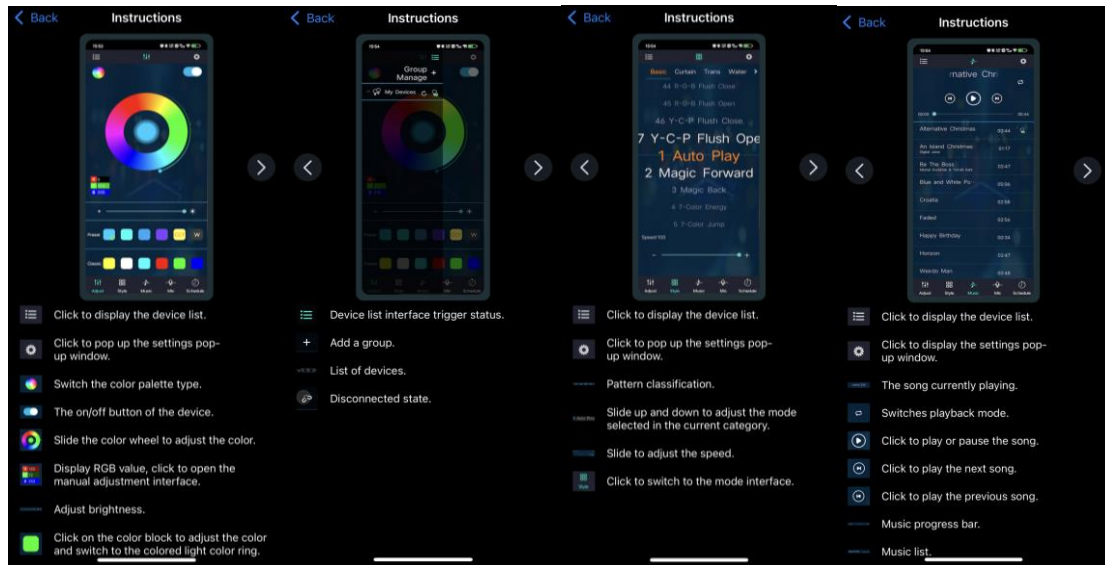

FCC Statement

This device complies with part 15 of the FCC rules. Operation is subject to the following two conditions: (1) this device may not cause harmful interference, and (2) this device must accept any interference received, including interference that may cause undesired operation.

Changes or modifications not expressly approved by the party responsible for compliance could void the user's authority to operate the equipment.

NOTE: This equipment has been tested and found to comply with the limits for a Class B digital device, pursuant to part 15 of the FCC Rules. These limits are designed to provide reasonable protection against harmful interference in a residential installation. This equipment generates uses and can radiate radio frequency energy and, if not installed and used in accordance with the instructions, may cause harmful interference to radio communications. However, there is no guarantee that interference will not occur in a particular installation. If this equipment does cause harmful interference to radio or television reception, which can be determined by turning the equipment off and on, the user is encouraged to try to correct the interference by one or more of the following measures:

- Reorient or relocate the receiving antenna.
- Increase the separation between the equipment and receiver.
- Connect the equipment into an outlet on a circuit different from that to which the receiver is connected.
- Consult the dealer or an experienced radio/TV technician for help.

The device has been evaluated to meet general RF exposure requirement. The device can be used in portable exposure condition without restriction.