

390Eyes Smart Camera
Product Manual



www.xiaoqiangiot.com

Scan the QR code above to download the "390Eyes" APP and complete the installation

Dear users, thank you for using the company's products, please read the operation manual carefully before using the company's products and save this manual for subsequent production examinations

YCLSMS320

390Eyes

1. Register and log in to the APP

- 1.1 Open the APP (as shown in Figure 1)
- 1.2 Click to register (as shown in Figure 2)
- 1.3 Follow the prompts to fill in the registration information(as shown in Figure 3) to complete the registration and login to the APP (as shown in Figure 4)

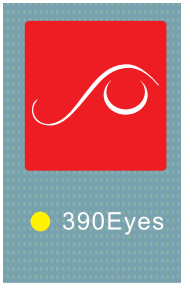

figure 1



figure2

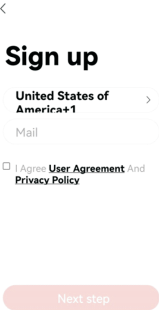

figure3

2. Add a camera

Method 1: Scan the code to add

- 1.1 Click the "+" sign at the top right of the home page (as shown in Figure 4)
- 1.2 Click the scan button in the upper right corner (as shown in Figure 5)
- 1.3 Scan the "PID QR code" on the camera (as shown in Figure 6)
- 1.4 Follow-up steps to be added, please ask the production test APP to prompt

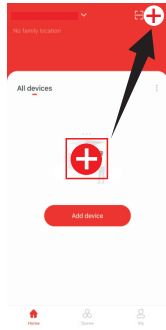

figure 4



figure5



figure6

Method 2: WiFi Camera (AP connection)

- 2.1 Click the "+" sign at the top right of the home page (as shown in Figure 7)
- 2.2 Click on WiFi Camera (AP connection) (as shown in Figure 8)
- 2.3 After entering the correct WiFi password, click "Next" (as shown in Figure 9)



figure7

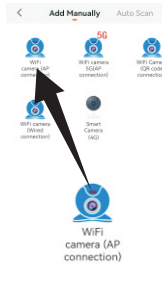

figure8

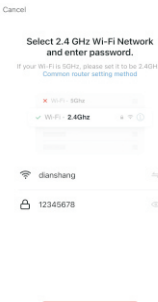

figure9

- 2.4 Power on the camera wait about 30s and click "Next" (as shown in Figure 10)
- 2.5 After heard "wait for connecting" Click next , if not , please reset the camera until you hear the prompt.(figure11)
- 2.6 Click "Go to Connect" (as shown in Figure 12)



figure10



figure11

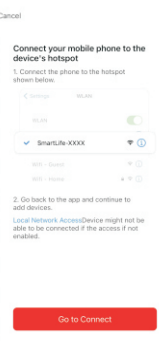

figure12

- 2.7 Connect the mobile phone WiFi which named "SmartLife" and return back to the APP (as shown in Figure 13)
- 2.8 The device is being added (as shown in Figure 14)
- 2.9 After jumping out of the successful addition page, click the "Done" button on the upper right to complete the addition (as shown in Figure 15)

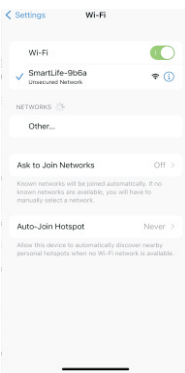

figure13

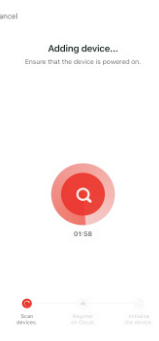

figure14



figure15

Method 3: Wired addition (this method requires the camera to have a network port)

- 3.1 Click the "+" sign at the top right of the home page (as shown in Figure 16)
- 3.2 Click WiFi camera (wired connection) (as shown in Figure 17)
- 3.3 Power on the camera wait about 30s and click "Next" (as shown in Figure 18)

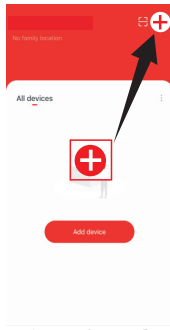

figure16

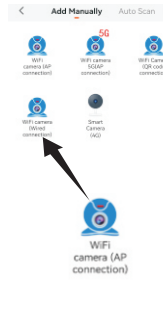

figure17



figure18

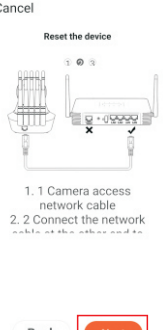

figure19



figure20

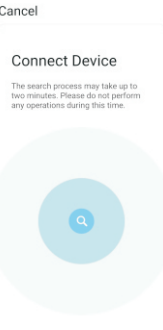

figure21

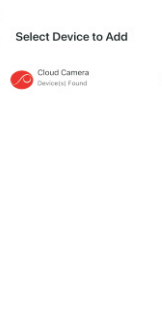

figure22

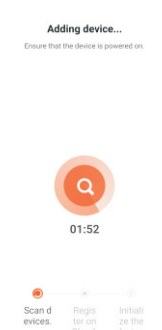

figure23

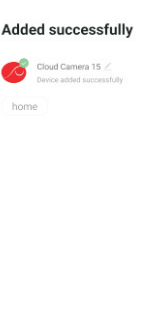

figure24

FAQ

- 1. Can two mobile phones be connected to one camera at the same time?
(A camera can only be added by one account, and multiple mobile phones can be viewed by sharing the device or logging in to the same account through multiple mobile phones)
- 2. Can I connect to the camera without WiFi?
(No, the camera needs to be connected to WiFi network to use)
- 3. Check the playback prompt "SD card not detected"?
(Check if the memory card is correctly inserted into the camera)
- 4. How to change the network connection?
(Long press the camera reset button until the "reset successful" is issued to restart and then connect)
- 5. The camera prompts to be offline?
(Check whether the WiFi network is normal, check whether the power supply is working properly)

warranty card

your name: _____

shoppingtime: _____

contact details: _____

cause of issue: _____

390Eyes

FCC WARNING

This device complies with part 15 of the FCC Rules. Operation is subject to the following two conditions: (1) this device may not cause harmful interference, and (2) this device must accept any interference received, including interference that may cause undesired operation.

Any changes or modifications not expressly approved by the party responsible for compliance could void the user's authority to operate the equipment.

NOTE: This equipment has been tested and found to comply with the limits for a Class B digital device, pursuant to Part 15 of the FCC Rules. These limits are designed to provide reasonable protection against harmful interference in a residential installation. This equipment generates, uses and can radiate radio frequency energy and, if not installed and used in accordance with the instructions, may cause harmful interference to radio communications. However, there is no guarantee that interference will not occur in a particular installation.

If this equipment does cause harmful interference to radio or television reception, which can be determined by turning the equipment off and on, the user is encouraged to try to correct the interference by one or more of the following measures:

- Reorient or relocate the receiving antenna.
- Increase the separation between the equipment and receiver.
- Connect the equipment into an outlet on a circuit different from that to which the receiver is connected.
- Consult the dealer or an experienced radio/TV technician for help.

To maintain compliance with FCC's RF Exposure guidelines, This equipment should be installed and operated with minimum distance between 20cm the radiator your body: Use only the supplied antenna.