

User Manual

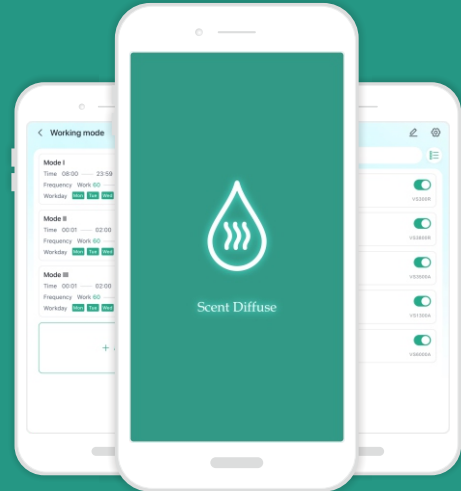

Before using this client, please carefully read the user manual and fully master how to operate quickly. If there are any uncertainties, please contact our company and do our best to provide you with comprehensive services.

◆ Download and install the app

- iOS users can search for the “Scent Diffuse” app in the app store to download and install it.
- Android users can search for the “Scent Diffuse” in the Google Play app store to download and install, or scan the QR code to download and install (password is “1”).

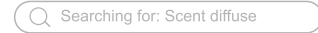

Android

◆ Log In or Sign Up

Click on “Scent diffuse” on the mobile desktop to enter the application, and a login page will pop up;

- Enter your phone number, email, and password, click on the “Account Login” to enter the homepage.
- “Bluetooth mode”, after Bluetooth connect with product, you can use Bluetooth to control the product.
- New users click the “Register Now” to enter the registration page and register a new user account according to the prompts.
- Users who have forgotten their password, click the “Forgot Password” to enter the reset password page and follow the prompts to reset a new password.

◆ Add device



· Bluetooth device connection

- Click the “Bluetooth” button on the homepage, or click the “Bluetooth Mode” button on the login page to enter the Bluetooth automatic search page;
- Select devices with prefixes named “VS”, “DiWi”, and “DW” from the search list to pair, click confirm to start Bluetooth pairing, and wait for Bluetooth connection to complete;
- After successful Bluetooth pairing, you will enter the device settings page.

Note: Keep your phone's Bluetooth turned on, network stable, and close to fragrance devices.



· Scan QR code connection

- Click on the “QR Code” button on the homepage to enter the QR code scanning page;
- Scan the QR code pasted on the device and add the device;
- After adding successfully, you will enter the device settings page.

◆ Device settings

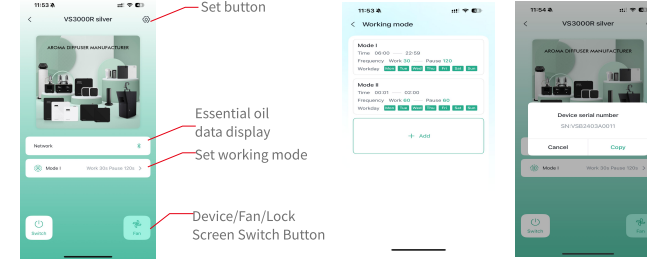

· Working Mode Settings

Click working mode to enter the mode setting page, where you can set up 5 working modes.

- Week setting: Select the desired working day for work;
- Time period setting: Set the start and end time of the device.
 - ① The start time can not be over than the end time;
 - ② Devices running across the early morning hours need to have two time slots set around 00:00.
- Equipment usage frequency setting: set the concentration of fragrance spray, and freely select the spray working time (s) and spray pause time (s);
- After entering the work mode information, click "Save" to complete the settings.

· Device Settings Description

Click the “Settings” button in the upper right corner to pop up a list of settings.

- Group setting: Devices can be grouped and set;
- Device information: The serial number of this device can be viewed;
- Device authorize: This device can be authorized through phone number, email number, and QR code;
- Modify nickname: View the working log of this device;
- Delete Device: This device name can be modified to make it easy to distinguish devices located in different areas;
- Delete device: This device can be deleted.

◆ Group management

· Add Group

- Click on the bottom navigation bar “Group” to enter the group page;
- Click on the “+” in the upper right corner to add a first level group, enter the name to complete the addition;
- Click on the name of the group to enter the group settings page;

· Group settings

- Add device: Add ungrouped devices to this group;
- Remove device: Move the device of this group to another group;
- Batch working mode: Set the grouped devices to a unified working mode data;
- Volume authorization: Authorize the devices of this group to others;
- set fragrance in bulk: Set the devices of this group to batch modify the fragrance name;
- Delete Group: Click “Delete Group” to delete this group.

◆ My personal center

- Click on the bottom navigation bar “User” to enter my page, click on the profile picture to enter the personal information page. Personal information can be modified by changing the profile picture, nickname, phone number, email, and password.
- Settings: APP related settings can be made. This includes clearing cache, modifying language, and clicking “Exit Account” to exit the app. Click “Cancel Account” to cancel the current account.
- Help and feedback: You can provide suggestions for the product or identify system issues through text and images. Click the submit feedback button to submit successfully.
- Authorization records: can view my authorization and the device records authorized to me;
- About us: View the version and user agreement.

This device complies with part 15 of the FCC Rules. Operation is subject to the following two conditions: (1) This device may not cause harmful interference, and (2) this device must accept any interference received, including interference that may cause undesired operation.

Any Changes or modifications not expressly approved by the party responsible for compliance could void the user's authority to operate the equipment.

Note: This equipment has been tested and found to comply with the limits for a Class B digital device, pursuant to part 15 of the FCC Rules. These limits are designed to provide reasonable protection against harmful interference in a residential installation. This equipment generates uses and can radiate radio frequency energy and, if not installed and used in accordance with the instructions, may cause harmful interference to radio communications. However, there is no guarantee that interference will not occur in a particular installation. If this equipment does cause harmful interference to radio or television reception, which can be determined by turning the equipment off and on, the user is encouraged to try to correct the interference by one or more of the following measures:

- Reorient or relocate the receiving antenna.
- Increase the separation between the equipment and receiver.
- Connect the equipment into an outlet on a circuit different from that to which the receiver is connected.
- Consult the dealer or an experienced radio/TV technician for help.

FCC Radiation Exposure statement

The device has been evaluatec to meel general RF exposure requirement. The device can be used in portable exposure condition without restriction.