

RoHS

Compatible

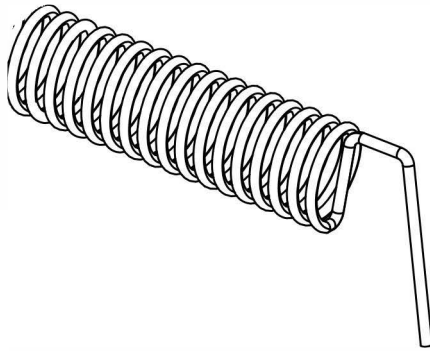
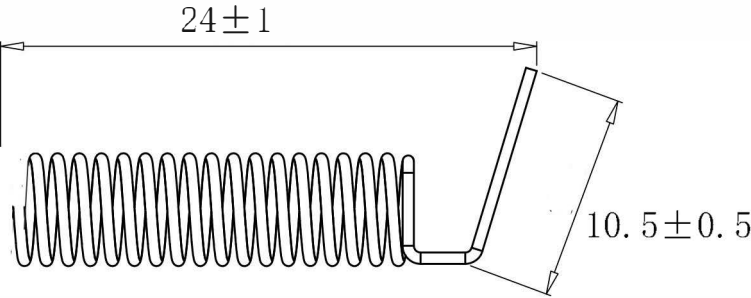
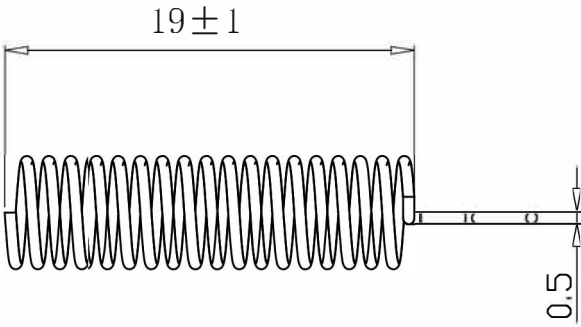
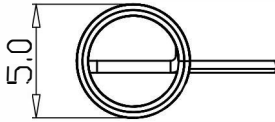

PART NAME:			MM/毫米
PART NO.:		C10	
APPROVED BY	CHECKED BY	DESIGNED BY	

Specification

A. Electrical Characteristics

S.W.R.(Tested in PC)	$\leq 2.0 @ 433.92\text{MHz}$
Typical Antenna Gain	$+3.0 \pm 0.7 @ 433.92\text{ MHz}$
Impedance	50 Ohm

B. Material

Material of Radiator	CU
Connector Type	N/A

C. Environmental

Operation Temperature	- 30 °C ~ + 85 °C
Storage Temperature	- 30 °C ~ + 85 °C

S.W.R. Testing Result

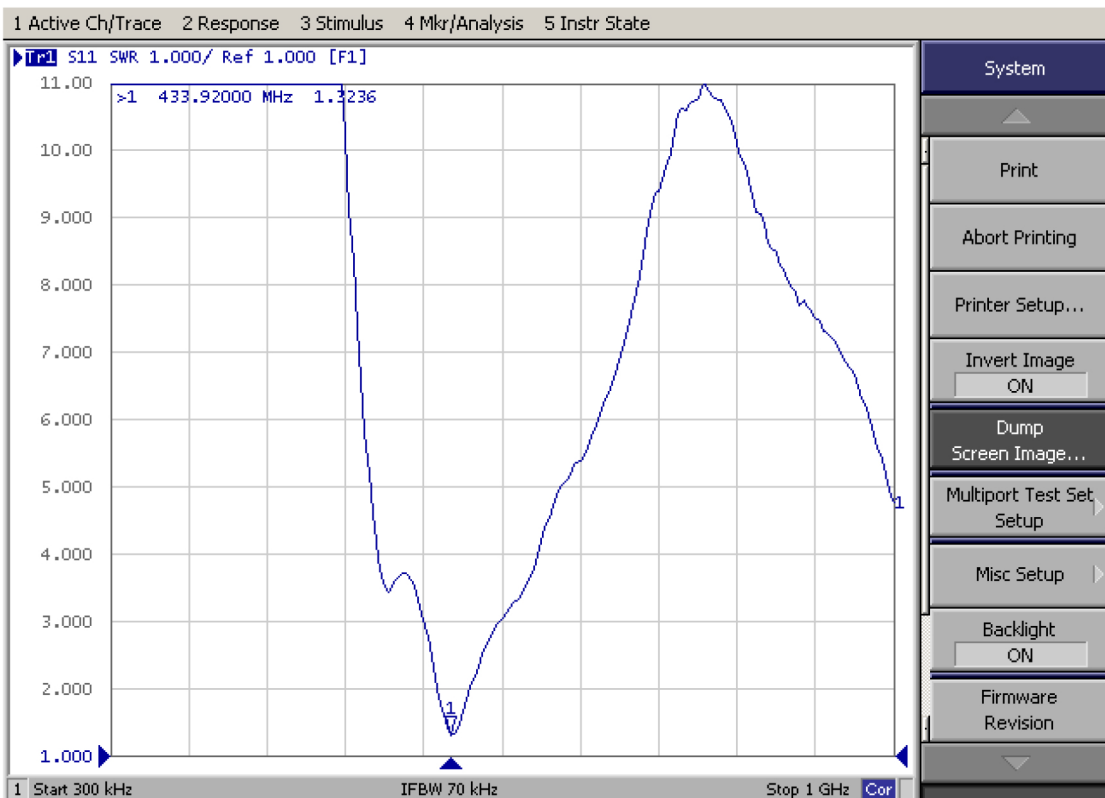

Antenna Radiation Pattern

Testing Equipment Specification:

Antenna Anechoic Chamber Dimension: 8 x 4 x 4 m

Quiet Zone: 600mm @1 GHz

Isolation: >100dB @ 1 MHz ~ 10 GHz

Testing Equipment: Agilent 5071B

Received Antenna: 0.7 ~ 6.0 GHz for Gain Calibration

Double Ridged Horn Antenna

