

PANCAKEXR
Virtual Reality All-In-One Headset
for PANCAKE 1C/PANCAKE 1

PANCAKEXR
Virtual Reality All-In-One Headset

User Guide

Please read this manual carefully before using the product
and keep it properly

Execution standard: GB8898-2011

What's in the box

Please check whether there are the following items in the box:

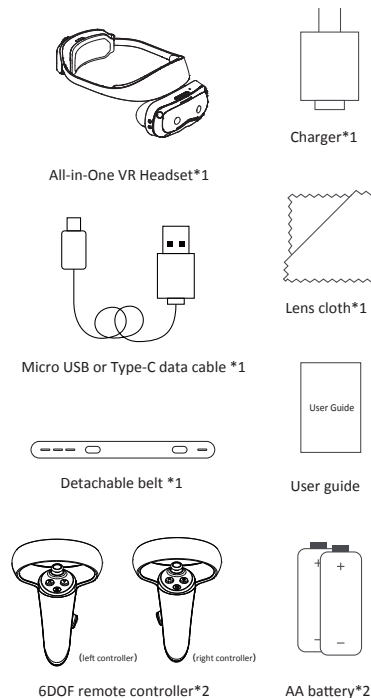

Components Overview

1.All-in-One VR headset

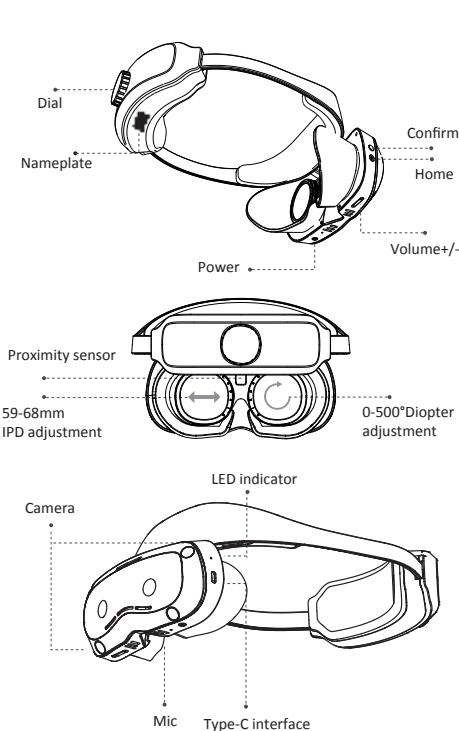

2.6DOF remote controller

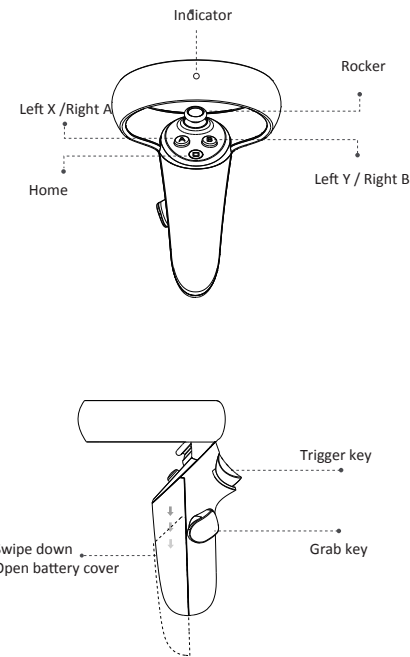

Basic Operation

1.instructions for key interface / Buttons of the headset

Headset interface	Operation description	
Power key	Long press Short press	Power On/Off Display On/Off
Confirm key	Short press	Confirm / Select (It does not take effect when the handle is connected)
Home key	Short press Long press	Opens launcher main menu Recenter the scene
Volume +/-	Short press Long press Double click	Volume +/- one level Maximum /Minimum volume Volume +/- two level

Note: Long press for 6 seconds to fast power off.
Long press for 10 seconds to hard reboot.

2.Instructions for Status indicator (LED) of the headset

Power on /off	Led Status description
Power on (Power>20%)	Flashes fast 1s,blue light
Power on (Power<20%)	Flashes fast 3s,red light
Power off	Flashes fast 1s,red light

Headset indicator status	Status description
Green light	The current power is >90%
Blue light	Power is between 20-90%
Red light	Power is less than 20%
No light	Screen off & battery is deep discharged and enters the precharge state Flashing red light - in charging

Data cable interface status	Status description
Plug/unplug USB cable	Blue light flashes fast for 3 seconds

3. Headset connector interface description

Headset interface	Operation description
Type-C interface	Charging/ data transfer

4.Controllers Interface description

Contrst keys (Right)	Operation description	
Trigger key	Short press	Confirm
Home key	Short press Long press	Brings up Home menu Recenter Headset view
Grab key	Long press	Performs grab action or makes a fist when using virtual hands.
X Button	Short press	Selects object in the enviornment.
Y Button	Short press	Returns you to previous screen or menu

Contnest keys (left)			Operation description
Trigger key	Short press	Confirm	
Home key	Short press Long press	Brings up Home menu Recenter Headset view	
Grab key	Long press	Performs grab action or makes a fist when using virtual hands.	
A Button	Short press	Selects object in the enviornment.	
B Button	Short press	Returns you to previous screen or menu	

Product parameters

Name	Pancake All-in-one VR Headset
Model	CVR-655-128C
CPU	Qualcomm XR2,8 cores 64 bit
System	Android 12
Resolution	1920*1920
Storage	8G+128G
Fov	95°~105°
PPI	1058
Wireless network	Wi-Fi 6
Lens	Pancake
Fast charge	QC 3.0
Battery	5500mAh
Accessories	headset, controllers, fast charge, user guider, Type-C data cable
VST	support

Important Notice

In order to protect you and others from injury or protect your equipment from damage, please read the following safety information before using the device.

1. Only use the equipment for its intended purpose.

2. It is recommended to be used in environments within temperatures ranging -10°C~35°C and humidity <80%.

3.Battery (battery packs or combination batteries) should not be exposed to such conditions as sunshine, fire or similar overheating.

4. Do not use it in any environments with chemical or flammable gases, long-time high temperature and humidity, containing gases and dust that is sufficient to corrode metals and destroy insulation, containing explosive hazards or other abnormal conditions.

5. It is recommended to take a proper rest after 30 minutes of use. Please stop using it immediately, if you feel any discomfortable in physically.

6. It's recommended that those with abnormal physical conditions (including but not limited to pregnant women, the elderly, binocular vision abnormalities, heart disease patients, psychiatric patients) consult a doctor before deciding whether to use it.

7.This device is not specially designed for children. Children under 14 years old should use it under the supervision of adults. If negative effects are found, stop using it immediately. Adults should also ensure that children under 14 years old not to use this device for a long time.

8.When using this device, please make sure that the area around is safe. Make sure that there are no other people, furniture, fixtures and other obstacles in the using area. Do not use this device near stairs, windows, balconies, heat sources or other objects that may cause danger.

9. Do not connect USB data cable while wearing this device.

10. The device can transmit radio waves that may interface with the operation of nearby electronic devices. If the user wears a heart pacemaker or any other implantable medical device, please consult a doctor or a medical device manufacturer before deciding whether to use it.

11. Do not use this device with high volume for a long time to avoid hearing damage.

12. Avoid lens contacting with hard and sharp objects when using, use matching soft cloth and water to wipe, do not use organic solvent to wipe.

13. Please pay attention to the correct placement method, the wrong placement method can easily lead to strong light damage to the screen.



14.If the device is overheated due to prolonged use, it may cause interface drift. Please long press the enter key for correction.

15. Only suitable for safe use in non-tropical climate conditions.

16.Warnings: disposal of a battery into fire or a hot oven, or mechanically crushing or cutting of a battery, that can result in an explosion; leaving a battery in an extremely high temperature surrounding environment that can result in an explosion or the leakage of flammable liquid or gas; and a battery subjected to extremely low air pressure that may result in an explosion or the leakage of flammable liquid or gas.

17. Transport and storage within the temperature range from -20 ℃ to 60 ℃, and can withstand short-term transportation and storage at the temperature up to 70 ℃,yet no more than 24h.

18. The device has been evaluated to meet general RF exposure requirement.

FCC Statement

This equipment has been tested and found to comply with the limits for a Class B digital device, pursuant to part 15 of the FCC rules. These limits are designed to provide reasonable protection against harmful interference in a residential installation. This equipment generates, uses and can radiate radio frequency energy and, if not installed and used in accordance with the instructions, may cause harmful interference to radio communications. However, there is no guarantee that interference will not occur in a particular installation. If this equipment does cause harmful interference to radio or television reception, which can be determined by turning the equipment off and on, the user is encouraged to try to correct the interference by one or more of the following measures:

- Reorient or relocate the receiving antenna.
- Increase the separation between the equipment and receiver.
- Connect the equipment into an outlet on a circuit different from that to which the receiver is connected.
- Consult the dealer or an experienced radio/TV technician for help. To assure continued compliance, any changes or modifications not expressly approved by the party. Responsible for compliance could void the user's authority to operate this equipment. (Example- use only shielded interface cables when connecting to computer or peripheral devices).

This equipment complies with Part 15 of the FCC Rules.

Operation is subject to the following two conditions:

- (1) This device may not cause harmful interference, and
 - (2) This device must accept any interference received, including interference that may cause undesired operation.
- The device has been evaluated to meet general RF exposure requirement.

Statement of Hazardous Substances

Accessory	Pb	Hg	Cd	Cr6+	PBB	Pbde
Headset	×	○	○	○	○	○
Cable components	×	○	○	○	○	○
Power adapter	×	○	○	○	○	○
Plastic polymer	○	○	○	○	○	○
Metal accessory	×	○	○	○	○	○

This form is prepared in accordance with the provisions of the SJ/T11364 standard.

○ : It indicates that the contents of the harmful substance in all homogeneous materials of the component should be limited below according to GB/T26572 .

× : It indicates that the toxic or hazardous substance contained in at least one of the homogeneous materials of the part exceeds the limit requirement specified in GB/T26572.

This form shows the information on hazardous substances contained in the headset. The information on hazardous substances for parts are prepared based on the information provided by suppliers and the results of internal inspections. The harmful substances contained in some parts cannot be replaced under the current technical level, and our company is making unremitting efforts to make it possible to replace them.

5 The numbers in this logo indicate that the environmental protection use period of the product under normal use is 5 years. Some parts may have an environmental protection use period mark, and the environmental protection use period is subject to the number in the mark. Due to different models, the product may not contain all the above components except the host, and its environmental protection label also be changed in the service life, please refer to the actual sales configuration of the product.



If you want to know more about Pancake XR, give us your feedback or cooperation,

please visit our website: <https://www.pancakexr.com/>

After-sales service: info@pancakexr.com

Customer Service Hotline: 0755-26010936

Manufacturer:

SHENZHEN SKYWORTH NEWWORLD TECHNOLOGY CO., LTD

Address: Room A508, Skyworth Building, Gaoxin South 1st Road, Nanshan District, Shenzhen, China 518000

Date: 08/20/2022

