

105G双铜，双面印刷，风琴折，成品尺寸：70x100MM

Portable Bluetooth Speaker

Simplicity
from precision machining



Precautions

- ★The radio function is not applicable to the products in Europe, Canada and the United States.
- ★The waterproof grade is ipx5. Please do not immerse the product in water.
- ★When the battery is low, the product will send out a sound of "Dong Dong Dong". Please charge it.



Product instruction:

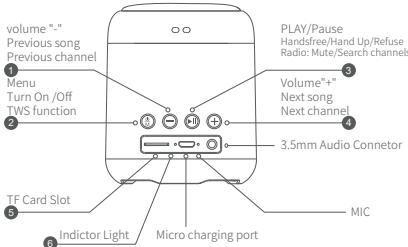

- ① Short press to the previous song;long press volume down; when in Radio mode, shot press to previous channel
- ② Long press 3s to power on/off ;short press transfer to (TF Card Memory, Radio or Bluetooth) function ; If it is powered off,it will be "Reset" after long press 10s
- ③ Short press: play/pause/handsfree/hand Up; Long press (1s) :refuse the phone call When in Radio mode,short press to mute the speaker, long press to search for channels



- ④ Short press to next song;long press volume up.When in the radio mode, short press to next channel
- ⑤ TF card Slot
- ⑥ Led indictor light
Turn on : when blue light flashes,it will turn to the Bluetooth mode. The blue light will be bright constantly when it is connected successfully.
Music play: Blue Light slowly flashes
Charging:Red light bright
In radio mode, the blue light will flash.



TWS Function:

After the two speakers are turned on,press one of the "①③"buttons twice,and the speaker will find another pair.After the pairing as retained,a brisk tone was found. At this point,connect Bluetooth to play music together.



Specifications

Bluetooth version :	5.1
Working distance:	≥10 meter
Working voltage:	3.7V
Input voltage:	DC 5V==2A
Battery capacity:	1200mAh lithium polymer
Battery voltage:	3.7V
TF card:	Support (up to 32G)
Weight :	± 285g
Dimensions:	89*75mm

- 1.The working time of the speaker varies depending on the music type or volume played.
- 2.The speaker will turn off automatically if you leave bluetooth unconnected after turning on over about 5 minutes.

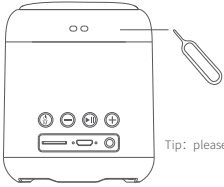

Tip: please thread the line with the attached pin

Warranty Service

Please read the following terms carefully to protect your rights.
You are ensured to have our best after sales service

1. Free return/exchange conditions
 - The appearance/function does not meet your expectations within 30 days from the date of purchase
 - Any quality problems of the products within 12 months from the date of purchaseIn the above cases, please email Sanag Customer Service Team and we will provide a solution within 24 hours.

2. How to contact us?
 - ①: Please click the store name on the product page, then click [Ask a question](#) button to contact us.
 - ②: [Account Service] - [Order History] - [Contact Seller]

3. After-sales service cannot be provided even under the warranty period under the following conditions.
 - ① Damage caused by personal reasons:
 - Product failure due to improper repair or storage
 - Product failure due to self-demolition or repair
 - ② Product failure by force majeure (fire, flood, earthquake and so on)

FCC Statement

This device complies with part 15 of the FCC Rules. Operation is subject to the following two conditions: (1) This device may not cause harmful interference, and (2) this device must accept any interference received, including interference that may cause undesired operation.

This equipment has been tested and found to comply with the limits for a Class B digital device, pursuant to part 15 of the FCC Rules. These limits are designed to provide reasonable protection against harmful interference in a residential installation. This equipment generates, uses and can radiate radio frequency energy and, if not installed and used in accordance with the instructions, may cause harmful interference to radio communications. However, there is no guarantee that interference will not occur in a particular installation. If this equipment does cause harmful interference to radio or television reception, which can be determined by turning the equipment off and on, the user is encouraged to try to correct the interference by one or more of the following measures:

- Reorient or relocate the receiving antenna.
- Increase the separation between the equipment and receiver.
- Connect the equipment into an outlet on a circuit different from that to which the receiver is connected.
- Consult the dealer or an experienced radio/TV technician for help.

Caution: Any changes or modifications to this device not explicitly approved by manufacturer could void your authority to operate this equipment.

RF Exposure Information

The device has been evaluated to meet general RF exposure requirement. The device can be used in portable exposure condition without restriction.