

105

Package List

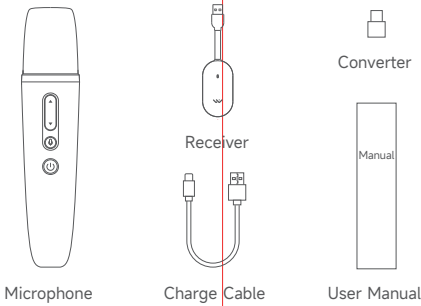

Guide for Keys and Indicators

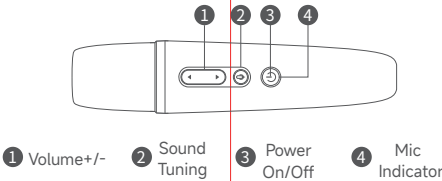

Microphone Indicator

Solid Blue	Normal Working Mode
Flashing Blue	Pairing Mode
Solid Red	Low Power
Flashing Green	Charging Status

Receiver Indicator

Solid White	Receiver is working and connected to microphone
Quick Flashing White	Receiver and microphone pairing in progress
Slow Flashing White	Receiver and microphone not connected

Operation Instruction

Power On and Connecting Steps

1. Insert the receiver into the USB-A Data port located in the car's Glove Cabin (or use the USB-C converter if your vehicle has a USB-C Data port).
2. The receiver's white indicator light to flash slowly.
3. Press the microphone power button, and the blue indicator light will turn on while the receiver's white light turns solid white.
4. Open any karaoke app on the car and start singing.

Note: Make sure to place the receiver in an open area to avoid any obstruction that may affect its performance.

Power Off Steps

1. Press and hold the power button for more than 2 seconds until the indicator light goes off, indicating that the microphone is powered off.
2. Remove the receiver from the car.

Charging

Use another product's charger (5V==1A) and insert one end of the provided charging cable into the charger and the other end into the bottom of the microphone. The microphone's indicator light will start flashing green, indicating that it is charging normally. When the indicator light turns solid green, it means that the microphone's battery is fully charged.

Pairing

Note: The microphone is already paired during manufacturing, so please refrain from pairing it again unless necessary. Users may need to perform a pairing operation only when the microphone and receiver fail to connect (as indicated by the following situations):

The microphone is turned on, the receiver's indicator flashes slowly, and there is no sound from the microphone. If unplugging and plugging in the receiver does not solve the issue, users can try to perform a pairing operation.

Pairing Procedure

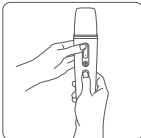

Step 1
With the receiver plugged in and the microphone is off state, long press the "Volume+" and "Power" Keys simultaneously for over 8 seconds, the mic indicator light flashes, entering pairing mode.

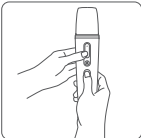

Step 2
(For 2-mic version)With the second microphone off, long press "Volume=" and "Power" keys simultaneously for over 8 seconds until the mic indicator light flashes, into the pairing mode.
(Microphone close to the receiver within half a meter, there should be no obstructions between them)

MUSIC
TRAVEL
LOVE

Shanghai LvDong Technology Co., Ltd.
1st Floor, Building 2, No. 18 Fangsi
Road, Songjiang District,
Shanghai,China.

35

315

105

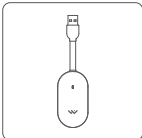

Step 3
Re-plug the receiver and wait for the receiver indicator light blinks fast.

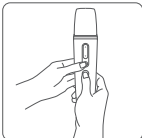

Step 4
Press the "Sound Tuning" and "Power" Keys at the same time to exit the pairing mode. (The second mic doing the same)

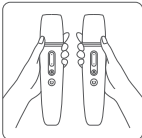

Step 5
Once the microphone and receiver indicators stay on, pairing is complete and ready for normal use.

Firmware update

If Tesla firmware updates cause microphone sound issues for mic is available, download the "MicAssistant" app from Google Play or Apple Store. Follow these steps:

1. Connect the receiver to your Tesla.
2. Enable Bluetooth on your phone.
3. Keep your phone and receiver within 0.5 meters; scan for receiver operations.
4. Open "MicAssistant" and choose Firmware or Config Updates.
5. After updating, unplug and reconnect the receiver, then test functionality.

Ensure

1. Please avoid exposing this product to high temperatures or damp environments to prevent malfunctions.
2. If the product is not used for a long period of time, please remember to charge it promptly to avoid affecting the battery life.
3. The product has been paired during manufacturing and can be used directly. Unless necessary, please refrain from performing pairing operations again, as it may result in malfunctioning.

Guide for Common Problems

Mic power indicator light does not turn on
Check if the battery level is too low and charge it promptly.

Mic has no sound

1. Check if the mic is turned on with a solid indicator light.
2. Check if the receiver is properly connected to the car Type-C or USB A port.
3. If the mic is already turned on, check if the receiver's indicator light is solid. If it is flashing, refer to the pairing process for further instructions.

Mic Volume Too Low

1. Ensure the microphone is powered on and press the volume button to set it to the highest level.
2. Set the Tesla's master volume to maximum (tap the MIC icon and adjust the music volume to the highest setting).
3. In the Karaoke App (e.g., Stingray/TJ Media), separately adjust the Music and Mic volumes in the app's sound settings.

Names and contents of hazardous substances in the device

Part name	Hazardous substances					
	Pb	Hg	Cd	Cr+6	PBB	PBDE
PCB component	×	○	○	○	○	○
Plastic part	○	○	○	○	○	○
Metal part	×	○	○	○	○	○
Connection cable	×	○	○	○	○	○

This form is compiled according to Directive on Restricting the Use of Certain Hazardous Substances in Electronic and Electrical Equipment (Restriction of Hazardous Substances).

○: indicates that the content of the hazardous substance in all homogeneous materials of the part is below the specified limit requirements.
×: indicates that the content of the hazardous substance in at least a homogeneous material of the part exceeds the specified limit requirements.

Note: The device applies the concept of environmental protection design and effectively controls the hazardous substances. The hazardous substances indicated by "×", mainly hampered by the level of technical development, cannot be replaced by other viable substances.

Environmental protection service life

Identification refers to the period (ten years) during which harmful substances in electronic and electrical products will not leak or mutate under normal use conditions, and the user's use of the electronic and electrical product will not cause serious pollution to the environment or cause serious damage to their personal and property.

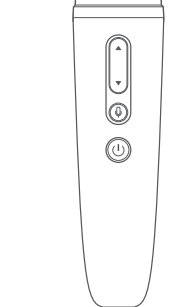

MUSIC
TRAVEL
LOVE

35

315

Antenna type: PCB antenna

Antenna gain: -1.38dBi

Operating frequency band: 657.5MHz-662MHz

the product check a white-space database to determine available channels prior to operation at a given location.

FCC Statement

Any Changes or modifications not expressly approved by the party responsible for compliance could void the user's authority to operate the equipment.

This device complies with part 15 of the FCC Rules. Operation is subject to the following two conditions:

- (1) This device may not cause harmful interference, and
- (2) This device must accept any interference received, including interference that may cause undesired operation.

RF warning for Portable device:

The device has been evaluated to meet general RF exposure requirement. The device can be used in portable exposure condition without restriction.

Note : This equipment has been tested and found to comply with the limits for a Class B digital device, pursuant to part 15 of the FCC Rules. These limits are designed to provide reasonable protection against harmful interference in a residential installation. This equipment generates,uses and can radiate radio frequency energy and, if not installed and used in accordance with the instructions, may cause harmful interference to radio communications. However, there is no guarantee that interference will not occur in a particular installation. If this equipment does cause harmful interference to radio or television reception, which can be determined by turning the equipment off and on, the user is encouraged to try to correct the interference by one or more of the following measures:

- Reorient or relocate the receiving antenna.
- Increase the separation between the equipment and receiver.
- Connect the equipment into an outlet on a circuit different from that to which the receiver is connected.
- Consult the dealer or an experienced radio/TV technician for help.