

# Artome Remote Controller User Guide



**Basic Operations**

**Common Issues and Solutions**

**Initial Pairing Instructions**

**Battery Replacement Instructions**

**Specifications**



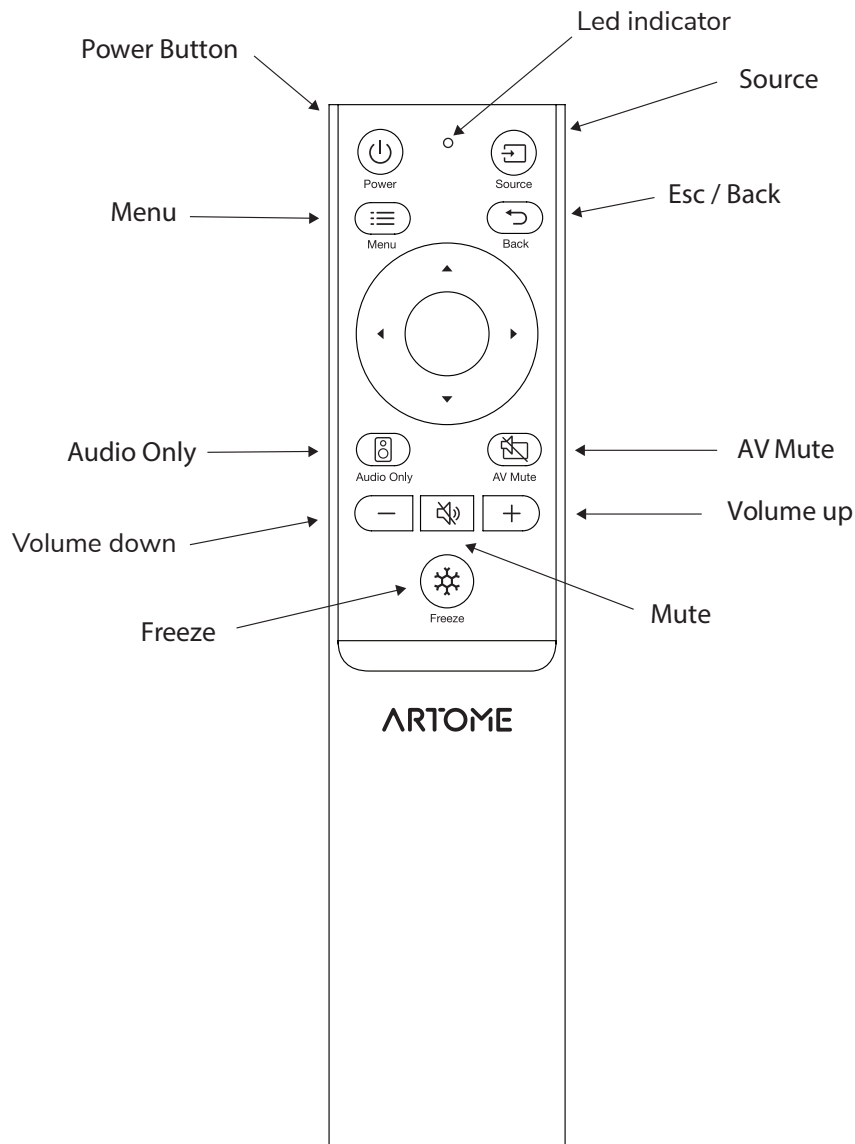

### Basic Operations:

<b>Power On/Off</b>	Use the power button to turn the Artome unit on or off.
<b>Source</b>	Select the input source.
<b>Menu</b>	Access the Epson menu.
<b>Esc / Back</b>	Go back or exit the current Epson menu.
<b>Volume Control</b>	Adjust the volume using the + and - buttons.
<b>Freeze</b>	Freeze the video while allowing the audio to continue.
<b>Audio Only</b>	Switch to audio-only mode.
<b>AV Mute</b>	Press the AV Mute button to mute both audio and video.

## Introduction

The Artome unit can be conveniently controlled using a remote controller. This remote communicates with the Artome unit via Bluetooth. Only one remote controller can be connected to an Artome device at a time. The remote controller should not be replaced unless it is lost or damaged. The remote controller is already paired with the Artome unit at the factory, so the user does not need to pair it again.

## Common Issues and Solutions

<b>Artome not powering on with the first press of a button:</b>
If the remote and Artome haven't communicated recently, the first button press will be lost as the remote initiates a connection. This takes about 1 second. Subsequent presses will be registered. If the Artome unit is always powered, the remote keeps the connection open, eliminating delay.
<b>Remote Controller Not Working:</b>
Ensure the batteries are properly inserted to the remote and have sufficient charge.
Ensure the Artome unit is plugged into the power socket.
Ensure the Artome unit is functioning by pressing the buttons on the unit itself
If the remote controller is set into pairing mode again by pressing the <b>Audio Only</b> and <b>AV Mute</b> buttons for 5 seconds, the remote will erase its pairing information and attempt to create a new connection. This will fail. To resolve this, set the remote into pairing mode again by pressing the <b>Audio Only</b> and <b>AV Mute</b> for 5 seconds. After this second pairing attempt, the remote will start working again.

*Note: If the Artome unit has been updated or reset to factory settings, the remote controller may need to be paired again. Follow the initial pairing instructions to perform the pairing. If this does not resolve the issue, contact customer support.*

## Initial Pairing Instructions (After factory reset)

### Set Artome unit in Pairing Mode:

Press and hold the **Pause** button on the Artome unit for 2.5 seconds. The Pause LED will flash, indicating that the Artome is in pairing mode and ready to listen for advertising remote controllers.

### Set the Remote Controller in Pairing Mode:

Press and hold both the **Audio Only** and **AV Mute** buttons on the remote controller simultaneously for about 5 seconds. Once the remote controller is connected to the Artome, the **Volume +** and **Volume -** LEDs on the Artome unit will illuminate for 2 seconds.



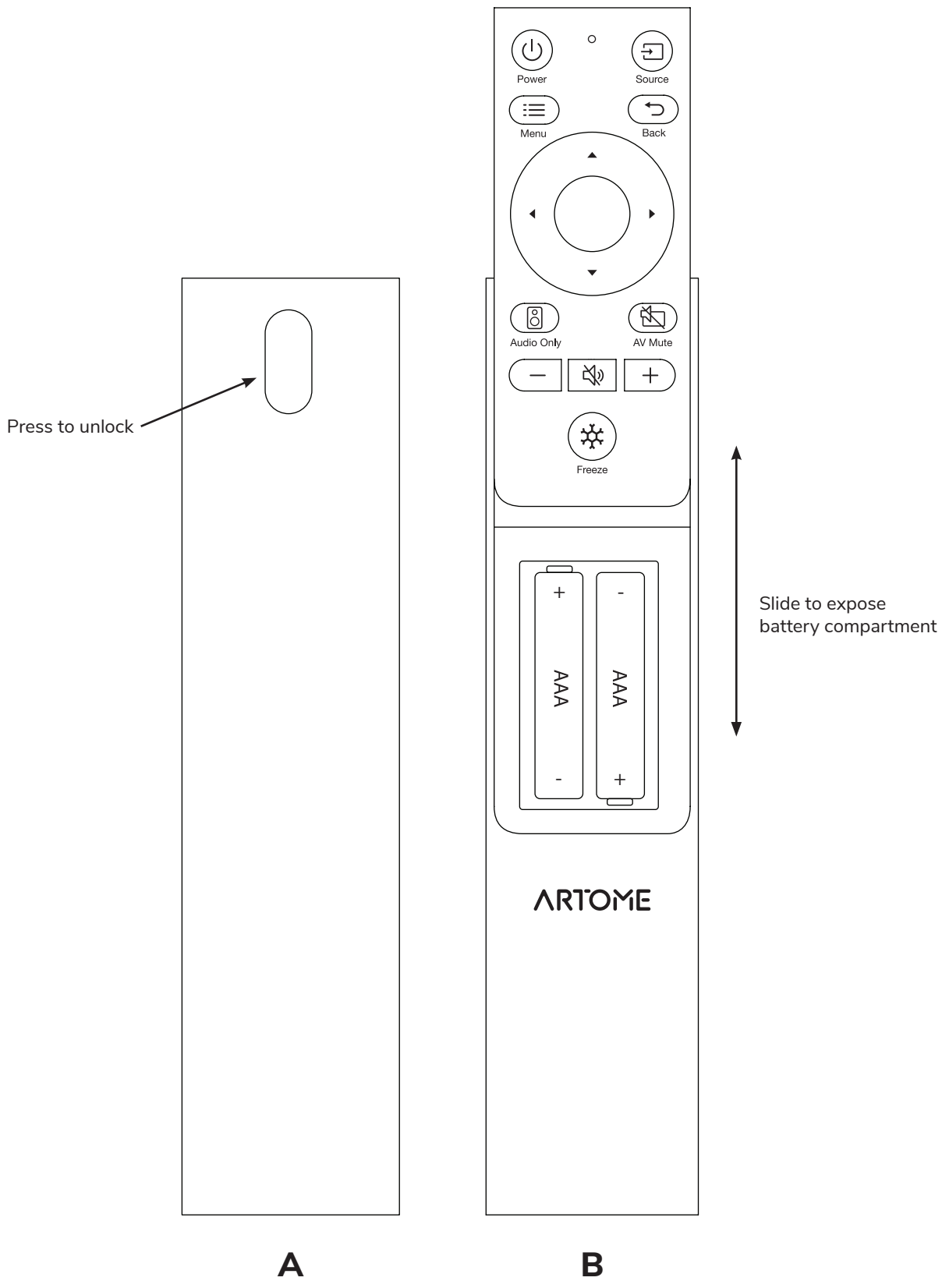

# Battery Replacement Instructions

To ensure your Artome remote controller functions correctly, you may need to replace the batteries periodically. Follow the steps below to replace the batteries.

### Locate the Button to Open the Remote

On the backside of the remote (image A), find the button and press it firmly to release the back cover of the remote. Once the button is pressed, slide the back cover down to expose the battery compartment.

### Remove Old Batteries and Insert New Batteries

Take out the old AAA batteries from the battery compartment. Insert two new AAA batteries, ensuring that the positive (+) and negative (-) ends are aligned correctly as indicated in the image B.

### Replace the Back Cover

Slide the back cover back into place until it clicks securely.

### Test the Remote

Press any button on the remote to ensure it is working correctly.

# Specifications

Feature	Specifications
Material	Aluminum and plastic, silicone buttons
Width	1.42 inches (36 mm)
Height	6.26 inches (159 mm)
Thickness	0.51 inches (13 mm)
Connectivity	Bluetooth
Power Source	Two AAA batteries (included)
Range	Approximately 32-39 feet (10-12 meters)
Features	LED indicator
Compatible Products	Artome S1, Artome M10, and Artome X20



## FCC Compliance

Unique identifiers: FR602

FCC ID:2BNPQ-FR602

Responsible Party:

Street address:

31101 Wiegman road

Hayward CA 94544

Tel. (619) 436 9131

contact@artomeusa.com

FCC Caution :

This device complies with part 15 of the FCC Rules. Operation is subject to the following two conditions: (1) This device may not cause harmful interference, and (2) this device must accept any interference received, including interference that may cause undesired operation.

Any Changes or modifications not expressly approved by the party responsible for compliance could void the user's authority to operate the equipment.

Note: This equipment has been tested and found to comply with the limits for a Class B digital device, pursuant to part 15 of the FCC Rules. These limits are designed to provide reasonable protection against harmful interference in a residential installation. This equipment generates uses and can radiate radio frequency energy and, if not installed and used in accordance with the instructions, may cause harmful interference to radio communications. However, there is no guarantee that interference will not occur in a particular installation. If this equipment does cause harmful interference to radio or television reception, which can be determined by turning the equipment off and on, the user is encouraged to try to correct the interference by one or more of the following measures:

- Reorient or relocate the receiving antenna.
- Increase the separation between the equipment and receiver.
- Connect the equipment into an outlet on a circuit different from that to which the receiver is connected.
- Consult the dealer or an experienced radio/TV technician for help.

The device has been evaluated to meet general RF exposure requirement. The device can be used in portable exposure condition without restriction.

