

尺寸:60*110mm

Vibrating egg

10 vibration modes + wireless remote control



Gourd

Effie

Aid



— User's Guide —

Cleaning, Storage and Safety

Please clean it with neutral soap and water before and after each use (it is recommended to use a special cleaner for sex toys), then wipe it gently with a dry non-woven cloth or towel, and then let it air dry until it is completely dry. Finally, store this product in a cool, ventilated, and dry place until next use.

- Do not use alcohol, gasoline or acetone cleaners.
- Do not put the product directly into the boiling water pot.
- Please avoid direct sunlight and never expose the product to high temperatures.

Package list

1 pcs × Product 1 pcs × Remote control
1 pcs × USB Charging Cable 1 pcs × User Manual

Product Specifications

Name	Gourd Egg	Effie	Aid
Model	HB009	HBB329	HBB17-5
Size	33*85mm	82*29*29mm	82*34*34mm
Color	Red/Purple/Blue	Pink	Pink/Red/Purple

Material	Silicone+ABS	Waterproof	Life waterproof
Usage	Masturbate, Flirt	Max noise	≤60dB
Power supply	USB charging	Rated current	200mA
Charging time	40 minutes	Rated voltage	3.7 V
Usage time	50 minutes	Features	10 vibration

Product diagram and usage

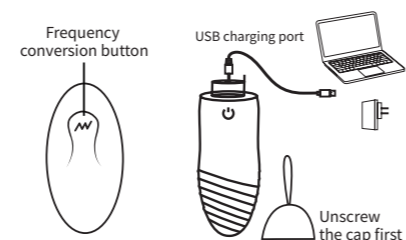

- (1) This fun vibrating egg provides 10 frequency vibration modes to meet various pleasures. You can also control it individually through the remote control for easy adjustment; humanized design, velvety touch, soft and comfortable.
- (2) **Switch button:** Press and hold for 3 seconds to turn on, the LRD light will light up. A short press can switch the vibration mode between 10 frequencies, and a long press can turn off the function.
- (3) **Remote control button:** When the product is in standby mode, the LRD light lights up. Short press the remote control to control the product to cycle through 10 vibration modes to switch the vibration frequency.
- (4) Easily recharge via USB data cable or mobile phone adapter.
- (5) During the charging process, the LED light continues to flash. After charging is completed, the LED light stops flashing.
- (6) The vibrator cannot be activated while charging.

Precautions

- (1) This product is a personal hygiene product and cannot be shared by multiple people to avoid bacterial infection;
- (2) This product is only suitable for use by adults over 18 years old, please keep it away from children;
- (3) During use, please do not use excessive force to avoid injury;
- (4) When using this product, it is recommended to use it with condoms and professional lubricants for better results;
- (5) When using this product, if you find any damage to the product or any physical discomfort, please stop using it immediately;
- (6) Check the product regularly for damage. If any damage is found, please stop using it immediately;
- (7) After using this product, please clean it immediately and store it properly;
- (8) After this product is scrapped, it should be treated as a waste electrical and electronic product and recycled to the corresponding waste electronic product recycling station. This product is not suitable for the treatment of ordinary garbage.

Executive Standard

Q/441900HBWL001-2022
Qualified
Product date

Warning:

This device complies with Part 15 of the FCC Rules. Operation is subject to the following two conditions:
(1) this device may not cause harmful interference, and
(2) this device must accept any interference received, including interference that may cause undesired operation.
Changes or modifications not expressly approved by the party responsible for compliance could void the user's authority to operate the equipment.

NOTE: This equipment has been tested and found to comply with the limits for a Class B digital device, pursuant to Part 15 of the FCC Rules. These limits are designed to provide reasonable protection against harmful interference in a residential installation. This equipment generates, uses and can radiate radio frequency energy and, if not installed and used in accordance with the instructions, may cause harmful interference to radio communications. However, there is no guarantee that interference will not occur in a particular installation.

If this equipment does cause harmful interference to radio or television reception which can be determined by turning the equipment off and on, the user is encouraged to try to correct the interference by one or more of the following measures:

- Reorient or relocate the receiving antenna.
- Increase the separation between the equipment and receiver
- Connect the equipment into an outlet on a circuit different from that to which the receiver is connected.
- Consult the dealer or an experienced radio/TV technician for help

NOTE: This device and its antenna(s) must not be co-located or operation in conjunction with any other antenna or transmitter
The device has been evaluated to meet general RF exposure requirement. The device can be used in portable exposure condition without restriction.