

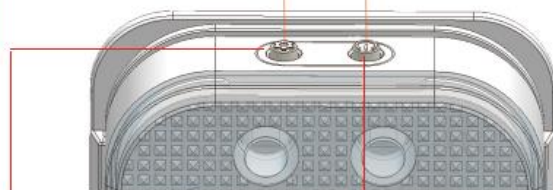

Simultaneously press the settings button and power button to turn on warning lighting

Press any button to turn off the warning light



Tap to switch colors

Long press to increase brightness
Long press to decrease brightness

Long press to turn on/off

To protect the battery, please use the button to shut down if not in use for a long time (remote shutdown still generates standby current)

Short press the power button on the lamp body to switch between light combinations: spotlight/scattered light/spotlight+scattered light

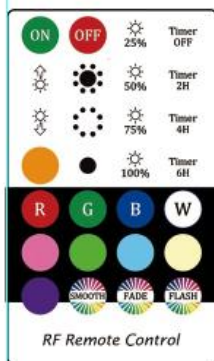

RF Remote control can switch light combinations: spotlight/scattered light/spotlight+scattered light

- Timer 2H Press "Timer 2H" to flash the red spotlight once.
- Timer 4H press "Timer 4H" to flash the red spotlight twice.
- Timer 6H press "Timer 6H" to flash the red spotlight three times.

Timer (2H/4H/6H)

Press the "6H" button, the pool lights will enter in the 6-hour timer mode. That means the pre-programmed timing sequence of 6 hours on and 18 hours off for every 24 hour cycle. Press "OFF" to cancel the timing mode, if the battery is exhausted, the timing mode will also be cancelled.

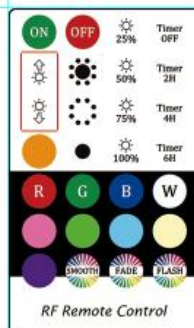

Control light brightness



3 Flashing modes

(Level 5, press ↑↓ to speed up or slow down)

ACCESSORIES LIST



Pick a suitable position underwater and wipe off the dirt and moss.



Stick the glue to the back of the motherboard (3 parallel lines are recommended)



Stick it on the wall and hold it for about 30 to 60S. If it does not move, release it and wait for 3 hours before use (it takes 24H to fully cure).

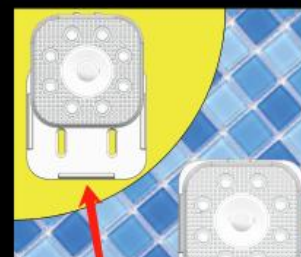

The glue fully cures 24 hrs later. Perfectly installing the lights underwater.

Easy to open waterproof cover

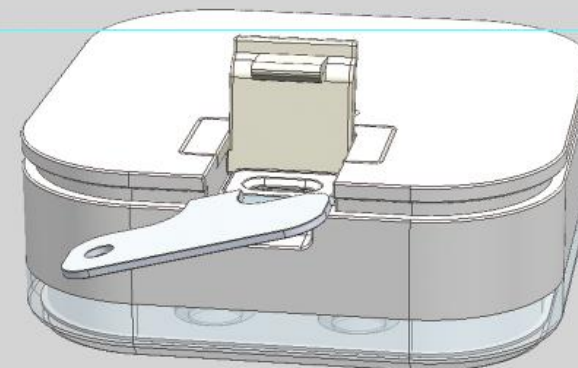
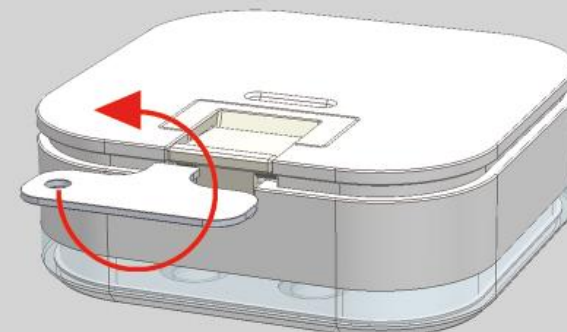

* Be sure to turn off the waterproof cover at the charging port before putting the light into the water.

* Please check whether the charging port is clean and dry before charging.

Rechargeable Pool Light



Thank you for purchasing this product. Installing this product requires no wiring, no damage to the walls (waterproof layer) of the swimming pool and fountain, and there is no risk of electric leakage or shock. It can be easily moved, installed or replaced, and can also be used in other scenarios, achieving one product with multiple purposes.



Swimming pool



Bathub



Fountain



Ice bucket

**NO POWER CORD REQUIRED
NO RISK OF LEAKAGE**



MADE IN CHINA

PRODUCT DETAILS

Rechargeable Pool Lights

Model : JK-PLF-A

Main light body size : 80*80*29.5mm

Plastic plate size : 84.8*83.8*8.1mm

Charging voltage: 5V

Battery: 3000mAh

Working hours: 16-200 hours

Charging time: 6 hours

SCOPE OF PRODUCT APPLICATION

Applicable scenarios: bathtub, swimming pool, waterfall, fountain, pool, aquarium, ice bucket, vase, fish tank, yacht, vase, garden, Christmas tree (projection);

Applicable holidays: weddings, parties, Valentine's Day, Easter, Halloween, Thanksgiving, Christmas and other holidays;

PRODUCT FUNCTIONS AND CHARACTERISTICS

- * Lighting combination: Spotlight + Diffuser (Patented)
- * Waterproof structure design (Patented)
- * Maximum range: 10m (suitable for large and small swimming pools)
- * RF Remote control distance: 600FT (≥ 182M) (in the air), far exceeding similar products
- * Memory function
- * Timer (2H/4H/6H)
- * Function reference remote control instructions
- * Waterproof grade: IP68
- * Adjustable brightness: 6-level brightness adjustment
- * Rich colors: 10 colors + 3 colorful rhythm modes
- * 3 Flashing modes(Level 5, press ↑↓ to speed up or slow down)

Special function: press two keys at the same time to change into: warning light, which can be used to warn others when rainstorm, snowstorm, vehicle failure or need help (press any key to cancel the warning function). The built-in strong magnet can be attached to iron objects or the car body.

Light memory function description:

A: When the remote control turns off the light, it has the light and brightness memory function when it is turned on again.

B: If the light body switch key is pressed and turned off, it does not have the light and brightness memory function.



WARM TIPS

- * Be sure to turn off the waterproof cover at the charging port before putting the light into the water.
- * Please check whether the charging port is clean and dry before charging.
- * A remote control can control multiple pool lights.
- * The worse the water quality or the deeper it is underwater in the swimming pool, the worse the remote control reception effect will be.
- * Using the remote control to shut down, the lighting fixture will have a standby battery of 100mAh damaged every day. If you need to retain power, please press and hold the power button to shut down.
- * Timer :
Press "Timer 2H" to flash the red spotlight once.
press "Timer 4H" to flash the red spotlight twice.
press "Timer 6H" to flash the red spotlight three times.
- * If the lamp does not receive the remote control signal for a long time, the lamp signal receiver will enter a semi sleep state to achieve energy-saving effect. If the remote control does not respond, please press it again. The lighting time of the lamp is better than that of similar products under the same capacity.
- * Please do not place it in hot water for a long time (the water temperature should be ≤ 40 degrees), as steam may enter the lamp body and damage

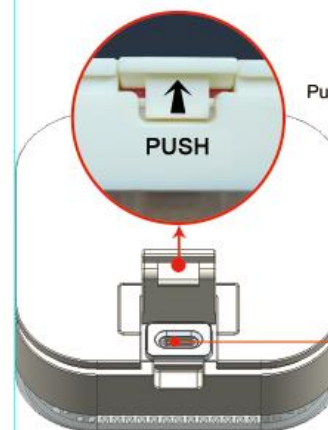

Changes or modifications not expressly approved by the party responsible for compliance could void the user's authority to operate the equipment. This equipment has been tested and found to comply with the limits for a Class B digital device, pursuant to Part 15 of the FCC Rules. These limits are designed to provide reasonable protection against harmful interference in a residential installation. This equipment generates uses and can radiate radio frequency energy and, if not installed and used in accordance with the instructions, may cause harmful interference to radio communications. However, there is no guarantee that interference will not occur in a particular installation. If this equipment does cause harmful interference to radio or television reception, which can be determined by turning the equipment off and on, the user is encouraged to try to correct the interference by one or more of the following measures:

- Reorient or relocate the receiving antenna.
- Increase the separation between the equipment and receiver.
- Connect the equipment into an outlet on a circuit different from that to which the receiver is connected.
- Consult the dealer or an experienced radio/TV technician for help.

This device complies with part 15 of the FCC Rules. Operation is subject to the following two conditions:

- (1) This device may not cause harmful interference,
(2) this device must accept any interference received, including interference that may cause undesired operation.

The device has been evaluated to meet general RF exposure requirement.
The device can be used in portable exposure condition without restriction.

【Product usage Warning and Instructions】

WARNING:

- | |
|--|
| a) Remove and immediately recycle or dispose of used batteries according to local regulations and keep away from children. Do NOT dispose of batteries in household trash or incinerate. |
| b) Even used batteries may cause severe injury or death. |
| c) Call a local poison control center for treatment information. |
| d) The compatible battery type (e.g., LR44, CR2032). |
| e) The nominal battery voltage |
| f) Non-rechargeable batteries are not to be recharged. |
| g) Do not force discharge, recharge, disassemble, heat above or incinerate. Doing so may result in injury due to venting, leakage or explosion resulting in chemical burns. |

Precautions when replacing batteries and WARNING:

- | |
|--|
| a) Ensure the batteries are installed correctly according to polarity (+ and -). |
| b) "Do not mix old and new batteries, different brands or types of batteries, such as alkaline, carbon-zinc, or rechargeable batteries. |
| c) Remove and immediately recycle or dispose of batteries from equipment not used for an extended period of time according to local regulations. |
| d) Always completely secure the battery compartment. If the battery compartment does not close securely, stop using the product, remove the batteries, and keep them away from children. |

⚠ WARNING

- **INGESTION HAZARD:** This product contains a button cell or coin battery.
- **DEATH** or serious injury can occur if ingested.
- A swallowed button cell or coin battery can cause **Internal Chemical Burns** in as little as **2 hours**.
- **KEEP** new and used batteries **OUT OF REACH** of **CHILDREN**
- **Seek immediate medical attention** if a battery is suspected to be swallowed or inserted inside any part of the body.

