

# OUTDOOR EAVES LIGHT

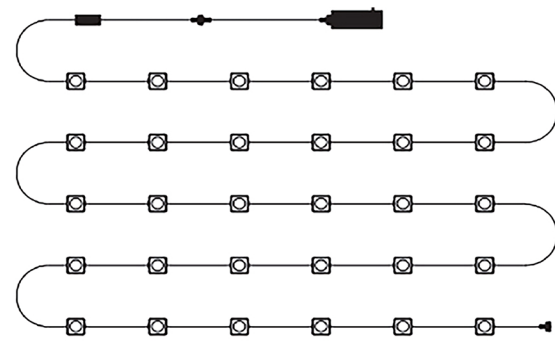

Please read this manual carefully before using the product, and keep it for records properly.



## Technical Parameters

Input Voltage	DC 24V
LEDs number	1
Color temperature	RGB
Shell body material	PC
Waterproof grade	IP67
Operating temperature	-20° C~60° C

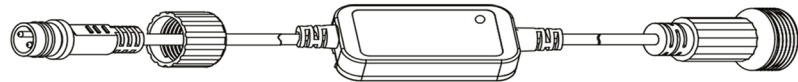

Language

Operation Platform

Input Voltage

IP Rating

Working Temperature

APP Control Distance

Remote Control Distance

Chinese、English、Japanese

Android™ 4.0 or IOS 9.0 or higher

DC24V

IP44

-20-55°C

Visible distance 20Meters

Visible distance 15Meters

# Installation steps

1. Please install the string lights 5-10 cm away from the wall surface.

2. Clean the surface with a cloth or tissue before installing the string lights

3. Remove the protection behind the 3m adhesive backing

4. Press the light firmly against the surface for more than 5 seconds.

5. Connect 2 string lights via the waterproof connectors and screw in the cap.

6. Attach 2 screw clips to each string light to keep them secure, and complete the installation

Warm tip: Given the uncertainties of housing materials and natural factors, the adhesive backing cannot ensure a firm fixation. Therefore, it is recommended to use screws for further fixation during installation.

**Tip:**

The APP installation link and detailed usage instructions are shown as follows.

## Download Surplife APP

Download “Surplife”APP from App Store and Google Play Store,or scan the QR code.  
Note: To use the 'Surplife' app, you need to open your phone Bluetooth permission



SurplifeAPP



## Remote control parameters

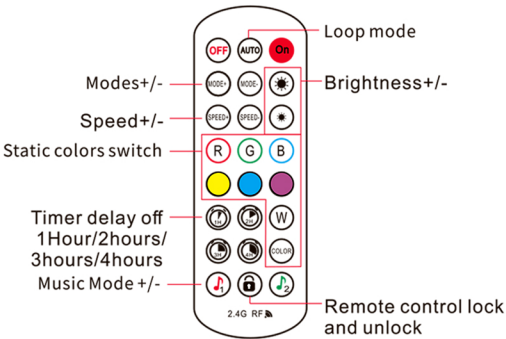

## 1: About Settings

Click on the "Settings" icon to enter the settings interface, where you can set the type of cell , color calibration, and number of lights for the controlled device  
(The number of lights per segment should not exceed 150, and the total number of points should not exceed 2048). The setting of IC points should be based on the application function. And according to Selection of scene types for controlled lighting

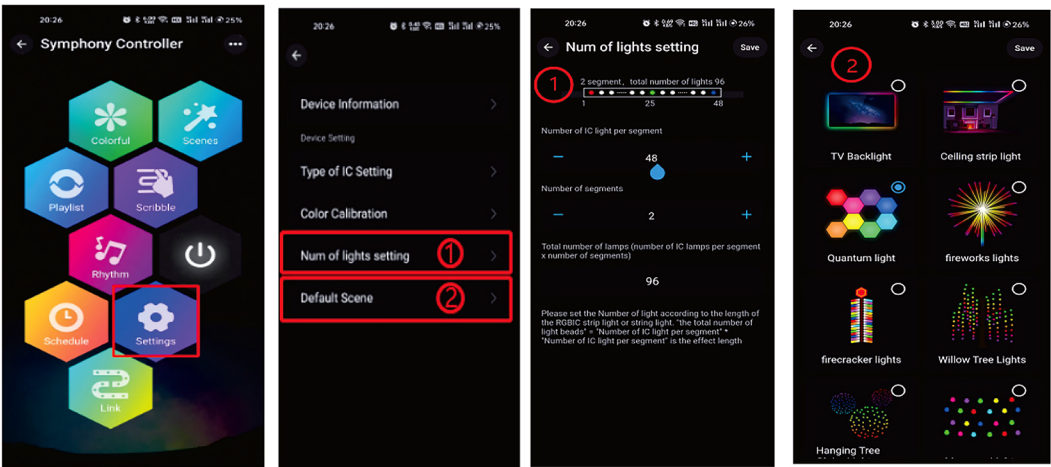

# FCC Statement:

This device complies with part 15 of the FCC Rules. Operation is subject to the following two conditions: (1) This device may not cause harmful interference, and (2) this device must accept any interference received, including interference that may cause undesired operation.

This equipment has been tested and found to comply with the limits for a Class B digital device, pursuant to part 15 of the FCC Rules. These limits are designed to provide reasonable protection against harmful interference in a residential installation. This Equipment generates,uses and can radiate radio frequency energy and,if not installed and used in accordance with the instructions,may cause harmful interference to radio communications.However,there is no guarantee that interference will not occur in a Particular installation.If thise quipment does cause harmful interference to radio or television reception, which can be determined by turning the equipment off and on, the user is encouraged to try to correct the interference by one or more of the following measures:

- Reorient or relocate the receiving antenna.
- Increase the separation between the equipment and receiver.
- Connect the equipment into an outlet on a circuit different from that to which the receiver is connected.
- Consult the dealer or an experienced radio/TV technician for help.

Caution: Any changes or modifications not expressly approved by the party responsible for compliance could void the user's authority to operate the equipment.

This equipment complies with FCC radiation exposure limits set forth for an uncontrolled environment. This transmitter must not be co-located or operating in conjunction with any other antenna or transmitter.