

# Frvesroe v1

## 3 Channel 4K Dash Cam



## User Manual

Sales & Support Email: [frvesroe@gmail.com](mailto:frvesroe@gmail.com)

# Frvesroe v1



Made in China

# CONTENTS

Warm Tips	03
1. What's in the Box?	03
2. Camera Overview	04
3. Installation	08
4. Basic Operation	15
5. Specifications	22
6. Warnings	24
7. FCC Warning Statement	25
8. Warranty & Support	26

## Warm Tips :

1. Please read the User Manual carefully before use.
2. The dash cam must be plugged in to operate.
3. Please do not debug the product or use your mobile phone to watch driving videos during driving, and pay attention to driving safety.
4. This product requires the insertion of an SD card for use. Please use a functional SD card.
5. Do not disassemble or repair the dash cam casing by yourself. If the product malfunctions, please contact the official Frvesroe.
6. Do not install the dash cam in a location that may obstruct the driving view.
7. Please use this product away from high temperature and humid environments.
8. Do not install the dash cam directly in front of passengers to prevent accidental detachment and potential safety hazards.
9. Please note that it may not be possible to connect to the app when using CarPlay or Android Auto.
10. Please use this product within the scope permitted by law.

## 1. What's in the Box?

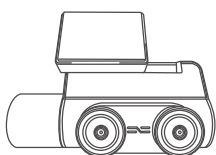

**A.** Frvesroe V1 Dash Cam

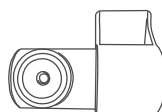

**B.** Rear Camera



**C.** Mount Slide Bracket & 3M Adhesive Sticker\*1

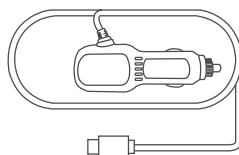

**D.** Car Charger with Built-in Type-C Cable (11.5ft)

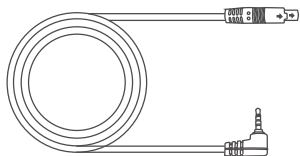

**E. Rear Camera Cable(18ft)**



**F. Electrostatic Stickers\*3**



**G. Crowbar\*1**

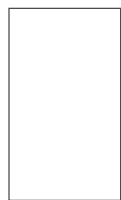

**H. User Manual**

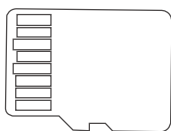

**I. 64G SD Card**

## 2. Camera Overview

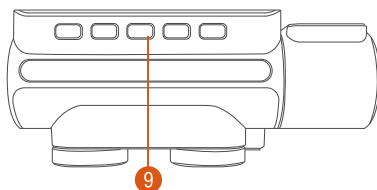
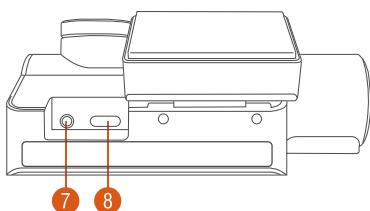
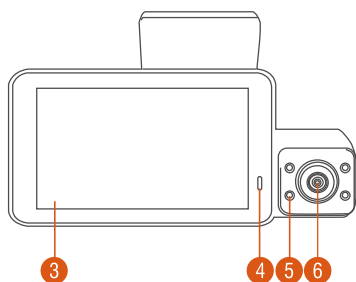
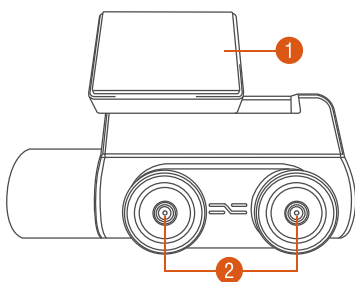

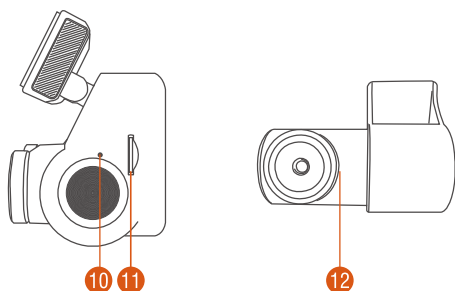



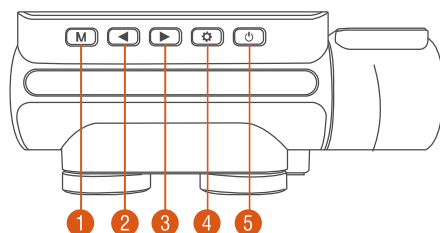

1. GPS
2. Front Camera
3. 3" IPS Curved Screen
4. LED Indicator
5. Infrared Lights for Cabin Camera
6. Cabin Camera
7. Round Port for Connecting the Rear Camera Cable
8. Type-C Port for Charging
9. Keys
10. Reset Button (Restore to Factory Settings)
11. Memory Card Slot
12. Rear Camera

## 2.1 Keys and Functions



NO.	Key	Instruction
1		<ul style="list-style-type: none"> <li>· In the preview interface, short press to enter the menu settings.</li> <li>· In the recording interface, long press to turn the audio recording on or off.</li> </ul>

NO.	Key	Instruction
1		<ul style="list-style-type: none"> <li>· In the menu settings interface, short press to return to the previous interface.</li> <li>· In the file browsing interface, short press to return to the previous interface, and long press to delete the file.</li> </ul>
2		<ul style="list-style-type: none"> <li>· In the preview and recording interfaces, short press to switch the video window.</li> <li>· In the menu settings and file browsing interfaces, short press to select the previous option or file.</li> <li>· In video playback mode: While the video is playing, short press to play or pause the video.</li> </ul>
3		<ul style="list-style-type: none"> <li>· In the preview interface, short press to enter the gallery interface.</li> <li>· In the recording interface, short press to start emergency recording.</li> <li>· In the menu settings and file browsing interfaces, short press to select the next option or file.</li> <li>· In video playback mode: Short press to start video playback. While the video is playing, double press to return to the beginning of the video.</li> </ul>
4		<ul style="list-style-type: none"> <li>· In the preview interface, short press to start recording.</li> <li>· In the recording interface, short press to pause recording.</li> <li>· In the menu settings and file browsing interfaces, short press to confirm the option.</li> <li>· When playing back the file, double press to play the video at 2X or 4X speed.</li> </ul>

NO.	Key	Instruction
-----	-----	-------------

- |   |   |   |
|---|---|---|
| 5 |  | <ul style="list-style-type: none"> <li>• In the power-on state, long press to turn off the camera; in the power-off state, short press to turn on the camera.</li> <li>• In the recording interface, short press to take a snapshot.</li> </ul> |
|---|---|---|

## Screen Overview

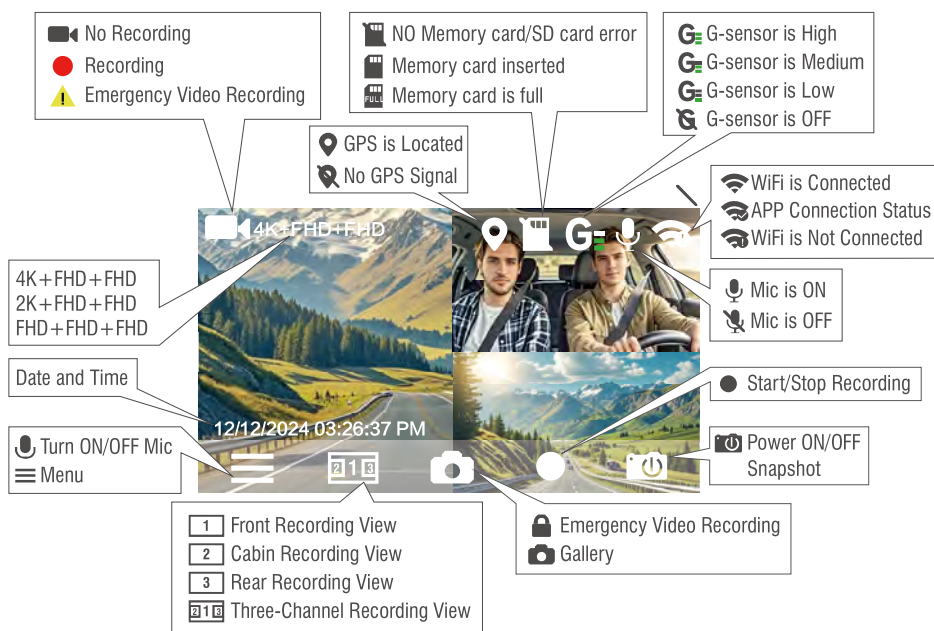

## File Format Definition

20301208113258\_000008A.MP4  
 20301208113258\_000007B.MP4  
 20301208113258\_000006I.MP4

A for front camera  
 B for rear camera  
 I for cabin camera

Date      Time      Sequence number

## LED Light Indicator Description:

**Power On:** Red light turns on.



**Power Off:** Red light briefly lights up and then turns off.

**Operating Status:**

**1.Time-Lapse Recording Enabled:**

- During recording: Blue and white lights alternate flashing.
- Not recording: Red light remains steady.

**2.Time-Lapse Recording Disabled:**

- During recording: Red and white lights alternate flashing.
- Not recording: Red light remains steady.

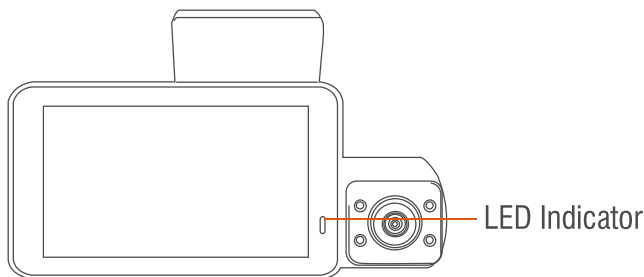

### 3. Installation

#### 3.1 Inserting a Memory Card (Including a 64GB SD Card)

Please insert the memory card into the slot with the metal side facing the screen of the camera (As shown in the figure below), until you hear a "click" from the slot, which indicates that the card has been inserted correctly. (Memory card capacity: 8GB-512GB, card speed requirements: U3/Class10/A2)

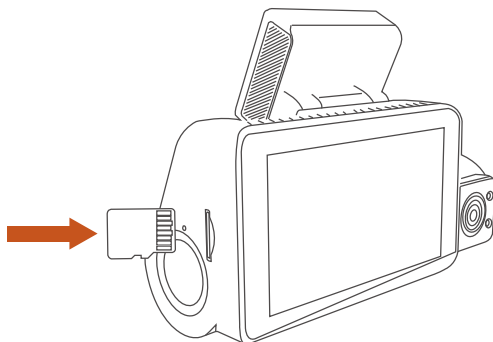

After inserting the memory card, if the screen prompts "Card error", please replace it with a new memory card. After the memory card

is replaced, the camera will automatically restart and enter the recording interface.

### **Reminder:**

- The dash cam has certain requirements for memory card speed. It requires a U3/Class10/A2 memory card. If the card speed is not fast enough, there may be problems such as missing files, frequent memory card errors, and abnormal video files.
- We recommend formatting the card once a month to ensure the normal operation of the dash cam.
- Do not remove or insert the memory card during recording to avoid losing important videos.

## **3.2 Installation**

### **3.2.1 Installation and Removal of Front Camera Mount Slide Bracket**

(1) Mount Slide Bracket Installation:

The new dash cam comes with the mount slide bracket preinstalled, so no installation steps are required by you.

Align the mount slide bracket with the dash cam mount interface and push it in the direction shown in Figure 1 until the bracket is securely installed.

(2) Mount Slide Bracket Removal:

To replace the mount slide bracket, push it in the direction shown in Figure 2 to remove it. (One replacement mount slide bracket is included.)

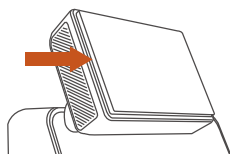

Figure 1

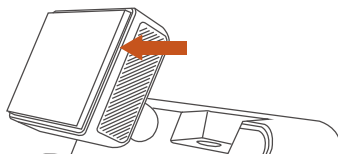
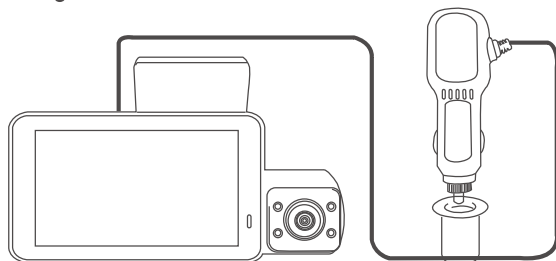

Figure 2

### **3.2.2 Car Charger Installation**

Connect one end of the car charger to the car cigarette lighter and

the other end to the Type C port on the front camera. Start the ignition, waiting for the dash cam to start.



### 3.2.3 Power on the Dash Cam to Select the Installation Location

Before installing the V1 front camera, please turn it on and check whether the shooting angles of the front camera and the cabin camera are suitable through the screen of the V1.

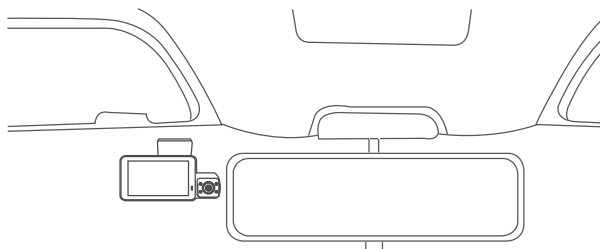

### 3.2.4 Installation of Electrostatic Sticker

1. Clean the windshield with water or alcohol, then dry it with a cloth.
2. Remove the protective film from the electrostatic sticker and apply it to the windshield.
3. Remove the protection film of the mount and main camera lens, then attach the mount and camera to the sticker.

**Note:** It is recommended to place the electrostatic sticker near the rear-view mirror to avoid obstructing your view.

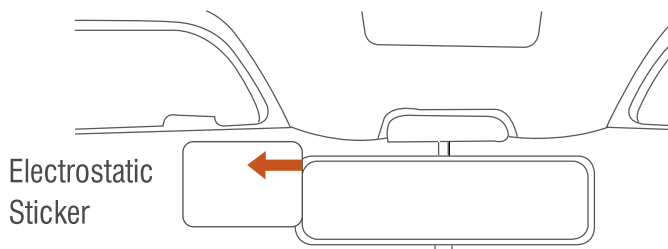

### 3.2.5 Front Camera Installation

Remove the protective film from the mount, then fix the mount and camera on the electrostatics sticker.

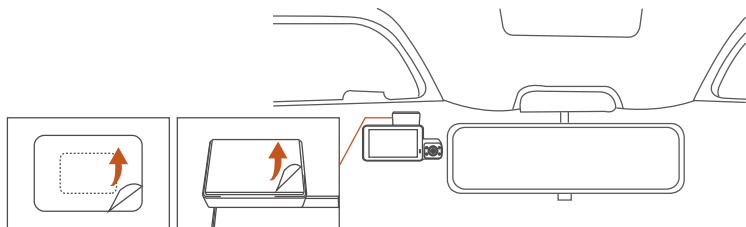

### 3.2.6 Rear Camera Installation

1. Please take out the rear camera cable and connect the rear camera to the front main camera with the rear camera cable, and connect the car charger to power on.
2. After the camera is powered on, choose the installation location on the rear windshield, ensuring full rear view coverage.
3. Once the position is determined, clean the rear windshield with water or alcohol, then dry it with a cloth.
4. Remove the protective film from the electrostatic sticker and apply it to the windshield.
5. Remove the protection film of the sticky pad and rear camera lens, then attach the rear camera to the sticker.

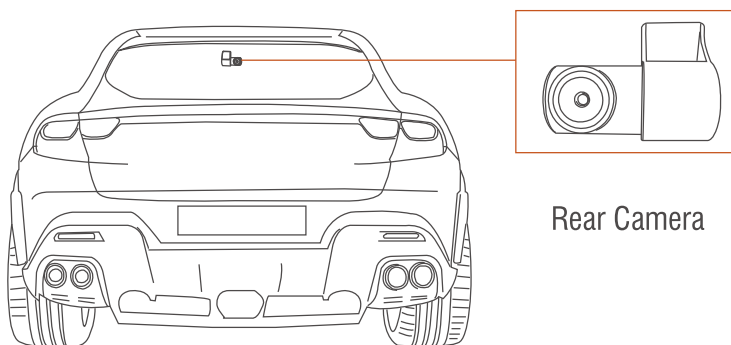

### 3.2.7 Wire Arrangement

**Car charger cable:** Use the Frvesroe included crowbar to tuck the car charger cable into the seal between the A-pillar and the

windshield, from the passenger to the cigarette lighter.

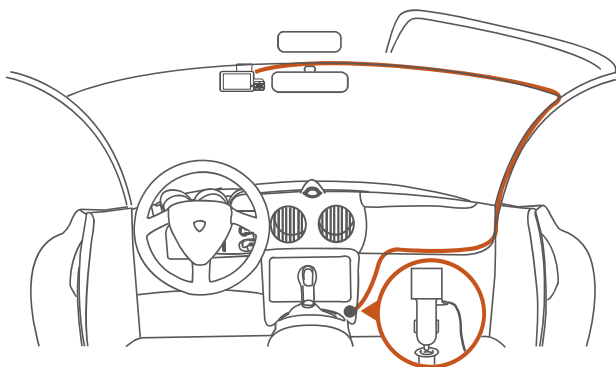

**Rear camera cable:** Arrange the rear camera cable from the front windshield to the rear windshield, as shown in the picture below.

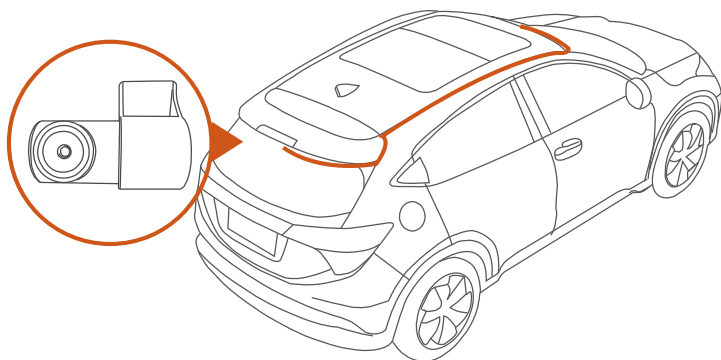

### 3.3 APP Download

1. Please scan the QR code for the relevant version below to download the app and install it.
2. Search for the "Viidure" app in App Store or Google Play Store to find the app and then download and install it on your phone.



### 3.4 Wi-Fi Connection

**WiFi Name Prefix:** Frvesroe V1\_

**Initial WiFi Password:** 12345678

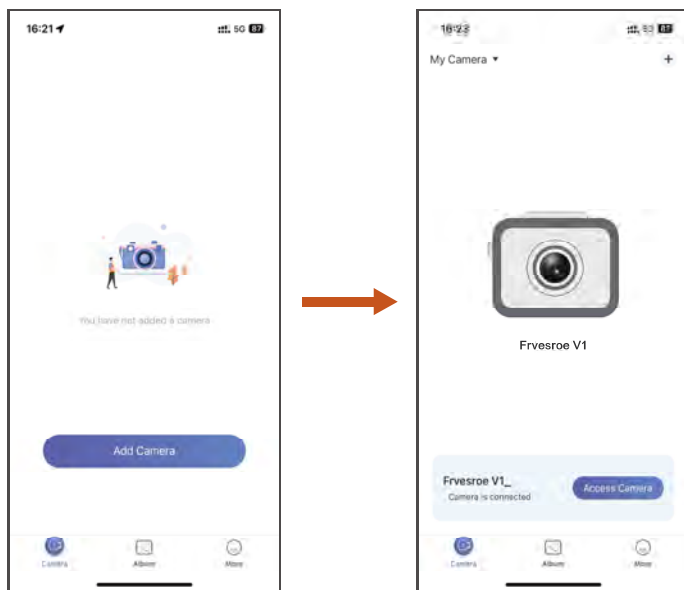

#### Note:

1. When the V1 dash cam's Wi-Fi is connected to the "Viidure" app, the front and cabin cameras continue to record normally, while the rear camera stops recording.
2. The camera's Wi-Fi activates automatically when the V1 dash cam is powered on.
3. Ensure your phone's Wi-Fi is enabled before connecting to the camera's Wi-Fi.
4. The initial password is for first-time login only. To enhance security, change it after logging into the "Viidure" app to prevent unauthorized access.
5. If you forget the Wi-Fi password
  - (1) you can find it through: Menu - General Settings - WiFi - Password.
  - (2) please reset the camera settings to restore the Wi-Fi password to the default (12345678).

### 3.5 APP Operation

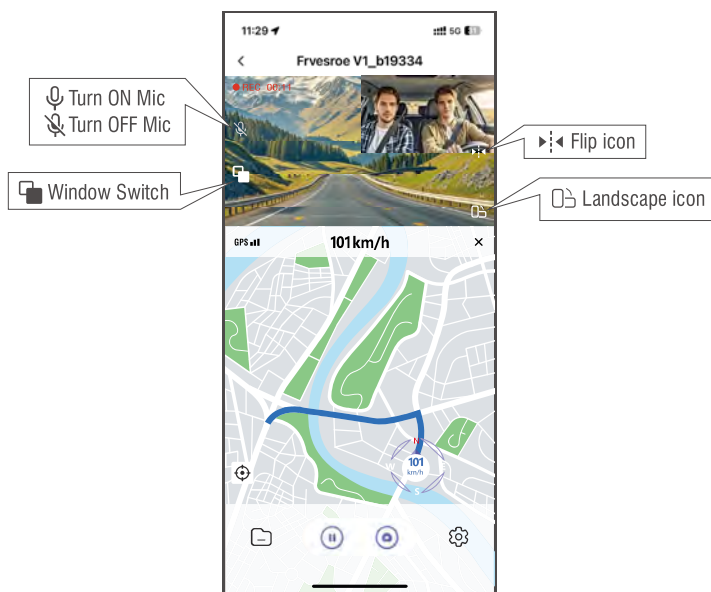

After entering the APP real-time preview, you can do the following operations.



- 1. Video Preview:** Once the app successfully connects to the camera, it enters the real-time preview page where you can view video, GPS location, and trajectory. Click the flip icon to mirror the video. Click the landscape icon for full-screen mode. Click the window switch icon to toggle between front and cabin video views. Click the microphone icon to enable or disable the microphone.
- 2. Playback video:** You can view the recorded video or photo files in the SD card in the APP, click "Camera Files" and then select the video or photo to play back.
- 3. Video download:** You can choose to download videos or photos in the browse file interface or in the video playback.
- 4. Video capture:** App real-time preview interface can capture the current picture.
- 5. Video and Photo Editing:** You can trim videos and set them to music, crop photos and enhance them with filters.

- 6. **Social Sharing:** You can share videos and photos to social platforms with one click after downloading them locally.
- 7. **Camera Settings:** You can set video resolution, loop recording options, and other parameters as needed.

## 4. Basic Operation

Press the button , pause the video first, then press the button  to enter the menu settings.

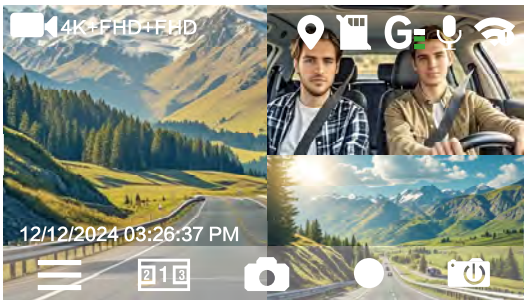

### 4.1 Menu Settings

The V1 dash cam has 3 function menus, which are: Video Settings, General Settings, and Audio Settings. You can set your dash cam according to your requirements with these function setting.

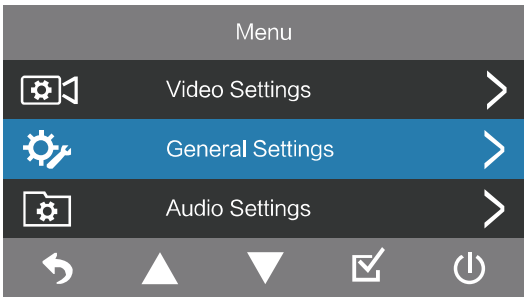

#### A. Video Settings

- **Resolution:** Default setting is 4K + FHD + FHD. You can set it to 4K + FHD + FHD, 2K + FHD + FHD, FHD + FHD + FHD.
- **Loop Record:** Default setting is 1 Min. You can choose the options among 1/3/5 Min.



- **G-Sensor:** Default setting is MID. You can choose the desired G-sensor sensitivity level: LOW, MID, HIGH, OFF. The higher the sensitivity level, the easier it is to trigger Emergency Recording. G-sensor is most sensitive when set to High.
- **Motion Detection:** The default value is disabled. You can choose to enable. When the front camera detects motion, the dash cam will automatically start recording.

**Note:**

1. Motion Detection mode only works when the camera is powered on. It will not function once the camera is turned off.
2. Motion Detection and Time Lapse can only be enabled one at a time. Enabling one will automatically disable the other.

- **Parking Monitor:** The default value is disabled. You can choose to enable.

**Note:** Parking Monitor mode can only be activated when the dash cam is powered by the ACC Hardwire Kit cable.

- **Time Lapse:** The default value is disabled. You can choose to enable Every 1s/Every 3s/Every 5s.

**Note:** Time Lapse and Motion Detection can only be enabled one at a time. Enabling one will automatically disable the other.

- **Exposure:** The default is 0. You can adjust the exposure value to -2, -1, 0, 1, or 2 to control the camera's exposure level.
- **Anti Flicker:** Default is 60Hz. Options: 50Hz, 60Hz.
- **Night Vision:** Default is Auto. Options: Auto/ON/OFF. Activating improves night recording quality.

## **B. General Settings**

- **Screen Saver:** Default is 30 Sec. Options: OFF/30 Sec/1 Min/3 Mins/5 Mins.
- **Digital Clock:** Default is ON. Options: ON/OFF.
- **Date and Time:**  
Date formats: YYYY/MM/DD, DD/MM/YYYY, MM/DD/YYYY.

Time formats: 24-hour (00:00:00), 12-hour (00:00:00 AM/PM).

- **Daylight Saving Time:** Default: OFF, with options to turn ON/OFF.
- **Speed Unit:** Default: MPH, with options for KM/H and MPH.
- **Plate Number Stamp:** Select the number or letter to set. Once configured, your license plate number will appear in the recorded video. You can also enable/disable the stamp, with the default setting as off.
- **Date Stamp:** The date and time will appear in the recorded video. Default: ON, with options to turn ON/OFF.
- **Language:** Default is English. Available languages include: English, 简体中文, 繁體中文, 日本語, Deutsch, Italiano, Español, Français.
- **WiFi:** Default is ON. Connect to WiFi using your phone to control the V1 dash cam. WiFi details include SSID and Password.
- **Format SD Card:** Formatting will erase all data on the memory card.
- **Reset to Defaults:** Resetting to factory defaults will erase ALL setting.
- **Device Information:** View the camera Model and Firmware version.
- **Regulatory Info:** View the camera Brand, Model, Product Name, and Country of origin.

## C. Audio Settings

- **Keypad Sound:** Default is OFF, with options to turn ON/OFF.
- **Startup Sound:** Default is ON, with options to turn ON/OFF.
- **Record Audio:** Default is ON, with options to turn ON/OFF.
- **Video Volume:** Default is LOW, with options for HIGH, MID, LOW.

## 4.2 Gallery

View recorded videos and photos.

- **Event Video:** Emergency recordings.
- **Normal Video:** Loop recordings, parking mode videos, and time-lapse recordings.
- **Photo:** Stored photo files.

## 4.3 Key Features

### 4.3.1 Loop Recording

Once the memory card is inserted and power connected, the V1 dash cam will power on and start loop recording. Each video segment is saved according to the set loop duration in the normal video folder. When this folder reaches 70% of its capacity, new recordings will overwrite older ones. This ensures continuous recording without interruption while driving.

#### Note:

1. Loop recording relies heavily on the speed of the memory card. Regularly format the card to prevent issues like file overload or card aging, which can disrupt recording.
2. Regularly review loop recordings to ensure important videos are not overwritten.



### 4.3.2 Event Recording

Event video is triggered by the G-sensor (Gravity Sensor) and can be activated automatically or manually.

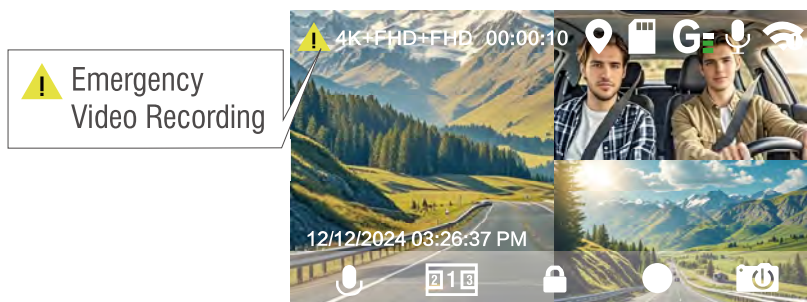
During driving, the camera will automatically lock for event recording in special circumstances, or you can manually lock it.



#### Manually lock event recording:

To manually lock, simply press the button  on the recording interface. During the locked recording, you can also press the button  multiple times to capture photos.

Once the event recording ends, the video will be saved in the Event Video folder and the photos in the Photo folder.

### **Auto-lock event recording:**

The emergency recording is automatically triggered when the vehicle experiences a collision or vibration. The dash cam senses the vibration and locks the current video.

During the locked recording, you can also press the button  multiple times to capture photos.

After the event recording ends, the video will be saved in the Event Video folder and the photos in the Photo folder.

### **Note:**

1. The sensitivity of automatic locking video trigger is determined by the collision sensitivity (i.e., the G-Sensor setting in the menu: Default is MID). The higher the G-Sensor sensitivity, the greater the probability of being triggered.
2. The total capacity of the event video file accounts for 30% of the total capacity of the current memory card. When the event video file reaches the upper limit, the new event video file will automatically overwrite the old event video file. It is recommended to periodically check and save your event video files to avoid loss.

### **4.3.3 Parking Monitor**

Parking Monitor is an essential feature of the dash cam, providing security surveillance when the vehicle is parked.

To activate parking monitor mode, the dash cam must be powered using an ACC Hardwire Kit cable(sold separately). Once connected to the ACC Hardwire Kit cable, the camera will automatically enter parking mode after the engine is turned off.

### **Note:**

1. In extremely hot environments, we recommend disabling Motion Detection and setting the G-sensor to "LOW". If the internal temperature of the vehicle reaches 60°C, it is advised to turn off the dash cam to prevent malfunction from overheating.
2. All parking monitor recordings are saved in the normal video folder. To prevent these files from being overwritten by loop recording, please check them regularly to avoid loss.

### 4.3.4 Motion Detection

When the front camera detects motion, the dash cam will automatically start recording.

**Note:**

1. Motion Detection mode only works when the camera is powered on. It will not function once the camera is turned off.
2. Motion Detection and Time Lapse can only be enabled one at a time. Enabling one will automatically disable the other.

### 4.3.5 GPS Function

The GPS function is an important feature of the dash cam. GPS is enabled by default, and the camera receives GPS signals through the GPS mount. It can record the location where the video is taken and the speed of the car at that time.

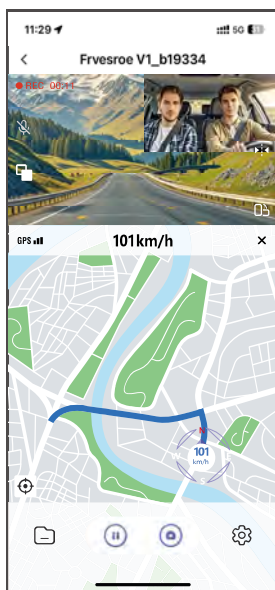

**Note:**



- The GPS connection will be completed within 3-5 minutes after you turn on the camera. If the connection is not successful within 5 minutes, please check if your environment (e.g., underground parking lot, densely populated residential area, subway, tunnel,

- etc.) is affecting GPS signal reception.
- GPS information is recorded along with the video. To view it, please download and install the Viidure APP.

#### 4.3.6 Viewing and Deleting Video/Photos

##### A. View on the Camera

In the preview interface, press the button  to enter the “Gallery” and select any folder.

After opening the video folder, you can press the button  to select the preview file, or press the button  to select the next file.

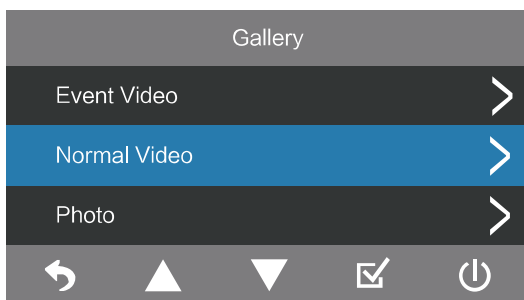

- Delete Videos or Photos

Delete the video or photo on the camera. Long press the button  in the file browsing interface to pop up the delete menu.

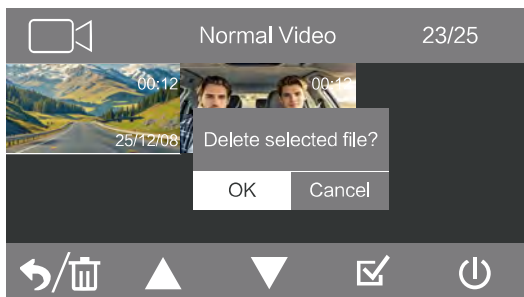

##### B. View on the “Viidure” App



After connecting the phone to the camera's Wi-Fi, you can play, download, and delete files in the Viidure app.

**Note:**

For video playback in the app, or downloads to SD card, there will be no network traffic consumption.

## 5. Specifications

Model	V1
Chips	Novatek high-performance processor
Image Sensor	Sony CMOS Sensor
WiFi	2.4G
GPS	Beidou GPS
Screen	3" IPS curved Screen
USB Port	Tpye-C

Model	V1
Camera Angle	Front: 170° wide viewing angle Cabin: 140° wide viewing angle Rear: 140° wide viewing angle
Aperture	Front: F/1. 8 wide aperture Cabin: F/1. 8 wide aperture Rear: F/1. 8 wide aperture
Languages	English、简体中文、繁體中文、日本語、Deutsch、Italiano、Español、Français
Video Resolution	Front+Cabin+Rear: 2160P+1080P+1080P 1440P+1080P+1080P 1080P+1080P+1080P
Video File Format	MP4
Photo File Format	JPG
Audio	Built-in microphone and speaker
Memory Card Capacity	External: 8GB-512GB Micro SD Card, U3, A2, Class 10 (64G Card included in the package)
Power Source	Built-in super capacitor
Working Voltage	12V
Working Current	400~450MA
Working Temperature	-4°F to 140°F(-20°C to 60°C)
Storage Temperature	-4°F to 158°F(-20°C to 70°C)



## 6. Warnings

- This product is an auxiliary device for recording exterior images of vehicles, and some functions may not be supported due to different driving and vehicle environments.
- This product can record and save images of vehicle accidents, but it does not guarantee that all accident images can be recorded. The image may not be saved in a special folder if the crash sensor is not activated for minor collisions.
- Be sure to turn off the power when inserting or removing the memory card.
- For stable use of the product, please format the memory card at least once a month.
- Generally, memory cards have a limited lifespan, and long-term use may result in data not being saved. In this case, it is recommended to purchase a new memory card. The company will not be held responsible for data loss due to prolonged use of the memory card.
- Do not install or operate this product while the vehicle is in motion.
- Do not subject the product to strong shocks or vibrations, as this may damage the product and cause malfunction or inoperability.
- Do not use chemical solvents or cleaning agents to clean the product.
- The ambient temperature range for normal use of this device is -20°C to 60°C. Exceeding this temperature range may cause the product to malfunction.
- Do not place the product near open flames. Do not use the product in high-temperature and high-humidity environments, as this may cause electric shock, short circuits, and other hazards, potentially damaging the product.
- Do not disassemble or modify the car charger yourself, or use a short-circuited car charger, as this may cause personal injury, electric shock, fire, or damage to the product.
- Please do not disassemble or modify the product without permission to avoid damaging the recorder, generating heat, or causing a fire.

- Please use this product within the scope of the law.

## **7. FCC Warning Statement**

Changes or modifications not expressly approved by the party responsible for compliance could void the user's authority to operate the equipment. This equipment has been tested and found to comply with the limits for a Class B digital device, pursuant to Part 15 of the FCC Rules. These limits are designed to provide reasonable protection against harmful interference in a residential installation. This equipment generates uses and can radiate radio frequency energy and, if not installed and used in accordance with the instructions, may cause harmful interference to radio communications. However, there is no guarantee that interference will not occur in a particular installation. If this equipment does cause harmful interference to radio or television reception, which can be determined by turning the equipment off and on, the user is encouraged to try to correct the interference by one or more of the following measures:

- Reorient or relocate the receiving antenna.
- Increase the separation between the equipment and receiver.
- Connect the equipment into an outlet on a circuit different from that to which the receiver is connected.
- Consult the dealer or an experienced radio/TV technician for help.

### **FCC Radiation Exposure Statement**

The antennas used for this transmitter must be installed to provide a separation distance of at least 20 cm from all persons and must not be co-located for operating in conjunction with any other antenna or transmitter.

This device complies with Part 15 of the FCC Rules. Operation is subject to the following two conditions:

- (1) This device may not cause harmful interference.
- (2) This device must accept any interference received, including interference that may cause undesired operation.

## **8. Warranty & Support**

### **Warranty**

The Frvesroe offers a 12-month warranty service period.

### **Support**

If you have any questions about the product, please feel free to contact us and we will respond within 12-24 hours.

1. Contact our customer service representative from the purchase channel.
2. Send an email to our official address at [frvesroe@gmail.com](mailto:frvesroe@gmail.com).

### **Your opinion matters**

Frvesroe is firmly committed to continually improving our products, enhancing services, and optimizing user experience. If you have any suggestions on how we can improve, we welcome you to share your valuable feedback via our official email at [frvesroe@gmail.com](mailto:frvesroe@gmail.com).

**Thank you for choosing Frvesroe.**