

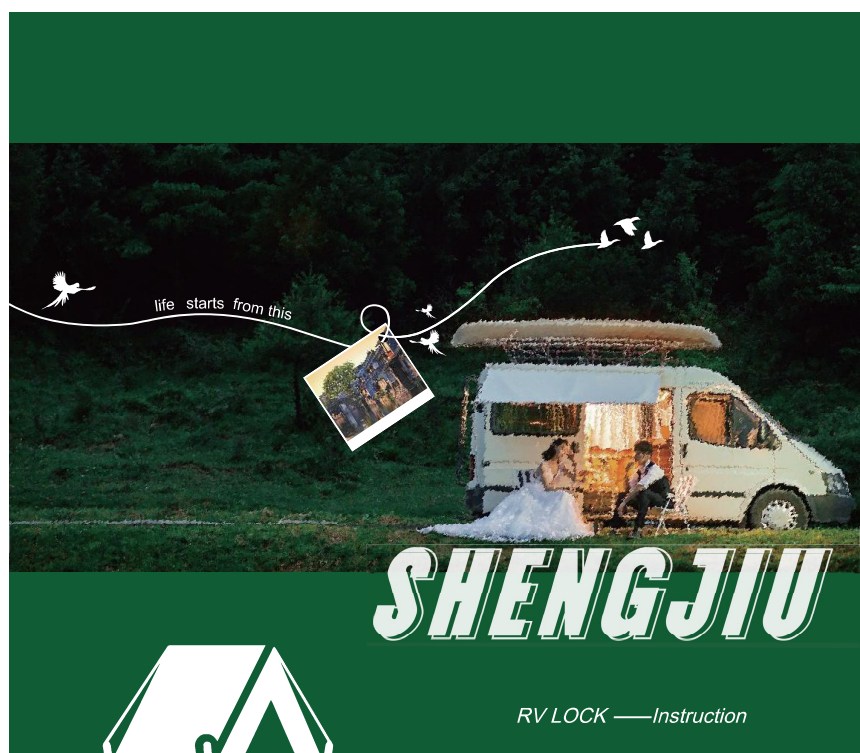

To PURSUE UNDEFINED FREEDOM





CONTENTS

01 . _____
Product Overview 1P

02 . _____
Product Data 2P - 3P
2 - 1 Product drawing data
2 - 2 Requirements for opening size
2 - 3 Product view

03 . _____
Installation and use 4P-7P
3-1 Preparation before installation
3-2 Door lock installation
3-3 Remote key pairing
3-4 Password Change
3-5 Fingerprint registration

05 . _____
Packing List 9P
Product Promise 10P

04 . _____
Maintenance 8P
4 - 1 Battery Replacement

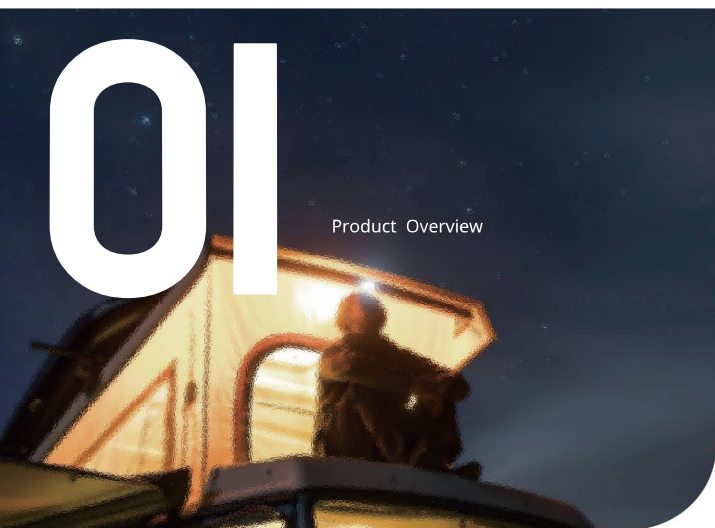

Product Overview

DS982-7C

DS982-7C The main material is selected from high-strength zinc alloy, meticulously crafted, with a sturdy structure that can effectively resist external impacts, providing solid security for your RV. The surface is treated with powder coated, which not only gives the door lock a stylish and minimalist appearance but also ensures weather resistant in various environments.

This door lock is specially designed for the RV industry, perfectly suited for outdoor use environments of RVs. It is powered by a 6V battery, ensuring stability and reliability. The unlocking methods are extremely diverse, covering fingerprint unlocking, remote key, password unlocking, and mechanical key emergency unlocking, fully meeting the usage needs in different scenarios, greatly enhancing both convenience and security.

Exposed surface meets neutral salt spray for 96 hours, demonstrating excellent corrosion resistance; The front protection level reaches IP54, effectively resisting dust and rain, maintaining outstanding performance even in harsh outdoor conditions. Applicable door panel thickness is 35 - 45MM, easy and quick installation, equipped with detailed installation instructions and auxiliary tools to complete the installation. Whether you are an RV enthusiast pursuing a premium life, or a traveler focusing on safety and convenience, this RVLock is an ideal choice for RVs.

02

Performance Date

Name	D S 9 8 2 - 7 C
Description	<ul style="list-style-type: none">• Material: Zinc Alloy• Finish: Powder coating
Structural Features	<ul style="list-style-type: none">• Unlocking Methods: Fingerprint Unlock, Remote Key, Password Unlock, Mechanical Key Emergency Unlock• Exposed surface meets neutral salt spray for 96 hours; front protection level IP54• Panel preparation: 35-45mm



2-1 Product drawing information

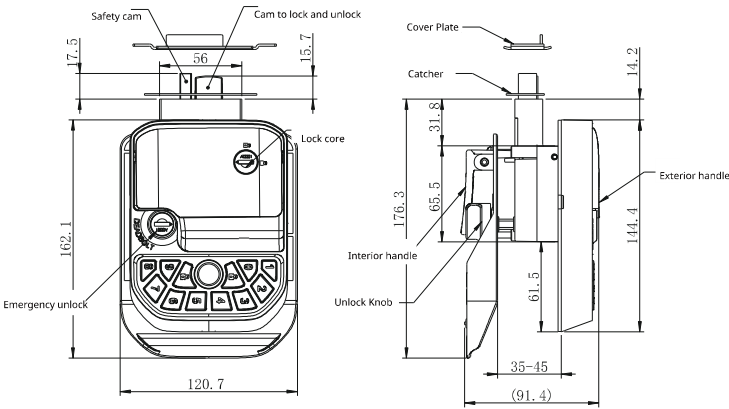

2-2 Panel Opening Hole size

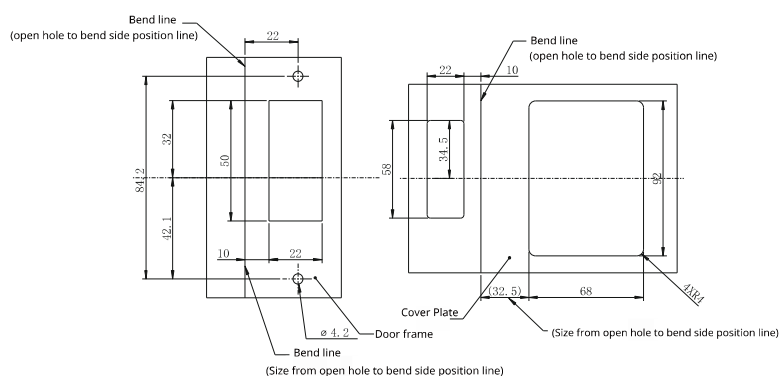

2-3 Product view



Front view



Rear view

3-1 Preparation Before Installation

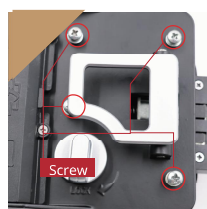

- Remove the 4 screws from the plate (See Figure-01)

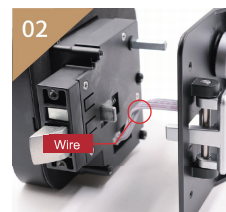

- Take out the wires and separate the upper and lower lock bodies (See Figure-02)

3-2 Installation

Step One

- Use your own tools to complete the hole on the RV entrance door;
- Place the door frame plate inside the door frame and secure it with two ST4.8 self-tapping screws. (See Figure A1 on the right).

Step Two

Install the battery included in the box into the empty battery slot (Fig. A2). Before installing the new lock, the square tongue must be manually or electrically retracted so that the new lock can be slid into the opening.

Step Three

Carefully slide your new lock into the opening hole from the front while pulling the front wires smoothly, keeping the front (Figure A3) in place, and secure it with 2 countersunk M4 screws in the same direction as the door latch plate.

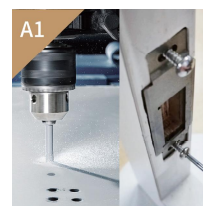

Step Four

When connecting the battery harness, insert the common terminal into the female terminal on the back of the main board (Figure A4). Once connected (if the battery is installed), you will hear a confirmation beep.

Step Five

Organize the wiring harness (Figure A5), ensuring that no harnesses are pinched, and secure them in the slots. When aligning the rear handle with the front handle, ensure that the rear handle is in the closed position. After installing the rear panel, keep the wiring harness away from the screw holes and moving parts.

Step Six

Install 4 long screws (Figure A6), ensuring simple positioning without needing to be overly tight.

Step Seven

Align the door lock, ensuring it is level; once in the best position, tighten completely, but do not over-tighten.

Sudden Eight

Enter the default unlock password '1234', then press the ' ' button to test your lock, your new lock is now ready to use (Figure A8). If the default password does not work, please press the 'code reset' button on the back of the key-board (Figure A7) for 5 seconds, which will reset your unlock password to '1234' and try again.

Step Nine

Cover the electronic lock with the protective shell (Figure A9), determine the position of the mounting screw holes, drill and tap, then use combination screws M4*14 to secure the protective shell (the protective shell can be freely opened and closed after installation).

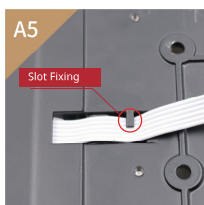
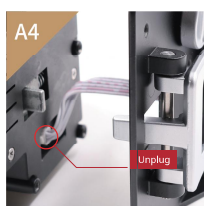
**3-3 Remote Key Pairing****Step One**

On the back of the lock, toggle the switch to the 'ON' position (See Figure B1), press any button on the panel to wake up the lock, and after the panel light goes out, the remote key function can be activated.

Step Two

Lock side: Long press the 'FOB Learn' for 3 seconds, the lock side buzzer will emit a long 'beep' sound, while the lock panel light will be in a flashing state, indicating that the lock is in pairing mode.

Key side: After the lock is in pairing mode, simultaneously press any one of the unlock buttons on the remote key (Figure B2). The red light on the key side will stay on, indicating that remote pairing has started.

When you hear the lock buzzer emit a long 'beep' sound and the light on the lock panel goes out, it indicates that pairing is complete. At this point, you can use the remote key to operate the lock.

Note

If you need to pair another remote key, please try steps 1-2 again. If you disable the remote key function, please set the switch to the 'OFF' position (Figure B1). One lock can match up to 3 remote keys at the same time.

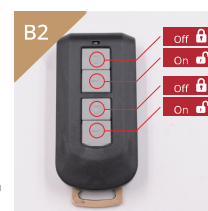
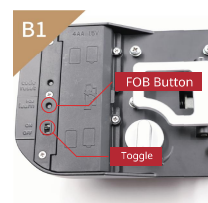

Press the button to operate	Light indication
Pairing (press and hold the button at the same time)	Red light stays on
Switch lock (paired)	Red light flashes slowly
Switch lock (unpaired)	Red light stays on
Pairing successful	Red light goes out after flashing slowly for 3 seconds
Pairing timed out	Red light goes out after flashing quickly

04

MAINTENANCE

3-4 Password Change

Operation Steps

- First, you need to know the current lock password (or initial password);
- Press and hold the '8' and '🔒' keys, then release; Enter the old password /initial password (1234) within 5 seconds after the buzzer sounds, then press "🔒";
- After entering the new password, press the "🔒" button, then re-enter the new password and press the "🔒" button.
- When the new password is successfully set, there will be a long beep of "beep beep beep", and the keyboard light will turn off.



Example

Assuming the 'new' password you choose is '5-6-7-8';

- The default password is '1-2-3-4';
- Press and hold the '8' and "🔒" keys simultaneously, release the keys. Enter the default password '1-2-3-4', then press "🔒";
- Enter the new password '5-6-7-8', press "🔒", then re-enter the new password '5-6-7-8', and press "🔒";
- Unlock using the new password. Enter '5-6-7-8' and press the "🔒" key to unlock.

3-5 Fingerprint registration

Operation Steps

- Press and hold the "0" and "🔒" buttons at the same time, then release the buttons. The panel light will remain on and the buzzer will sound two long beeps.
- Enter the RV lock code and press the "🔒" button. The fingerprint module's blue light will blink, the panel light will remain on, and the buzzer will sound once to enter fingerprint registration mode.
- Press the fingerprint module (D1 in the figure) for 2 seconds and then lift your finger.
- Registration successful: The fingerprint module lights up green and the buzzer sounds long.
- Fingerprint registration failed or fingerprint not recognized: The blue light remains on for a long time and then goes out, and the buzzer sounds a short beep.



Note

To register a new fingerprint, repeat steps 1 • 3.

4-1 Battery Replacement

Step one

Remove the battery cover screw on the back of the lock (Figure D1), the screw is M3.



Step Two

Rotate the battery compartment cover (Fig D2) to flip open the battery cover, and install/replace 4 AA alkaline batteries as needed.



Step Three

After completing the battery replacement, secure the battery compartment cover and install the battery cover screws (Fig D1).

Note

If the user forgets the unlock code or remote key, press and hold the 'code reset' button to reset the code; the default unlock code is '1234'. If you hear a 'beep' sound every 10 seconds during the use of the lock, it indicates that the battery is low; please replace the battery as soon as possible.

Friendly Reminder

To ensure your lock functions at its best, we recommend replacing the battery every 6 months. (The battery life largely depends on the battery quality, usage, and conditions) We recommend removing the battery when the lock is not in use for an extended period.

05

PACKAGING LIST & PRODUCT PROMISE

Item	Quantity
Electronic Lock	1 (Piece)
AA Battery	4 (Cells)
Remote Key	2 (Pieces)
Protective Cover	1 (Unit)
Door Frame Plate	1 (Block)
Lock Plate	1 (Block)
Screwdriver	1 (Piece)
Cross Slot Pan Head Combination Screw M4*22	4 (Pieces)
Cross Slot Pan Head Combination Screw M4*14	1 (Unit)
Cross Countersunk Screw M4*12	2 (pieces)
Cross Pan Head Self-tapping Screw ST4.8*18	2 (pieces)

I. Product Quality Commitment

The electronic lock is designed, produced, and tested strictly in accordance with national standards and industry norms, ensuring that each electronic lock possesses excellent performance and reliable quality.

We select premium raw materials and advanced production processes to guarantee the durability and stability of the product. From the lock core to the exterior shell, from electronic components to mechanical structures, every part has been carefully selected and rigorously tested to ensure it meets high quality standards.

The brand has a complete quality control system, strictly monitoring every link in the production process to ensure consistent product quality. We conduct comprehensive testing on every electronic lock that leaves the factory to ensure its functionality is normal, performance is stable, and it is safe and reliable.

II. Product Safety Commitment

The electronic lock complies with national laws, regulations, and relevant safety standards, providing reliable anti-theft, anti-pry, and anti-violent unlocking functions. Our electronic lock employs advanced encryption technology and security mechanisms to ensure the safety of users' property and personal safety.

The product has undergone rigorous safety testing, including physical strength tests, electronic interference tests, and password cracking tests, to ensure its good safety performance in various complex environments.

We provide customers with detailed user manuals and safety tips to help them use the electronic lock correctly, enhance safety awareness, and avoid security risks caused by improper use.

III. After-Sales Service Commitment

Shengjiu offers high-quality after-sales service, and we have a professional after-sales team ready to provide customers with technical support and solutions at any time. If customers encounter any issues during use, they can contact our after-sales personnel at any time, and we will resolve the issues for you as soon as possible.

We provide a limited warranty service for our electronic locks. During the warranty period, if the product has quality issues, we will repair or replace it for the customer free of charge.

We continuously improve and perfect our after-sales service system to enhance service quality and efficiency, in order to meet customer needs and expectations.

IV. Legal and Regulatory Commitments

Shengjiu strictly adheres to national laws and regulations as well as relevant advertising laws, ensuring that product promotions are truthful, accurate, and legal. We will not engage in false advertising, exaggerated claims, or misleading behavior towards consumers.

Finally, we sincerely thank you for your trust and support of the Shengjiu brand. We will continue to uphold a customer-centric approach, constantly improving product quality and service levels, to provide you with higher quality, safer, and more reliable electronic lock products.

This device complies with part 15 of the FCC Rules. Operation is subject to the following two conditions: (1) This device may not cause harmful interference, and (2) this device must accept any interference received, including interference that may cause undesired operation.

FCC warning:

Any Changes or modifications not expressly approved by the party responsible for compliance could void the user's authority to operate the equipment.

Note: This equipment has been tested and found to comply with the limits for a Class B digital device, pursuant to part 15 of the FCC Rules. These limits are designed to provide reasonable protection against harmful interference in a residential installation. This equipment generates uses and can radiate radio frequency energy and, if not installed and used in accordance with the instructions, may cause harmful interference to radio communications. However, there is no guarantee that interference will not occur in a particular installation. If this equipment does cause harmful interference to radio or television reception, which can be determined by turning the equipment off and on, the user is encouraged to try to correct the interference by one or more of the following measures:

- Reorient or relocate the receiving antenna.
- Increase the separation between the equipment and receiver.
- Connect the equipment into an outlet on a circuit different from that to which the receiver is connected.
- Consult the dealer or an experienced radio/TV technician for help.

For RV-LOCK:

This equipment complies with FCC radiation exposure limits set forth for an uncontrolled environment. This equipment should be installed and operated with minimum distance 20cm between the radiator & your body.

For Keys:

The device has been evaluated to meet general RF exposure requirement. The device can be used in portable exposure condition without restriction.

IC warning

This device contains licence-exempt transmitter(s)/receiver(s) that comply with Innovation, Science and Economic Development Canada's licence-exempt RSS(s). Operation is subject to the following two conditions: (1) this device may not cause interference, and (2) this device must accept any interference, including interference that may cause undesired operation of the device.

Le présent appareil est conforme aux CNR d'Innovation, Sciences et Développement économique Canada applicables aux appareils radio exempts de licence. L'exploitation est autorisée aux deux conditions suivantes: (1) l'appareil ne doit pas produire de brouillage, et (2) l'utilisateur de l'appareil doit accepter tout brouillage radioélectrique subi, même si le brouillage est susceptible d'en compromettre le fonctionnement.

For RV-LOCK:

This equipment complies with IC RSS-102 radiation exposure limits set forth for an uncontrolled environment. This equipment should be installed and operated with minimum distance 20cm between the radiator & your body.

Pour RV-LOCK:

Cet équipement est conforme aux limites d'exposition aux rayonnements IC établies pour un environnement non contrôlé. Cet équipement doit être installé et utilisé avec un minimum de 20cm de distance entre la source de rayonnement et votre corps.

For Keys:

The device has been evaluated to meet general RF exposure requirement. The device can be used in portable exposure condition without restriction.

Pour Keys:

L'appareil a été évalué pour répondre aux exigences générales d'exposition aux RF. Le dispositif peut être utilisé dans des conditions d'exposition portatives sans restriction.