

User Manual

Electronic scooter

please read the user manual and warranty certificate carefully before use it

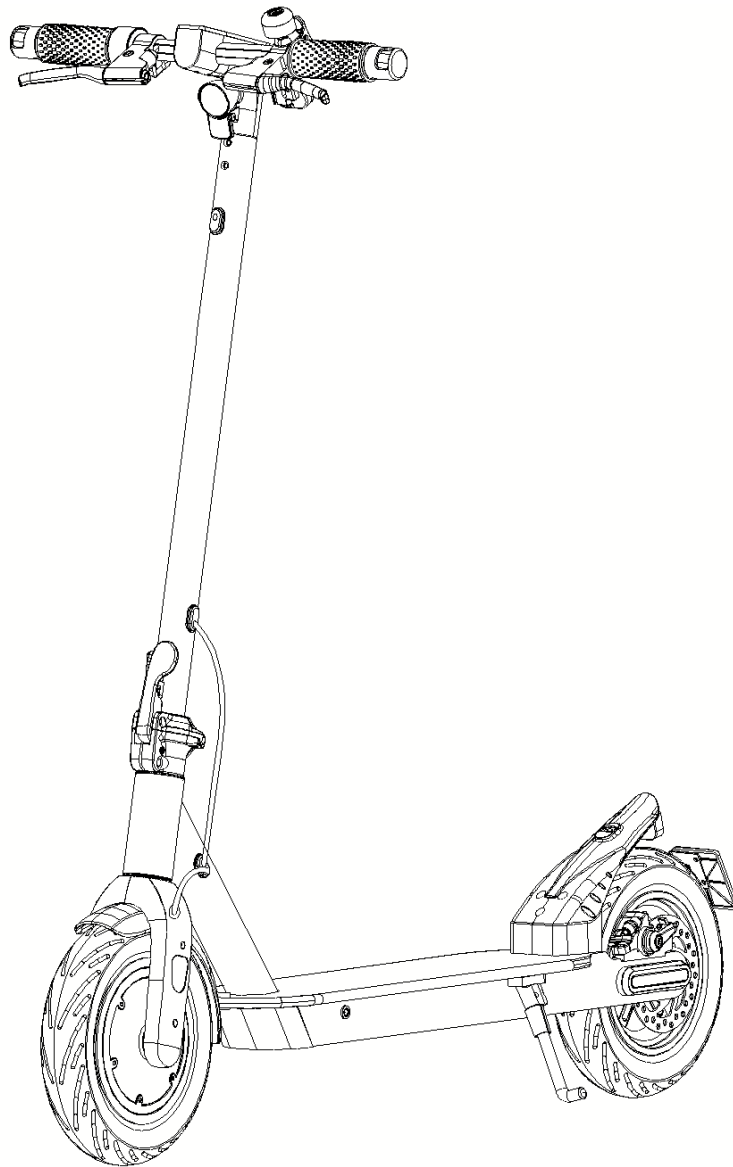

Safety introductions

1. This product is an electric scooter for adults. It is limited to one adult only and not carry people at the same time.
2. Please wear a safety helmet and other protective equipment when riding this product
3. Never ride this product in unsafe or illegal areas.
4. Please practice in the open space and avoid riding on the road before you are skilled enough to ride.
5. Do not behave dangerously or riding with one hand when you are riding, and keep your feet on the scooter.
6. Do not attempt to go directly through the step of 3 cm or more, which may subvert the car, and cause the driver's injury or vehicle damage, and try to avoid the steps below 3cm.
7. The max speed is 25km/h, To ensure safe driving . Please try to avoid using it at night
8. Do not use this product at a temperature below -5 degrees
9. Please slow down carefully or walk when meet the uneven road or poor-conditioned road.
10. Do not ride on the surface with oil or ice
11. Adjust the height of the product to its proper position according to your height to ensure the safety of driving.
12. Do not allow the product to be immersed in 4 cm of water or directly by water to avoid the electric power part of damages. in this case we will not take the responsibility to change the parts
13. In inclement weather such as rain and snow, please avoid riding as much as possible, so as not to cause unnecessary damage due to unnecessary factors

Main Parts name

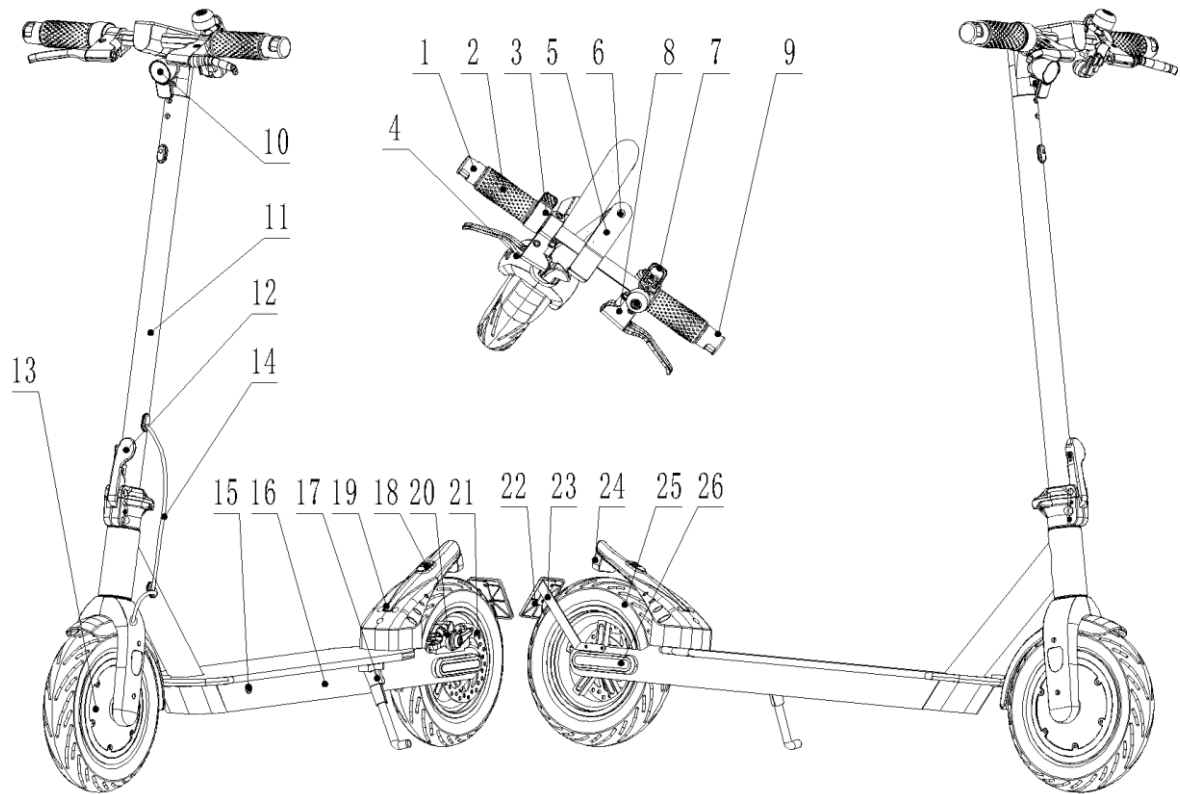

1.Left Turn signal light

2.handle grip

3.speed throttle

4.Right handle brake

5.display

6.button

7.Folding hook

8.left handle brake

9.turn signal light

10.front light

11. folding tube

12.folding buckle

13.motor

14.brake wire

15.charger port

16.frame

17.stand

18.folding hanger

19.mudguard

20.disc brake

21.disc brake plate

22.license plate

23.license plate frame

24.brake light

25.rear motor

26.side reflector

Product folding state

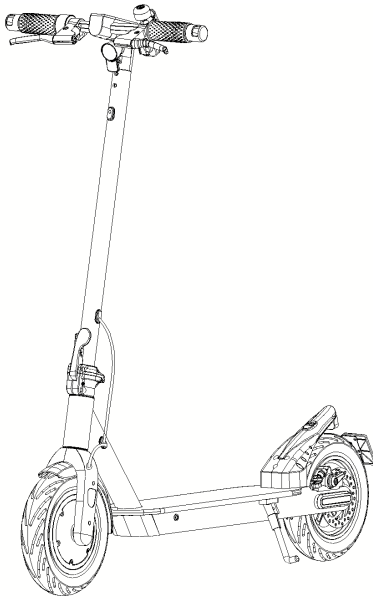

A-expansion

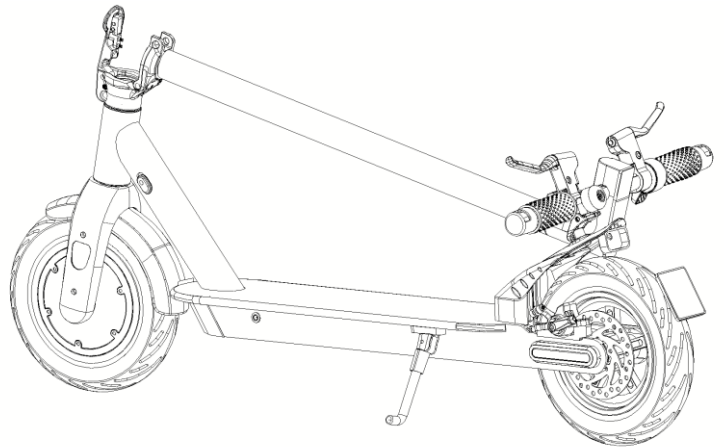

B- folding

Folding instruction

1.lift the slide buckle up(step A), then pull the folding lever out(step B), then Fold the T-bar

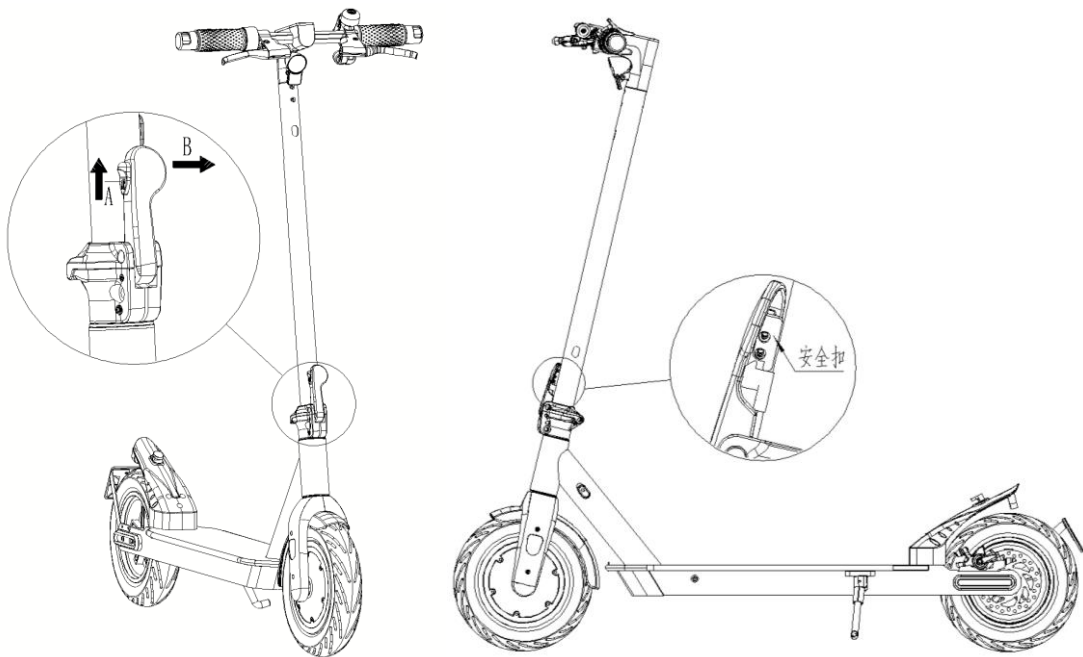

2. put down the T-bar to make the upper hang buckle fit into the hang buckle seat

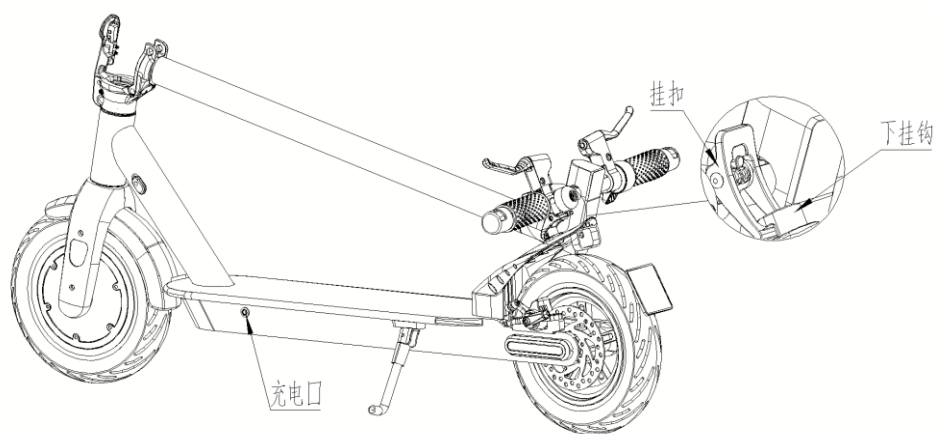

3.the expansion step is the opposite of the folding step

Operating instructions

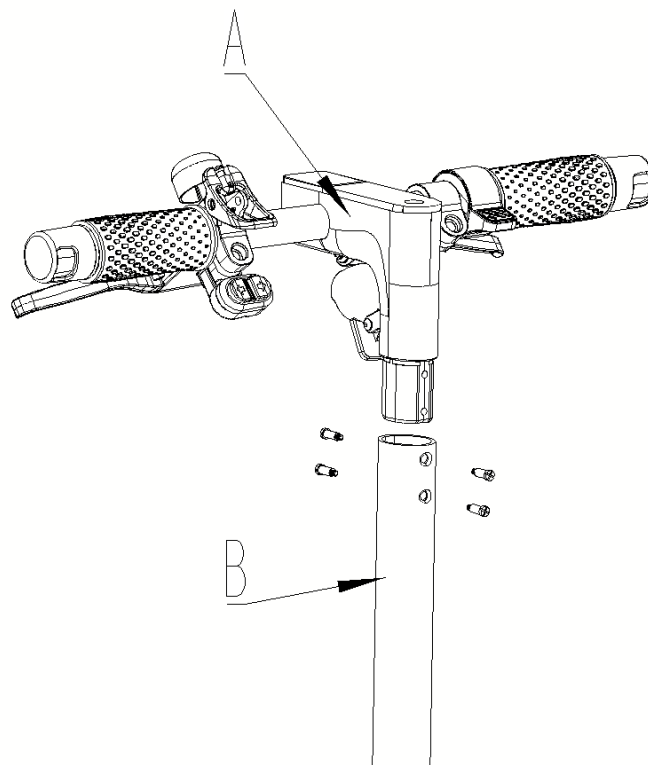

1. pls inset the T-bar(A) into the tube(B),then tight the 4 screws

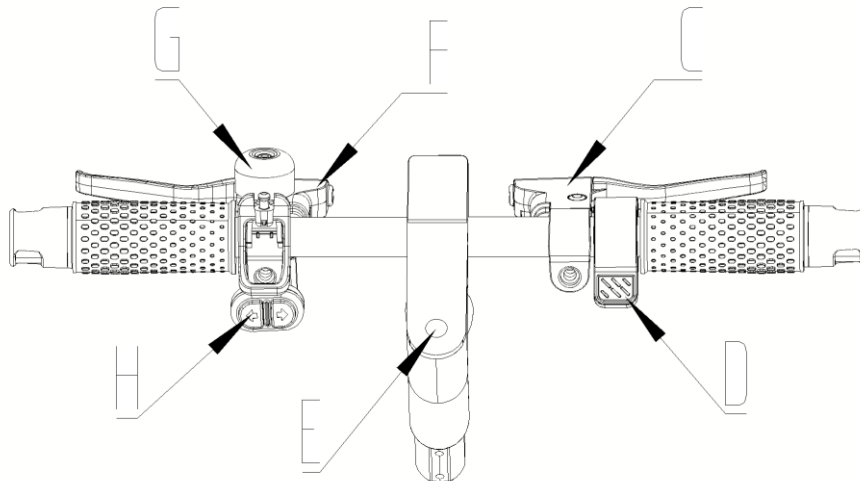

2. pls check all the parts,make sure that all of the have been fixed

3. Press the start throttle(part A) to start the scooter

4. In the above Pic, B is the speed throttle. Pushing it down accelerates the scooter, releasing it stops acceleration. C is the electric brake, D is the power switch, and E is the disc brake.

DISPLAY:

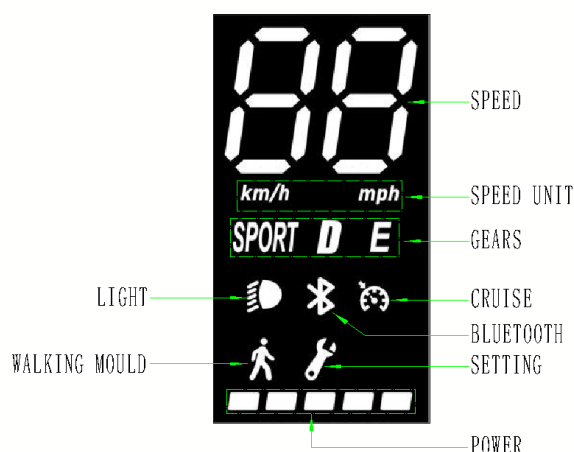

Function Settings:

1. Long press the button for 2S to turn on/off the device.
2. In the on state: Press twice to change the gear. The Walking mode with a speed of 6km/h, The gear E mode with a speed of 15 KM/H - D mode with a speed of 20KM/H - Sport mode with a speed of 25KM/H
3. Short press once to enable or disable the headlight function.
4. Short press three times to switch between miles and kilometers.
5. Fault code display: In case of a fault, the mileage will automatically display the fault code.

Serial number	Failure code	Remarks
1.	E09	Sub-motor communication failure (abnormal communication between main control and sub-control) "Non-dual-wheel drive models ignored"
2.	E10	Communication failure (abnormal communication between instrument and controller)
3.	E11	The motor current sensor is abnormal
4.	E14	Accelerator failure

5.	E15	Brake handle failure
6.	E16	Motor Hall failure
7.	E19	Sub-motor Hall abnormality (ignored for non-dual-wheel drive models)
8.	E21	Battery BMS abnormal
9.	E50	Overpressure (bus voltage is too high)
10.	E55	The controller temperature is too high
11.	E57	Motor temperature protection
12.	E58	Battery temperature protection

Disc brake instructions

1. we will adjust each scooter's disc brake before packing in order to reach the best brake effect, if there is a little sound between the brake device and plate, it is normal and will disappeared after ride several times

2. After using the scooter for a period of time, the disc brake should be adjusted to ensure the effective braking effect

Step 1: adjust the nut (NO 2) outward, and lock the nut (NO 1) after adjustment to prevent loosening



Step2.

loose the nut, pull the brake wire to make the brake arm forward, shorten the braking stroke, then tighten the nut, check the effect after all the steps, if the effect not very good, repeat all the steps to reach the best effect

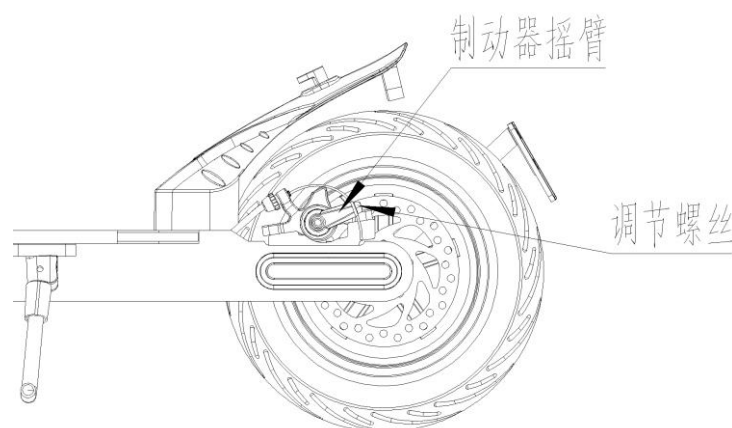

Riding operations

A. preparing

1. Wear safety helmet and protective pads, before use the scooter
- 2 Choose a place suitable for riding
- 3 Expand the product according to the instructions
- 4 Adjust the height of the T pipe according to your height

B. Starting

1. When all the preparations are finished, Press the battery switch to turn on the power(fig 9)
2. One foot on the deck, and the other one push the scooter on the ground. After the car starts sliding, the other foot is placed on the deck, press the starting level, the scooter slowly speed up.

C. Parking

1. Press the handle brake, the car will immediately power off and braked.

Battery and charger

1. Each electric scooter produced by our company is equipped with special lithium battery and special intelligent charger. Do not use other brand's charger to charge it. Also the other types of scooters should not be charged with our charger. Therefore, the battery or charger damage in that case, we will not responsible for the damage.

2. when you use the scooter first time, please charge the battery fully before use,

3. Our company's lithium battery charge can be recharged for at least 800 times, if the riding range is shorter In case of every full charge, the subsequent lithium battery should be replaced.

4. The charger provided by our company has the function of charging protection. When the battery 100% is full, it will automatically power-off and the green light will be displayed . The charge time is 5-6hours.

5. The charging instructions:

Open the charging cap, the charger plug is inserted into the charging port, and the other end of the charger is inserted into the socket. the red light of the charger indicates that it is charging, and please pull out the charger when the light became green, the power is full

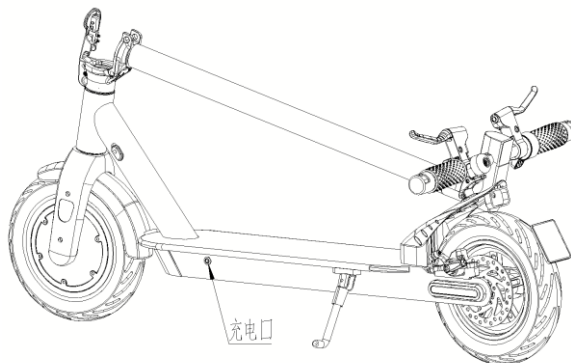

placement and Maintenance

1. Please keep it clean and don't park it outdoor or other serious moist places for longtime.
2. Please ensure the brake is flexible before riding each time, pls ensure all the components are flexible and the bolt fasteners are tightening.
3. the folding part need to add some grease in every three or four months, .
- 4.warning: If the scooter won't be in use for a long time, it should be fully charged, turn off the power switch and recharge within four months, otherwise the battery will be damaged.

If the above situation :water, collision Long stock without charging and other abnormal factors caused battery damage, it won't be in the scope of warranty

Soling method of general problems

If the scooter has failures that cannot be used, please contact your seller in time. Do not repair it by yourself

Product specification

project name	parameter name	parameter
product spec	the size of expansion	1150*480*1160MM
	the size of folding	1170*170*530MM
	Weight	12.5Kg
product performance	max loading	100Kgs
	max speed	25Km/h
	climbing ability	15%
	range	25km
battery	Standard voltage	36V
	battery type	Lithium battery
	battery capacity	7.8AH
motor	motor type	brushless DC hub-motor
	Rated output power	350W
	Rated voltage	36V
Charger	input voltage	110V-220V
	Charging time	5-6h

FCC Warning

This device complies with Part 15 of the FCC Rules. Operation is subject to the following two conditions:

(1) This device may not cause harmful interference, and (2) this device must accept any interference received, including interference that may cause undesired operation.

NOTE 1: This equipment has been tested and found to comply with the limits for a Class B digital device, pursuant to part 15 of the FCC Rules. These limits are designed to provide reasonable protection against harmful interference in a residential installation. This equipment generates, uses and can radiate radio frequency energy and, if not installed and used in accordance with the instructions, may cause harmful interference to radio communications. However, there is no guarantee that interference will not occur in a particular installation. If this equipment does cause harmful interference to radio or television reception, which can be determined by turning the equipment off and on, the user is encouraged to try to correct the interference by one or more of the following measures:

- Reorient or relocate the receiving antenna.
- Increase the separation between the equipment and receiver.
- Connect the equipment into an outlet on a circuit different from that to which the receiver is connected.
- Consult the dealer or an experienced radio/TV technician for help.

NOTE 2: Any changes or modifications to this unit not expressly approved by the party responsible for compliance could void the user's authority to operate the equipment.

The device has been evaluated to meet general RF exposure requirement. The device can be used in portable exposure condition without restriction.