

QS2 Smart Glasses Camera User Manual

1. Exploded View of the Product

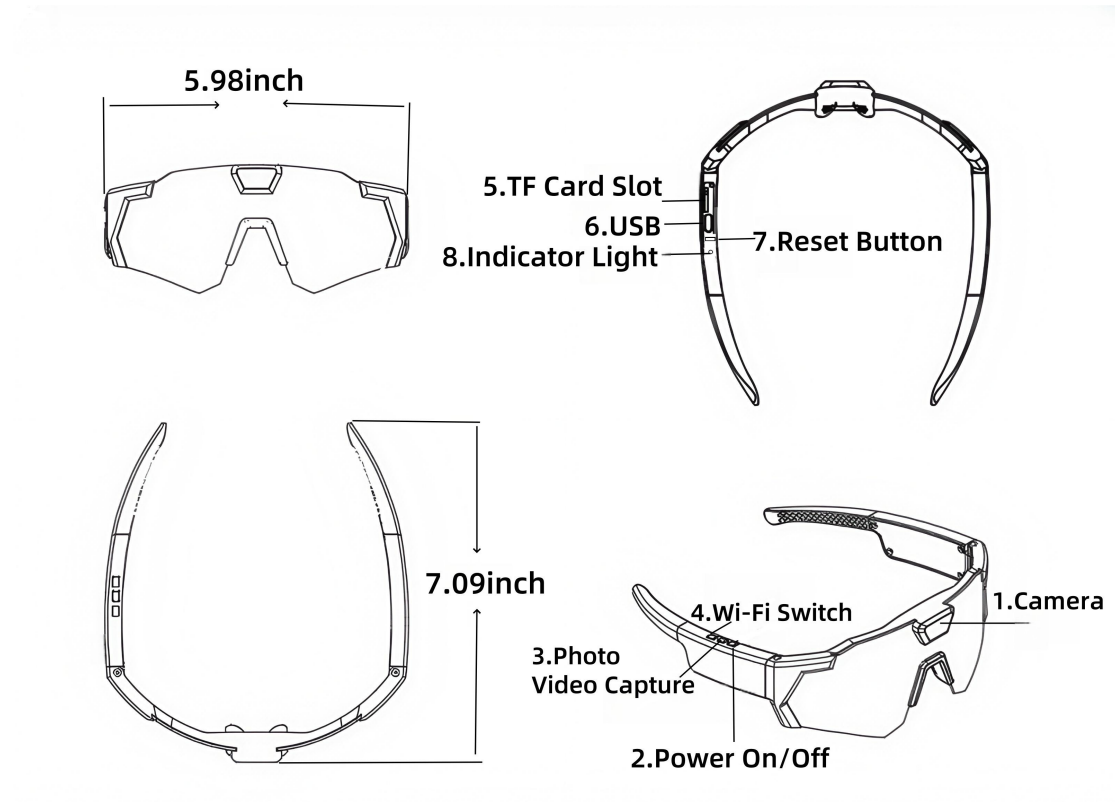

(1) Camera (2) Power On/Off (3) Photo/Video Capture (4) Wi-Fi Switch (5) TF Card Slot (6) USB (7) Reset Button (8) Indicator Light

2. APP Download

- (1) Scan the QR code with your phone to download the (Viidure) app
- (2) In the mobile app store, search for the (Viidure) software and click to download, as shown in the picture:

Recorder APP QR code:

English Search:viidure

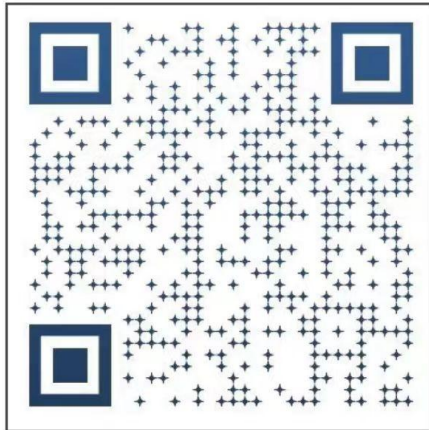

Access the mobile phone application market (Android or Apple app shop) search for APP: viidure, click to download and install. Or WeChat scan the code to download and allow the installation of information services and camera access.



Apple Store



Google Play



国内下载



Viidure

Photo & Video

Open

★★★★☆ 7.2K

Shenzhen Xiaozhen Te...

No. 31 Photo & Video



WayCam DVR

Photo & Video

Get

★★★☆☆ 1.2K

Shenzhen huiying technolo...

Photo & Video

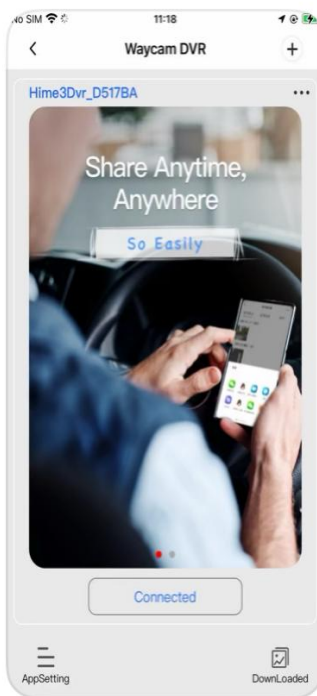

3. Precautions for Using This Device

- (1) . A memory card must be installed in the device for it to function.
- (2) . The Wi-Fi signal from the camera has a connection range of approximately 6 meters with the phone.
- (3) . Videos captured are only in preview mode within the APP; sound is available only after downloading to the phone.
- (4) . When enabling the Wi-Fi hotspot to connect to the phone, recording must be paused first for the hotspot to appear.
- (5) . The live feed clarity between the APP and the phone is compressed for real-time preview. However, videos saved to the phone or memory card retain their original quality.
- (6) . Follow the APP prompts and allow all necessary permissions.

(7) . If the device freezes due to low battery or improper operation, press the reset button to restore it.

(8) . There are two ways to use the camera for recording:

First Method:

- The camera does not need to be connected to the phone; simply use the function buttons to record.

- Recorded videos must be downloaded and played back via the mobile APP.

- Note: During recording, the phone cannot be connected to the APP. Pause recording first before operating the APP.

Second Method:

- Connect the phone to the camera' s Wi-Fi signal.

- Then, use the APP interface to control various functions.

4. Functional Operation Instructions

(1) Power On:

- Press and hold the power button for about 3 seconds.
- The device will vibrate continuously for about 2 seconds, and the blue LED will stay on, indicating that it is powered on.

(2) Power Off:

- While the blue LED is on (powered on), press and hold the power button.
- The device will vibrate twice, and the LED will turn off, indicating that it is powered down.

(3) Take a Photo:

- While the blue LED is on (powered on), briefly press the photo/video button once.
- The device will vibrate once, and the blue LED will blink once, confirming that a photo has been taken. Repeat as needed.

(4) Start Recording:

- While the blue LED is on (powered on), press and hold the photo/video button for about 3 seconds.
- The device will vibrate twice, and the blue LED will start blinking, indicating that recording has begun.

(5) Stop Recording:

- During recording, briefly press the photo/video button once.
- The device will vibrate once, and the blue LED will stay on, indicating that recording has stopped.

(6) Turn On Wi-Fi:

- While the blue LED is on (powered on), briefly press the Wi-Fi button once.

- The device will vibrate three times, and the red and blue LEDs will alternate blinking, indicating that Wi-Fi is enabled.

(7) Turn Off Wi-Fi:

- While the red and blue LEDs are alternating (Wi-Fi on), briefly press the Wi-Fi button once.
- The blue LED will stay on, indicating that Wi-Fi has been turned off.

(8) Charging:

- The red LED will blink during charging.
- When fully charged, both the red and blue LEDs will stay on.

(9) Connecting to a Computer:

- When connected to a computer, the red and blue LEDs will blink twice, then the blue LED will stay on.

(10) Low Battery Shutdown:

- If the battery is low, the red LED will blink 10 times before the device shuts down.

(11) No Memory Card Shutdown:

- If powered on without a memory card, the red and blue LEDs will blink rapidly 10 times before the device turns off.

(12) Modifying Date & Time for Recordings:

- Connect the camera to a computer using a USB cable.
- Open **"My Computer"**, then access the removable disk.
- Open the **"time.txt"** file and modify the date and time (ensure the format remains unchanged).
- Refer to the provided image for guidance.

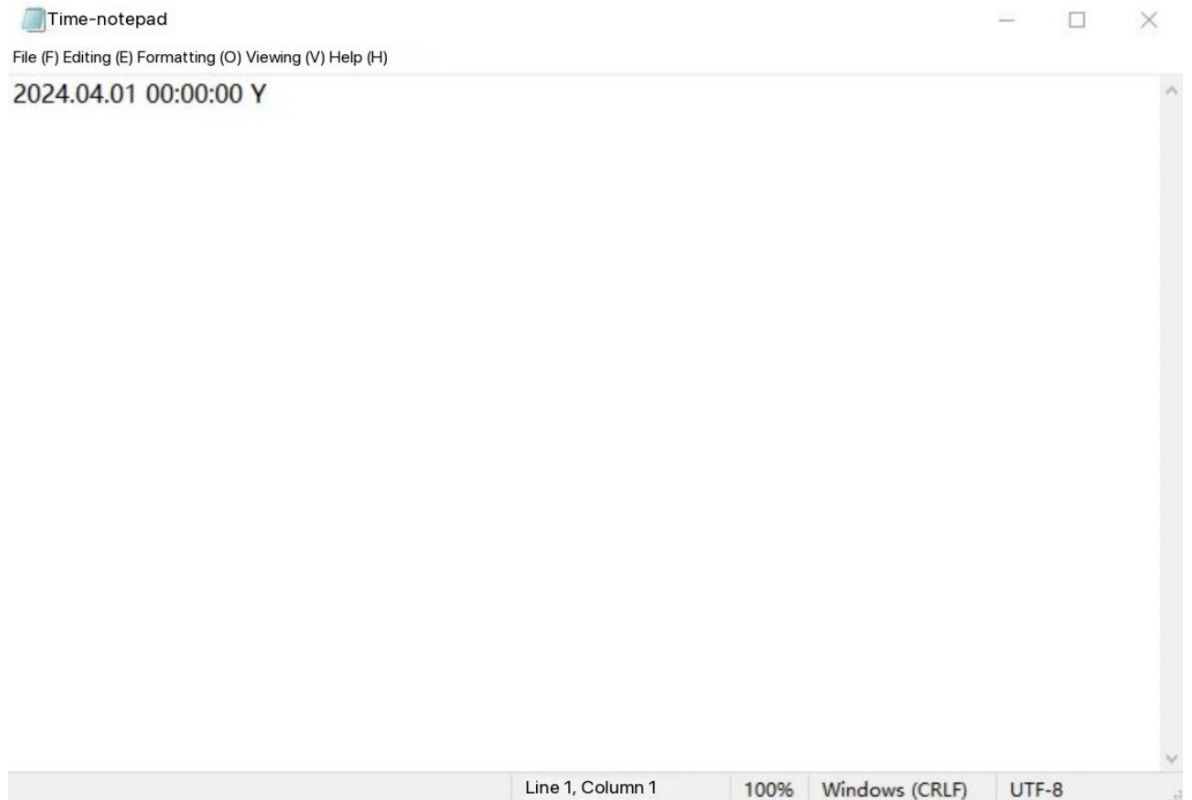

5.APP Functions

Connecting to Phone via Wi-Fi Hotspot

- (1) When Wi-Fi is enabled, the red and blue LEDs will blink alternately, indicating that the Wi-Fi hotspot is active.
- (2) Open your phone ' s Wi-Fi settings and locate the network starting with *****QS2-*****, then connect to it (as shown in ****Figure 1****).
- (3) Once connected, open the (Viidure) APP and tap *****Add Camera***** (as shown in ****Figure 2****).
- (4) Next, tap *****Add Camera***** (as shown in ****Figure 3****) to enter the live view interface.
 - The device will automatically start recording upon connection.
 - You can pause recording via the APP (as shown in ****Figure 4****).

Note: If the connection fails:

- Return to your phone ' s Wi-Fi settings to confirm a stable connection to the *****QS2-***** network.
- Reopen the (Viidure) APP and retry the connection steps.

(Figures referenced in instructions should be included for visual guidance.)

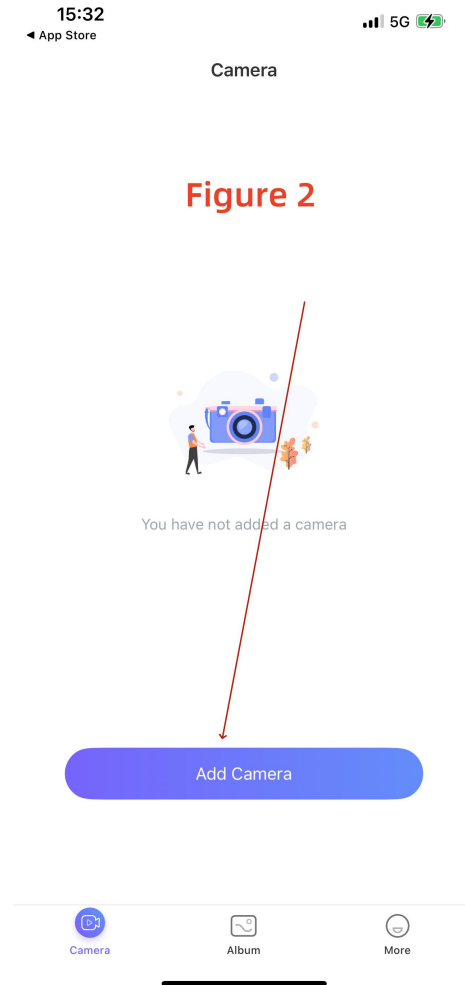
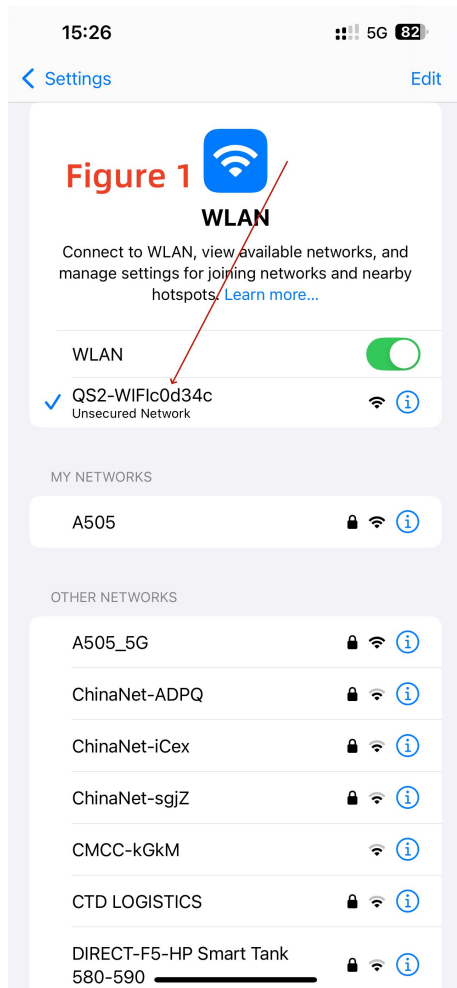

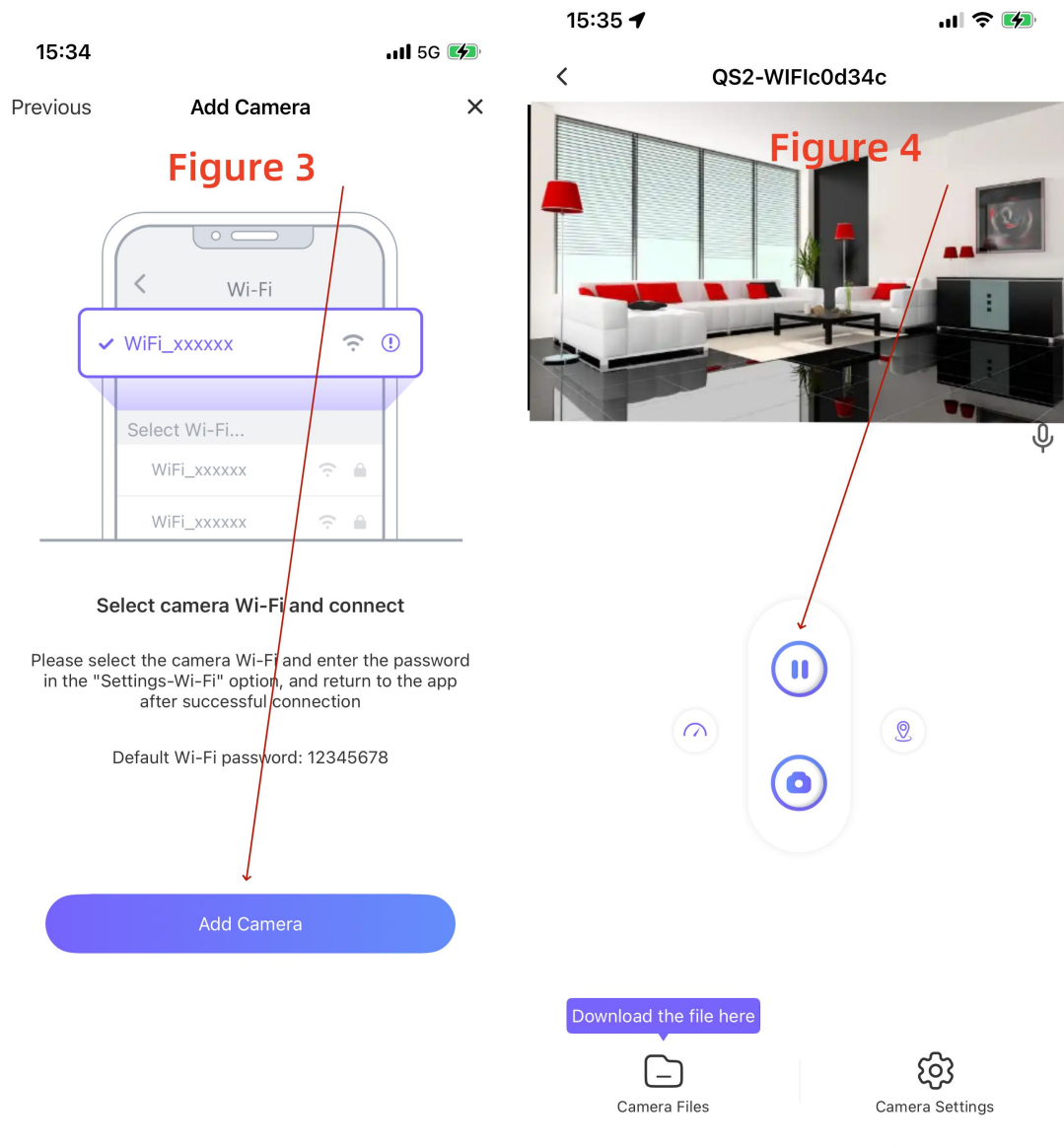

6. App Introduction

(1) . Can connect with your phone for real-time photo taking and viewing. Note: Real-time preview has no sound; after shooting, you need to download the file to hear the audio.

(2) . Dashcam settings allow you to customize various parameters according to your needs.

V. Specifications

Battery Capacity: 500mAh

Recording Duration: Approximately 2 hours (when the app is not running)

Video Quality:

- 1080FHD (1920×1080)
- 1080P (1440×1080)
- 720P (1280×720)

Photo Resolution:

- 12MP (4032×3024)

- 10MP (3648×2736)
- 8MP (3264×2736)
- 5MP (2592×1944)
- 3MP (2048×1536)
- 2MHD (1920×1080)
- 1.3MP (1280×960)
- VGA (640×480)

Loop Recording: 1 min / 2 min / 3 min / 5 min

Exposure Compensation:

+2.0, +1.67 (+5/3), +1.33 (+4/3), +1.0, +0.67 (+2/3), +0.33 (+1/3), 0.0,
-0.33 (-1/3), -0.67 (-2/3), -1.0, -1.33 (-4/3), -1.67 (-5/3), -2.0

Power Frequency: 50Hz / 60Hz

FCC Caution:

This device complies with part 15 of the FCC Rules. Operation is subject to the following two conditions: (1) This device may not cause harmful interference, and (2) this device must accept any interference received, including interference that may cause undesired operation.

Any changes or modifications not expressly approved by the party responsible for compliance could void the user's authority to operate the equipment.

NOTE: This equipment has been tested and found to comply with the limits for a Class B digital device, pursuant to Part 15 of the FCC Rules. These limits are designed to provide reasonable protection against harmful interference in a residential installation. This equipment generates, uses and can radiate radio frequency energy and, if not installed and used in accordance with the instructions, may cause harmful interference to radio communications. However, there is no guarantee that interference will not occur in a particular installation.

If this equipment does cause harmful interference to radio or television reception, which can be determined by turning the equipment off and on, the user is encouraged to try to correct the interference by one or more of the following measures:

- Reorient or relocate the receiving antenna.
- Increase the separation between the equipment and receiver.
- Connect the equipment into an outlet on a circuit different from that to which the receiver is connected.
- Consult the dealer or an experienced radio/TV technician for help.

The device has been evaluated to meet general RF exposure requirement. The device can be used in portable exposure condition without restriction.