

DingDang Screen Mirroring

User Manual

Thank you for choosing our products. Please read this manual before use to know more about the practical functions and simple operation methods.

Vertical screen display can be realized on TikTok; short pressing the small buttons on the device to switch vertical screen and horizontal screen display.

I. Device connection:

1. Connect devices as per the schematic diagram.



2. Switch TV to HDMI signal source, the following scene appears;



II. Select proper steps based on your phone models

iPhone models, no Wi Fi

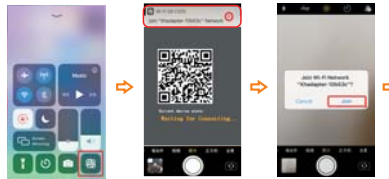

1. Turn on camera and zoom at QR code;
2. Click the prompt at top screen;
3. Click "Join in" and wait 30sec;



4. Swipe home screen, click "Screen Mirroring/Airplay";
5. Click "Xhadapter-xxxxxx";
6. Mobile screen displays on TV (press the button on screen transmitter side to switch vertically and horizontally display);

iPhone mobile, with Wi Fi

1. Add "Xhadapter" network into Wi Fi list

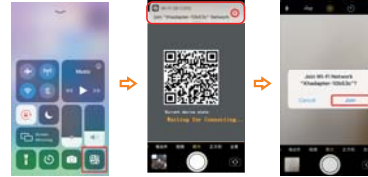

1. Turn on camera and zoom at QR code;
2. Click the prompt at top screen;
3. Click "Join in" and wait 30sec;



4. Update interface and zoom at QR code, then click prompt at top screen;
5. Wait 15sec to have all Wi-Fi signal displayed, select your Wi-Fi;
6. Input your Wi-Fi password, click "Connect";

2. To display mobile files, TikTok, online courses and others, the mobile has to be connected to same Wi-Fi;

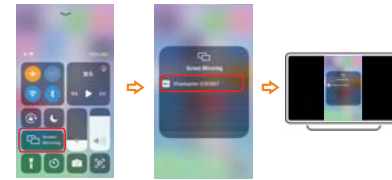

1. Swipe home screen, click "Airplay";
2. Click "Xhadapter-xxxxxx";
3. Mobile screen displays on TV (press the button on screen transmitter side to switch vertically and horizontally display);

3. To realize watching mobile movies on TV while operating other thing on mobile or when mobile is being turned off, the mobile has to be connected with same Wi-Fi; when playing video on TV, click the push icon and select transmitter name, then the video appears on TV;

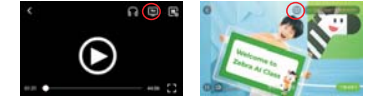

1. Open video App and choose your movie or video;
2. Find "TV" icon on your current mobile screen;

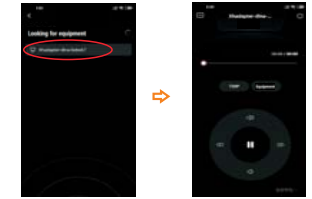

3. Select the transmitter name;
4. After successful pushing, you can adjust the fast forward and volume on your mobile;

Android mobiles, see the back side ➡

Android mobile, no Wi Fi

Android mobiles (Huawei/Samsung/Xiaomi/OPPO)

Mirroring mode:

Note: Not all Android mobiles have the same wireless co-screen function. To realize co-screen, the mobile system must support the function. Different brands of Android mobiles have different ways to set the wireless co-screen function: refer to the User Manual for details;

Xiaomi: setting—connect and share—mirroring;
Meizu: setting—display—mirroring;
HTC: setting—media output;
OPPO: setting—other wireless connection—multi-screen interaction;
Huawei: setting—more connections—mirroring;
Samsung: setting—screen mirroring / co-screen setting—Screen mirroring

Alternatively, download Maxscreen App and install;

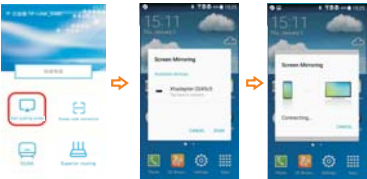

1. Open Maxscreen App → start pushing; maxscreen
2. Search device and select the transmitter name;
3. Connect mobile and transmitter, mobile screen displays on TV (press the button on screen transmitter side to switch vertically and horizontally display);

Android mobile, with Wi Fi

1. Download and install Maxscreen App;
2. Disconnect mobile 4G/5G, and cancel WLAN automatic connection, then follow the steps:



1. Click "scan code to connect router" in Maxscreen;
2. Select your Wi-Fi from the list;
3. Input your Wi-Fi password;

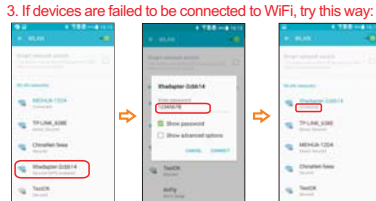

1. Open mobile Wi-Fi and select device name;
2. Input default password 12345678;
3. Successfully connected with Wi-Fi;



4. Open browser and input 192.168.49.1;
5. Select your Wi-Fi from Wi-Fi list;
6. Input your Wi-Fi password, click "Connect";

4. To display mobile files, TikTok, online courses and others on TV, please refer to the mirroring mode operations for Android mobiles without Wi-Fi (Huawei/Samsung/Xiaomi/OPPO);

5. To realize watching mobile movies on TV while operating other thing on mobile or when mobile is being turned off, the mobile has to be connected with same Wi-Fi; when playing video on TV, click the push icon and select transmitter name, then the video appears on TV;

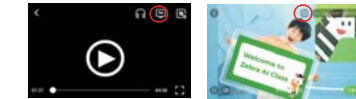

1. Open video App and choose your movie or video;
2. Find "TV" icon on your current mobile screen;

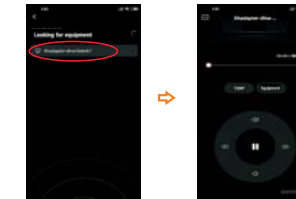

3. Select the transmitter name;
4. After successful pushing, you can adjust the fast forward and volume on your mobile;

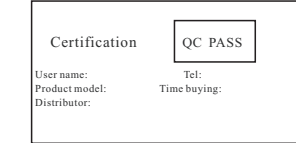

Scan QR code to watch video of device operation



For iPhone mobile

For Android mobile

Warning Statement

This device complies with part 15 of the FCC Rules. Operation is subject to the following two conditions: (1) This device may not cause harmful interference, and (2) this device must accept any interference received, including interference that may cause undesired operation.

Any Changes or modifications not expressly approved by the party responsible for compliance could void the user's authority to operate the equipment.

Note: This equipment has been tested and found to comply with the limits for a Class B digital device, pursuant to part 15 of the FCC Rules. These limits are designed to provide reasonable protection against harmful interference in a residential installation. This equipment generates uses and can radiate radio frequency energy and, if not installed and used in accordance with the instructions, may cause harmful interference to radio communications. However, there is no guarantee that interference will not occur in a particular installation. If this equipment does cause harmful interference to radio or television reception, which can be determined by turning the equipment off and on, the user is encouraged to try to correct the interference by one or more of the following measures:

- Reorient or relocate the receiving antenna.
- Increase the separation between the equipment and receiver.
- Connect the equipment into an outlet on a circuit different from that to which the receiver is connected.

- Consult the dealer or an experienced radio/TV technician for help.

This equipment complies with FCC radiation exposure limits set forth for an uncontrolled environment. This equipment should be installed and operated with minimum distance 20cm between the radiator & your body.