

Football Robot

Assembly Instructions

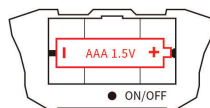

"+" "-" Ends:



One below

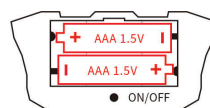

Two above

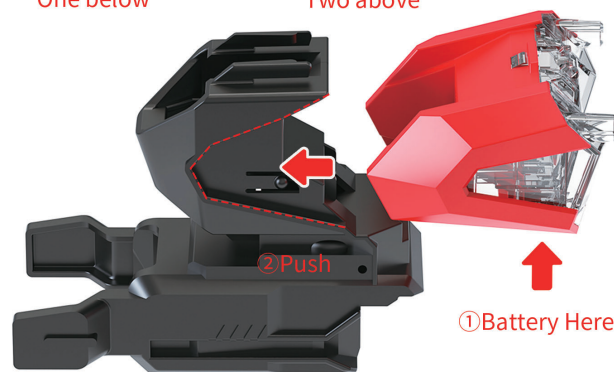

01

Insert 3 batteries into the power compartment and then attach the power compartment to robot body as indicated. A beep shows it's right.

Directions:

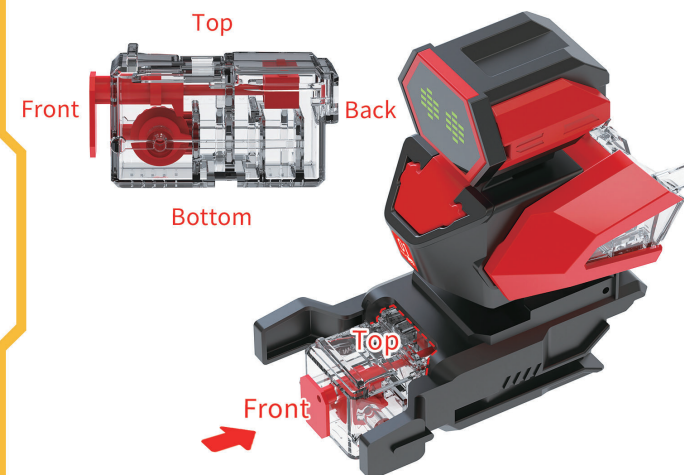

03

Find the shoot piece. Follow the above directions and slide it onto body. You will hear a beep.

Parts:

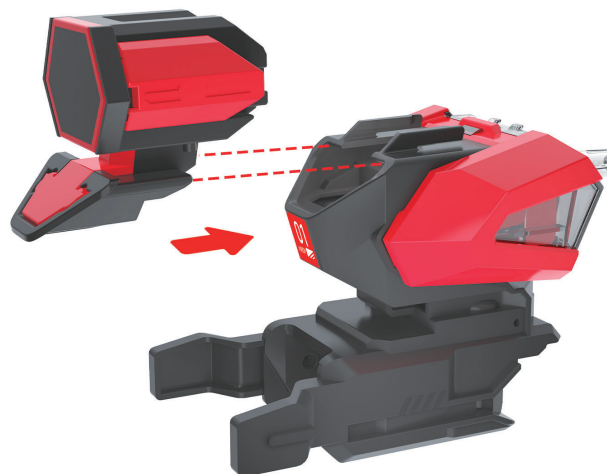
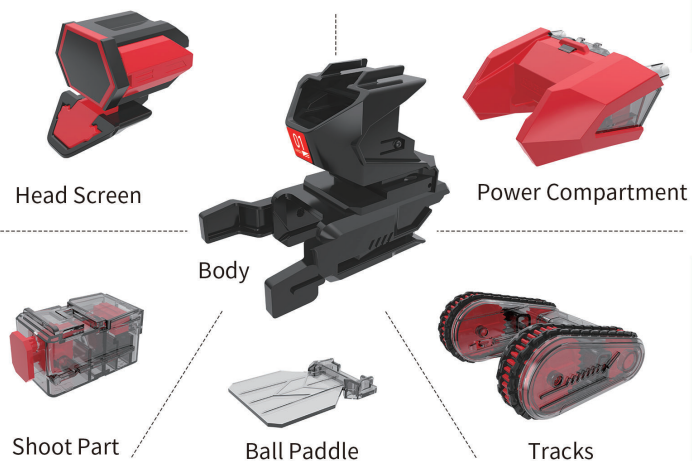

02

Find the head screen. Align its neck to the V-shaped opening on body and push it until you hear either a beep or a click.



04

Take out the tracks and slide it onto the body from the back as indicated above. You'll hear a beep when it's right.



05

Attach the ball paddle to robot as shown above. You'll hear a click when it's in place.

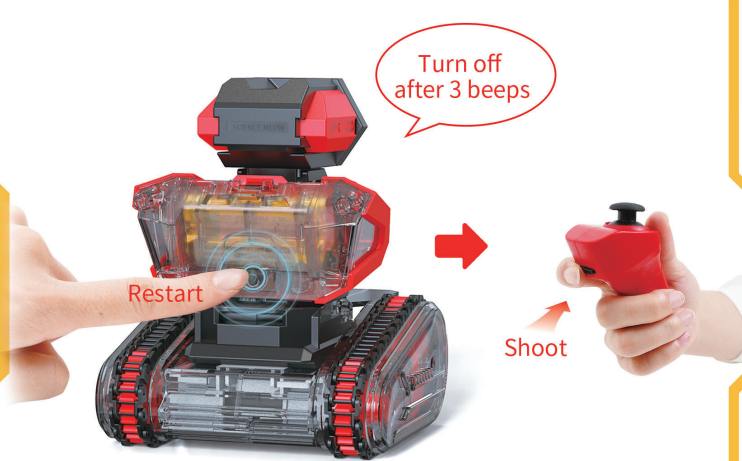

07

Robot will turn off by itself after ten minutes of rest, making a 'beep-beep-beep' sound. Press buttons as shown above to restart and control robot.



06

Insert two batteries into the remote control, making sure to follow +/- marks. It works if light flashes green. Now decorate your robot with stickers and start playing!

Game Rules:



Score 1 point each time the ball enters the opponent's goal. The first to reach 3 points wins.

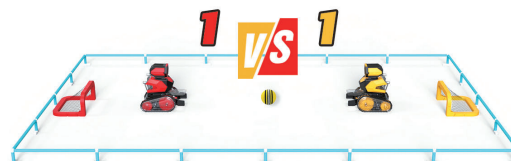

1v1 fence: 6 pieces long, 4 pieces wide

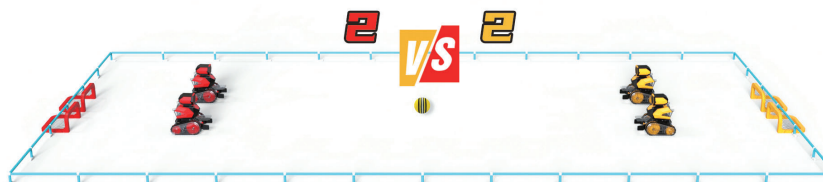

2v2 fence: 12 pieces long, 6 pieces wide

Tip: Use tape to keep the goal and field in place.

This device complies with part 15 of the FCC Rules. Operation is subject to the following two conditions: (1) this device may not cause harmful interference, and (2) this device must accept any interference received, including interference that may cause undesired operation.

Any changes or modifications not expressly approved by the party responsible for compliance could void the user's authority to operate the equipment.

NOTE: This equipment has been tested and found to comply with the limits for a Class B digital device, pursuant to Part 15 of the FCC Rules. These limits are designed to provide reasonable protection against harmful interference in a residential installation. This equipment generates, uses and can radiate radio frequency energy and, if not installed and used in accordance with the instructions, may cause harmful interference to radio communications. However, there is no guarantee that interference will not occur in a particular installation.

If this equipment does cause harmful interference to radio or television reception, which can be determined by turning the equipment off and on, the user is encouraged to try to correct the interference by one or more of the following measures:

- Reorient or relocate the receiving antenna.
- Increase the separation between the equipment and receiver.
- Connect the equipment into an outlet on a circuit different from that to which the receiver is connected.
- Consult the dealer or an experienced radio/TV technician for help.

The device has been evaluated to meet general RF exposure requirement. The device can be used in portable exposure condition without restriction

Note: The remote control car part is purely receiving, there is no RF transmission function