



# **SMD CERAMIC ANTENNA**

## **Data Sheet**

---

# **HZ3215WA01**

# **CA-2450-31-SE**

For 2400-2484MHz  
**3.2x1.6mm [EIA1206]**

China Zhenhua Group Yunke Electronics Co. Ltd.  
No. 268, North Section of Xintian Avenue,  
Wudang District, Guiyang City, Guizhou  
Province, Annex 1

## FEATURES

- Light weight,compact
- Wide bandwidth,lowcost
- Built-in antenna with high gain

## APPLICATIONS

- Bluetooth
- IEEE802.11g/b
- Zigbee systems,etc...

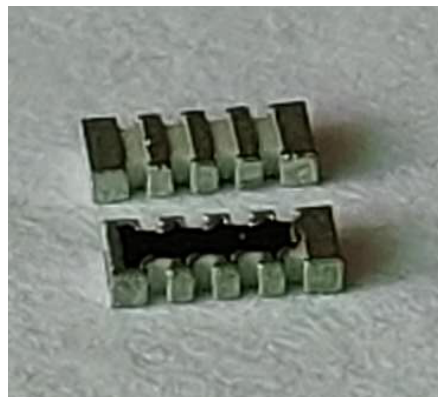

## SHAPES AND DIMENSIONS Dimensions in mm

[Top view]

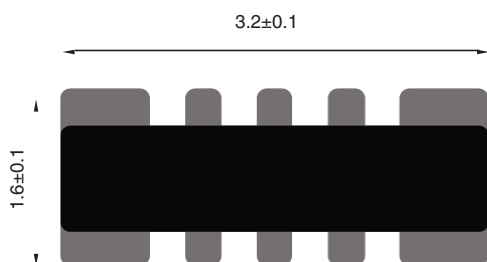

[Bottom view]

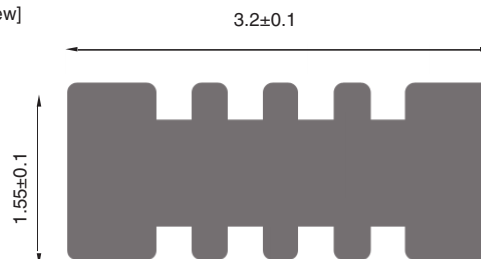

[Side view]

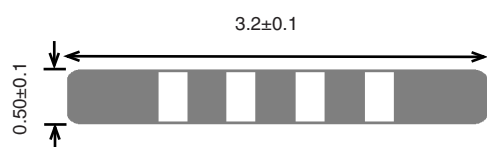

## RECOMMENDED LAND PATTERN



Dimensions in mm

## OLDER RESIST PATTERN

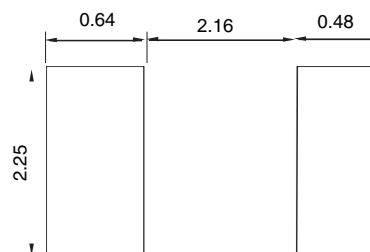

Dimensions in mm



## ELECTRICAL SPECIFICATIONS

Product type	CA-2450-31-SE
Center Frequency Range	2450MHZ
Peak Gain	1.7dBi
Input Impedance	50 $\Omega$

## PART NUMBERING SYSTEM

CA	-	2450	-	31	-	SE
Material		Frequency		Size		Series

■ **EVALUATION BOARD**

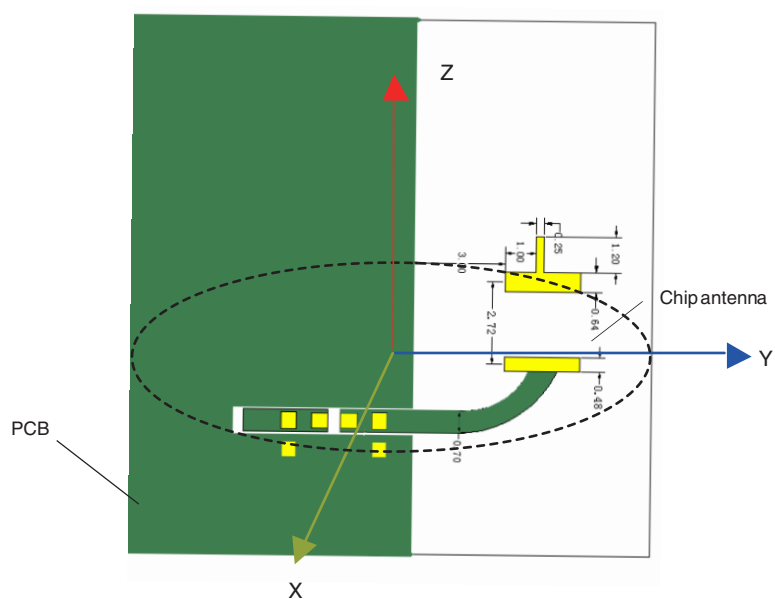
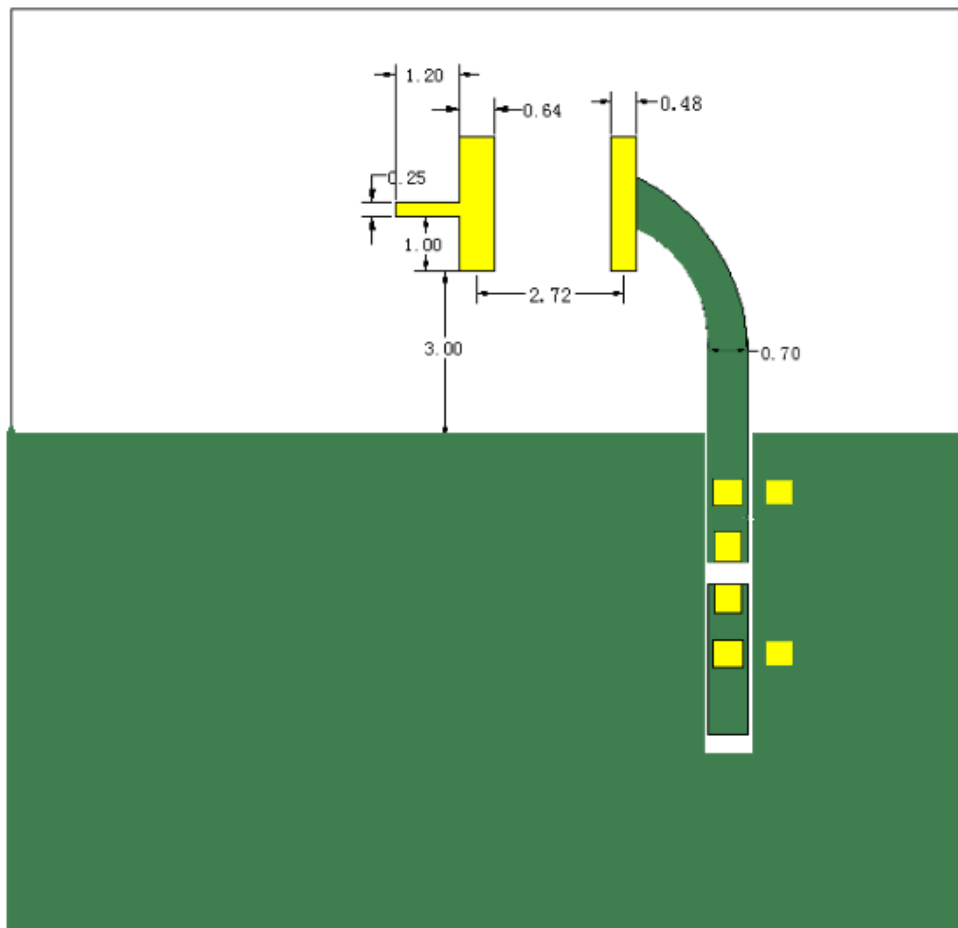

## ■ RADIATION PATTERNS

□ 2.4GHz WLAN BAND

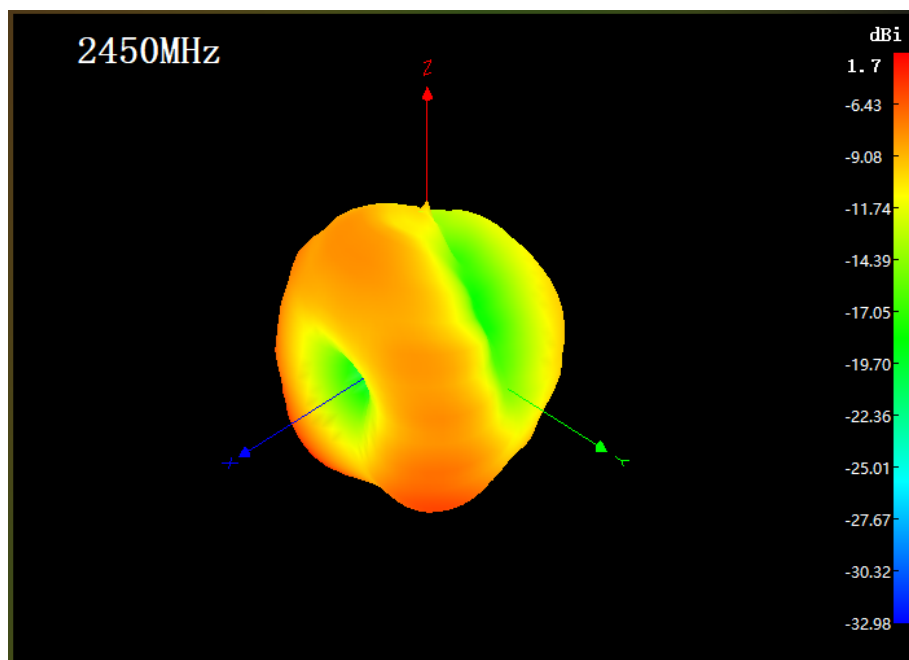

## ■ FREQUENCY CHARACTERISTICS

### □ EFFICIENCY AND VSWR

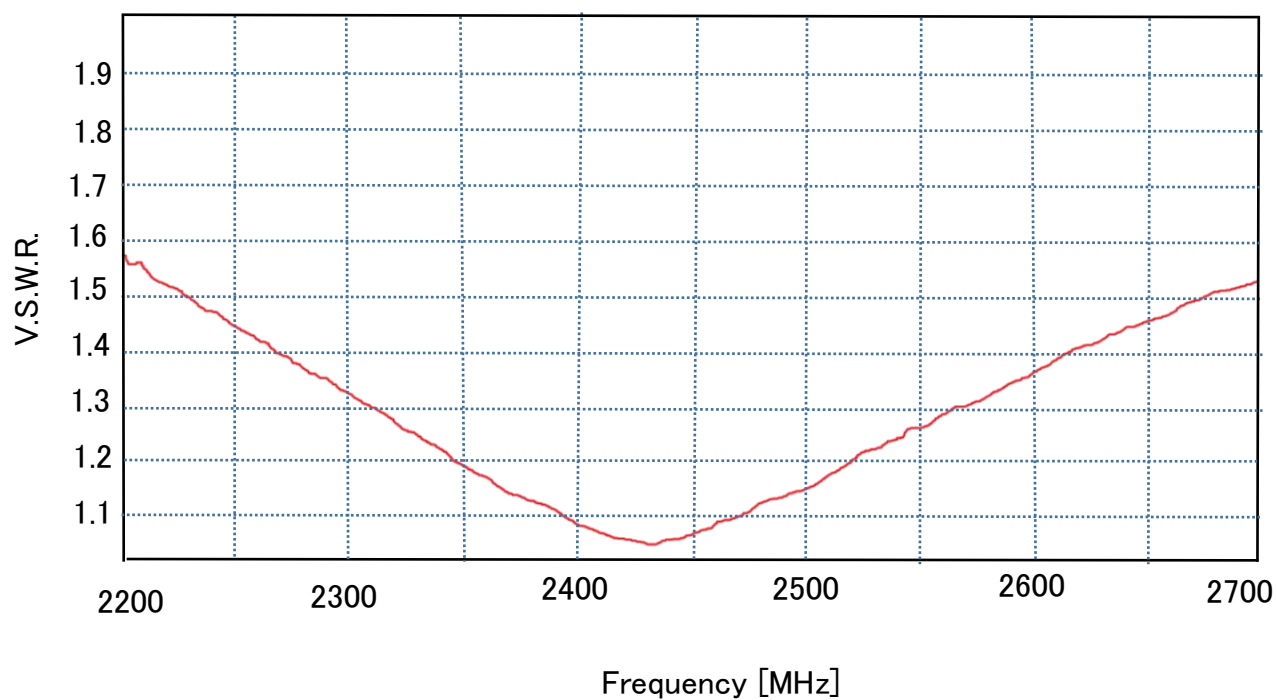

■ **RECOMMENDED REFLOW PROFILE**

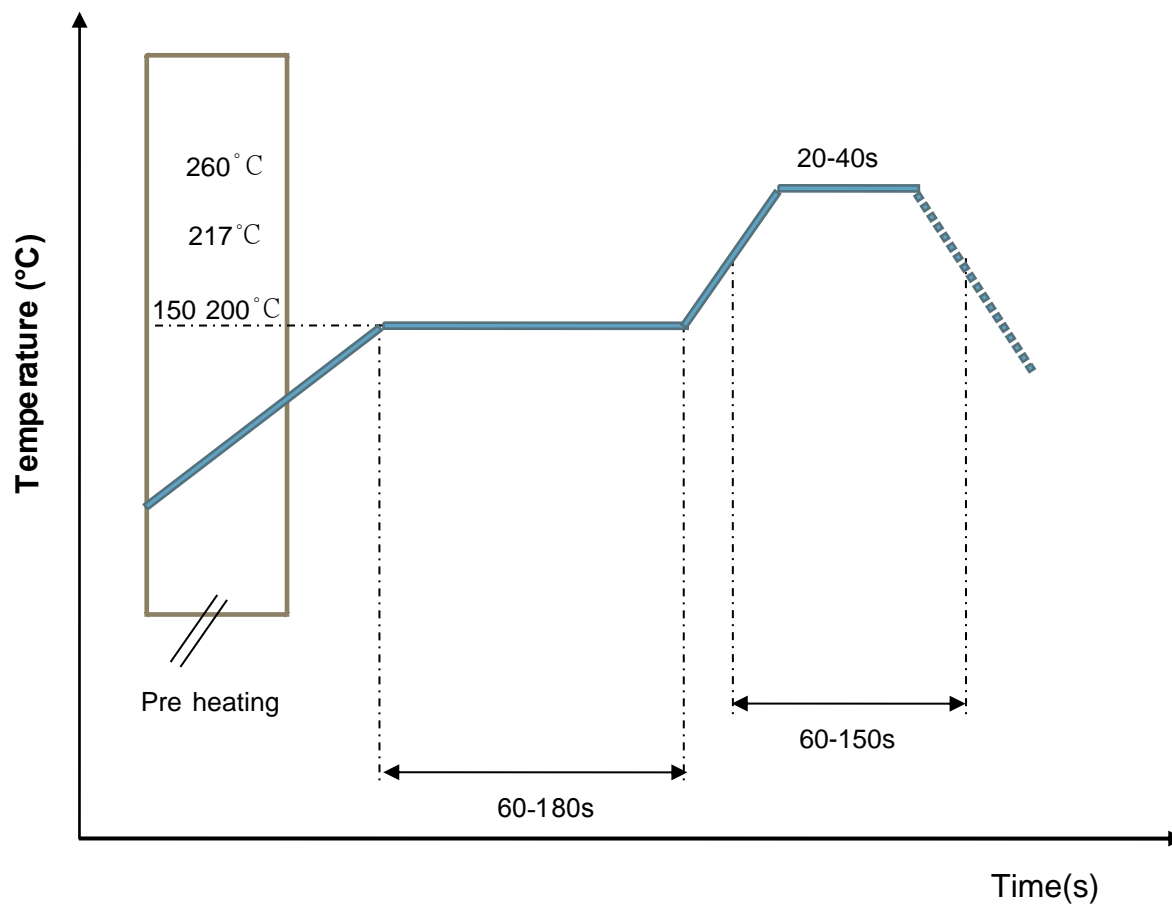

## ■ PACKAGING STYLE

### □ REEL DIMENSIONS

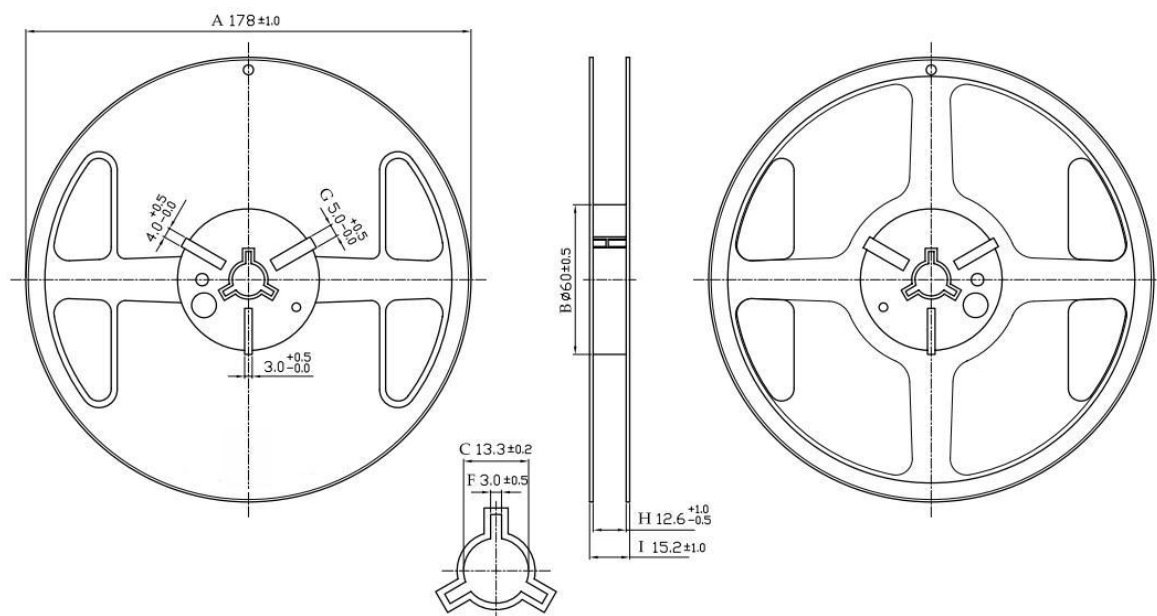

### □ TAPE DIMENSIONS

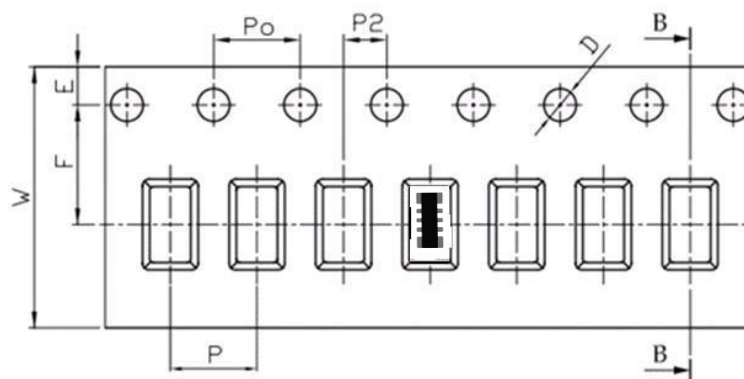

Feature	Specifications	Tolerances
W	12.00	±0.30
P	4.00	±0.10
E	1.75	±0.10
F	5.50	±0.10
P2	2.00	±0.10
D	1.50	+0.10 -0.00
P0	4.00	±0.10
10P0	40.00	±0.20

Typing Quantity: 5000 pieces per 7" reel