

边锋智驱
EDGE SMART DRIVE

K4 水下推进器

高效 | 智能 | 轻量化

快速指南

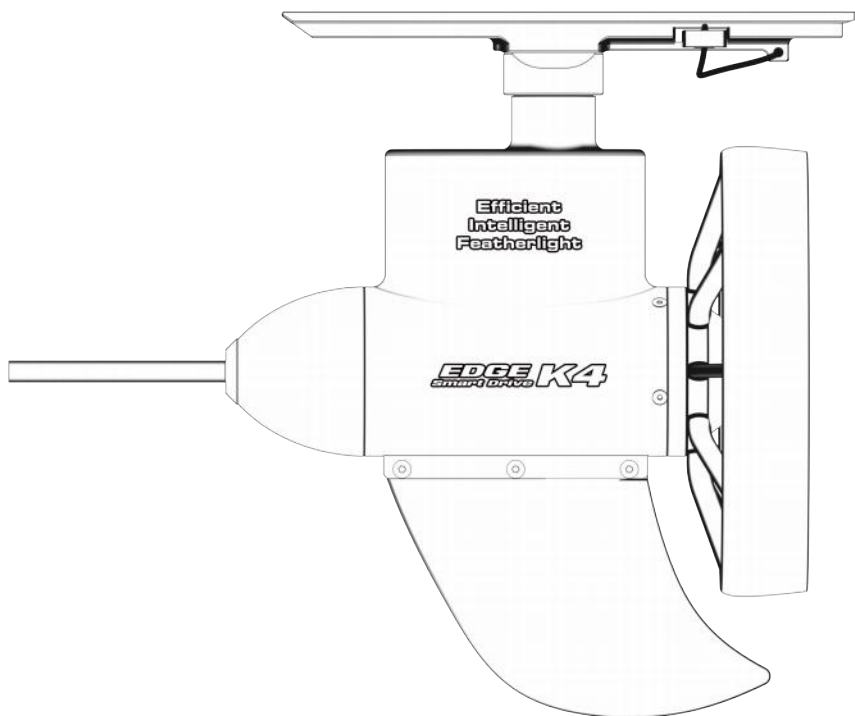

使用建议及获取支持

① 使用建议

首次使用本产品前用户需要仔细阅读《K4用户手册》了解相关产品信息及须知。

② 售后支持

您可选择以下途径获取产品问题解答、用户手册、教学视频等相关服务与支持。

网站地址: <http://www.edgesmartdrive.com>

邮箱: info@edgesmartdrive.com

安全注意事项

警告



在使用本产品前务必仔细阅读用户手册,熟知所有操作方法和注意事项。



用户在水下使用产品过程中请确保一定距离内有同伴看护



本产品不能作为救生设备使用。



在使用本产品前,应充分检查产品确认电池无破损、电量充足,确认螺旋桨及推进器运转及各项功能正常。



为保证安全,使用者在任何情况下都应穿着救生衣或配备救生设备。



在水中使用时,请随时注意观察电量,确保在[电量耗尽]前返回



使用过程中时刻注意周围水域情况确保周围没有船只和游泳者出现以免发生碰撞危险。



运输或航空携带本产品前务必将电池从机器中取出,并依据相关规定单独保管电池。



开机情况下不可将手指伸入螺旋桨中,也应注意不可将衣物或其他物体附着在螺旋桨附近。



在使用本产品时应特别注意皮划艇周围身边任何留长发的人,避免将他人的头发或衣物绞入螺旋桨。



在使用产品前应充分了解要进入的水域,用户应确保在合适的水域内进行皮划艇活动,且水域管理方同意在该区域内使用本产品。

提示

1. 请将电池的电量充满。
2. 当机器出现故障时, 请不要使用。
3. 尽量在空旷的地方使用本产品, 并注意不要让水中的衣物、藻类、绳索、防鲨网、贝壳、砂子或其他杂物绞入螺旋桨, 以免发生危险。
4. 不要在沙滩上直接试用本产品, 避免砂子、贝壳或其他杂物被吸入螺旋桨中。
5. 为保护电机寿命, 请勿在非水下环境中持续启动超过 30 秒。若有异常状态(如烧焦味等)应立即松开油门开关使机器停止运转, 并立即断开电源。
6. 在使用本产品前及使用本产品时, 不要饮酒或服用药物。
7. 产品表面不可与汽油、橡胶水等挥发性物质或酸性物质接触, 不可与尖锐物品接触。
8. 产品上方不可以放置重物。
9. 不可将电池投入火中。
10. 产品在不使用时, 请避免其被阳光直晒。高温会损坏电池并有可能造成爆炸或漏液。
11. 本产品不适用于水中混有沙子或具有类似物理特性的水域。
12. 在黑暗水域或者夜间使用时, 应有充足的照明。
13. 不要在水中更换电池, 一定要在干燥的环境下更换电池, 并保证设备及双手干燥。
14. 当不使用本产品时, 请务必将其从水中取出。
15. 在多人多机同时使用产品时, 需保证互相之间的距离大于 1.5m, 确保安全。
16. 非厂家售后服务人员切勿擅自进行修理, 修理不正确会导致产品漏水、损坏、火灾或触电。

产品概述：

K4是一款革命性的智能水上推进装置，专为桨板、皮划艇和充气船设计，赋予其强劲的动力和精准转向系统彻底解放您的双手。无论是水上运动爱好者想要延长游玩时间，钓鱼达人需要解放双手专注垂钓，还是家庭用户希望全家轻松亲水，甚至是行动不便人士寻求水上出行新方式，K4都能完美适配。这款多功能智能推进器安装简便，即装即用，让各类人群都能轻松享受水上运动的乐趣，重新定义您的水上探险方式。

产品亮点

1. 智能控制

K4可实现任意速度下，一键定速巡航，解放双手。前进倒退无缝切换，配合遥控转向，实现精准灵活的操控，赋予随心所欲的航行乐趣。

2. 多功能遥控

K4智能蓝牙遥控器是连接用户与电动尾舵的智能终端，集精准操控与状态监控于一体。遥控器配备数字显示屏，支持前进/后退/转向三档调速和巡航控制，并实时显示转速、GPS速度、档位、电量、里程及电压电流等关键数据，让用户在各种环境下都能实现精准操控，随时掌握设备运行状态。

3. 高效稳定

K4电动推进器专为水领域设计的高效率无刷电机，搭配流体力学设计的螺旋桨，以更小的功率推动船体高效巡航为目标，实现环保节能的愿景。

4. 小体积大推力

我们极致的设计理念，满足防水和使用功能，用最小的体积和重量，实现桨板和皮划艇的推进，便于携带和安装。

3、物品清单

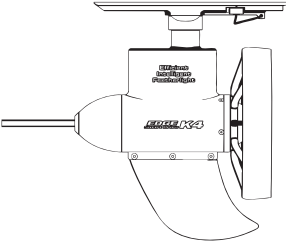

K4主机

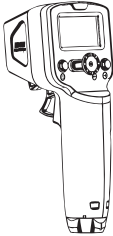

K4遥控器



鳍盒底座



电源转接线+蓝牙模块

4、部件名称

- | | | |
|--------|------|-------|
| ① 整流罩 | ② 电机 | ③ 螺旋桨 |
| ④ 鱼鳍 | ⑤ 头罩 | ⑥ 供电线 |
| ⑦ 转向舵机 | ⑧ 鳍盒 | |

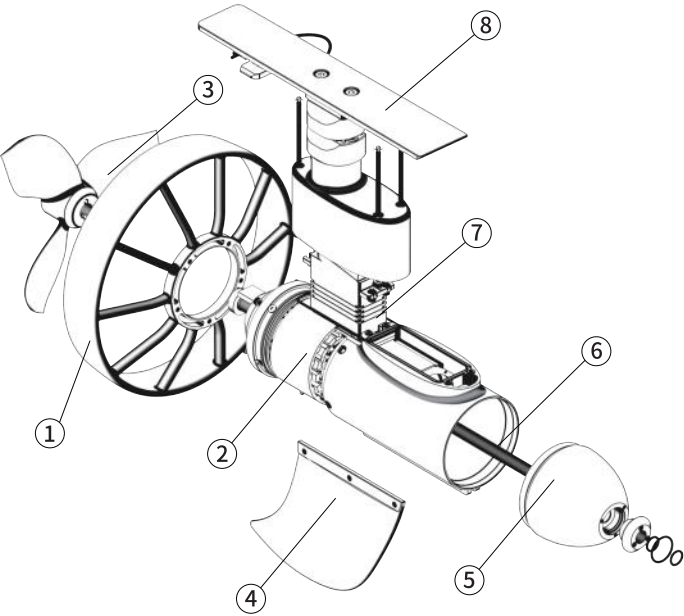

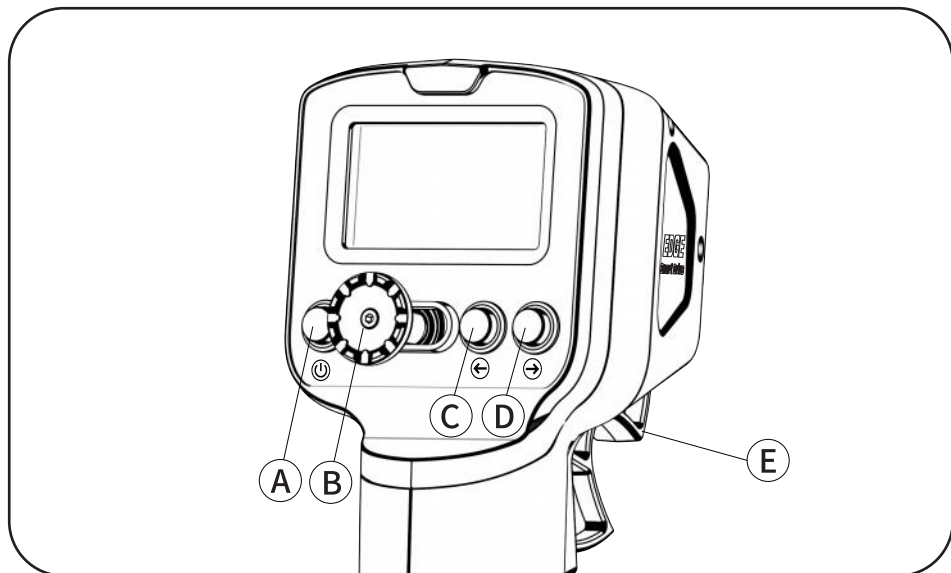

使用说明：

A键 :开/关机、模式切换键、定速巡航键(短按开关,长按3至5秒关机;连按2次模式切换D档/S档;在前进巡航状态下短按一下进行定速航行,再短按一下退出定速功能/或扣动油门扳机也可退出定速航行)

B键 方向舵摇杆(左/右)

C键 微调左舵方向、油门标定键(短按微调左舵方向;长按3至5秒标定油门归零)

D键 微调右舵方向、蓝牙配对键(短按微调右舵方向;长按3至5秒轻手蓝牙进行对频)

E键 油门扳机(扣为前进/推为倒车,在定速巡航状态下,扣或推退出定速巡航)

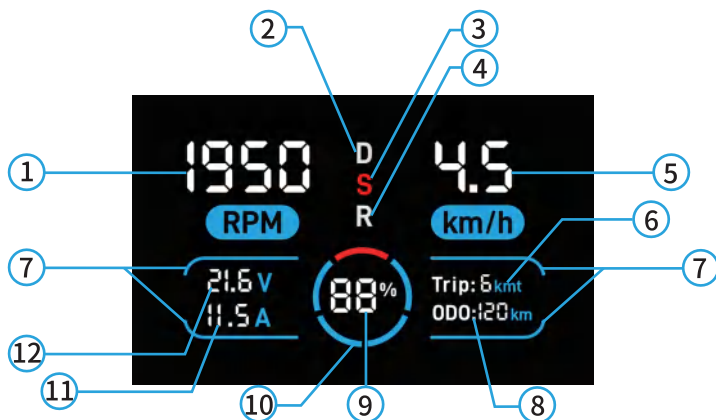

显示说明：

- | | |
|---------------|------------------------------|
| ① :电机转速 | ⑦ :蓝牙配对指示 (蓝牙连上为常亮, 掉线为流水显示) |
| ② :D普通模式前进档 | ⑧ :本机使用累计公里数 |
| ③ :S运动模式前进档 | ⑨ :6s电源输入端剩余电量 |
| ④ :R倒档 | ⑩ :遥控器电量 |
| ⑤ :移动速度 | ⑪ :实时电流 |
| ⑥ :当次开机移动累计里程 | ⑫ :电池实时电压 |

首次使用前准备：

● 检查物品齐全

开箱后务必查看物品是否齐全。

● 检查设备外观

设备开箱后请仔细检查有无机壳体破裂、保护罩脱落、螺旋桨叶断裂、电池密封圈胶垫损伤等影响产品使用情况。

● 检查设备功能

(1)检查蓝牙是否可以正常链接, 遥控短按A打开遥控, 链接K4成功后, 启动检查螺旋桨运转是否正常;

(2)检查控制手柄是否正常,开机后按一次开关键,检查开关键是否卡涩,是否可以正常切换动力模式;拨动油门检查控制动力系统是否正常:无极变速功能,在任意速度下按一次开关键后定速巡航,按任意键取消。

⚠ *如在开箱检查过程中,发现损坏问题,请勿使用产品并及时联系K4官方售后服务中心或其它授权的售后服务机构以便快速解决问题。为保护电机寿命请勿在非入水状态下运行产品超过30秒。

使用流程:

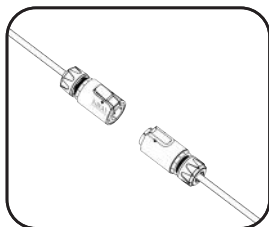

连接防水插头接电源

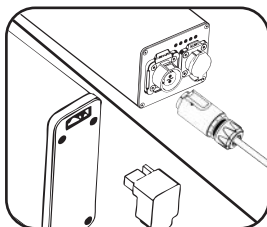

通过xt30孔/双芯防水插头
连接电源 (外接的电源需要是6s电源)

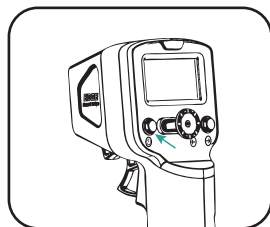

短按遥控器A键打开遥控器

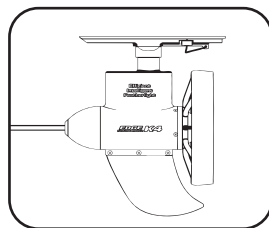

即可正常使用

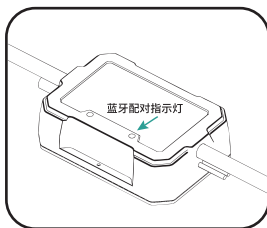

蓝牙模块配对指示灯常亮



蓝牙流水灯停止闪烁

操作说明:

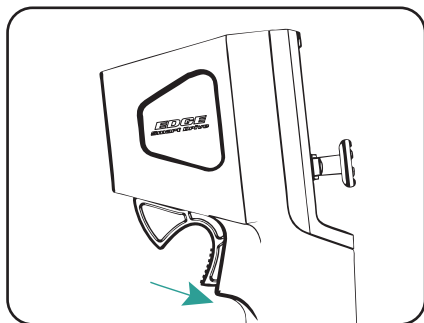

▲ 前进

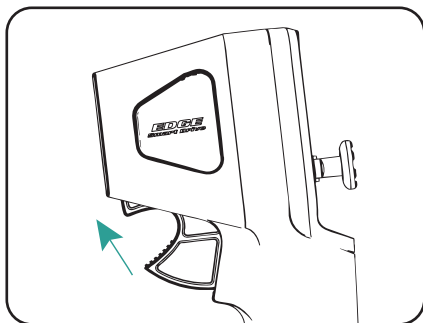

▼ 后退

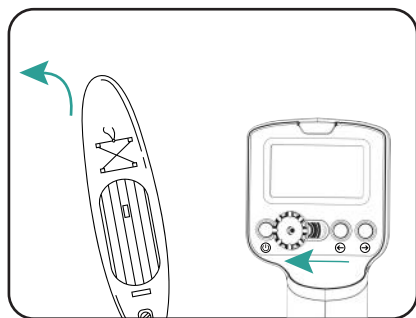

◀ 左转

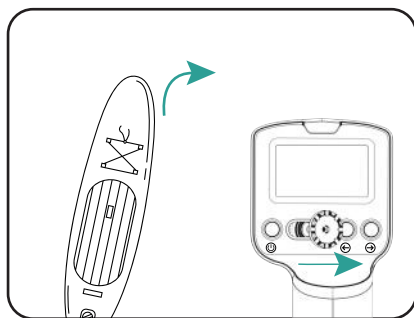

▶ 右转

蓝牙对频

蓝牙重新对频，中间显示01/02，松开手进行对频，等待蓝牙配对指示灯常亮与工作运行指示灯闪烁时，蓝牙配对成功

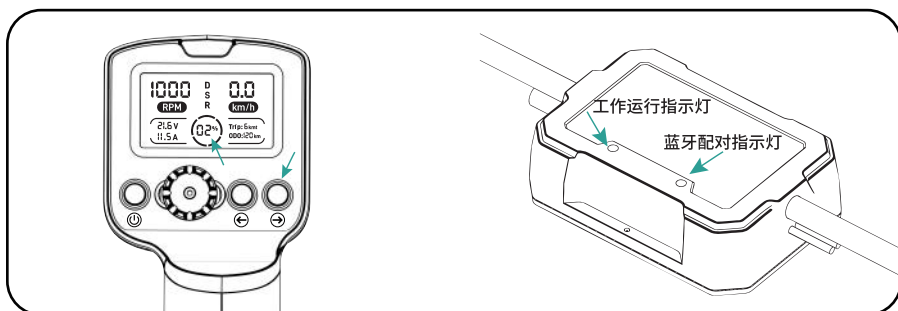

遥控器充电指引

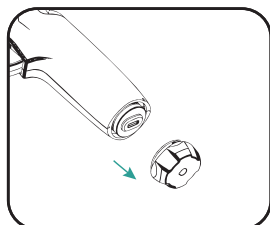

拧开充电口防水盖

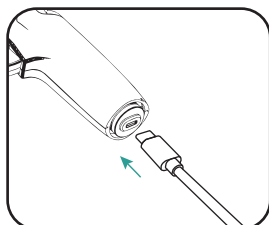

用USB-TYPEC线充电
(约2h充满)

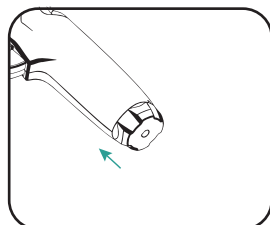

充电完成后，拧回防水盖

充电注意事项

1. 电量显示为1格，或者遥控器出线闪屏/关机/无法开机时，请及时给遥控器充电；



www.edgesmartdrive.com

本手册中包含的信息、照片和说明是Edge Smart Drive的财产, 未经授权不得复制和分发。此外, Edge Smart Drive保留更改本手册中任何信息的权利。

本手册可能随时更改, 恕不另行通知。您可以在Edge Smart Drive官方网站的“服务支持”部分查看用户手册的最新版本

如对用户手册有任何疑问或建议, 请透过以下电邮与我们联系

info@edgesmartdrive.com



扫码了解更多



EDGE
Smart Drive

K4 SUP & Kayak Motor

Efficient | Intelligent | Featherlight

Quick Guide

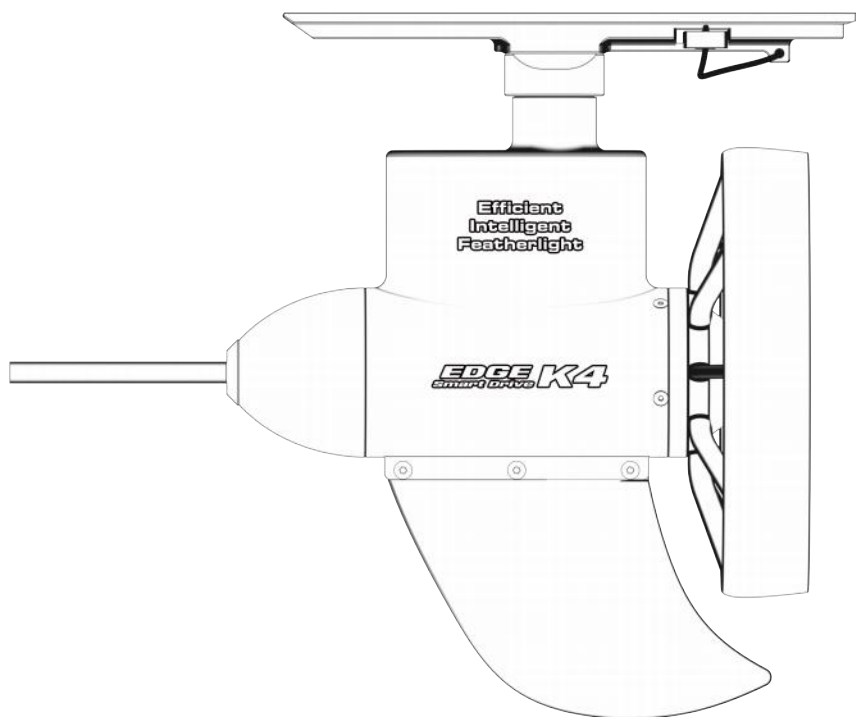

User suggestions & Support

① Before First Use

Read the 《K4 User Manual》 for safety and setup instructions.

② Customer Support

Get manuals, troubleshooting, and videos at:

Official Website: <http://www.edgesmartdrive.com>

Email: info@edgesmartdrive.com

Safety Precautions



WARNING



Before using this product, carefully read the user manual to fully understand all operating procedures and safety precautions.



This product must not be used as a life-saving device.



For safety, users must wear a life jacket or carry life-saving equipment at all times during operation.



Constantly monitor surrounding waters during operation to ensure no boats or swimmers are present, preventing collision risks.



Never insert fingers into rotating propeller, and keep clothing/objects clear of propeller area during operation.



Before operation, verify the waterway is suitable for kayaking and obtain necessary authorization from local authorities for powered vessel use.



Always ensure companion supervision within immediate reach when operating the product underwater.



Before operation, thoroughly inspect the product to confirm: undamaged battery, sufficient charge, normal propeller/thruster operation, and full functionality.



When using this product in water, constantly monitor battery level and ensure returning before [complete depletion].



Before transport or air travel, always remove the battery from the device and store it separately in compliance with applicable regulations.



During operation, maintain special vigilance for long-haired persons near the kayak to prevent hair/clothing entanglement in the propeller.

Tips

- 1、Fully charge the battery before use.
- 2、Do not use the product if it malfunctions.
- 3、Always operate in open water areas and be careful to avoid entanglement of clothing, algae, ropes, nets, shells, sand or other debris in the propeller to prevent hazards.
- 4、Do not operate the product directly on sandy beaches to prevent sand, shells or other debris from being sucked into the propeller.
- 5、To protect motor life, do not continuously operate for more than 30 seconds out of water. If any abnormal conditions occur (such as burning smell), immediately release the throttle to stop operation and disconnect power.
- 6、Do not consume alcohol or drugs before or during use of this product.
- 7、Do not expose the product surface to volatile substances like gasoline or rubber solutions, acidic substances, or sharp objects.
- 8、Do not place heavy objects on top of the product.
- 9、Do not throw batteries into fire.
- 10、When not in use, avoid direct sunlight exposure. High temperatures may damage the battery and potentially cause explosion or leakage.
- 11、This product is not suitable for use in waters containing sand or similar physical properties.
- 12、When operating in dark waters or at night, ensure adequate lighting is available.
- 13、Do not change batteries in water. Always change batteries in dry conditions with dry hands and dry equipment.
- 14、Always remove the product from water when not in use.
- 15、When multiple users operate multiple units simultaneously, maintain a minimum distance of 1.5m between units for safety.
- 16、Do not attempt unauthorized repairs by non-manufacturer service personnel. Improper repairs may lead to water leakage, damage, fire or electric shock.

Product Overview:

The K4 is a revolutionary intelligent water propulsion system designed specifically for paddle boards, kayaks, and inflatable boats. It delivers powerful thrust and precise steering to completely free your hands. Whether you're a water sports enthusiast looking to extend your playtime, an angler needing hands-free fishing, a family wanting easier water access, or individuals with mobility challenges seeking new ways to enjoy the water, the K4 adapts perfectly. This versatile smart propulsion system installs instantly and works immediately, allowing everyone to effortlessly enjoy water activities and redefine their aquatic adventures.

Key Features:

1. Smart Control

The K4 features one-touch speed lock for hands-free cruising at any speed. With seamless forward/reverse switching and remote steering, it delivers precise, agile maneuverability for effortless navigation enjoyment.

2. Multi-Function Remote Control

The K4's smart Bluetooth remote serves as your intelligent control terminal, combining precise operation with real-time status monitoring. Featuring a digital display, it offers three-speed adjustment (forward/reverse/steering) and cruise control, while displaying critical data including RPM, GPS speed, gear position, battery level, distance, voltage, and current. Stay in complete control of your device's operation in any environment.

3. High Efficiency & Stability

The K4's brushless motor is specifically engineered for aquatic environments, paired with a hydrodynamically optimized propeller. This combination delivers efficient cruising with minimal power consumption, realizing our vision of eco-friendly performance.

4. Compact Size, Powerful Thrust

Our ultra-compact design delivers maximum propulsion for paddle boards and kayaks while maintaining full waterproof functionality. The minimal size and weight ensure easy portability and installation without compromising performance.

3. Package Contents

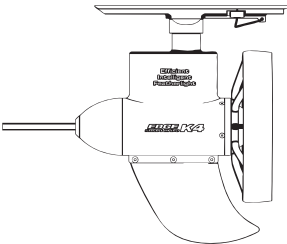

K4 Main Unit

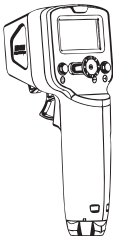

K4 Remote Controller



Fin Box Base



Power Adapter Cable
+ Bluetooth Module

4. Component Terminology

- ① Fairing

④ Stabilizer Fin

⑦ Steering Servo
- ② Motor

⑤ Head Cover

⑧ Fin Box
- ③ Propeller

⑥ Power Cable

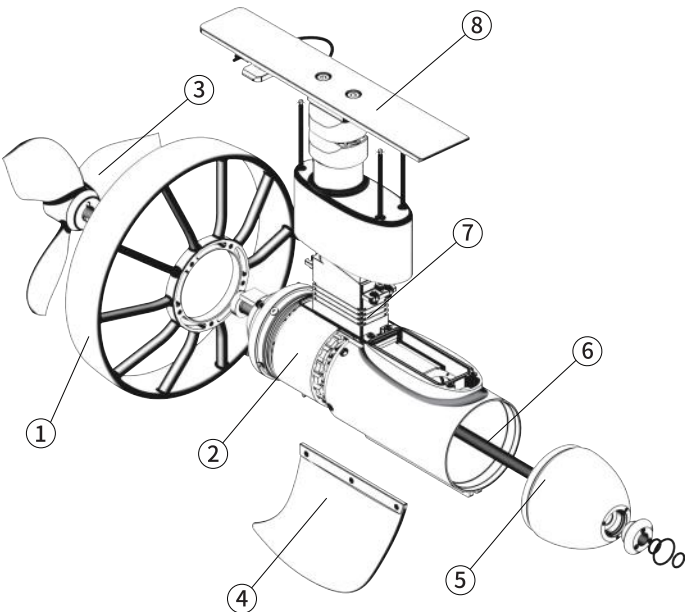

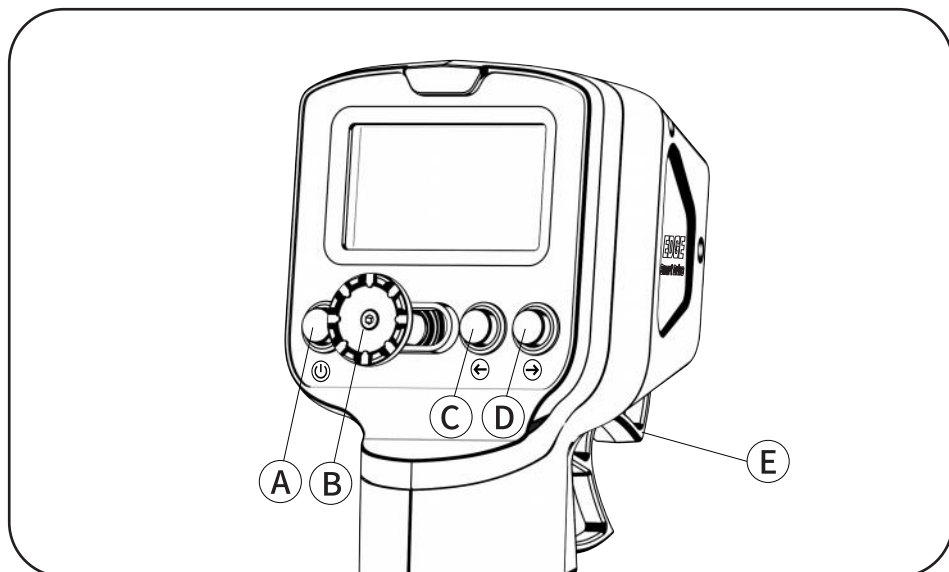

User Manual:

- Button A** – Power On/Off, Mode Switch, Cruise Control
 Short press: Turn on
 Long press (3-5 sec): Turn off
 Double press: Switch between D mode (Normal) and S mode (Sport)
 In cruise control: Short press to activate/deactivate (or pull/push throttle to cancel).
- Button B** – Rudder Joystick (Left/Right Steering)
- Button C** – Left Rudder Trim / Throttle Calibration
 Short press: Adjust left rudder trim
 Long press (3-5 sec): Reset throttle to zero.
- Button D** – Right Rudder Trim / Bluetooth Pairing
 Short press: Adjust right rudder trim
 Long press (3-5 sec): Enter Bluetooth pairing mode.
- Button E** – Throttle Trigger
 Pull: Move forward
 Push: Reverse
 In cruise control: Pull/push to cancel.

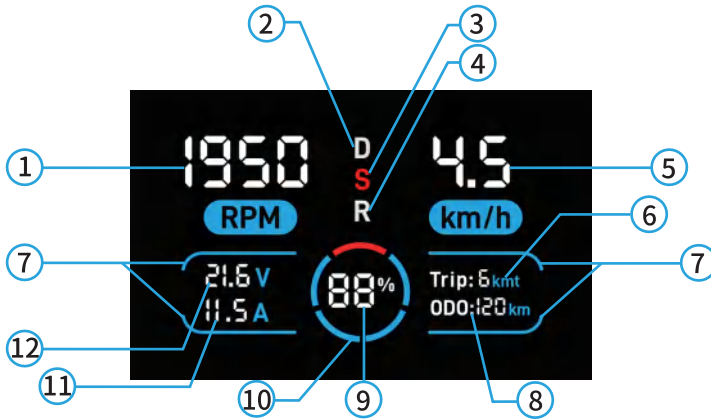

Display Information:

- | | |
|------------------------------------|---|
| ① :Motor RPM | ⑦ :Bluetooth Indicator
(Solid: Connected/Flashing: Disconnected) |
| ② :D - Standard Forward Mode | ⑧ :Odometer (Total Distance) |
| ③ :S - Sport Forward Mode | ⑨ :6S Battery Level |
| ④ :R - Reverse Mode | ⑩ :Remote Battery Level |
| ⑤ :Current Speed | ⑪ :Real-time Current |
| ⑥ :Trip Distance (Current Session) | ⑫ :Battery Voltage |

Pre-Use Preparation:

● Check Components

Verify all included items are present after unboxing.

● Inspect Device

Carefully check for: housing cracks, detached protective cover, broken propeller blades, or damaged battery seals that may affect functionality.

● Test Functions

(1)Bluetooth test: Briefly press A to power on remote, connect to K4, then verify propeller operation.

(2) Controller test: Press power button once (check for sticking) Verify power mode switching Test throttle: ① Stepless speed control ② Single press activates cruise ③ Any button cancels cruise.

⚠ If damage is found, DO NOT USE and contact K4 service. Do not operate out of water for >30 seconds.

Operating Procedure:

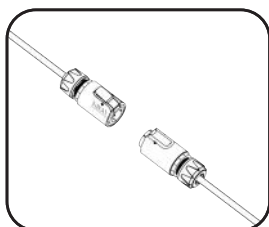

Connect the waterproof plug to the power source securely.

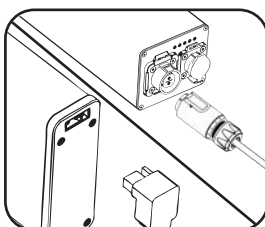

Connect to the power source via the XT30 port/2-pin waterproof plug. (External power source must be 6S).

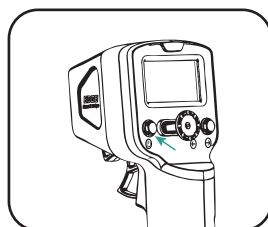

Press the A button briefly to power on the remote

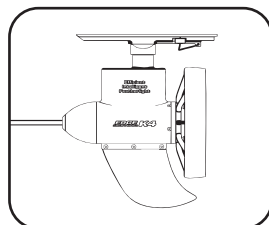

Ready for Use

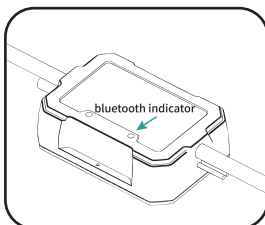

The pairing indicator of bluetooth module stays solid.

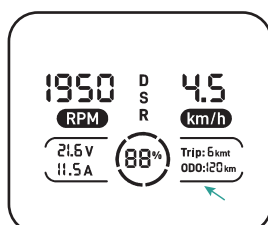

The flowing LED lights will stop blinking.

Operation Instructions:

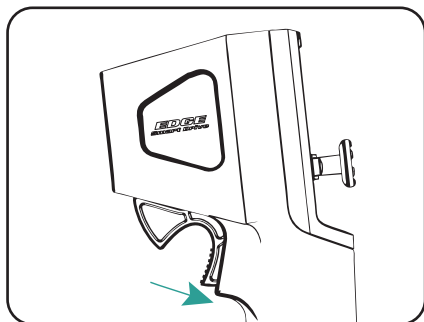

▲ Forward

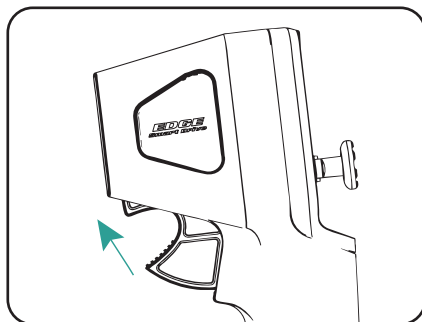

▼ Backward

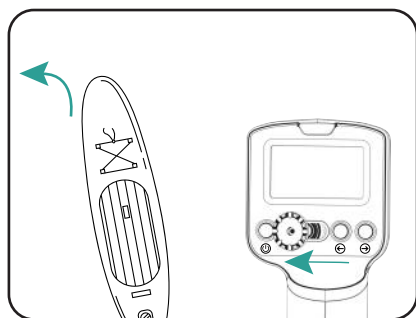

◀ Turn Left

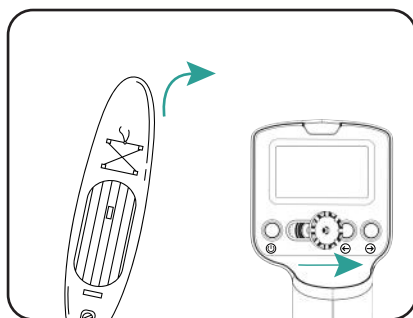

▶ Turn Right

Bluetooth Pairing

To re-pair Bluetooth (display shows "01/02"), release buttons to start pairing. Successful pairing is confirmed when Bluetooth indicator stays solid and operation light flashes.

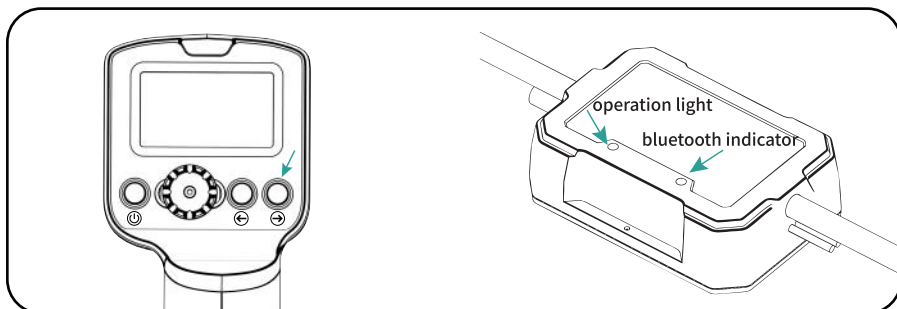

Remote Control Charging Instructions

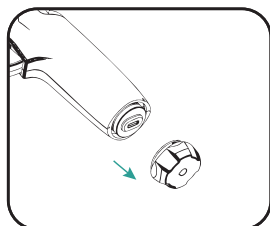

Twist open the waterproof charging port cover

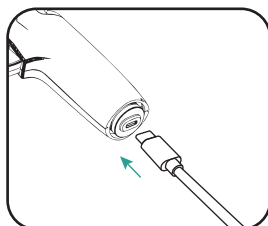

Charge via USB-TypeC cable (fully charges in 2 hours)

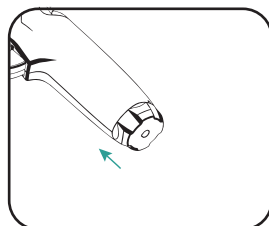

After charging, securely screw the waterproof cover back on.

Charging Precautions

1. Charge the remote immediately when the battery indicator shows 1 bar, or if the remote displays flickering/shutdown/failure to power on.

FCC Warning

This device complies with Part 15 of the FCC Rules. Operation is subject to the following two conditions:

(1) This device may not cause harmful interference, and (2) this device must accept any interference received, including interference that may cause undesired operation.

NOTE 1: This equipment has been tested and found to comply with the limits for a Class B digital device, pursuant to part 15 of the FCC Rules. These limits are designed to provide reasonable protection against harmful interference in a residential installation. This equipment generates, uses and can radiate radio frequency energy and, if not installed and used in accordance with the instructions, may cause harmful interference to radio communications. However, there is no guarantee that interference will not occur in a particular installation. If this equipment does cause harmful interference to radio or television reception, which can be determined by turning the equipment off and on, the user is encouraged to try to correct the interference by one or more of the following measures:

- Reorient or relocate the receiving antenna.
- Increase the separation between the equipment and receiver.
- Connect the equipment into an outlet on a circuit different from that to which the receiver is connected.
- Consult the dealer or an experienced radio/TV technician for help.

NOTE 2: Any changes or modifications to this unit not expressly approved by the party responsible for compliance could void the user's authority to operate the equipment.

The device has been evaluated to meet general RF exposure requirement. The device can be used in portable exposure condition without restriction.

Copyright Notice

All information, images, and instructions contained in this manual are the property of Edge Smart Drive. Unauthorized reproduction or distribution is prohibited.

Edge Smart Drive reserves the right to modify any content in this manual without prior notice. For the latest version of this manual, please visit the "Service & Support" section on the official Edge Smart Drive website.

For any inquiries or suggestions regarding this user manual, please contact us via email at: info@edgesmartdrive.com



Find us at FB