

Instructions for smart socket products

Product Name: smart socket

product 1st one manual one certificate and one socket

product specifications and parameters:
working voltage: 120v.

Working current:

10A (maximum resistance: 1200W)

preparation for use

1. Power on the socket, ensure that the mobile phone is connected to the WiFi network in the 2.4GHz band;
2. Ensure that the equipment, mobile, phone and router are close to each other
3. Download and open the app:
Search the app store for "graffiti smart" or scan the QR code on the outer package/manual to download and install the app;

If you download it for the first time, please click the "create new account" button to register;

If you have an account, click the login with existing account" button.



network access settings

(lash mode)

1. When the socket is powered on, the indicator light will flash automatically after 2 or 3 seconds. If there is no flash, long press the key for 10 seconds to let go, and hash after 2 to 3 seconds.
2. Then open the home page of graffiti smart app, and click Add device or add button' in the upper right corner;
3. Automatic scanning to find the device, click add, and wait for the distribution network to succeed. As shown in the figure below

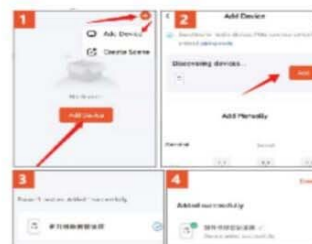

The method of binding sound,

Xiaoai classmate: the product first needs to be equipped with a good network in graffiti intelligence. Secondly, open the Mijia app, click "my" other platform devices in the lower right corner, find graffiti intelligence, authorize binding graffiti smart account and synchronize devices.

Small speaker: the product first needs to be equipped with a networking graffiti smart open the small sound app, click mine, click the "smart appliance" in the middle, enter the "graffiti" in the search box, authorize

the binding of graffiti smart account and synchronize the device.

Tmall Genie: the product first needs to set up a network in graffiti smart, open Tmall Genie app, click "add device" in the upper right corner of the home page, enter "graffiti" in the search box, authorize binding graffiti smart account and synchronize devices

FCC Warning Statement

Changes or modifications not expressly approved by the party responsible for compliance could void the user's authority to operate the equipment. This equipment has been tested and found to comply with the limits for a Class B digital device, pursuant to Part 15 of the FCC Rules. These limits are designed to provide reasonable protection against harmful interference in a residential installation. This equipment generates uses and can radiate radio frequency energy and, if not installed and used in accordance with the instructions, may cause harmful interference to radio communications. However, there is no guarantee that interference will not occur in a particular installation. If this equipment does cause harmful interference to radio or television reception, which can be

determined by turning the equipment off and on, the user is encouraged to try to correct the interference by one or more of the following measures:

- Reorient or relocate the receiving antenna.
- Increase the separation between the equipment and receiver.
- Connect the equipment into an outlet on a circuit different from that to which the receiver is connected.
- Consult the dealer or an experienced radio/TV technician for help.

This device complies with part 15 of the FCC Rules. Operation is subject to the following two conditions: (1) This device may not cause harmful interference, and

(2) this device must accept any interference received, including interference that may cause undesired operation.

RF Exposure Statement

To maintain compliance with FCC's RF Exposure guidelines, This equipment should be installed and operated with minimum distance of 20cm between your body. This device and its antenna(s) must not be co-located or operation in conjunction with any other antenna or transmitter.