



8 Inch Rugged Tablet

User's Manual

TRADEMARKS

Google, Android, Google Play and other marks are trademarks of Google LLC. The Bluetooth® word mark and logos are registered trademarks owned by Bluetooth SIG, Inc. All other brand and product names are trademarks or registered trademarks of their respective owners.

Images shown in this document may vary slightly from actual products at time of shipping.
Information in this manual is subject to change without notice

Contents

About This Manual	1
Conventions	1
Basic Safety Guidelines	2
Intended Use	2
Unintended Application Use	2
Maintenance and Operation Overview	2
Safety	3
Electrical Hazards	3
Environmental Hazards	3
Environmental	3
Cleaning and Servicing	3
Chapter 1. Introduction	5
About this Guide	5
Unpacking the Device	5
Accessories List	5
Chapter 2. Specification	6
Chapter 3. Identifying the Device	7
Front & Side View	7
Back View	7
I/O Ports	8
SIM Card & TF Card Slot	8
Dimensions	9
Chapter 4. Getting Started	10
First Time Use	10
Charging the Battery	10
Powering the Device On and Off	11
Installing the Nano SIM Card & TF Card	12
Installing Handstrap	13
Chapter 5. Apps and Settings	15
Home Screen	15
Touch Panel Control	15
Check System Information	16
Check the storage status	18
Check the system languages	19
Check the system date and time	21
Setting the Network, Internet and Connected Devices	22
Hotspot & tethering	27
Connected devices	28
QR code scanning	30
Basic Operations and Settings	30
Chapter 6. Troubleshooting	43
Troubleshoot the Wi-Fi Connection	43
Troubleshoot Operating the Tablet	44
Chapter 7. Maintenance	45
Cleaning the Device	45
Returning the Device	45

About This Manual

The ET-868 User's Manual provides instructions for qualified personnel to follow when setting up a new ET-868 device.

This document is intended for use by qualified personnel to compliment the training and expertise, not to replace it.

Conventions

Bolded or underlined text is used to emphasize the designated information.



A Note is used to provide additional information for the device or settings.



A Caution is used to warn against potential hazards or to caution against unsafe practices.



A Warning is used to identify immediate hazards for property damage, injury or death.

Basic Safety Guidelines

The following safety guidelines are intended to help protect the user from injury and prevent damage to the hardware.

- Do not place anything on the AC adapter's power cable and make sure the cable is not located where it can be tripped over or stepped on.
- Do not cover the AC adaptor as it reduces the cooling.
- Do not use the AC adapter while it is inside the carrying case.
- Use only the AC adapter, power cord, and batteries that are approved for use with the device. Use of another type of battery or AC adapter may cause risk of fire or explosion.
- If you use an extension cable with the AC adapter, ensure that the total ampere rating of all products plugged in to the extension cable does not exceed the ampere rating of the extension cable.
- If the device is moved between environments with very different temperature and/ or humidity ranges, condensation may form on or within the device. Avoid damaging the device by allowing sufficient time for the moisture to evaporate before using the device.
- When disconnecting cables, pull on the connector or on its strain relief loop, not on the cable itself. When pulling out or plugging in the connector, keep it evenly aligned to prevent bending the connector pins.

Intended Use

The ET-868 rugged tablet is equipped with multi-functional terminals for stationary and mobile applications in industrial environments such as logistics, warehousing, fleet management, manufacturing and the automotive industry.

Read the safety guidelines thoroughly before starting any servicing on the device. Read the guidelines before powering up the device, and keep this document for later use.

The operator is solely responsible for any damage resulting from unauthorized modifications to the device.

Unintended Application Use

The device is not designed for use in life-support systems or critical safety/security systems where system malfunction can lead to the direct or indirect endangerment of human life. The operator is fully responsible for using the device in these situations.

Maintenance and Operation Overview

The ET-868 is designed and manufactured according to strict controls and following the stated safety regulations. The following list identifies incorrect operating uses of the ET-868. Incorrect use of the ET-868 can lead to hardware damage, safety issues and possible risk to personnel health:

- The ET-868 is under operation by untrained personnel;
- The ET-868 is not maintained as recommended;
- The ET-868 is not used as intended

Safety

To prevent injury and damage, read the following safety guidelines prior to operating the device. The manufacturer assumes no liability for any and all damages arising from misuse or noncompliance with these guidelines.

Electrical Hazards

Cleaning/Servicing: Power Off the ET-868

- Disconnect the ET-868 from power before cleaning or servicing it.

Power Adapter

Our power adapter support 9V/2.22A(20W) fast charging.

Environmental Hazards

Do not use the ET-868 in locations near/with flammable gases or vapor.

The use of electrical equipment in explosive environments can be dangerous.

- Turn off the device when near a gas station, fuel depot, chemical plant or a place where blasting operations take place.

Environmental

Ambient Temperature

The ET-868 operates on the basis of a fanless concept which internal waste heat is released via the housing surface and requires fresh airflow in the environment.

- Operating the ET-868 with no fresh cooling air may cause overheating and damage to the device.
- The operating environment should not be enclosed to prevent the cool air being heated by the heat waste from the device.

Connecting and Disconnecting External Devices

To prevent the considerable damage, the ET-868 and the external device should be disconnected from power when connecting/disconnecting excluding USB devices.

Only Use Authorized Accessories

Only use the supplied cables, power packs and other accessories that have been tested and approved by us. Contact your local distributor for further information.

Cleaning and Servicing

- Disconnect the ET-868 from power before cleaning or servicing.
- Never clean the ET-868 with compressed air, a pressure washer or a vacuum cleaner.
- If necessary, clean the housing of the ET-868 with a damp cloth.
- Clean the touch-screen with a nonabrasive cloth.
-

Lithium Battery Safety Statement



Lithium battery inside. Danger of explosion if battery is incorrectly replaced. Replace only with same or equivalent type recommended by battery manufacturer.

Lithium-Ion batteries are classified by the U. S. Federal Government as non-hazardous waste and are safe for disposal in the normal municipal waste stream. These batteries contain recyclable materials and are accepted for recycling. Dispose of used batteries in accordance with local regulations.



WARNING – Non -approved batteries will not function in the device. Use only the battery for the system for which it was specified. Only use the battery with a charging system that has been qualified with the system per this standard. Use of an unqualified battery or charger may present a risk of fire, explosion, leakage, or other hazard.



WARNING – There are no user-serviceable parts in the batteries. Do not disassemble or open, crush, bend or deform, puncture, or shred the battery. Do not modify or remanufacture, attempt to insert foreign objects into the battery, immerse or expose to water or other liquids, or expose to fire, explosion, or other hazard. Do not expose to temperatures above +60 °C (+140 °F).



WARNING – Improper battery use may result in a fire, explosion, or other hazard.

- Do not short circuit a battery or allow metallic or conductive objects to contact the battery terminals.
- Avoid dropping the device or battery. If dropped, especially on a hard surface, and the user suspects damage to the battery, take it to a service center for inspection.
- In the event of a battery leak, do not allow the liquid to come in contact with the skin or eyes. If contact has been made, wash the affected area with large amounts of water and seek medical advice.
- Battery usage by children should be supervised.

Power supply safety



WARNING – Use only AC and vehicle adapters intended for the device. Output rating 9 Vdc, 2.22A. Other external power sources may damage your product and void the warranty.

- Ensure the input voltage on the adapter matches the voltage in your location. Ensure the Class I adapter has prongs compatible with your outlets and earthing connection.
- The AC power supply is designed for indoor use only. Avoid using the AC power supply in wet areas.
- Unplug the power supply from power when not in use.
- Do not short the output connector.

Chapter 1. Introduction

The ET-868 is a rugged device equipped with 802.11, Bluetooth and GNSS for wireless data communications.

The ET-868 is a rugged 8" tablet capable of 1920 x 12 resolution.

The ET-868 supports the following operating systems:

- Android 14 with Google Mobile Services(GMS) certified

About this Guide

The ET-868 User Manual provides instructions for qualified personnel to use as a guide for setup of the device. This document is not intended to replace the training and expertise of the end-user.

Unpacking the Device

Before you begin the installation or configuration process make sure to inspect all components and accessories. Contact your representative if there are any missing or damaged items.

Accessories List

The ET-868 is shipped with the 9V/2.22A PD adapter, Type-C Cable and Hand Strap.
Other accessories are sold and ordered separately.

Chapter 2. Specification

Technical Data	
Hardware	
Processor	MediaTek MT8788 Octa-Core, 2 x Cortex-A73@2.0GHz + 6 x Cortex-A53@2.0GHz
RAM	6 GB
ROM	128 GB
Front camera	5 MP
Back camera	13 MP Autofocus
Sensors	Accelerometer, Gyroscope, compass, ambient light sensor, Hall sensor
Indicators/operating means	
Display	Can be operated while wearing gloves
Touchscreen technology	Capacitive multitouch
Type	TFT, LCD
Screen diagonal	8 Inch (20.32 cm)
Resolution	1920 x 1200 (WUXGA)
Aspect ratio	16:10
Brightness	400 cd/m ² (nit)
Colors	16M
Electrical specifications	
Battery type	Li-Ion battery 30.40WH 3.8 V/8000 mAh
Operating duration	up to 10 H
Communication	
Mobile standard	2G/3G/4G/4G-LTE
WLAN	802.11 a/b/g/n/ac (2.4 GHz + 5 GHz)
Bluetooth	Version 5.0
GPS sensor	GPS, GLONASS, Beidou, Galileo
USB	USB 2.0 Type-A x 1, USB 2.0 Type-C x 1
SIM card	Optional 1: 2x Nano SIM Optional 2: 1x Nano SIM + 1x TF Card
Audio	1x 3.5mm Audio Jack
DC-In	1x 5.5mm DC Input(12V/2A)
HDMI	1x HDMI-A
NFC	
Brand	STMicroelectronics
Model	ST21NFCD
Operating Modes	Card Emulation, Reader/Writer and Peer to Peer communication
Biometric Fingerprint Scanner	
Sensor type	Optical
Acquisition window	17.6 x 23.0mm
Image size	300*400 / 256*360pixels
Image resolution	500DPI
FBI Approval	FAP20
Barcode Scanner	
	Optional
Image Sensor	640*480 CMOS(0.3MP)
Symbologies	2D and 1D
Reading depth	45~330mm
Viewing Angle°	H:42° / Vertical 31.5
Software	
Operating system	Android™ 14
Languages	English (default)
Ambient conditions	
Ambient temperature	-20 ... 55 °C (-4 ... 131 °F)
Mechanical specifications	
Degree of protection	IP67, MIL-STD-810H
Tablet Weight	760g
Dimensions	
W x H x D	258.50 mm x 153.92 mm x 22.49 mm

Chapter 3. Identifying the Device

Front & Side View



Back View

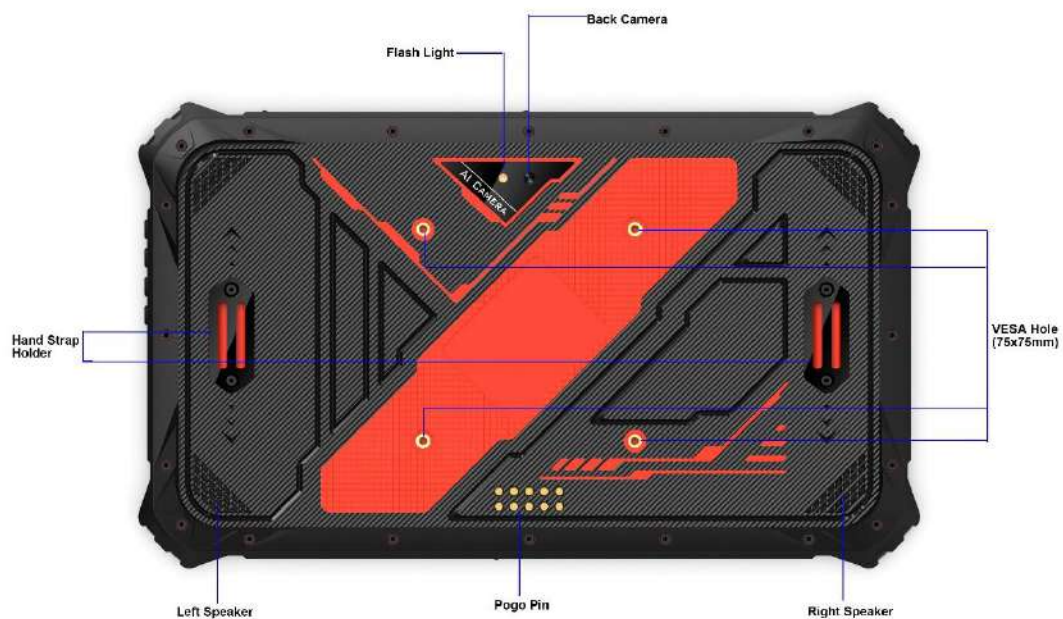

I/O Ports



SIM Card & TF Card Slot



Dimensions

The following image lists the device dimensions without add-ons (mm/inches).

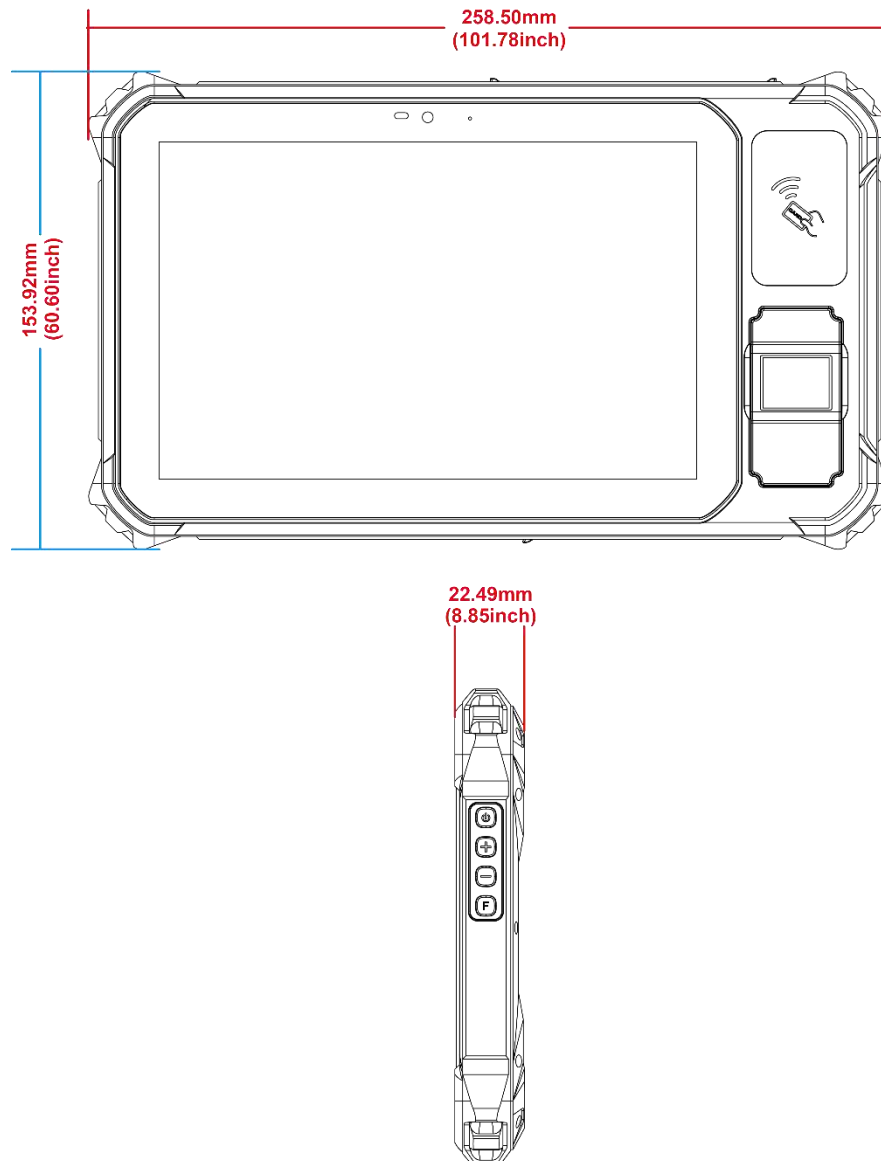

Chapter 4. Getting Started

This section provides an outline of the steps necessary to setup a new ET-868. A detailed guide follows the listed items, see as follows.

For additional technical assistance, contact your representative.



It is recommended to install or remove accessories on a clean, well-lit work surface. To protect yourself and the device from electrostatic discharge, wear anti-static wrist straps or place the device on an anti-static mat.

First Time Use

To activate the battery, please connect the power adapter to power on and charge to be 100%.

Charging the Battery

While the battery is charging, the power LED will be red. When the battery is fully charged, the power LED is lit as solid green.

1. Flip open the USB Type-C cover to expose the USB Type-C jack.



2. Connect the power adapter with Type-C cable to the USB Type-C port.

After charging the battery, disconnect the AC adapter and close the USB Type-C cover.

1. Insert one end of the cover first and angle the cover to seat it in place.
2. Push in the cover to seal the USB Type-C compartment

Powering the Device On and Off

Powering On/Off the Device

Only power on the ET-868 after connecting all of the peripherals and cabling.

1. Press and hold the power button until the screen lights. The device runs through the start-up sequence and powers up.



Powering Off the Device

2. Press and hold the power button until the screen shows power off/restart message, then choose power off.

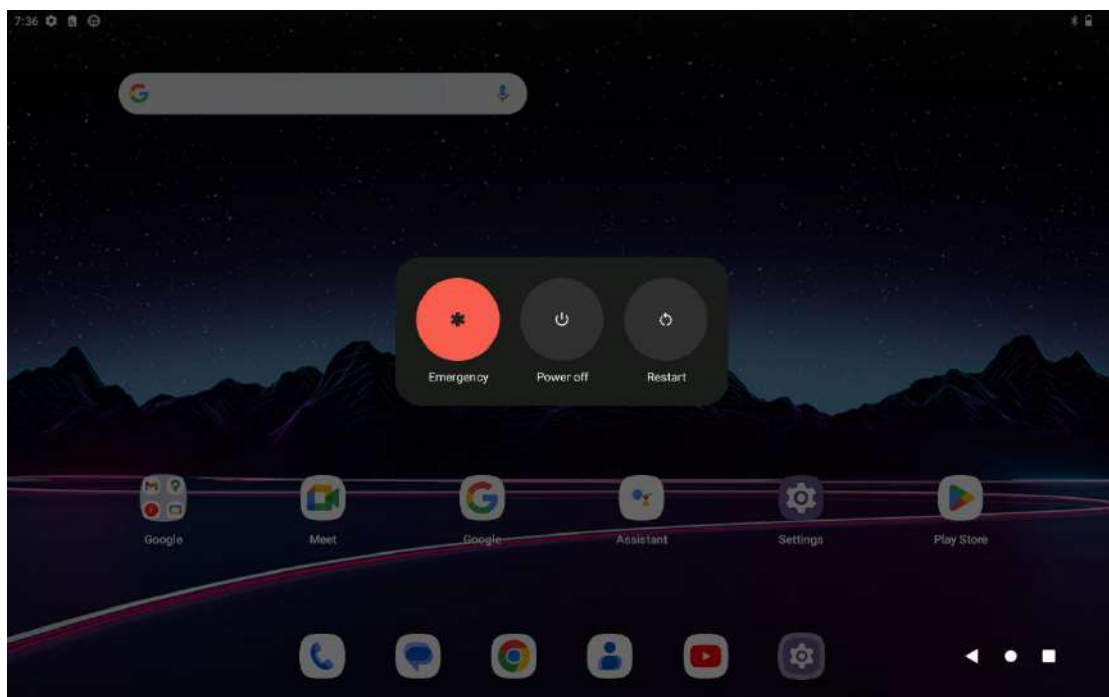

Installing the Nano SIM Card & TF Card



Support hot-swappable design

Check with your network or cellular service provider for availability and cost rate

The device includes a SIM card slot which support 2 options:

- 1) Two Nano SIM in SIM card slot



- 2) One Nano SIM+One TF Card in SIM card slot



After installed SIM card slot, please close the I/O compartment cover.

Installing Handstrap

1) Remove 4 screws



2) Connect the handstrap with metal holder



3) Secure the metal holder and handstrap with screw.



Chapter 5. Apps and Settings

Home Screen



The screen may appear differently depending on the region or service provider.

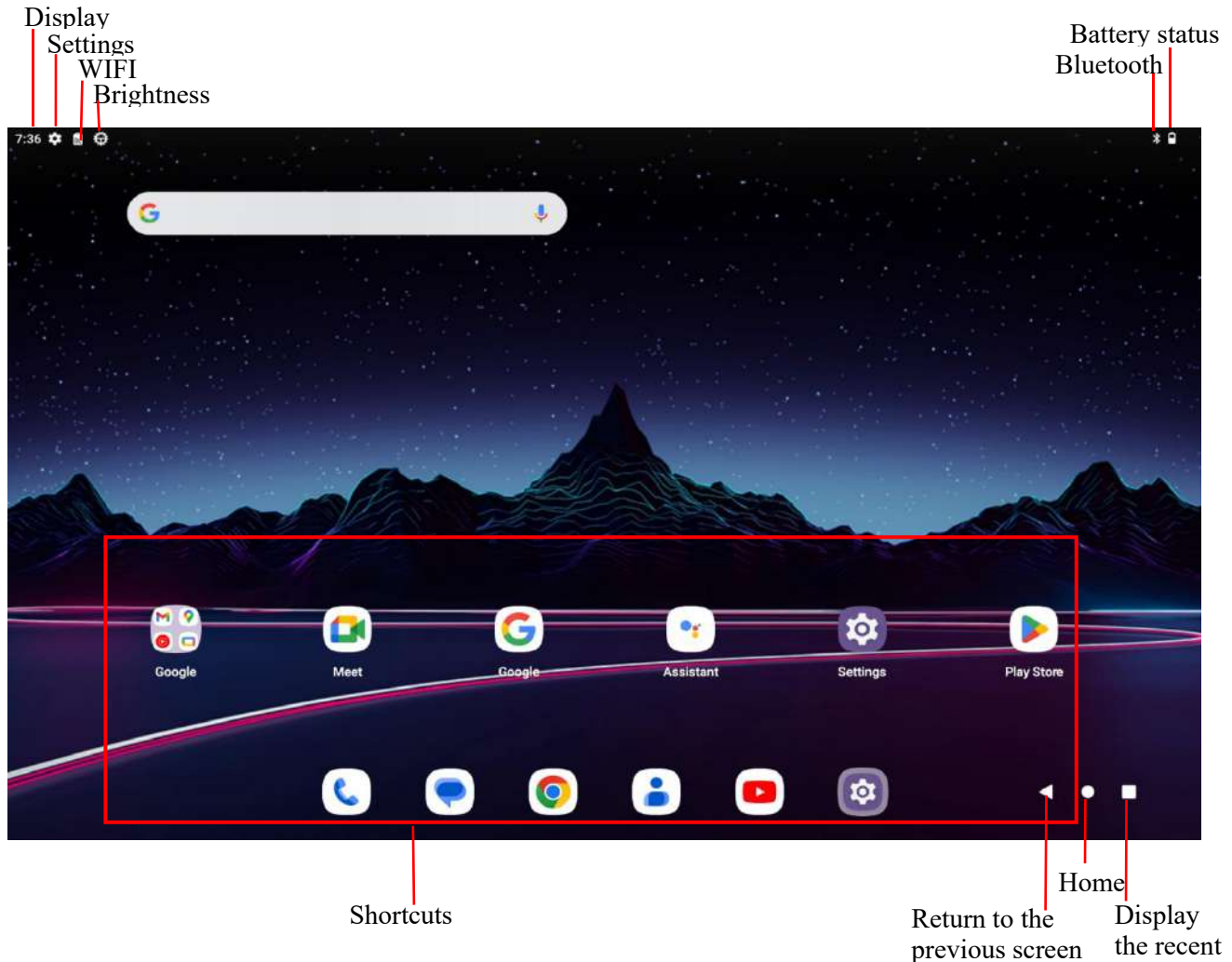

Touch Panel Control



Do not allow the touchscreen to come into contact with other electrical devices. Electrostatic discharges can cause the touchscreen malfunction.

To avoid damaging the touchscreen, do not tap it with anything sharp or apply excessive pressure to it with your fingertip.

It is recommended not to use fixed graphics on part or all of the touchscreen for extended periods. Doing so may result in afterimages (screen burn-in) or ghosting.



The device may not recognize touch inputs close to the edges of the screen, which are outside of the touch input area.

It is recommended to use fingers when you use the touchscreen

Single tap

Single tap on the touch panel screen lets you activate an application.

Longer press tap

Long-pressing an application allows you to drag and drop the application or the application shortcut to another desktop.

Long-pressing a desired file in the File Manager allows you to copy, cut, rename or delete the selected file

Swiping

Swipe upward, downward, to the left, or to the right.

Spreading and pinching

Spread two fingers apart or pinch on the screen.

Input, insert, select or copy texts

The keyboard appears when you use word processor to edit documents or enter the web address on the web browser address bar.

Check System Information

View system specifications

On the Home screen, swipe upward to open the Apps screen.

To return to the Home screen, swipe downward on the Apps screen. Alternatively, tap the Home button or the Back button

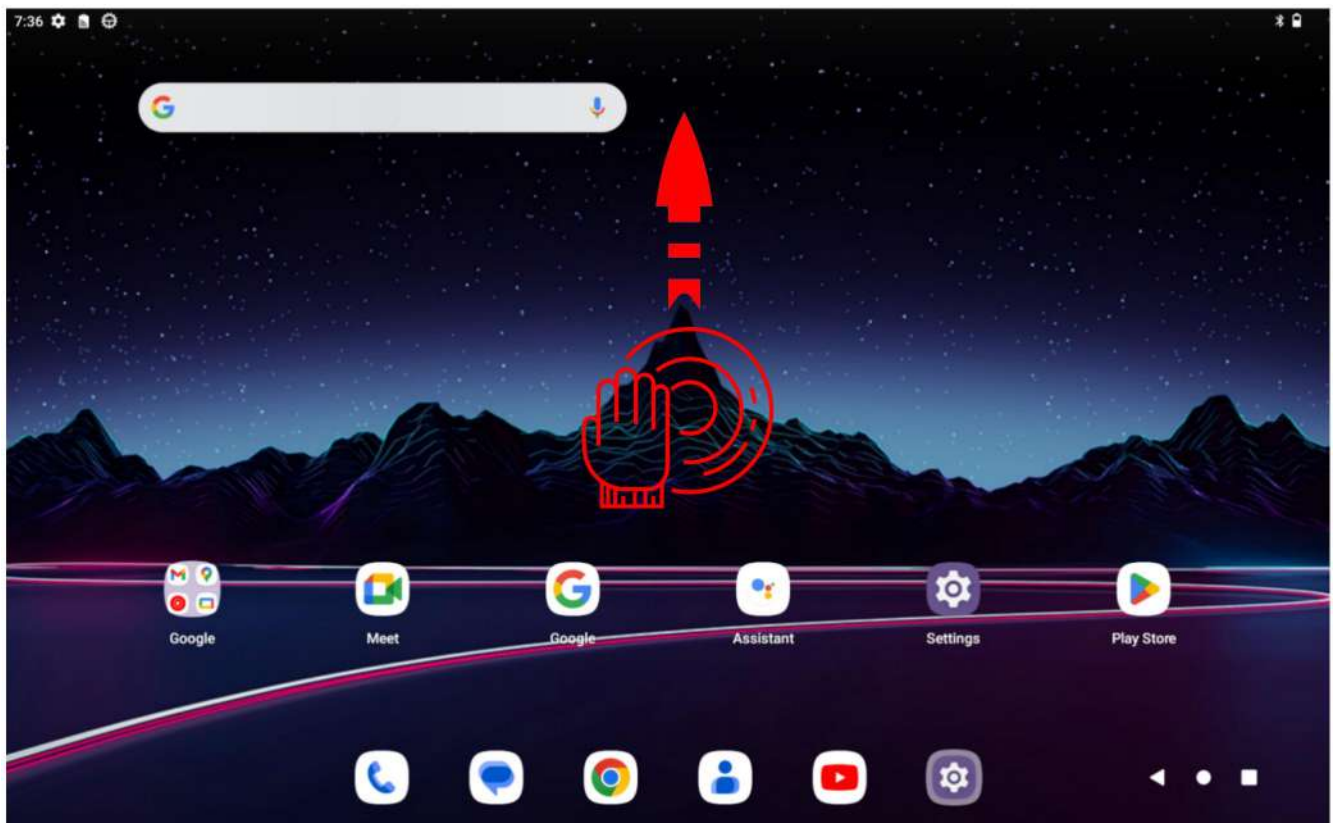

Tap “Settings” to view and configure all of the system settings

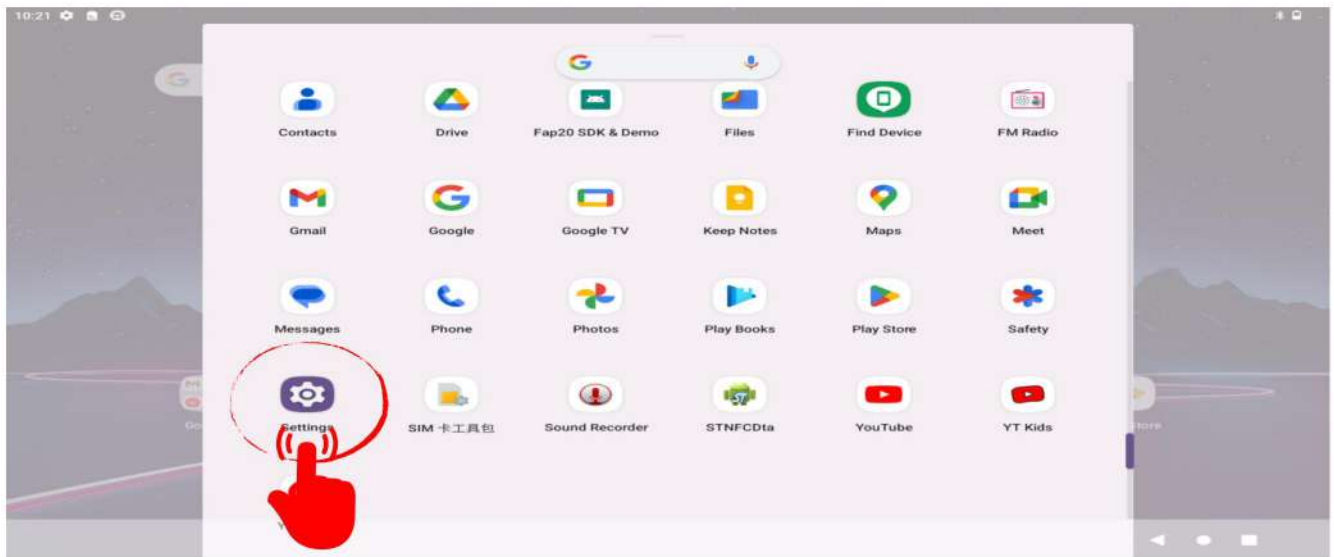

Select “About tablet” to view the tablet information

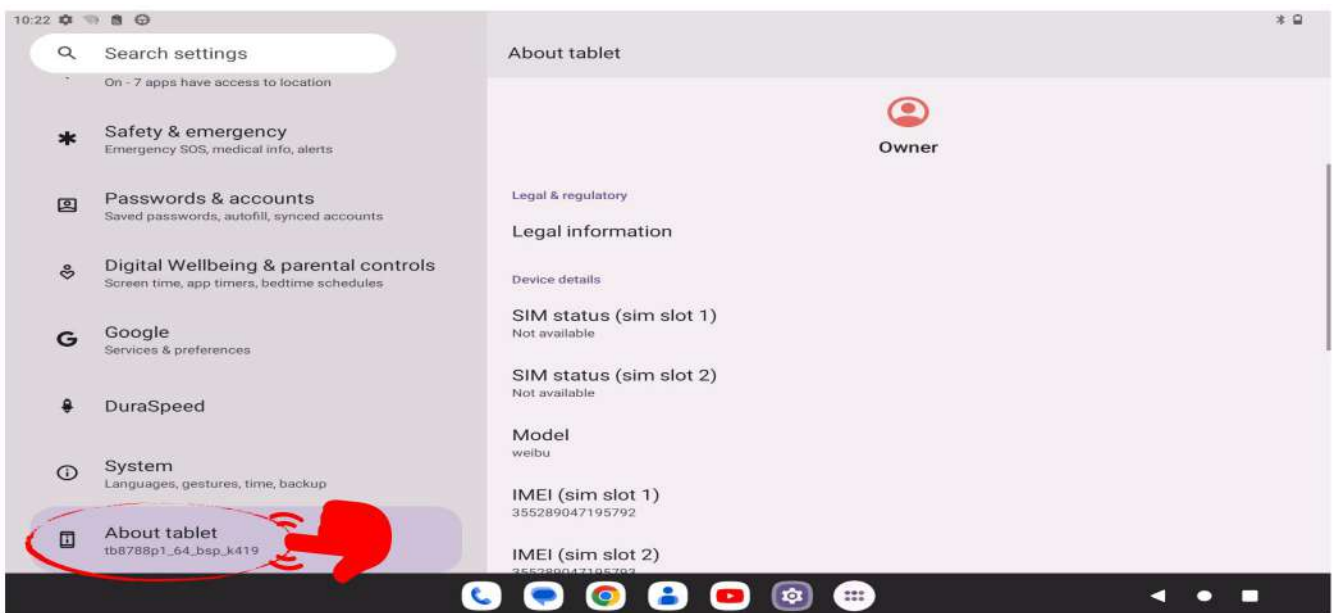

Display the system specifications

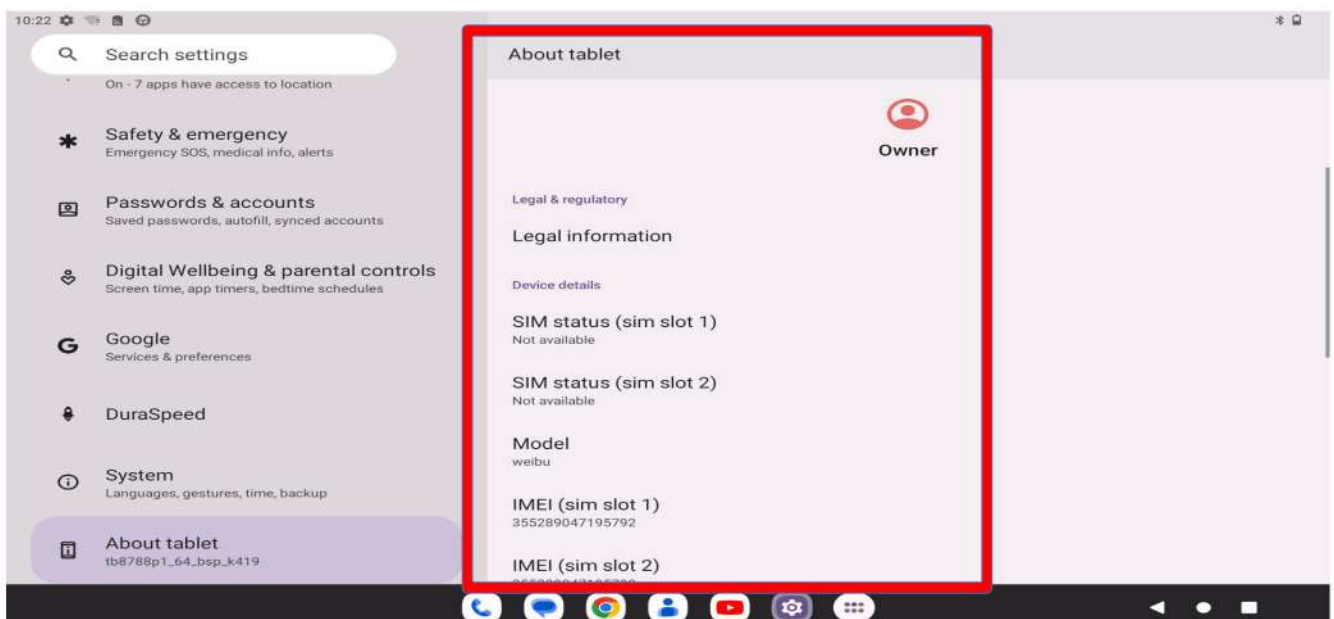

Check the storage status

Select "Storage" to view the storage information

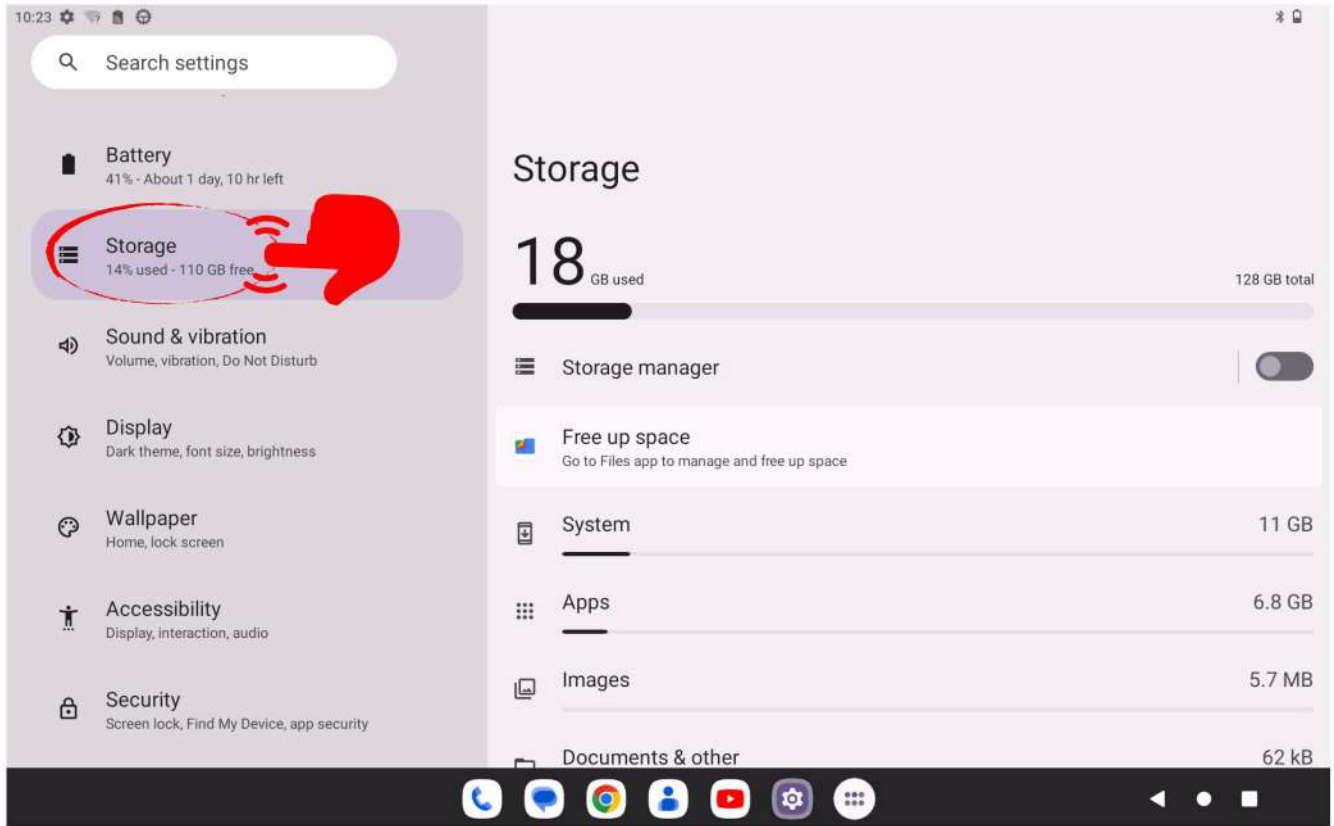

Display the internal storage (eMMC & SD card) location

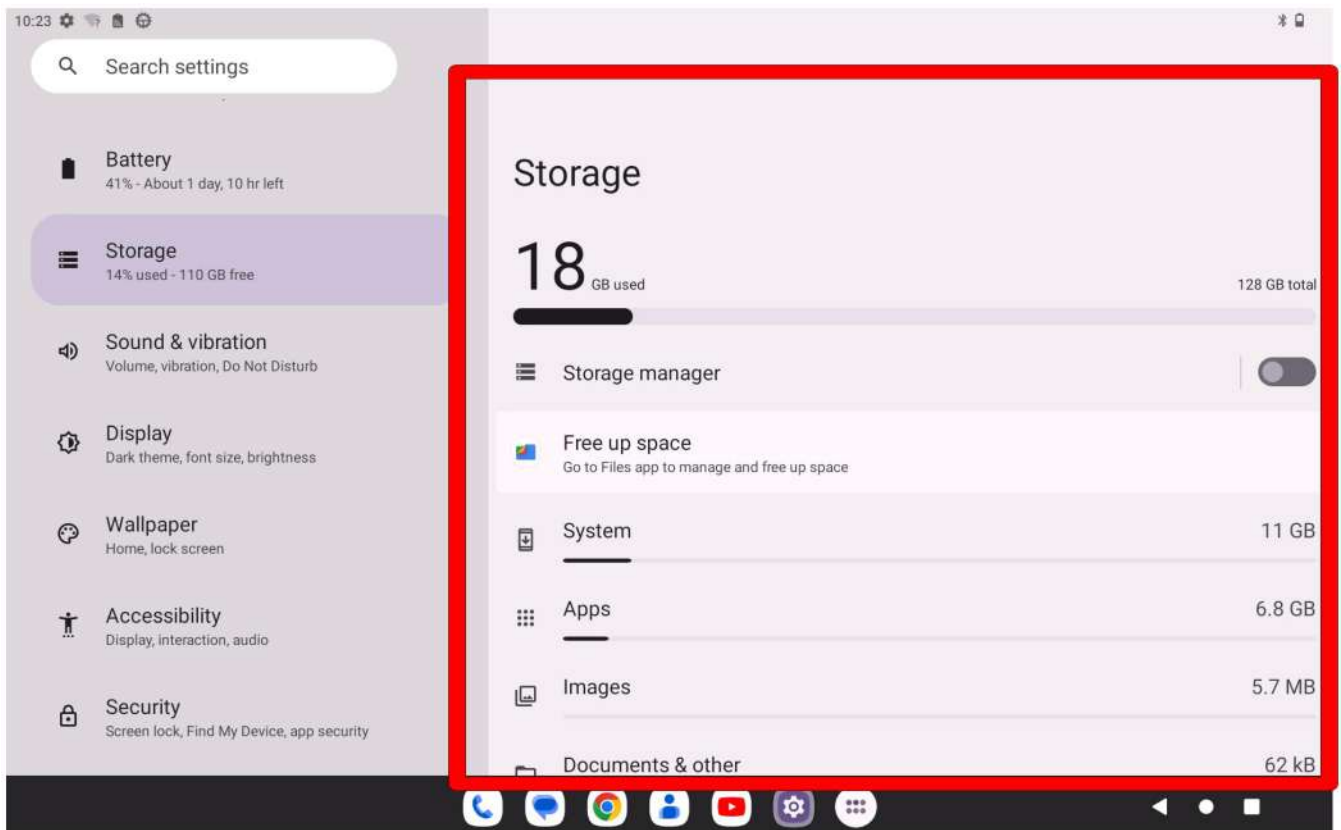

Check the system languages

Select “System” to view and configure system settings



After enter “System”, you can tap Advanced to do more settings

Select “Languages & Input”

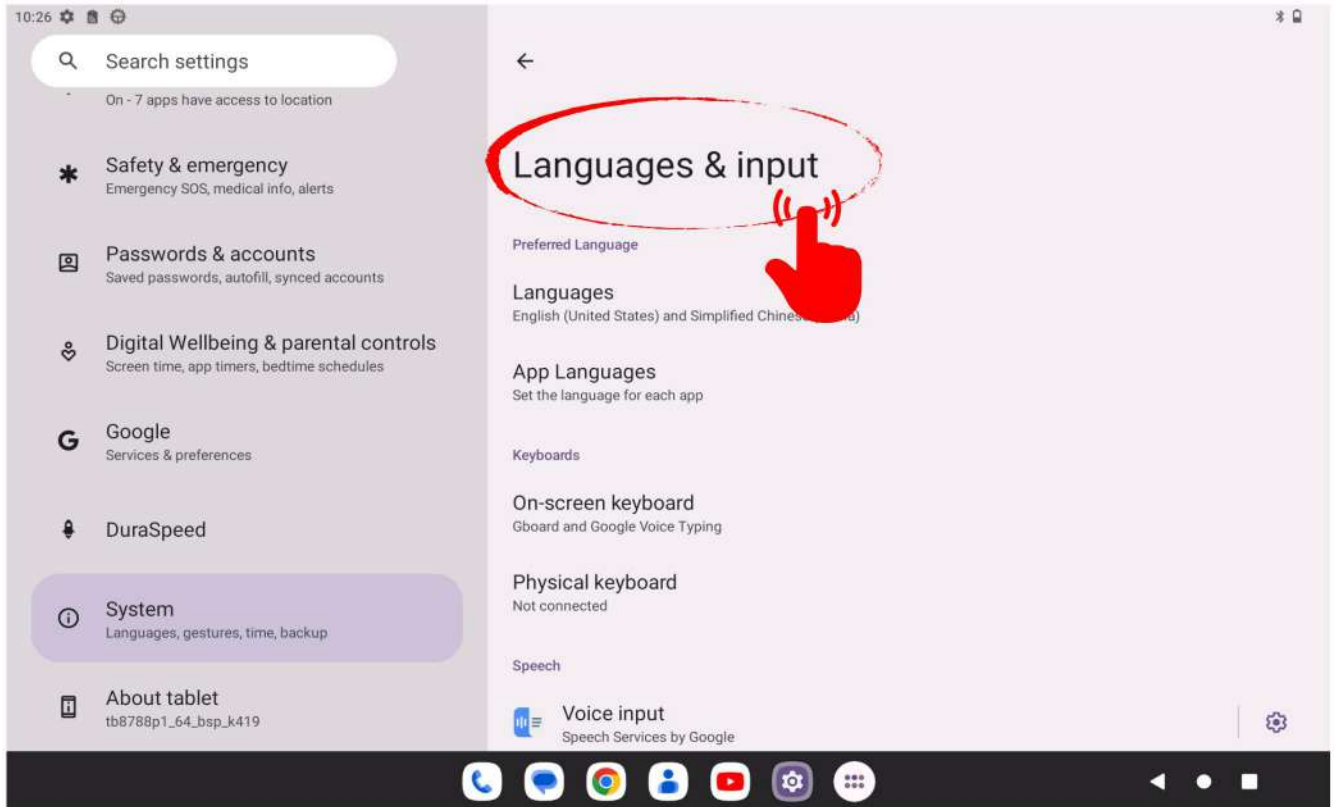

Select “Languages” to configure the language settings



English (United States) is the default

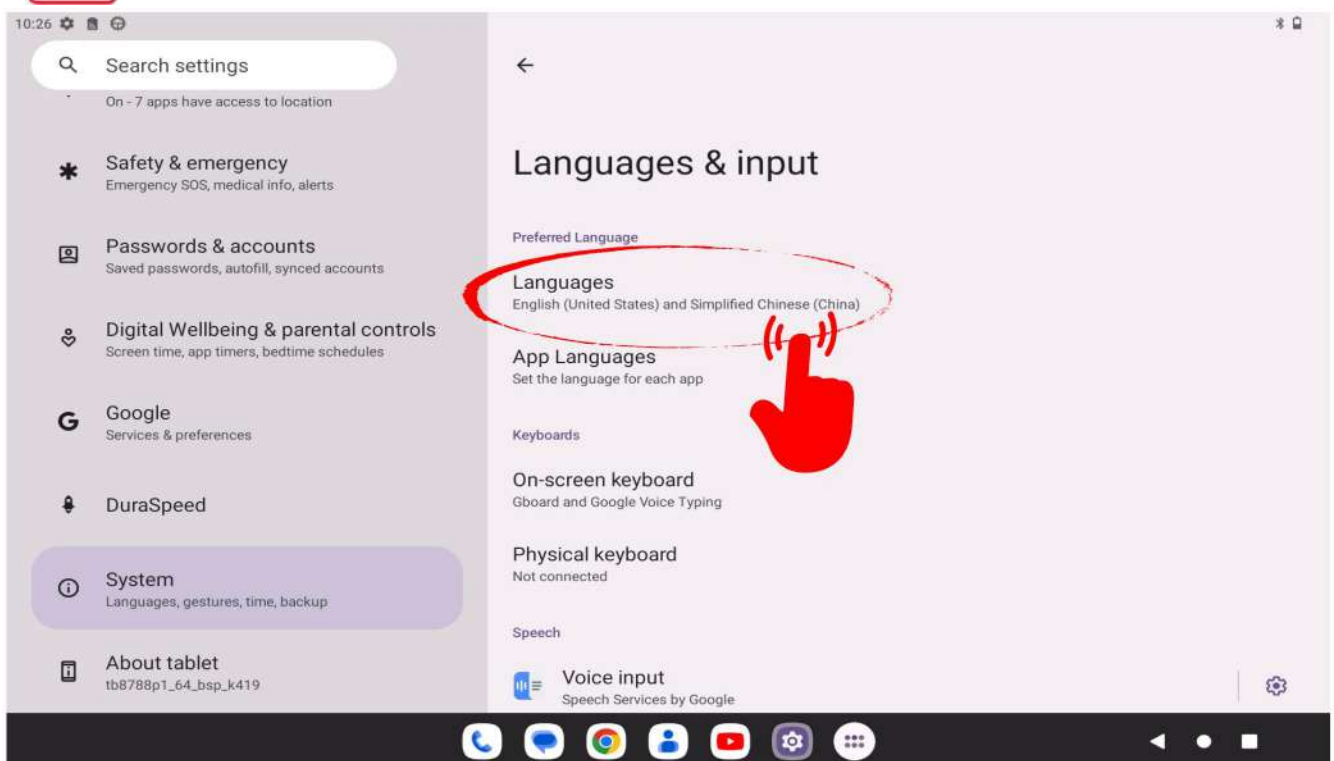

Tap “add a language” to choose and change languages

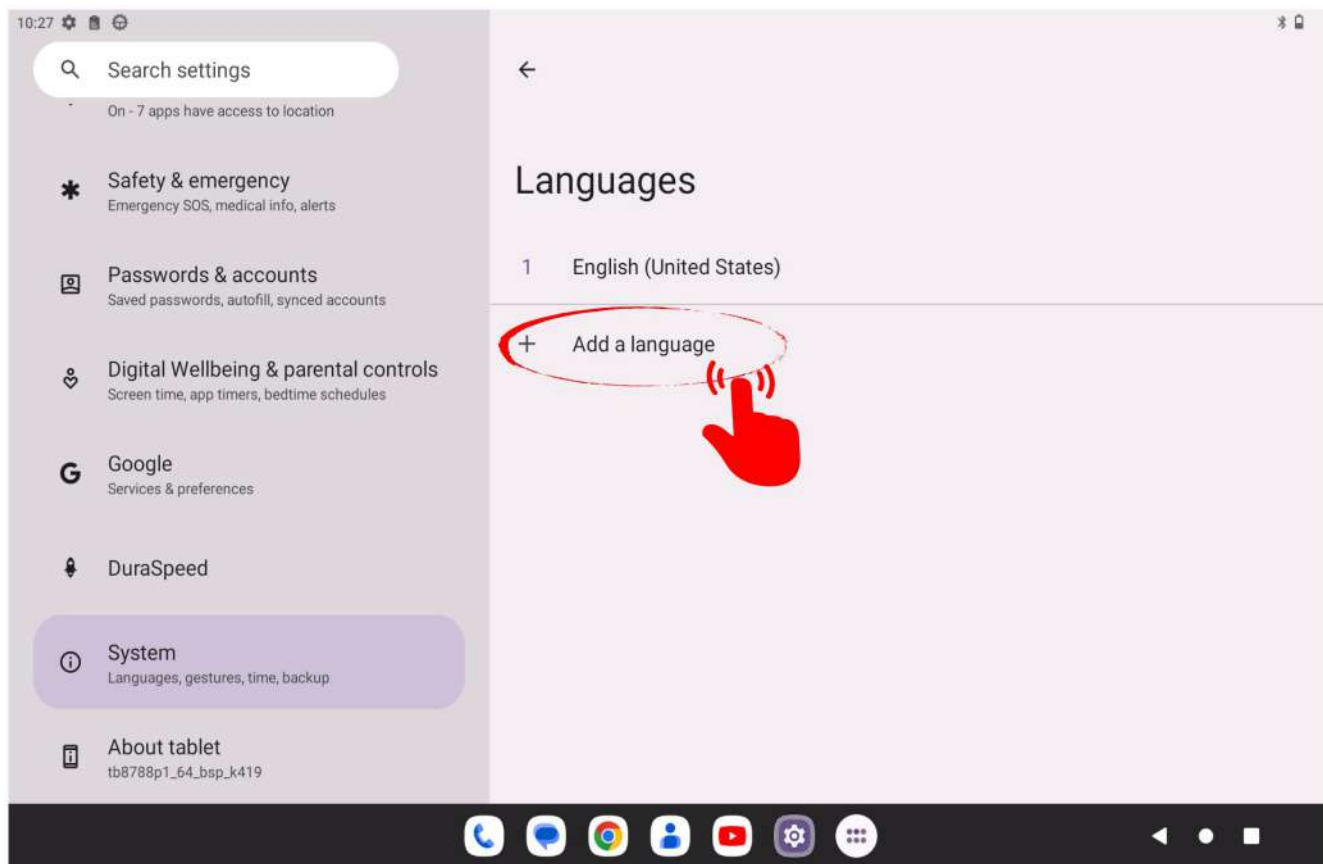

After adding a language, please long-press the bar and move it to the “1” position

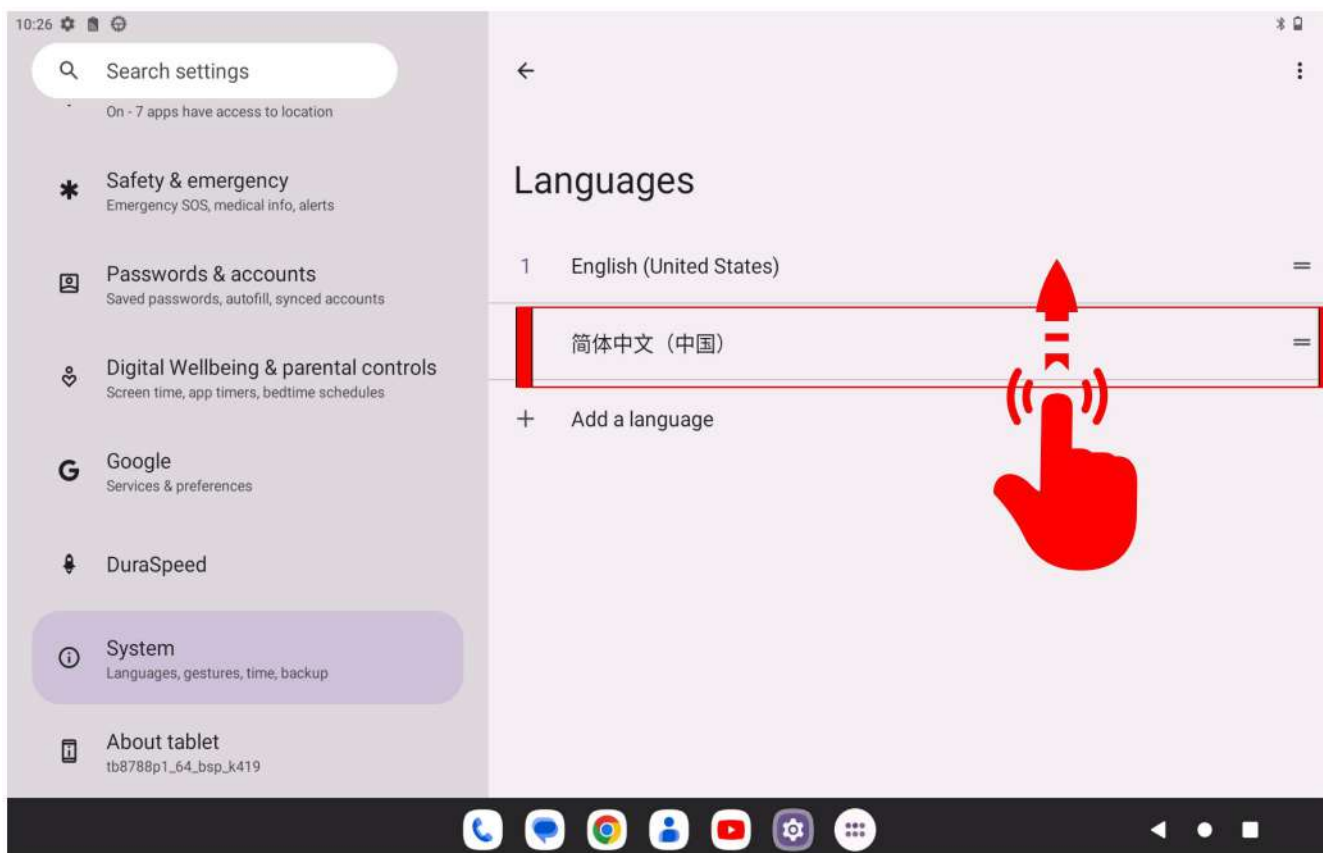

Check the system date and time

Select “Date & time” appropriate for your time zone

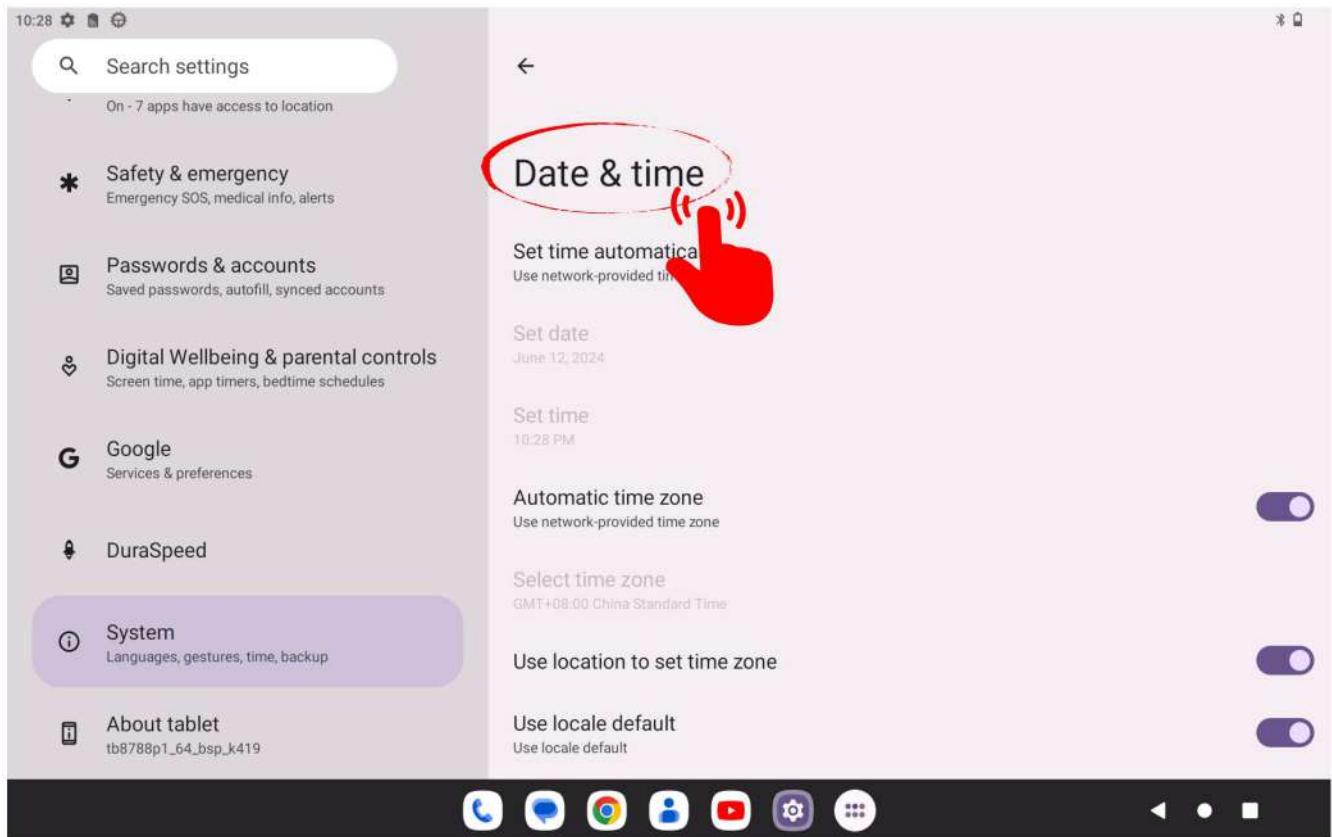

Display the date & time and check if it is correct

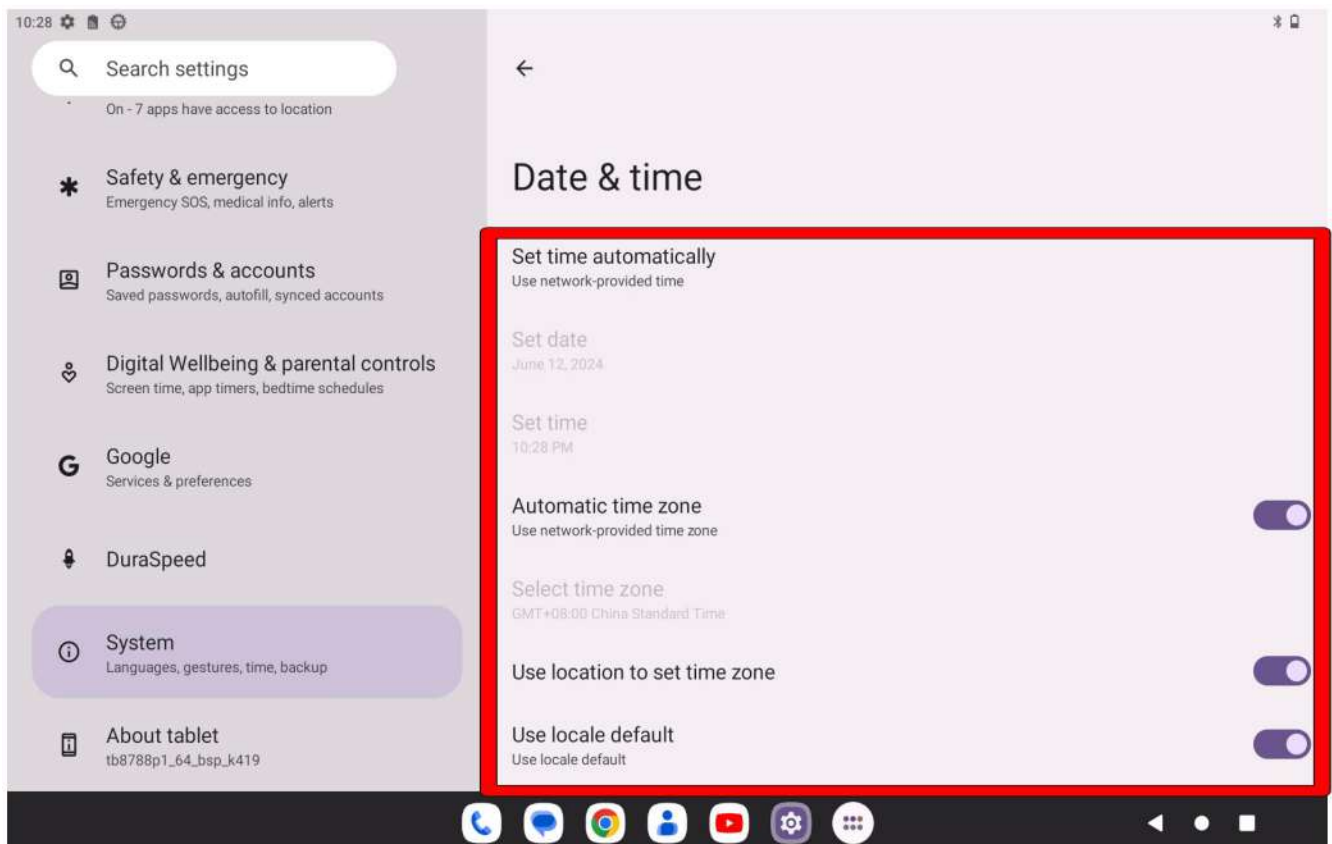

Setting the Network, Internet and Connected Devices

Check the Network & Internet

Tap “Settings” and select “Network & Internet”

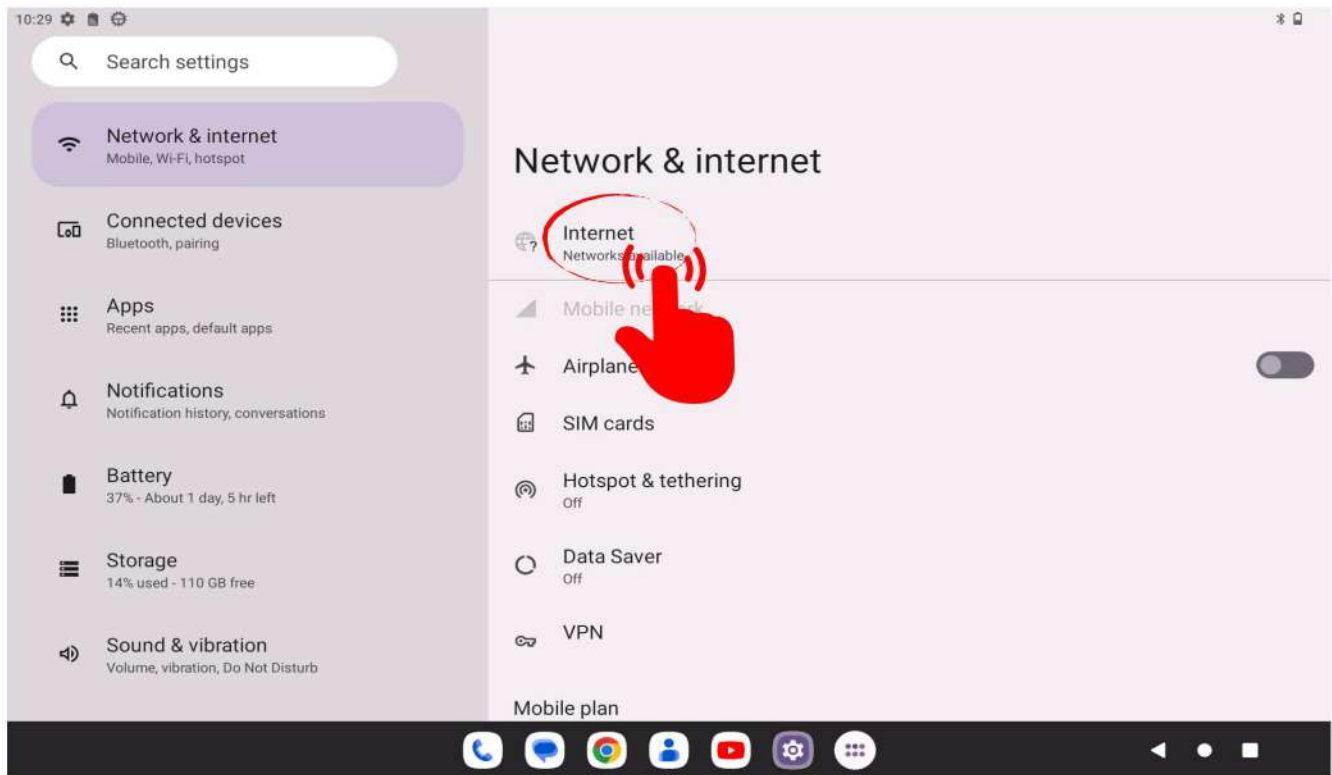

After enter “Network & Internet”, you can tap Advanced to do more settings

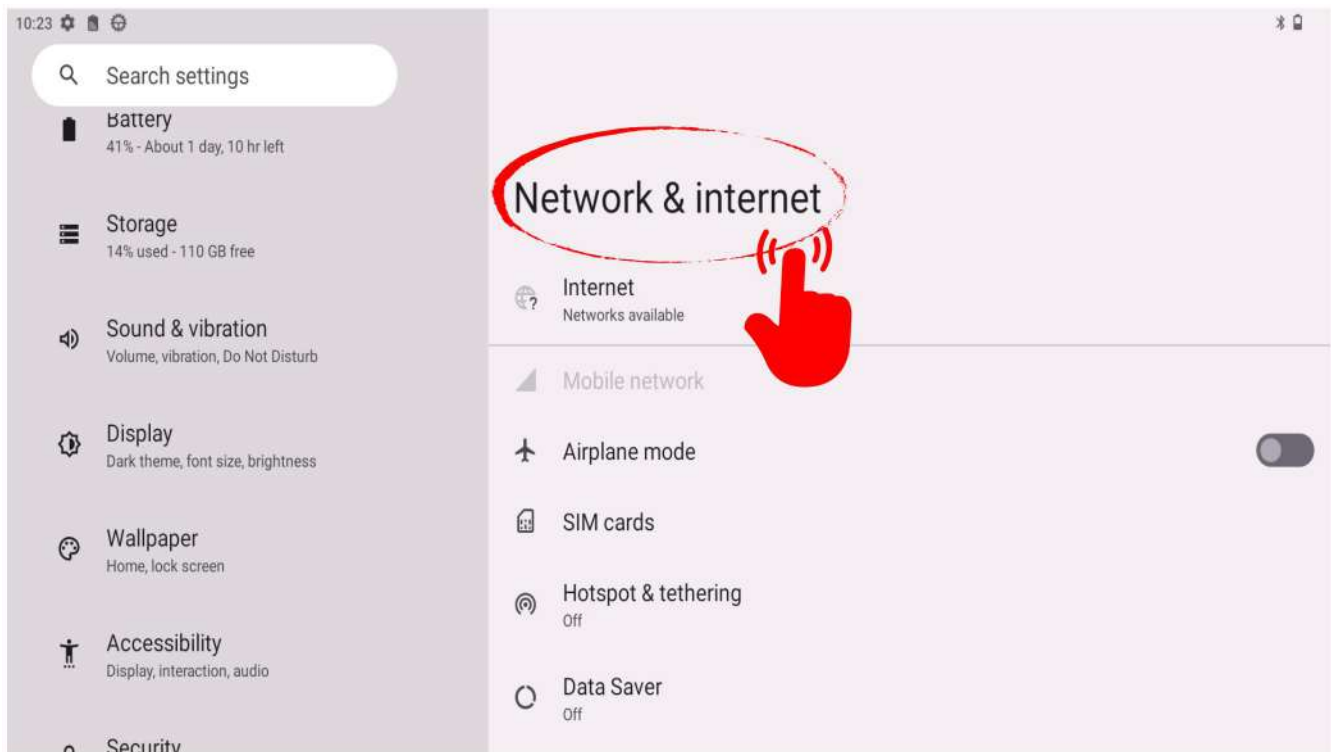

1) Select “Internet” and turn on the function

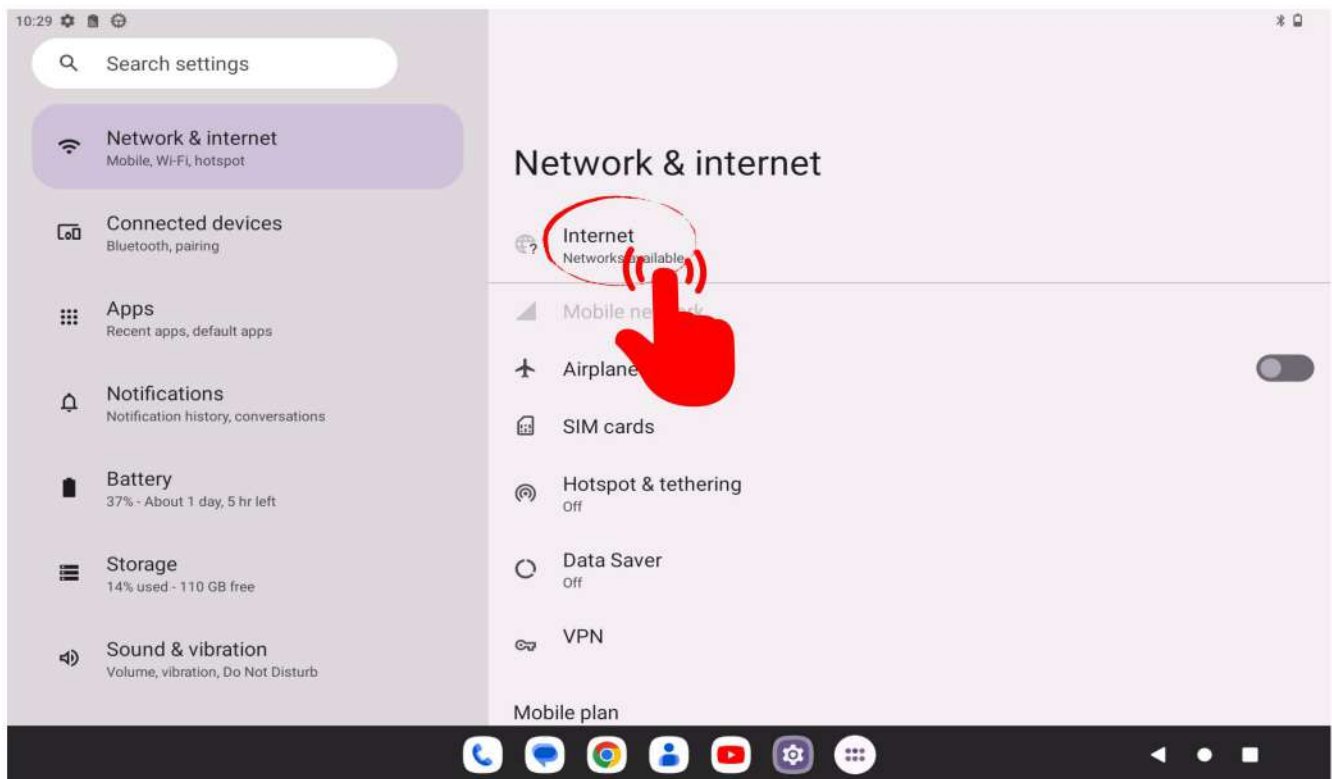

Select the name of your network and key in your password



2) Select “Mobile network” to check Networking settings



Make sure the SIM#1 card or SIM#2 card is plugged in

Hot-swappable SIM#1 card design

Support Dual SIM Dual Standby (DSDS) for Data only

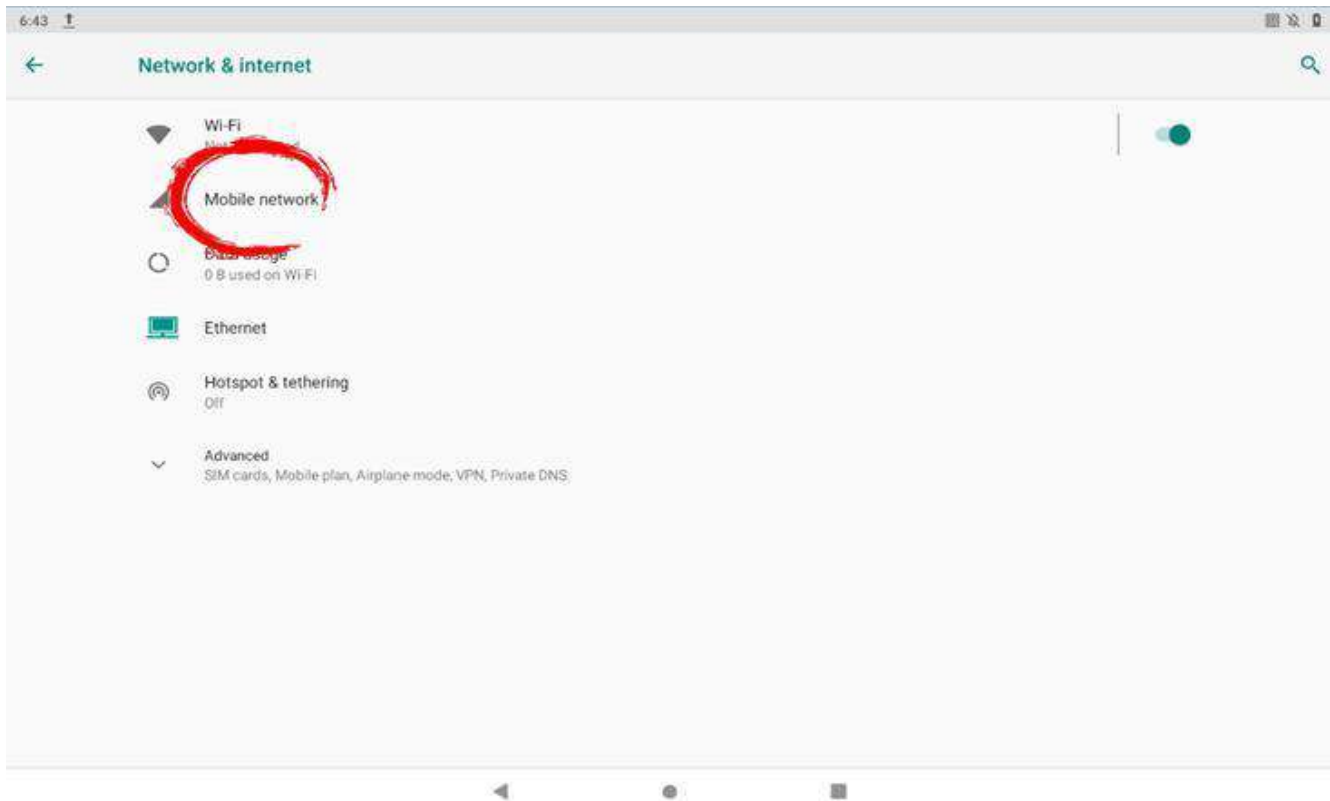

Show SIM#1 card information



Tap Advanced to see more information

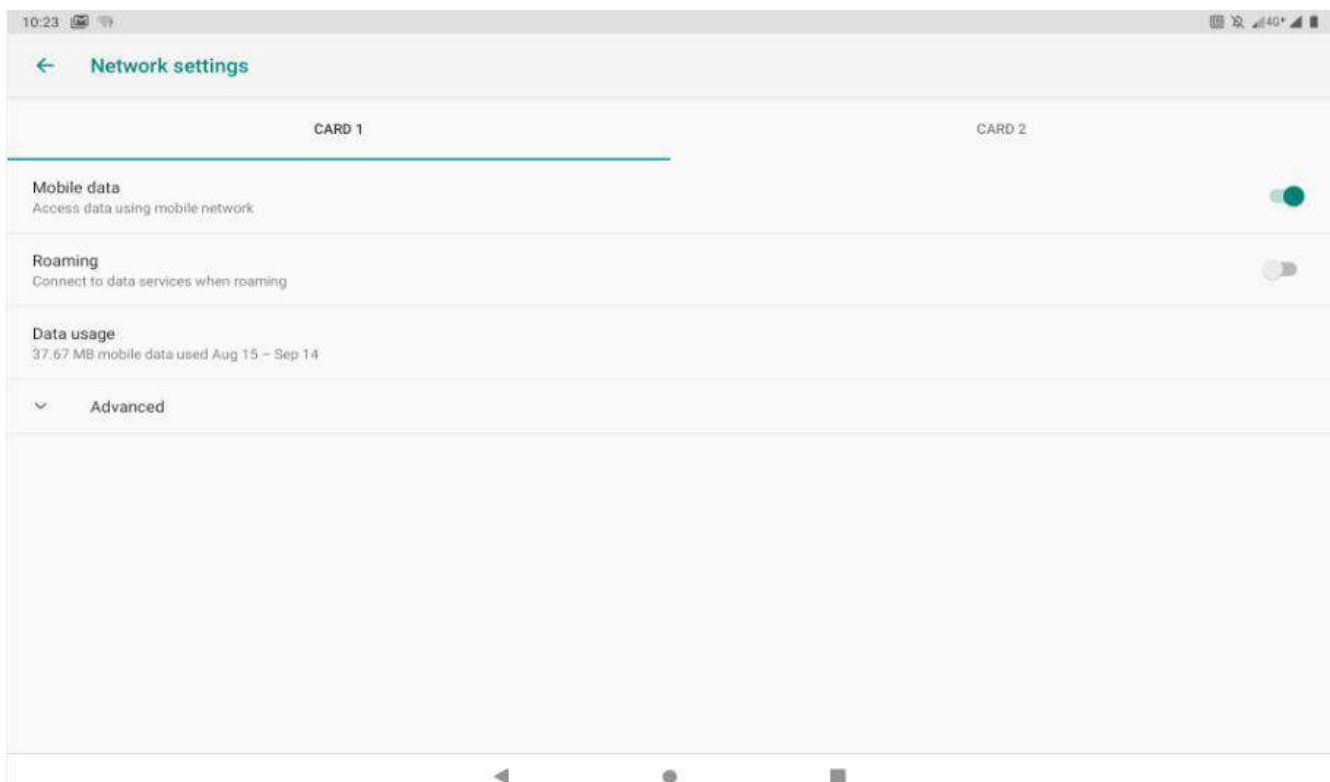

Tap “card 2” to show SIM#2 card information



Tap Advanced to see more information

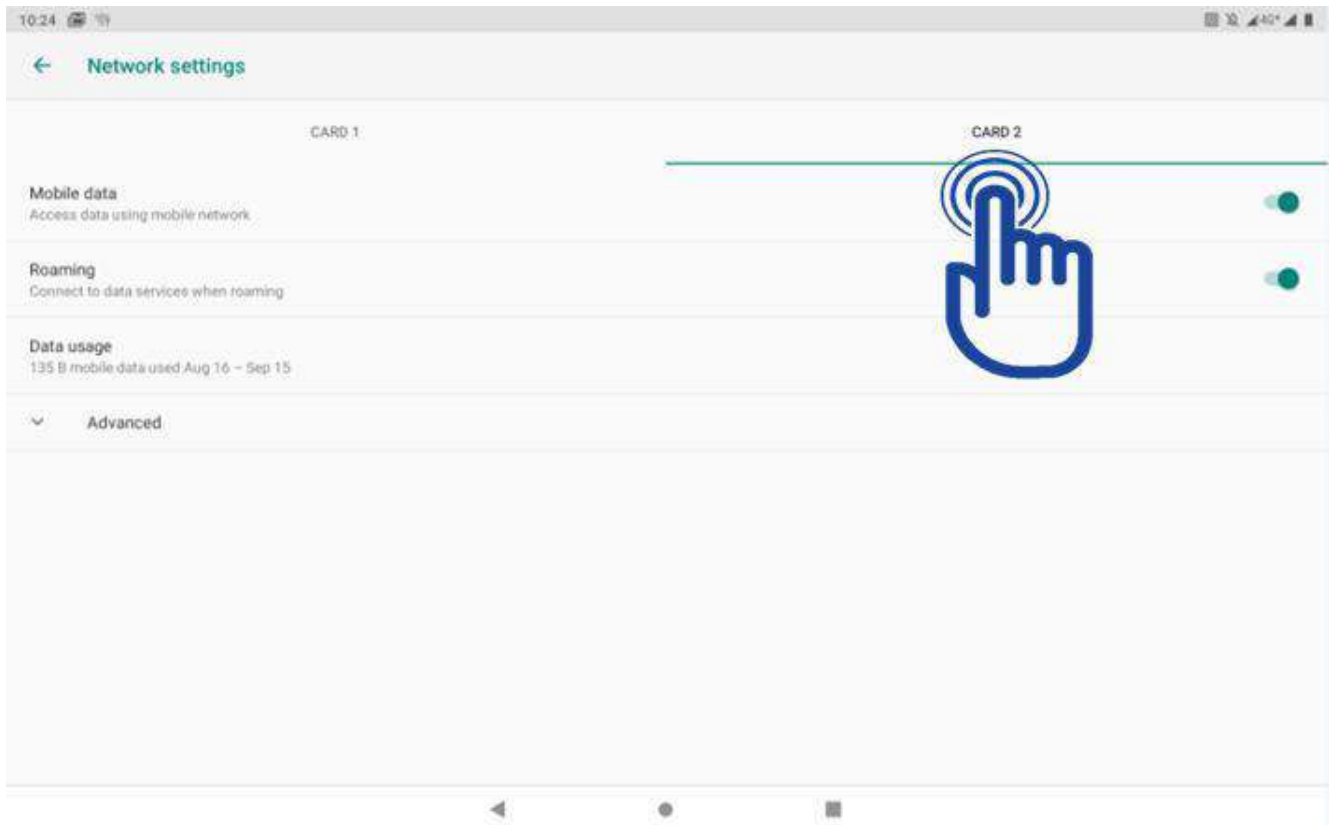

Go back to the “Mobile network” and select “SIM cards” to choose a preferable carrier.

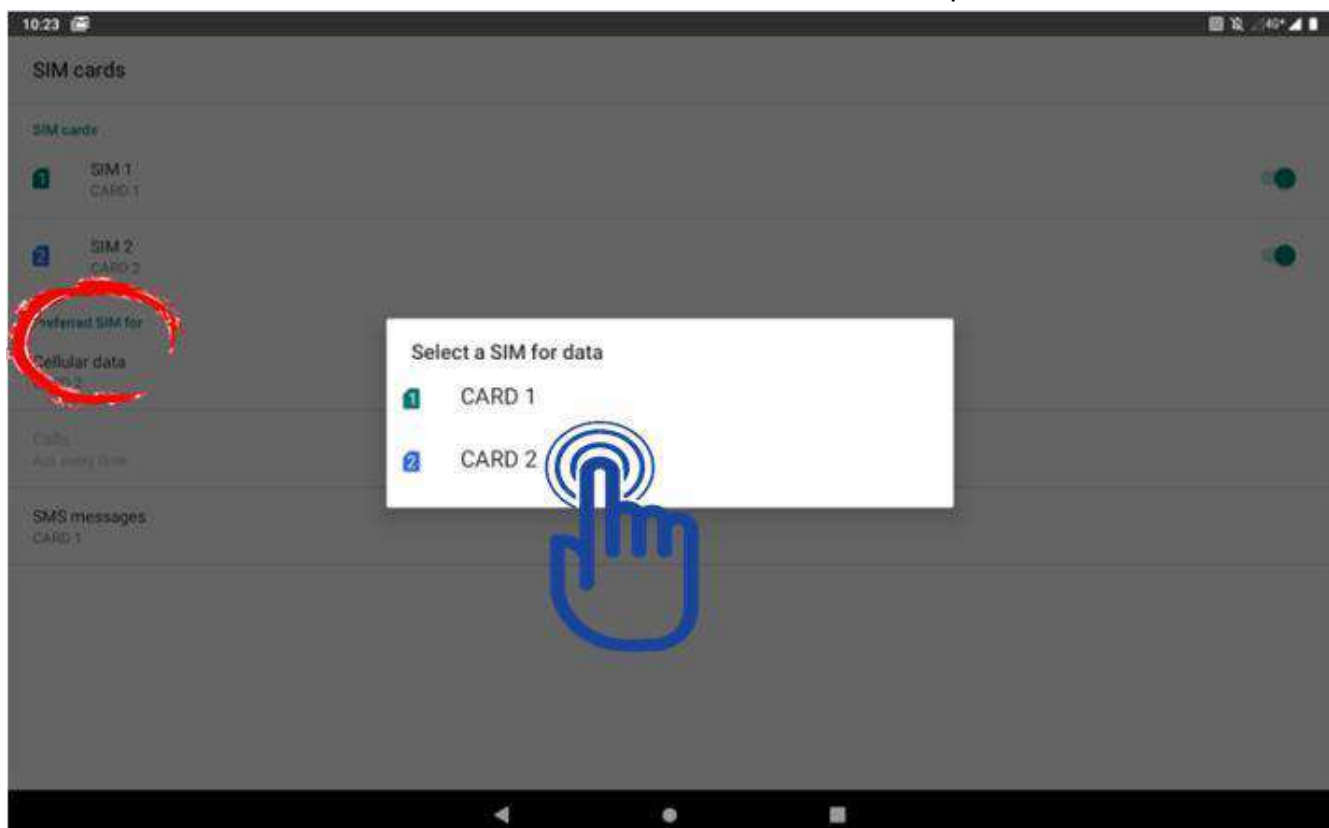

3) Select “Ethernet” to check Ethernet settings



Make sure RJ45 cable is plugged in

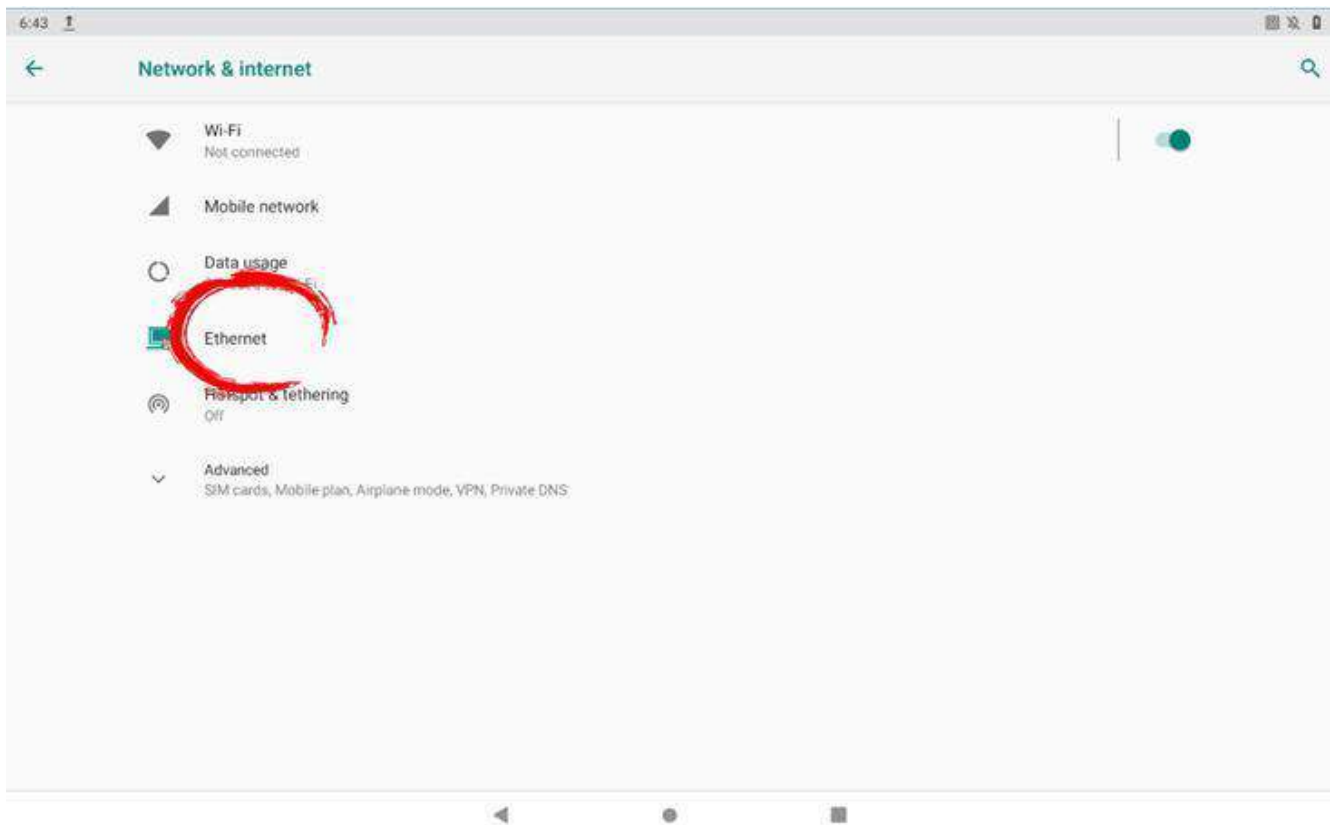

Turn on “Ethernet” function to check Ethernet settings

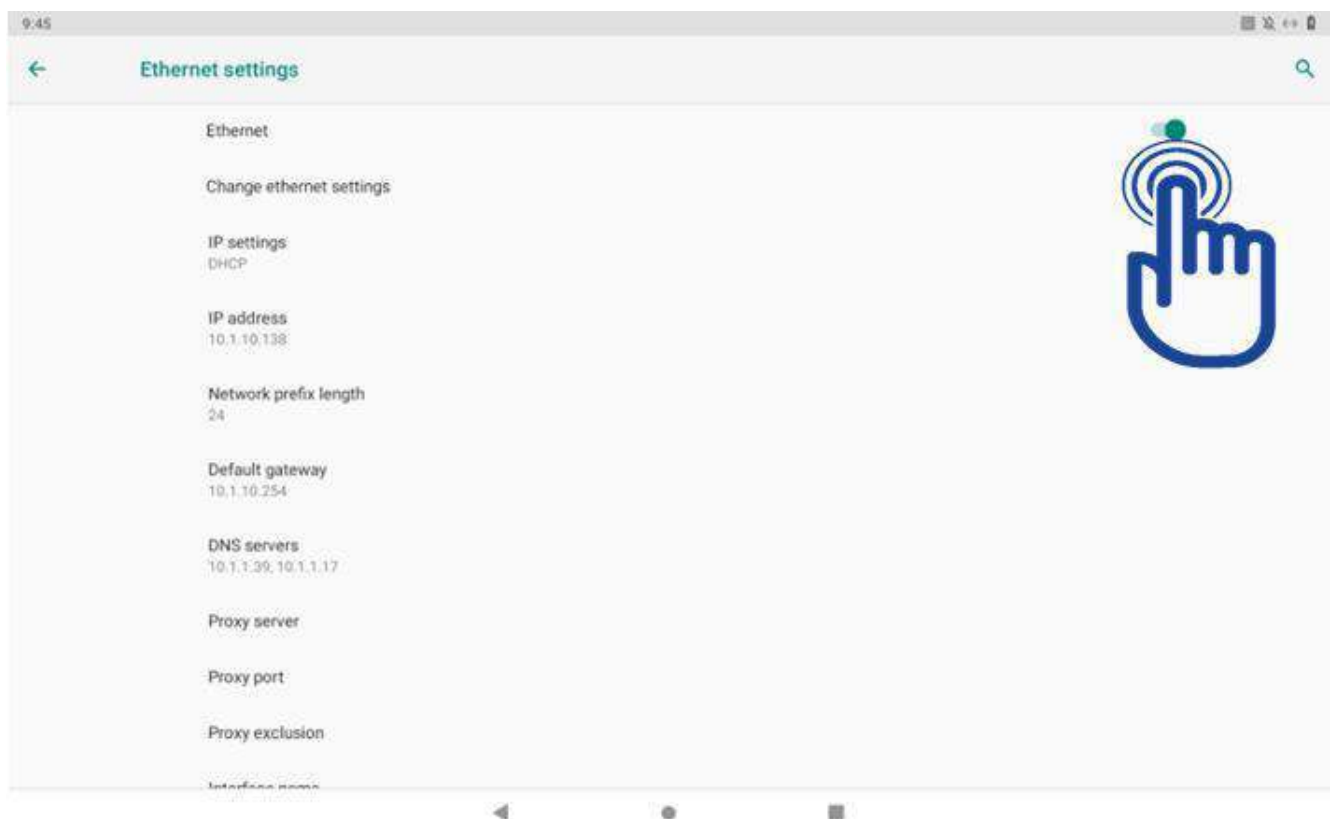

Hotspot & tethering

Select “Hotspot & tethering” to configure the device settings



Wi-Fi hotspot only supports 2.4GHz

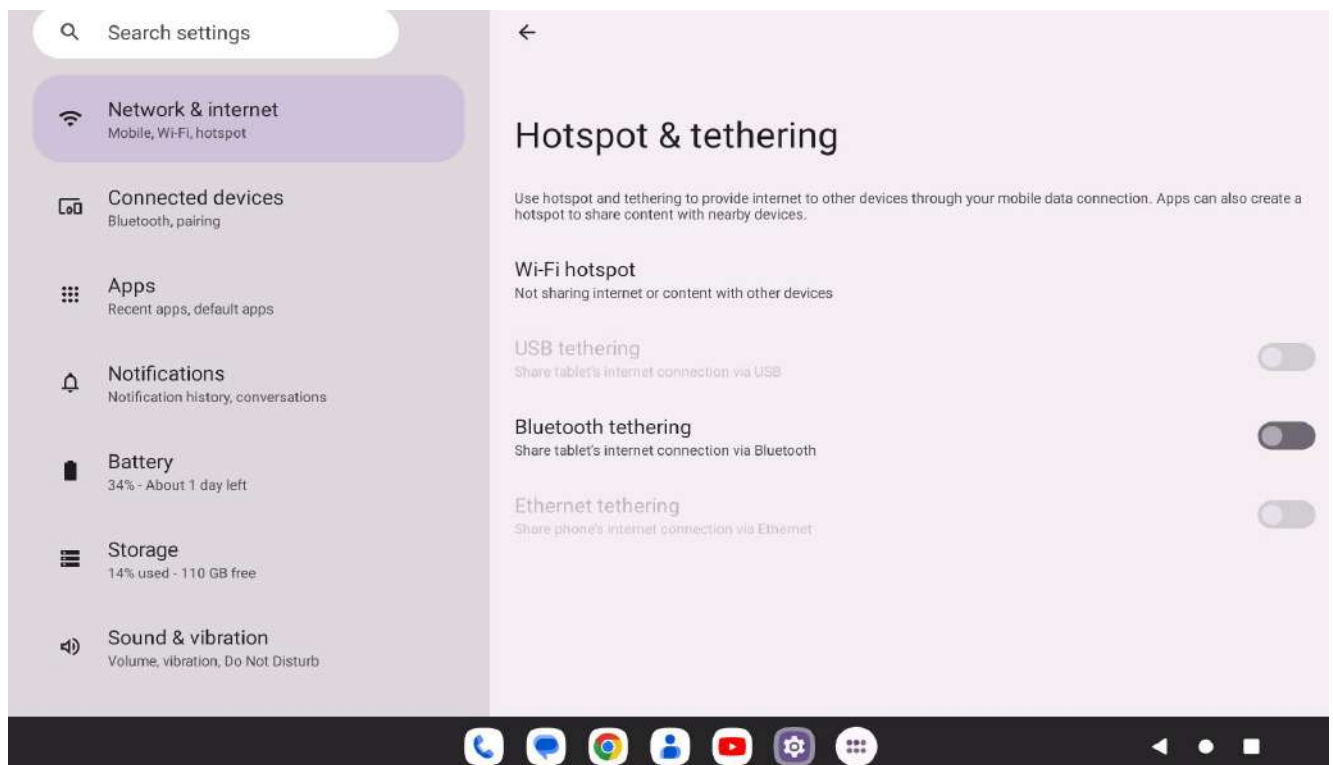
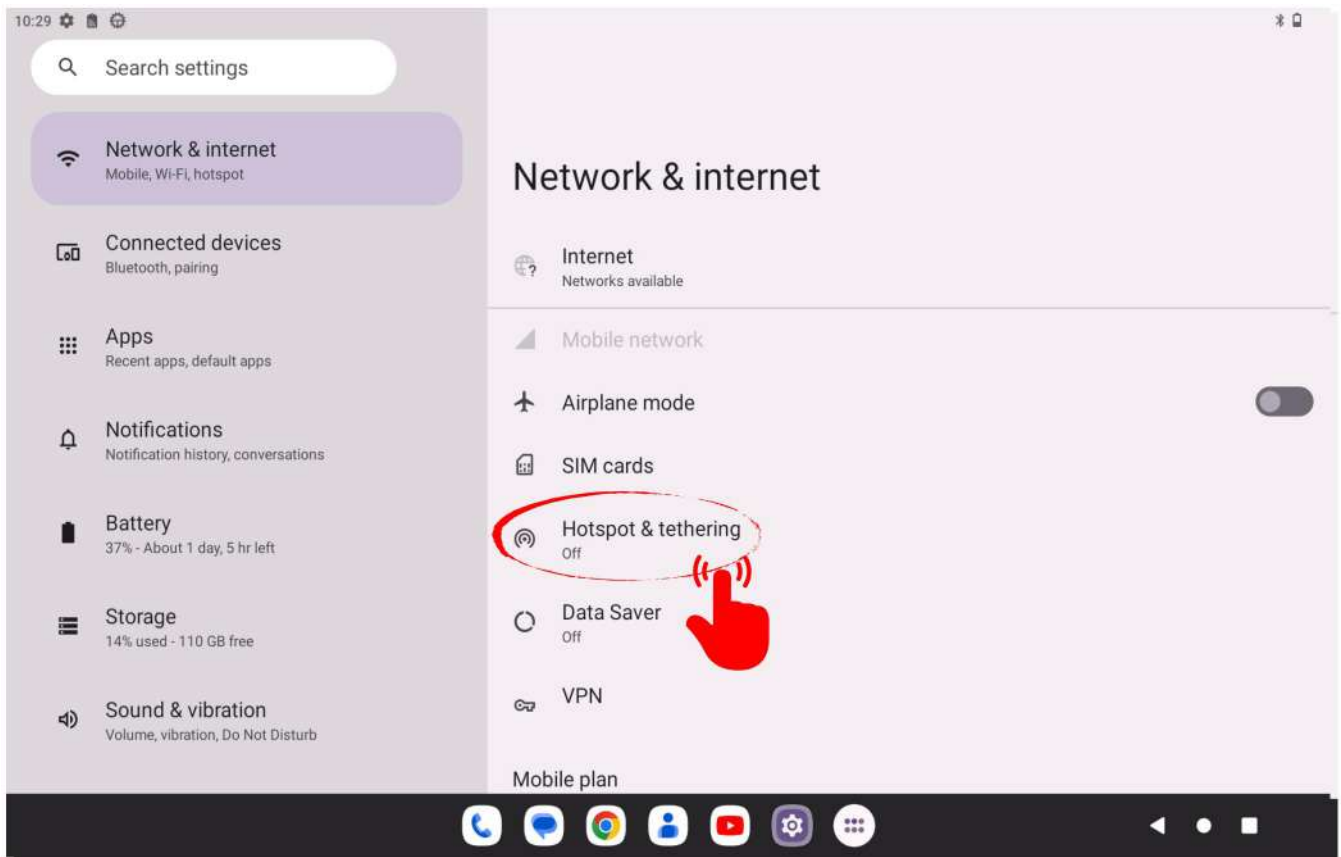

Connected devices

Select “Connected devices” to configure the device settings

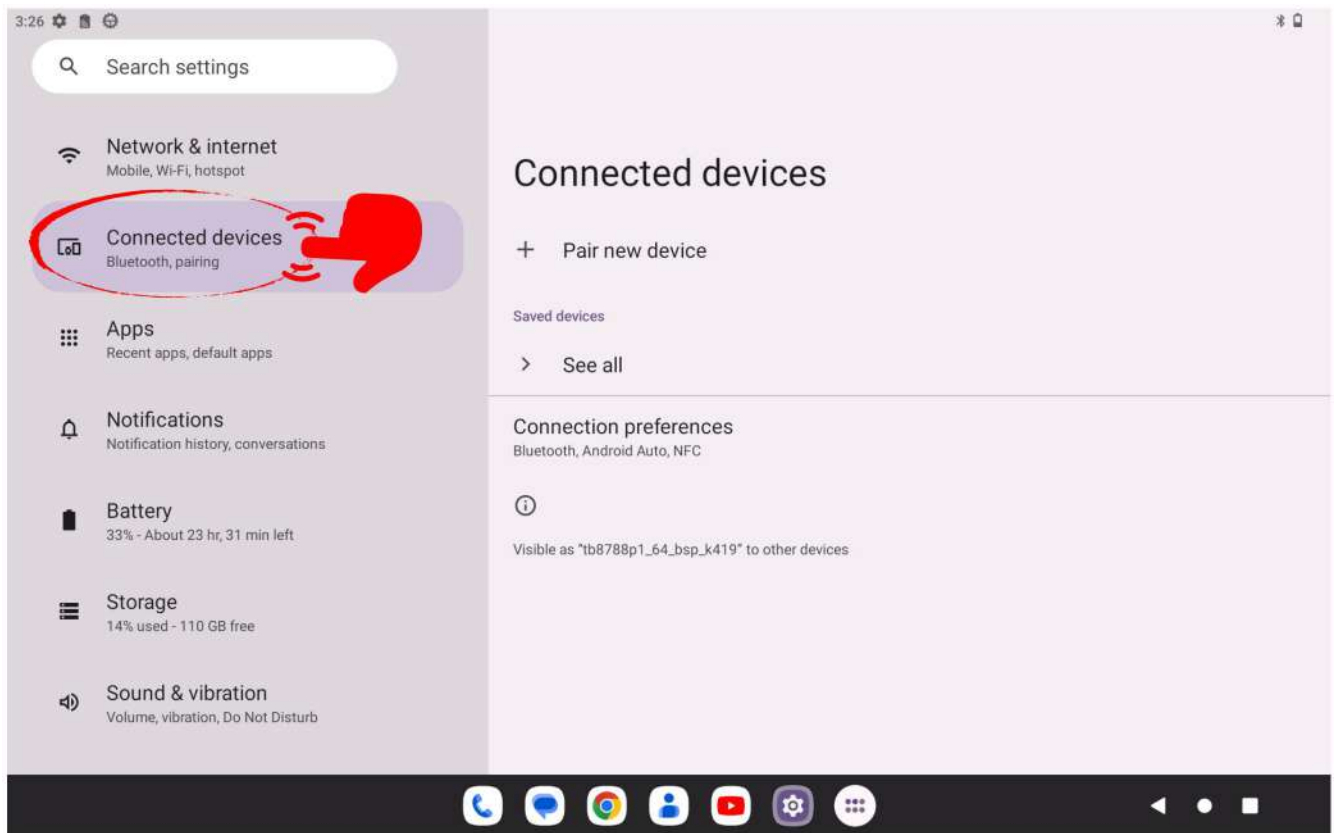

Select “Pair” new device” to search the device



Must turn on the wireless functions

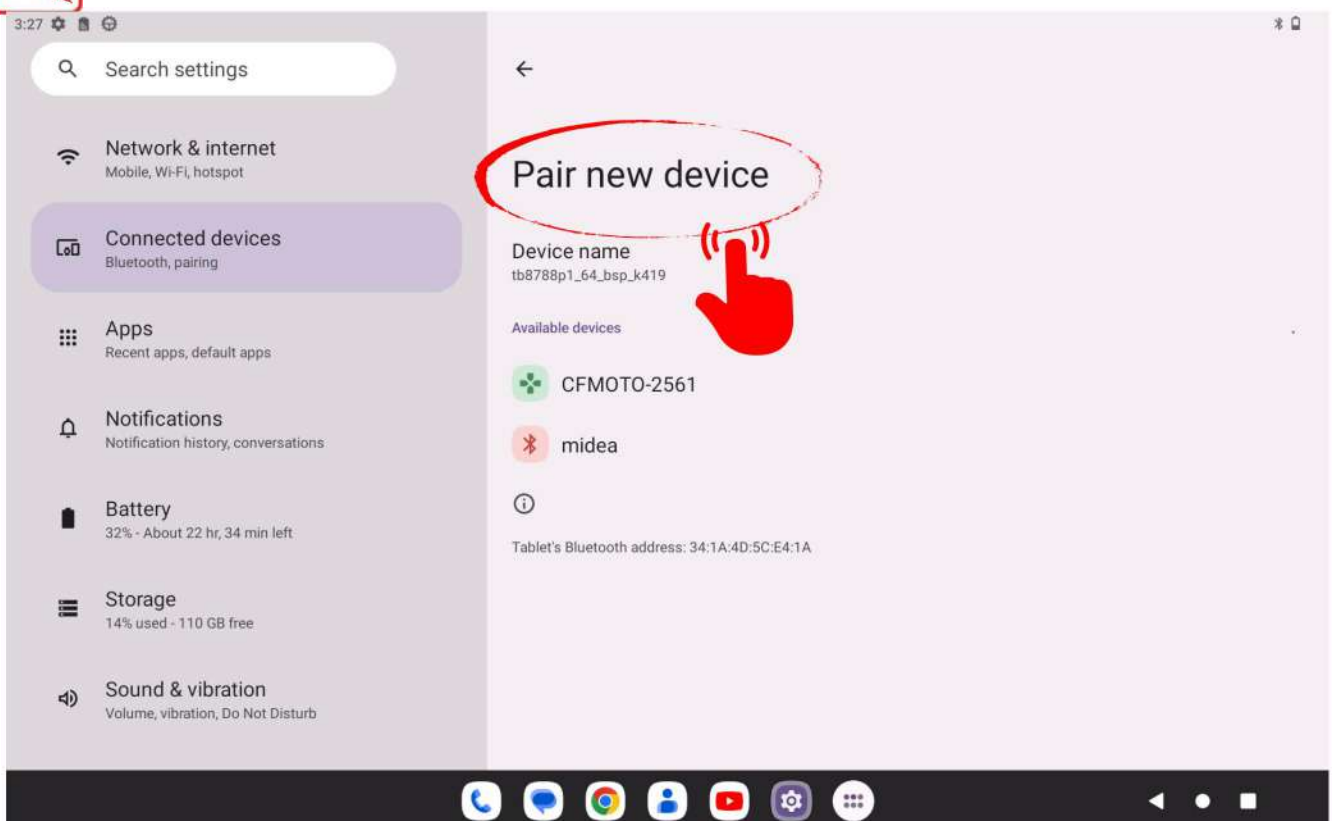

Choose one of the available device names

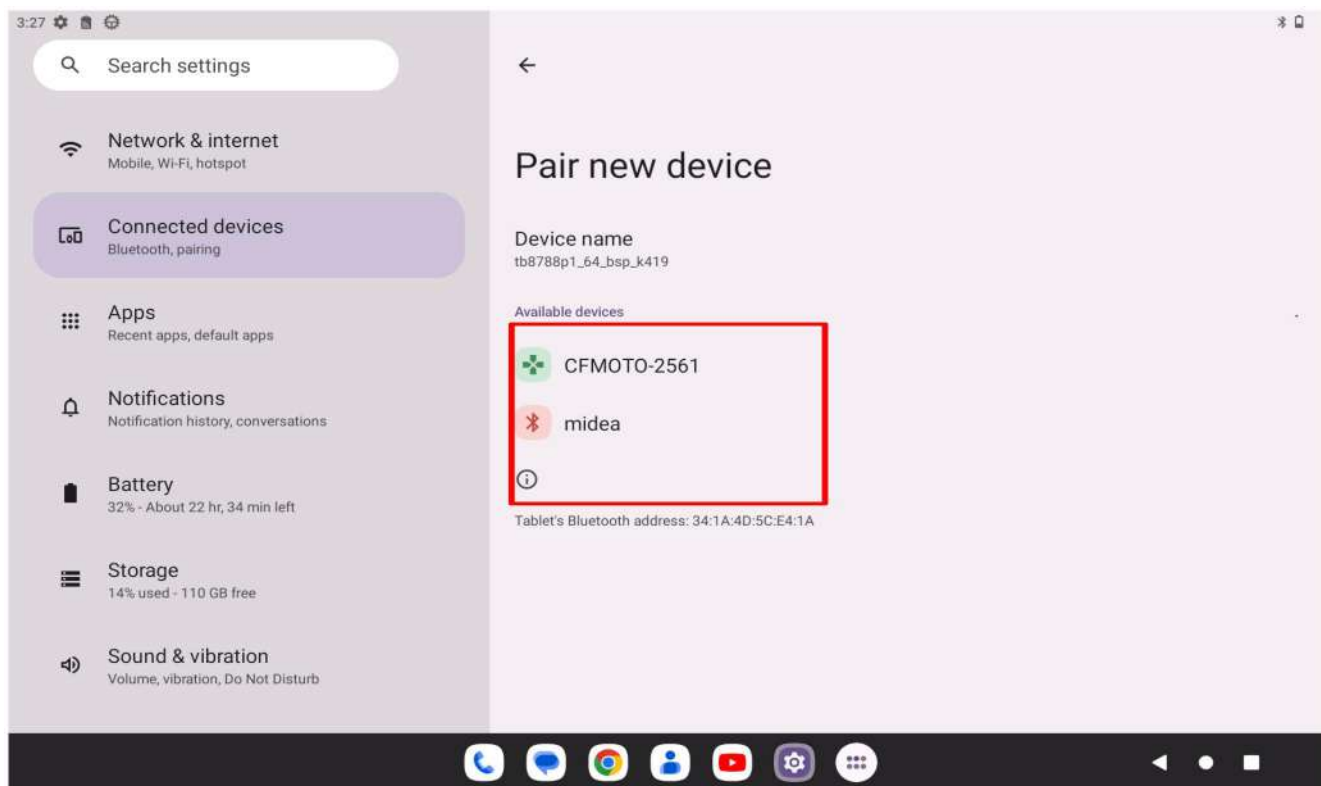

Select "Connection preferences" to choose which devices you prefer to connect, like Bluetooth, barcode scanner or NFC...etc.

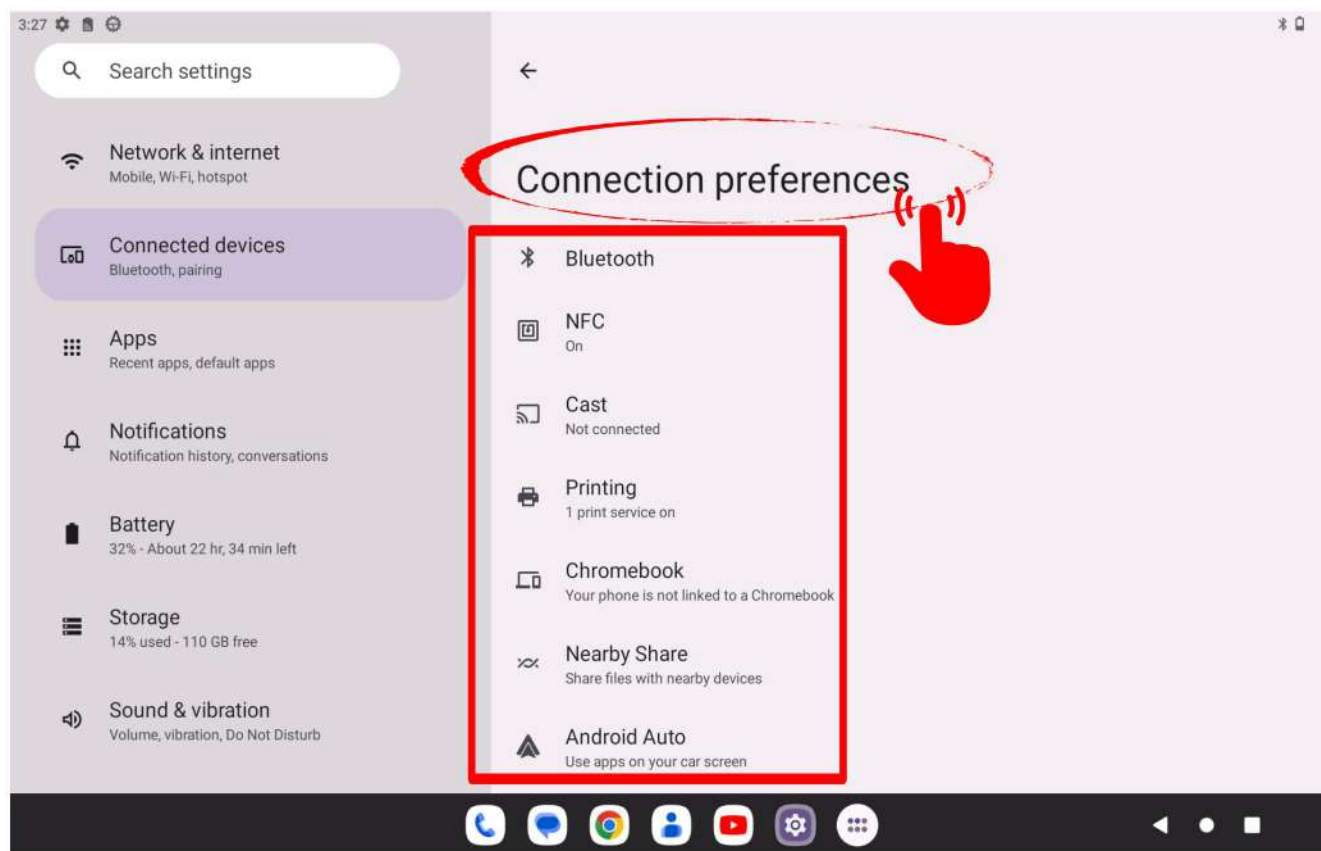

QR code scanning

When QR code scanning is integrated in the system, open the calculator App and type " (777)=" to go to test mode, then choose "Barcode" to start up QRcode scanning



QR code scanning is an optional feature



Basic Operations and Settings

Moving items

Tap and hold an item, and then drag it to a new location. To move the item to another panel, drag it to the side of the screen.

To add a shortcut to an app on the Home screen, tap and hold an item on the Apps screen, and then tap Add to Home. A shortcut to the app will be added on the Home screen.

You can also move frequently used apps to the shortcuts area at the bottom of the Home screen.

Creating folders

Create folders for similar apps to quickly access and launch apps. On the Home screen or Apps screen, tap and hold an app, and then drag it over another app.

Thus, creates a new folder that contains the selected apps. Tap Enter folder name and enter a folder name.

- Adding more apps: Tap Add apps on the folder. Tick the apps to add and tap Add. You can also add an app by dragging it to the folder.
- Moving apps from a folder: Tap and hold an app to drag it to a new location.
- Deleting a folder: Tap and hold a folder, and then tap Delete folder. Only the folder will be deleted. The folder's apps will be relocated to the Apps screen.

Editing the Home screen

On the Home screen, tap and hold an empty area, or pinch your fingers together to access the editing options. You can set the wallpaper, add widgets, and more.

- Wallpapers: Change the wallpaper settings for the Home screen and the locked screen.
- Widgets: Small apps that activate specific app functions for information and convenient access on your Home screen. Tap and hold a widget, and then drag it to the Home screen. The widget will be added on the Home screen.
- Home screen settings: Change the size of the grid to display more or fewer items on the Home screen and more.

Notification panel

On the Home screen, swipe downward to open the Notification panel.

To return to the Home screen, swipe upward on the Apps screen. Alternatively, tap the Home button or the Back button

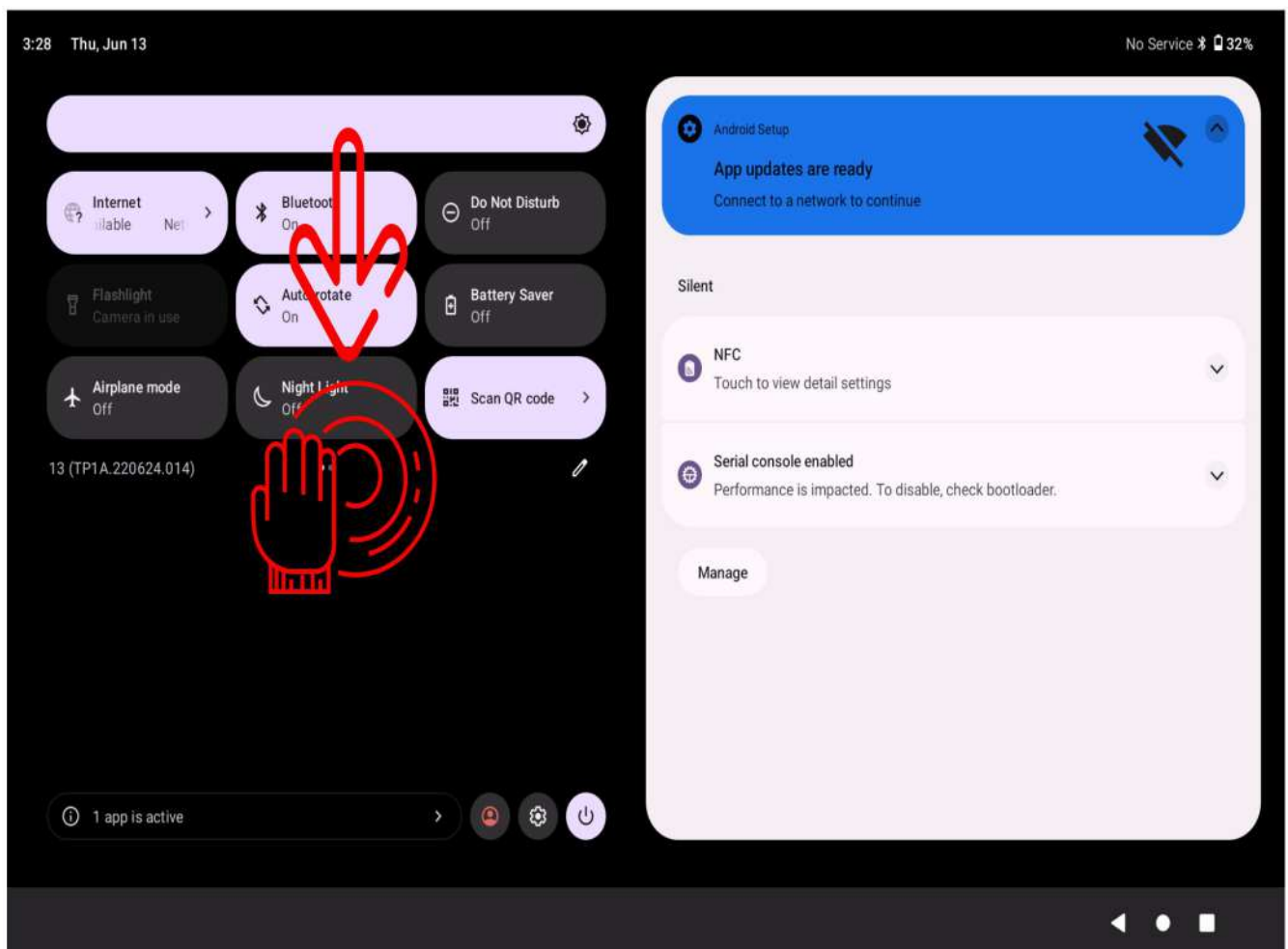

You can use the following functions on the notification panel

Indicator icons will appear on the status bar for notifications when you miss calls or receive new messages. To see more information about the icons, open the notification panel and view the details.

Tap quick setting buttons to activate certain features. Swipe downward on the notification panel to view more buttons.

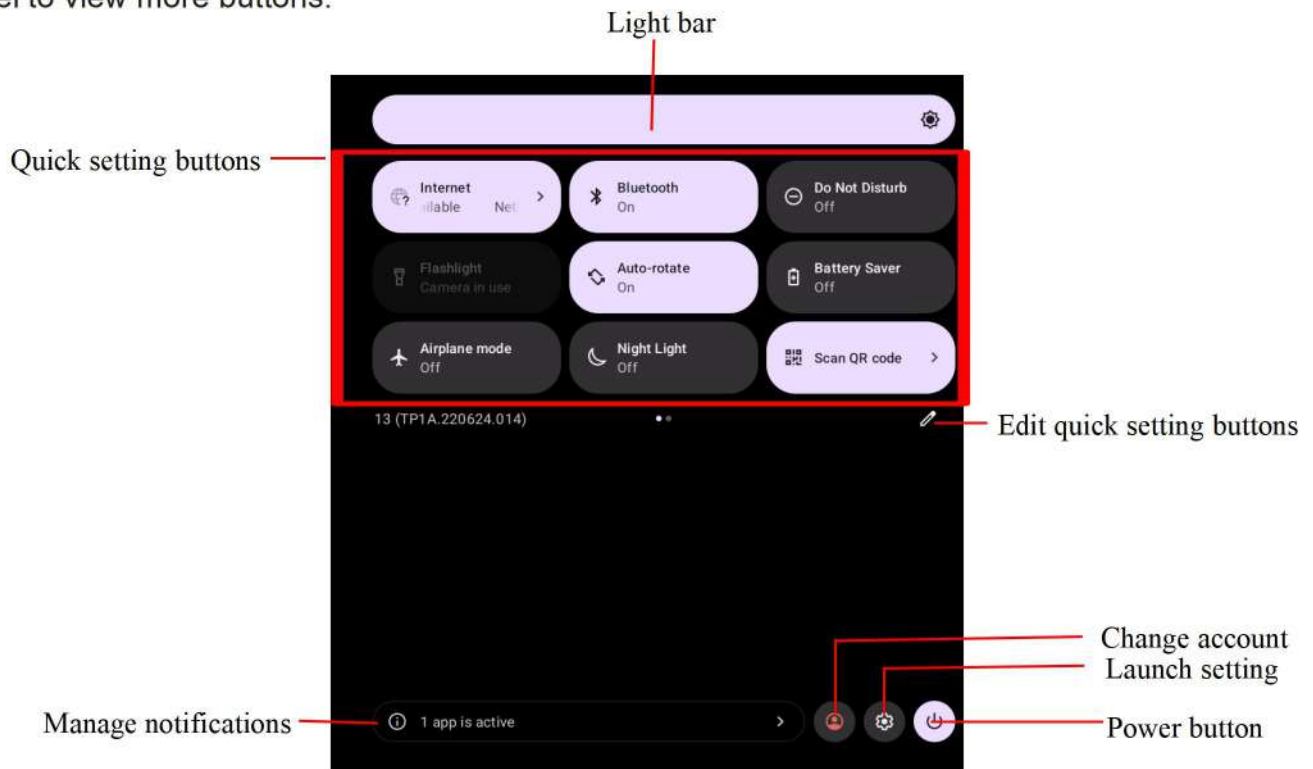

Apps & notifications

Select “Apps & notifications” to manage Apps settings

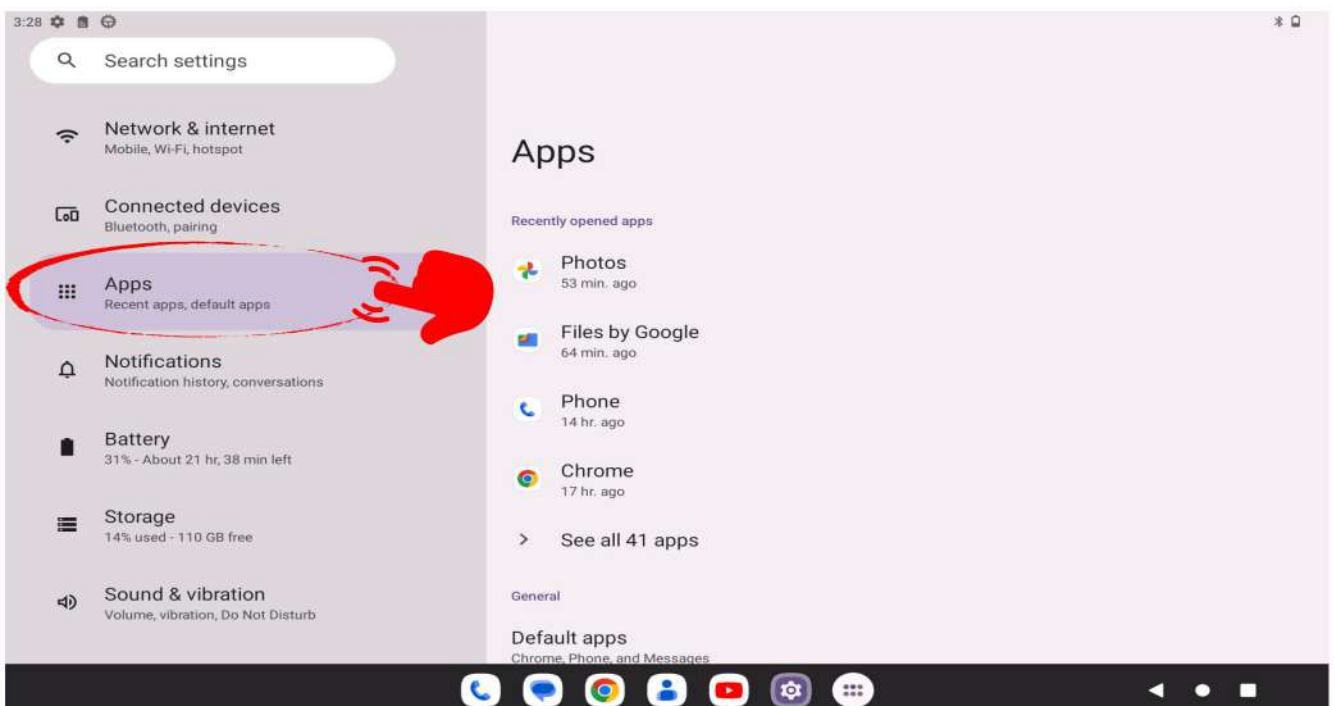

Display all apps to set “Disable” or “Force stop” of them



Tap Advanced to do more settings

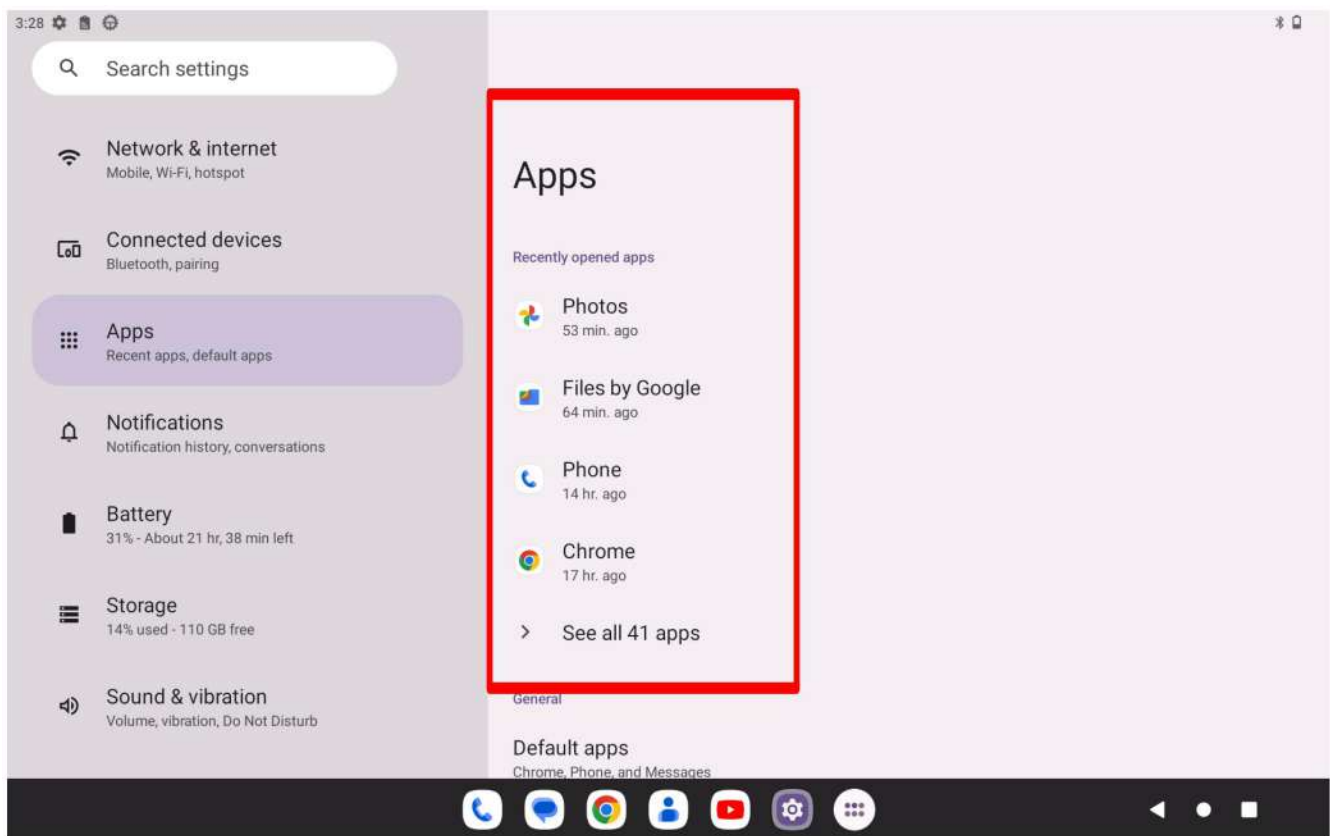

Display

Select “Display” to configure display settings

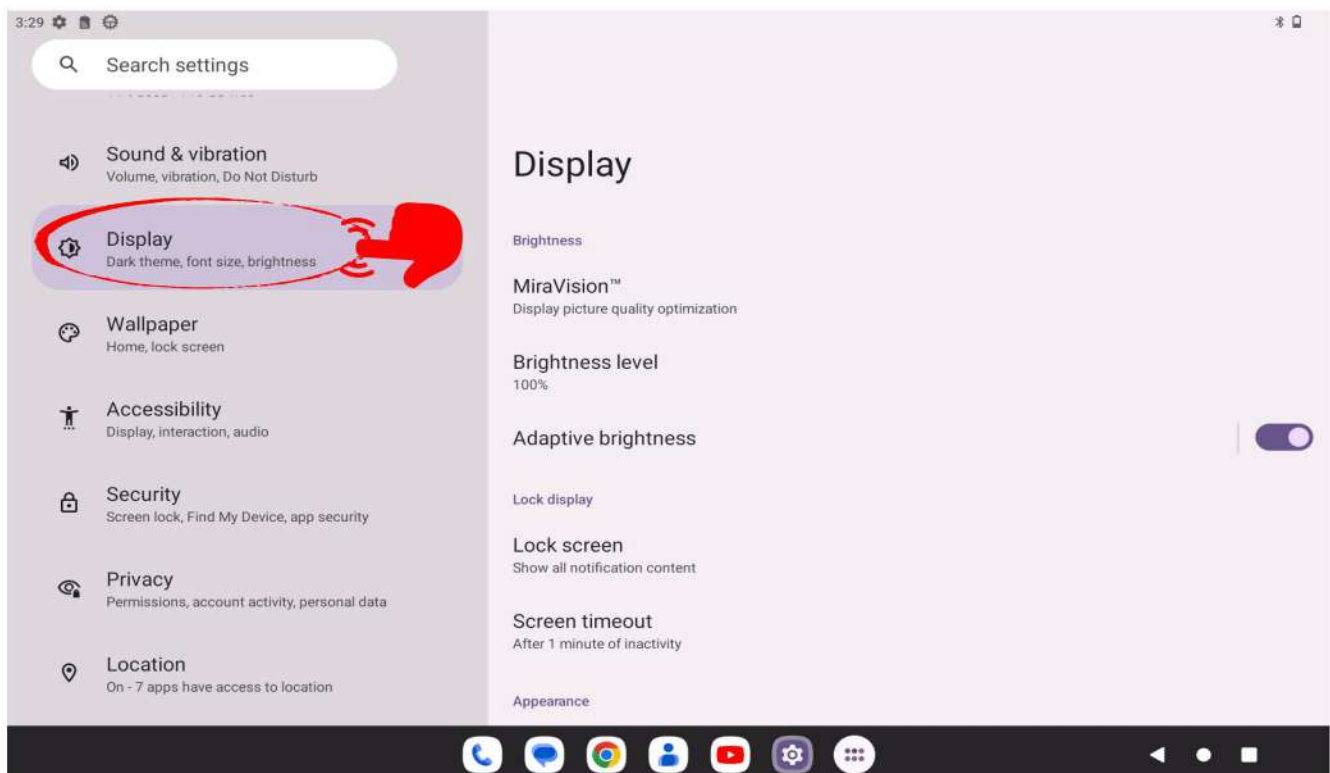

Adjust the configuration of Night Light, Brightness, Wallpaper, Sleep mode, Auto-rotate, Font size, Display size and other display settings.

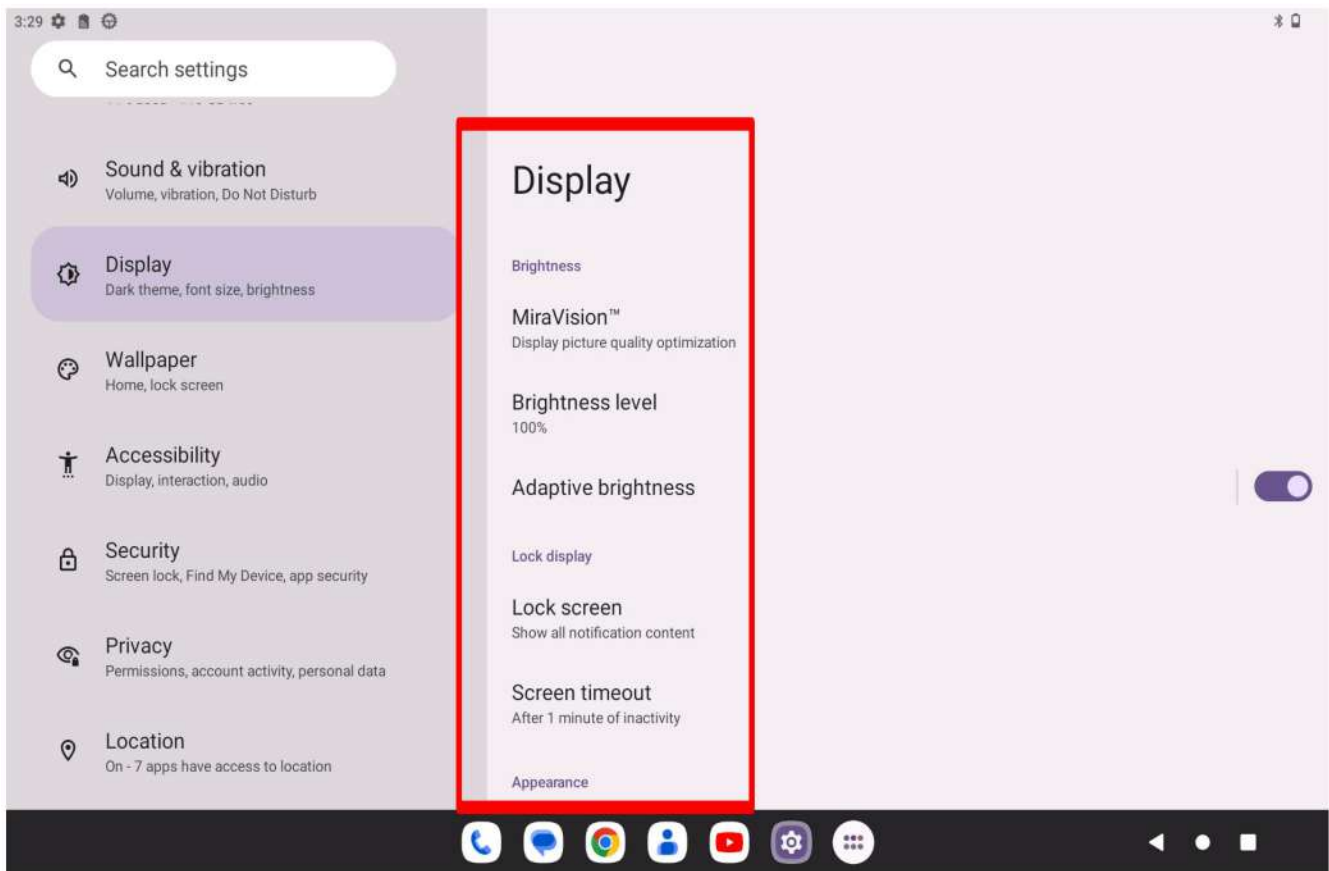

Sound

Select “Sound” to configure volume settings for audio broadcasts

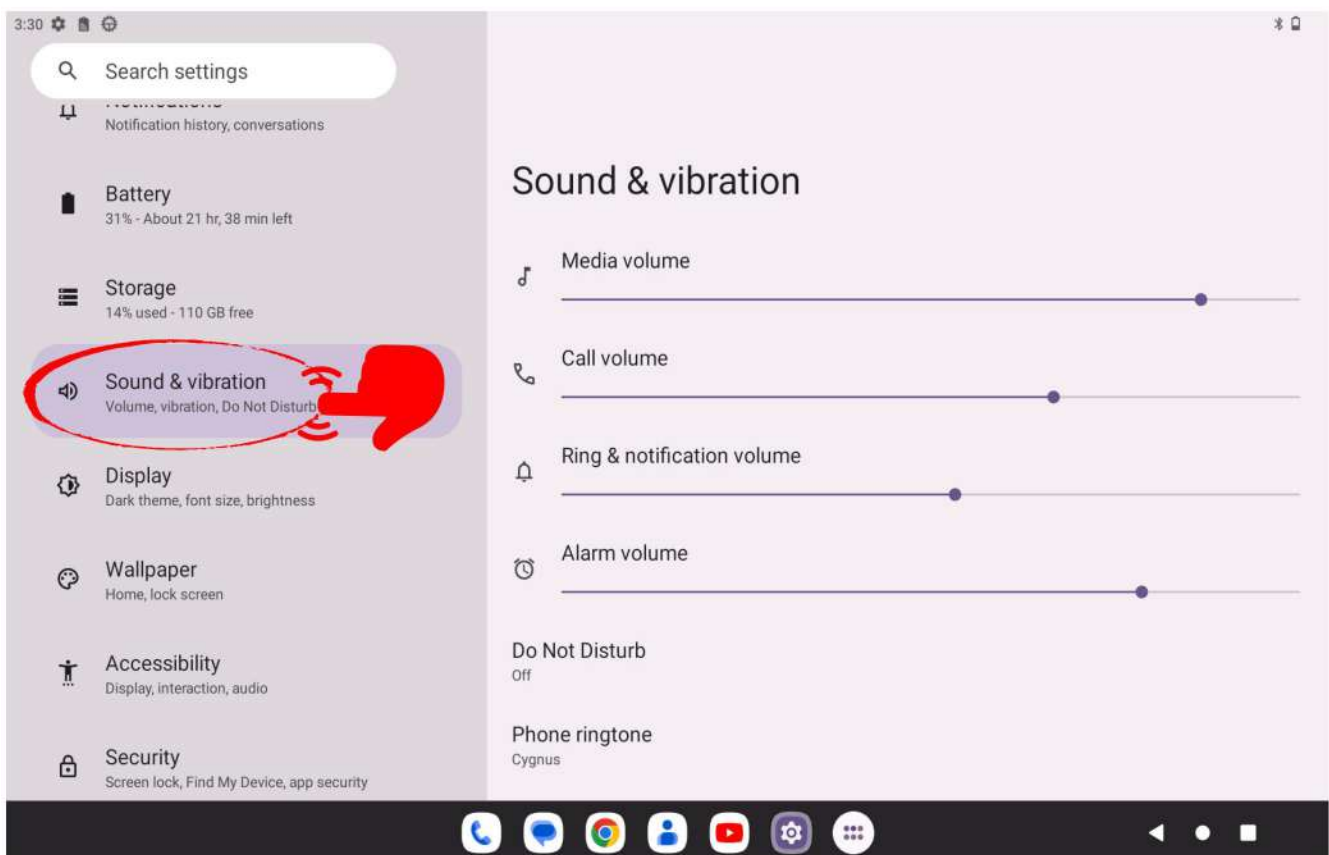

Configure the settings of Media volume, Call volume, Alarm volume, Notification volume and other sound settings..

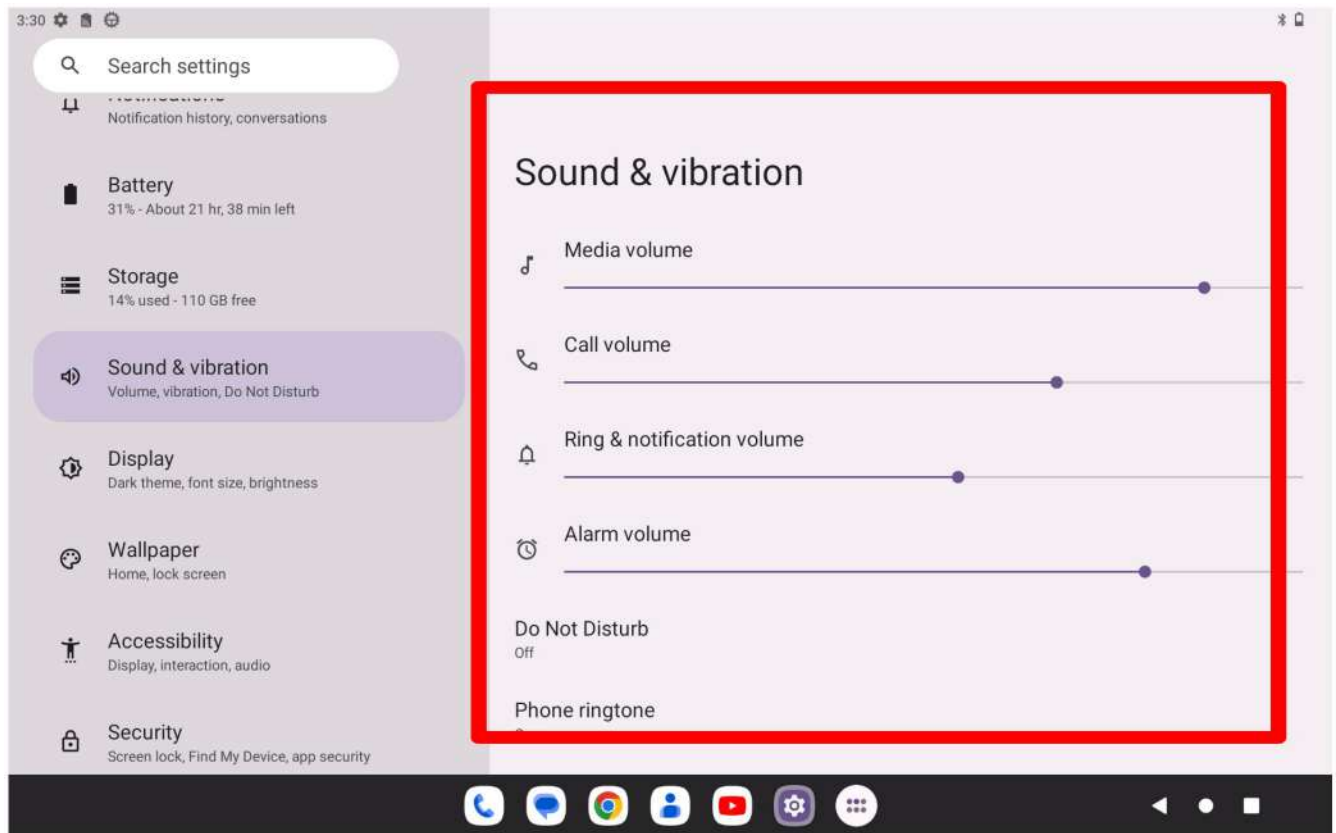

Security & Location

Select “Security & Location” to configure security settings

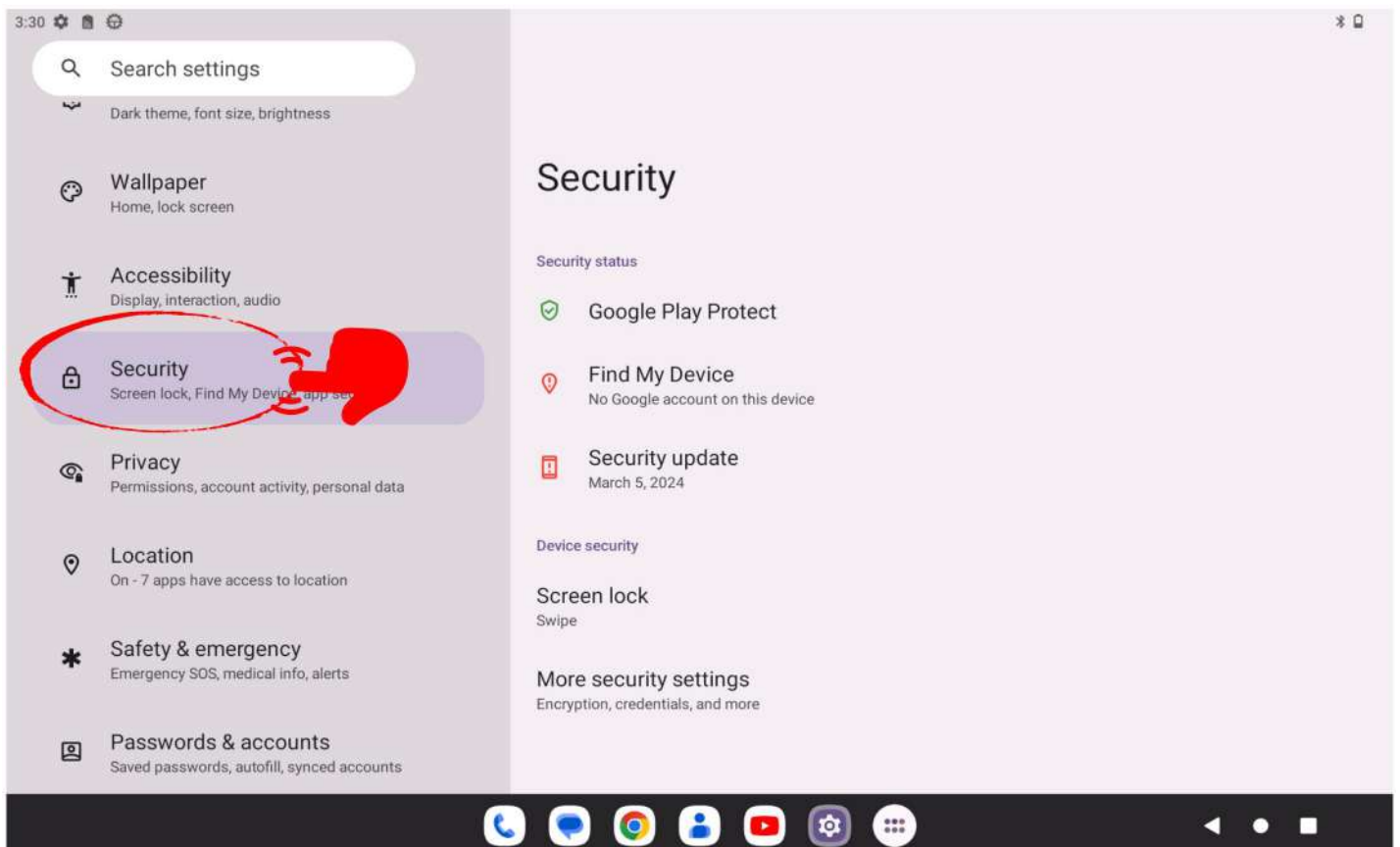

Display the security status and set device security

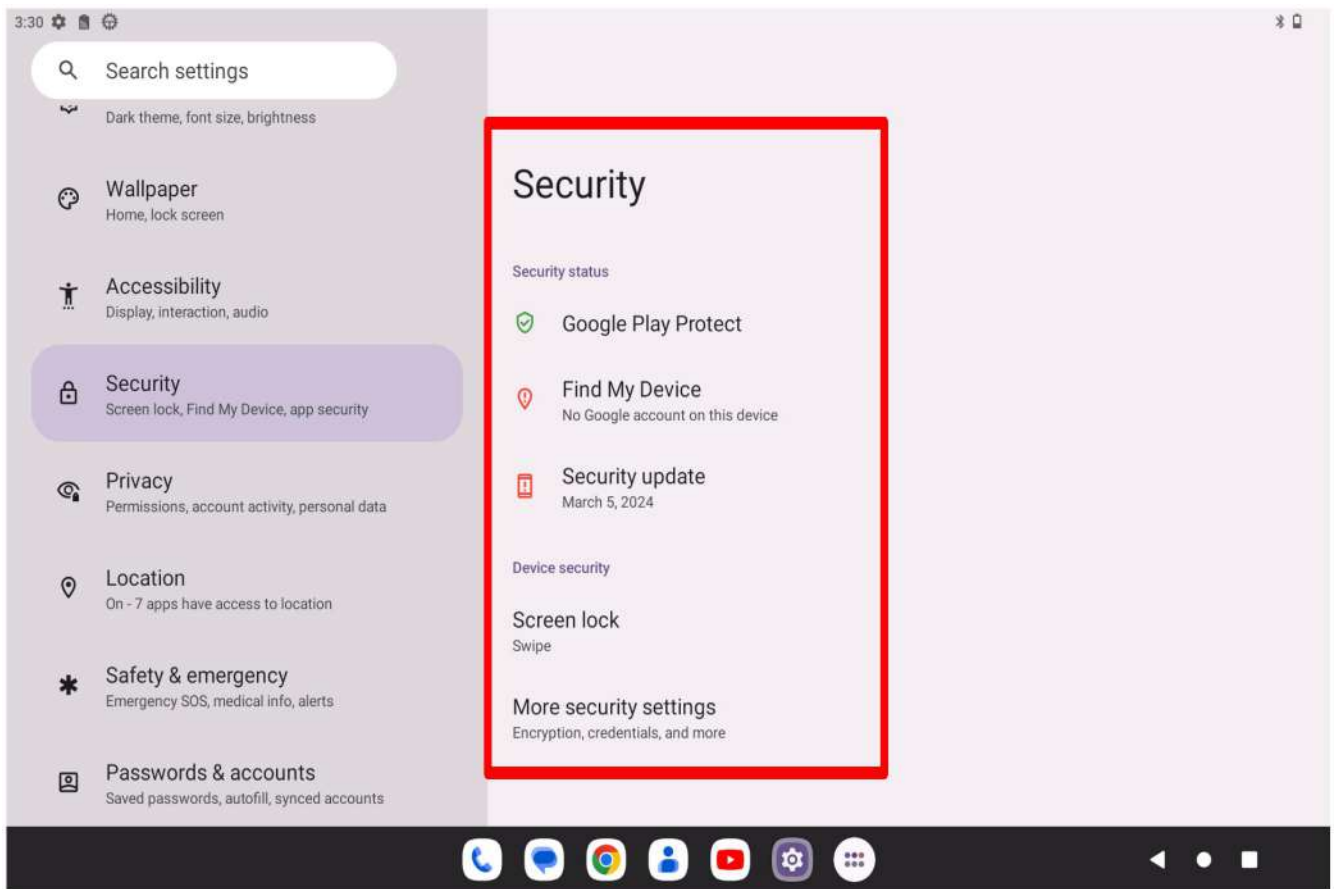

Google

Select "Google" to manage Google services and preference

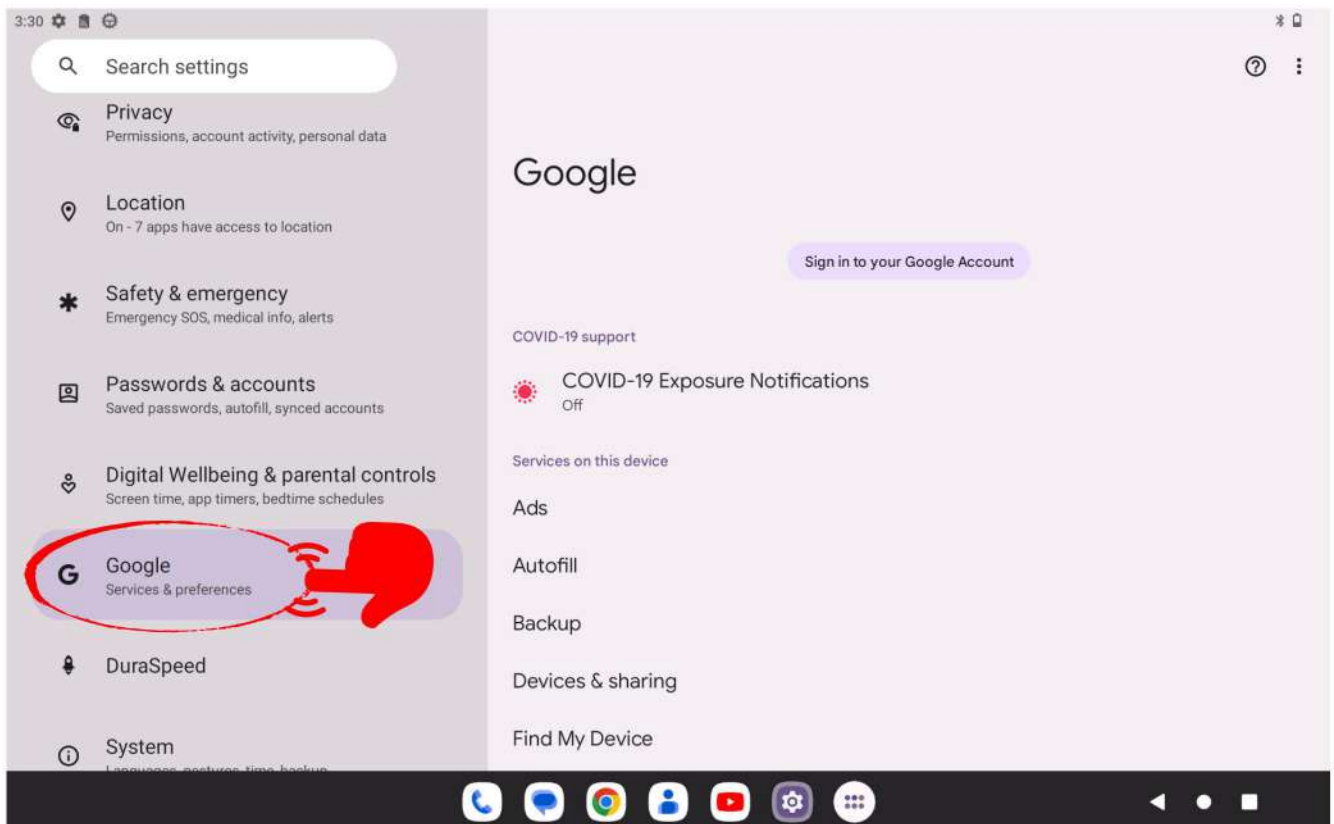

Check Google account information and configure Google service settings

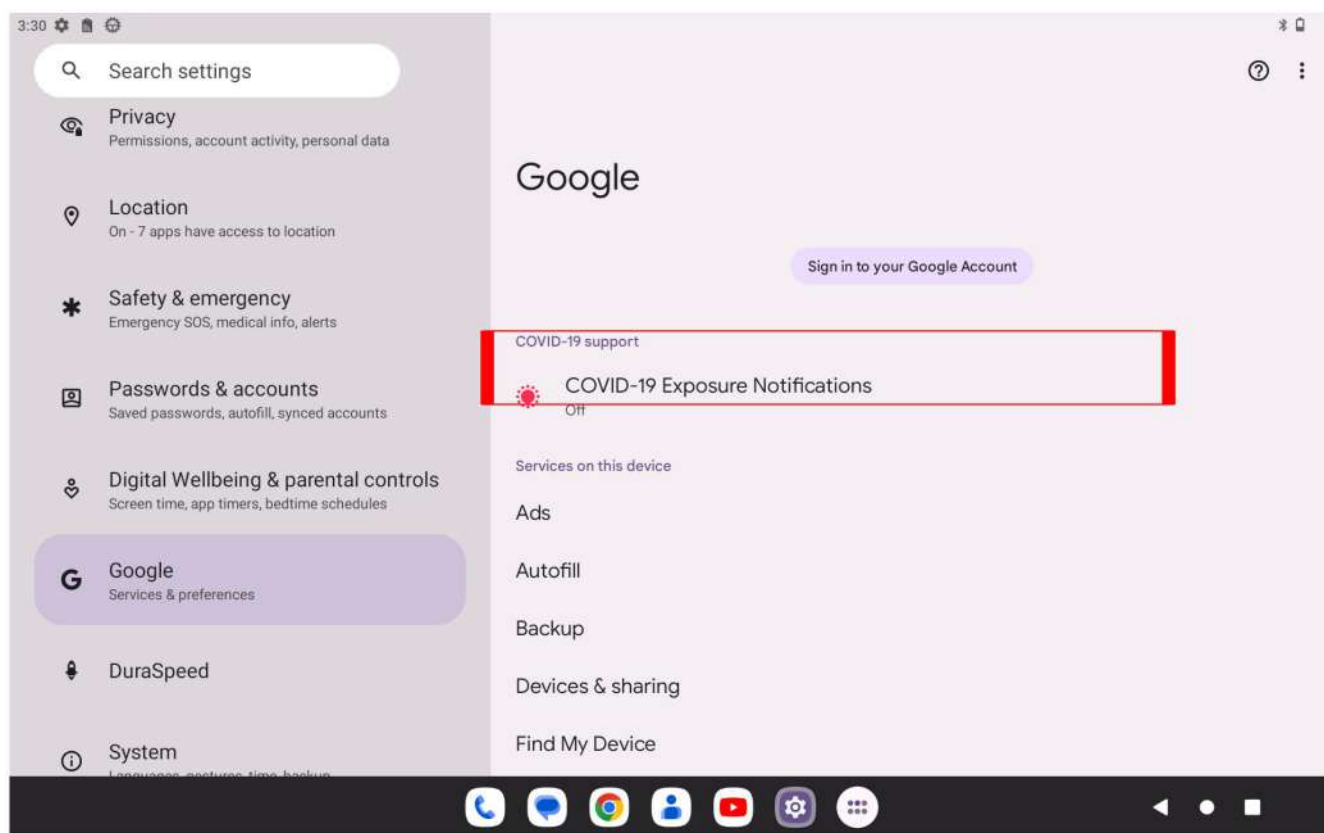

Google Map

Tap “Maps” to activate the Google map app



Make sure GPS function is turned on.

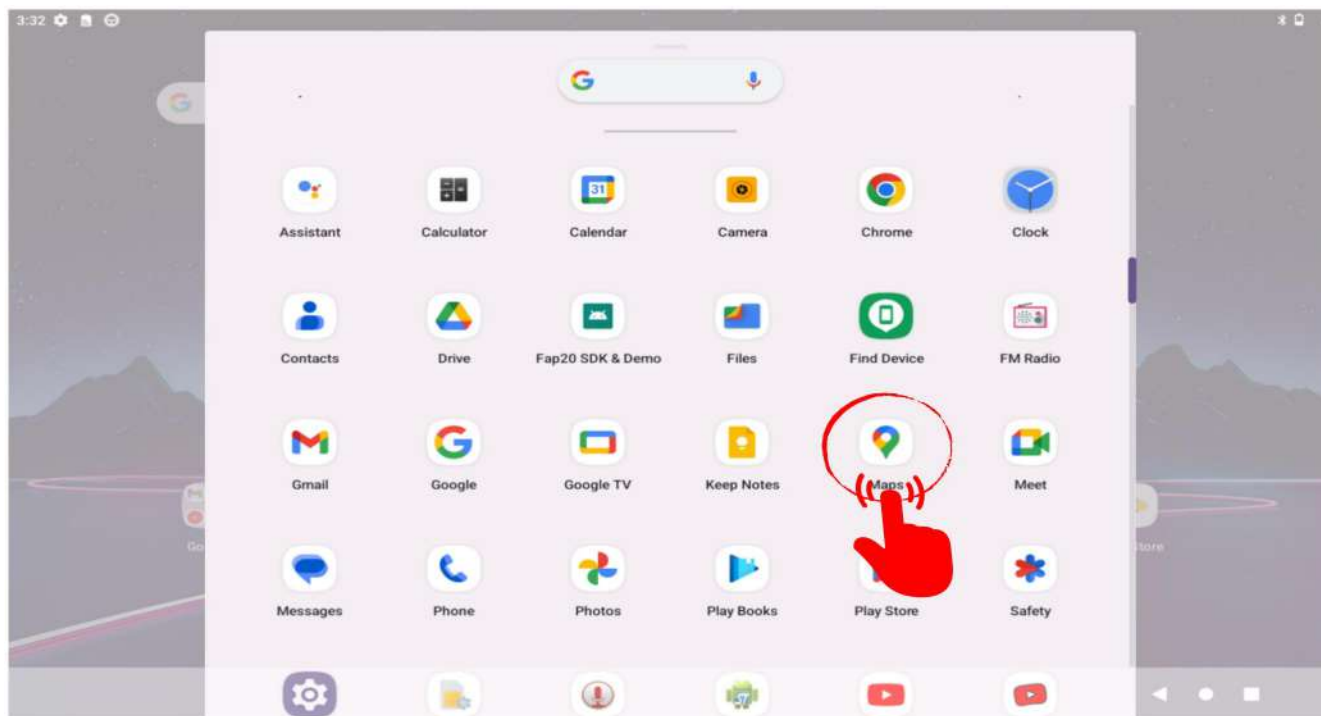

Google Maps helps you locate where you are.

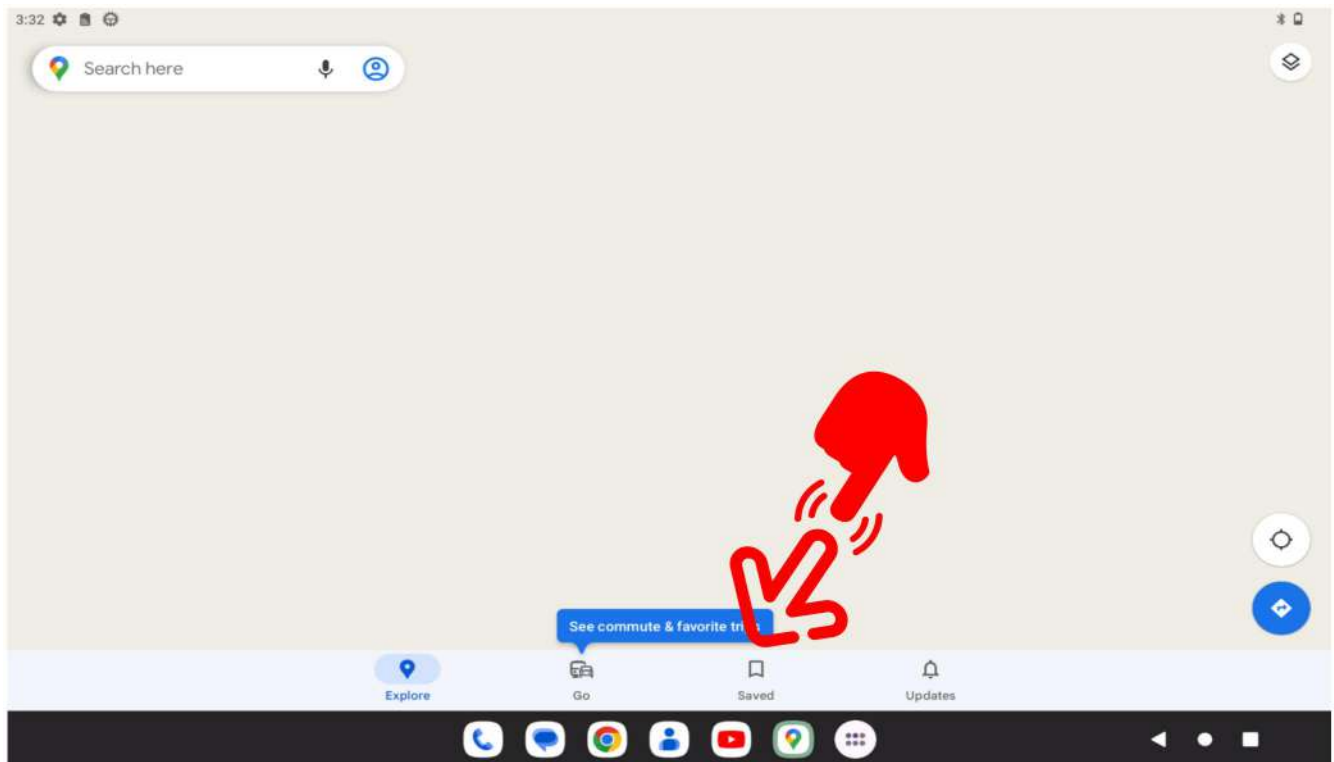

Play store

Tap "Play store" to launch the Play store app

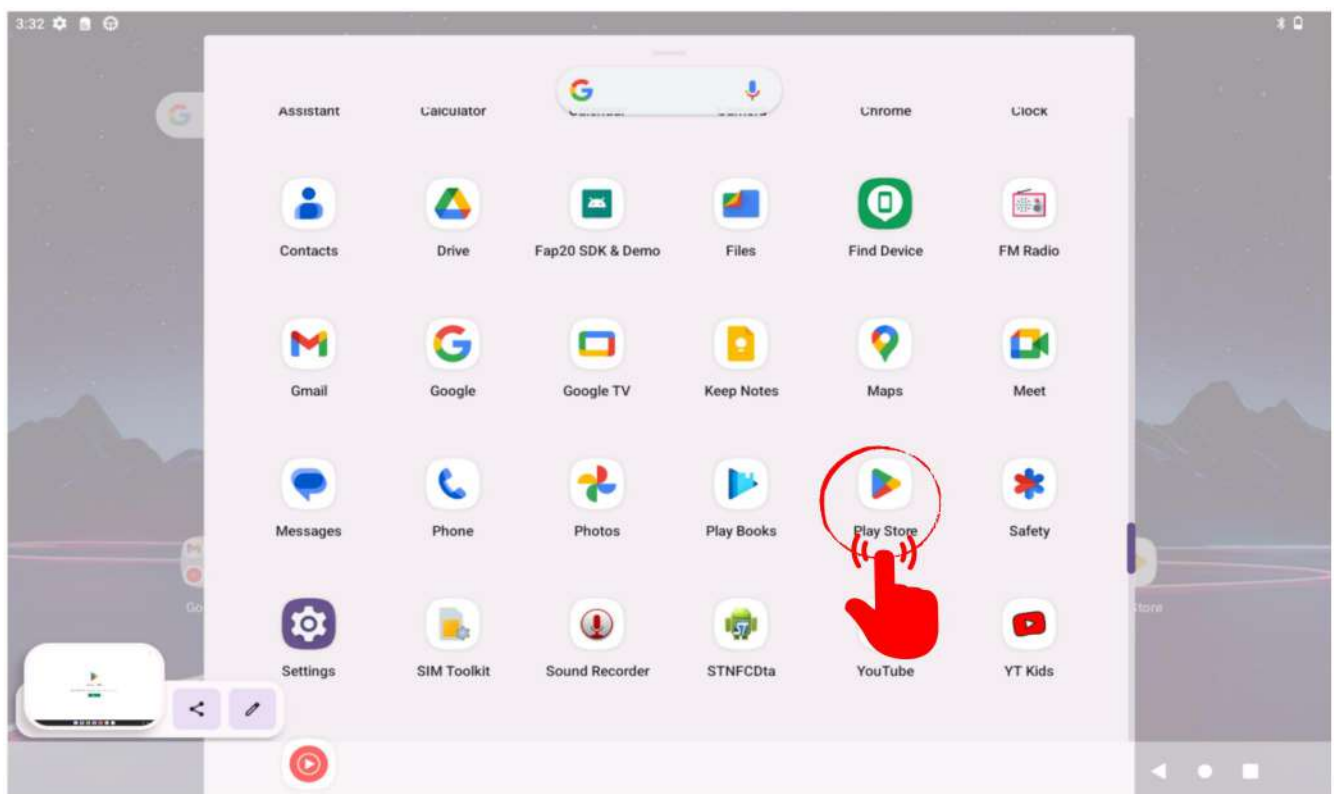

You can access many tools in the play store with your Google account. After setting up your account, you can log into the store at your discretion. After signing in, you are able to download and install applications from the “ Google Play Store ”.

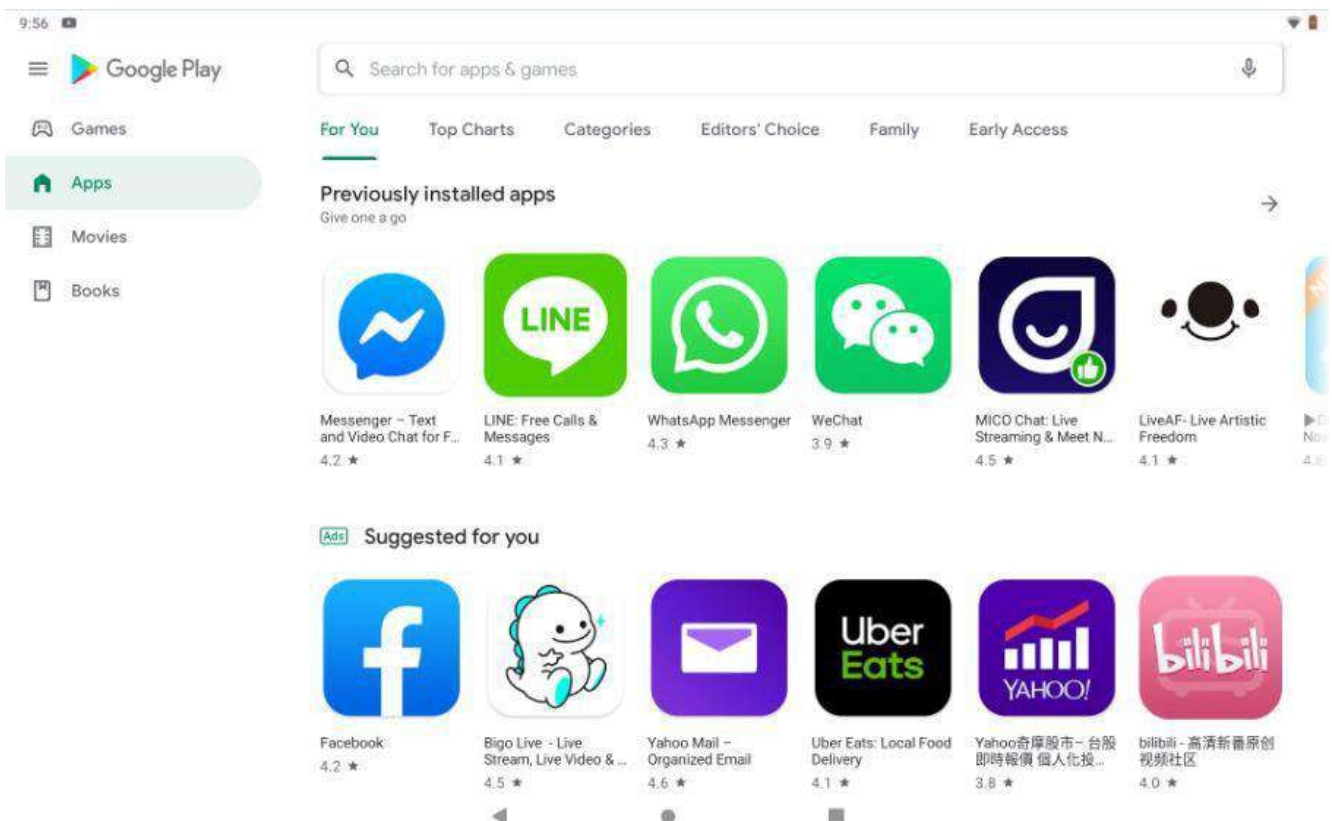

Gmail

Tap "Gmail" to launch the mail app



Set up an email account when opening Email for the first time.

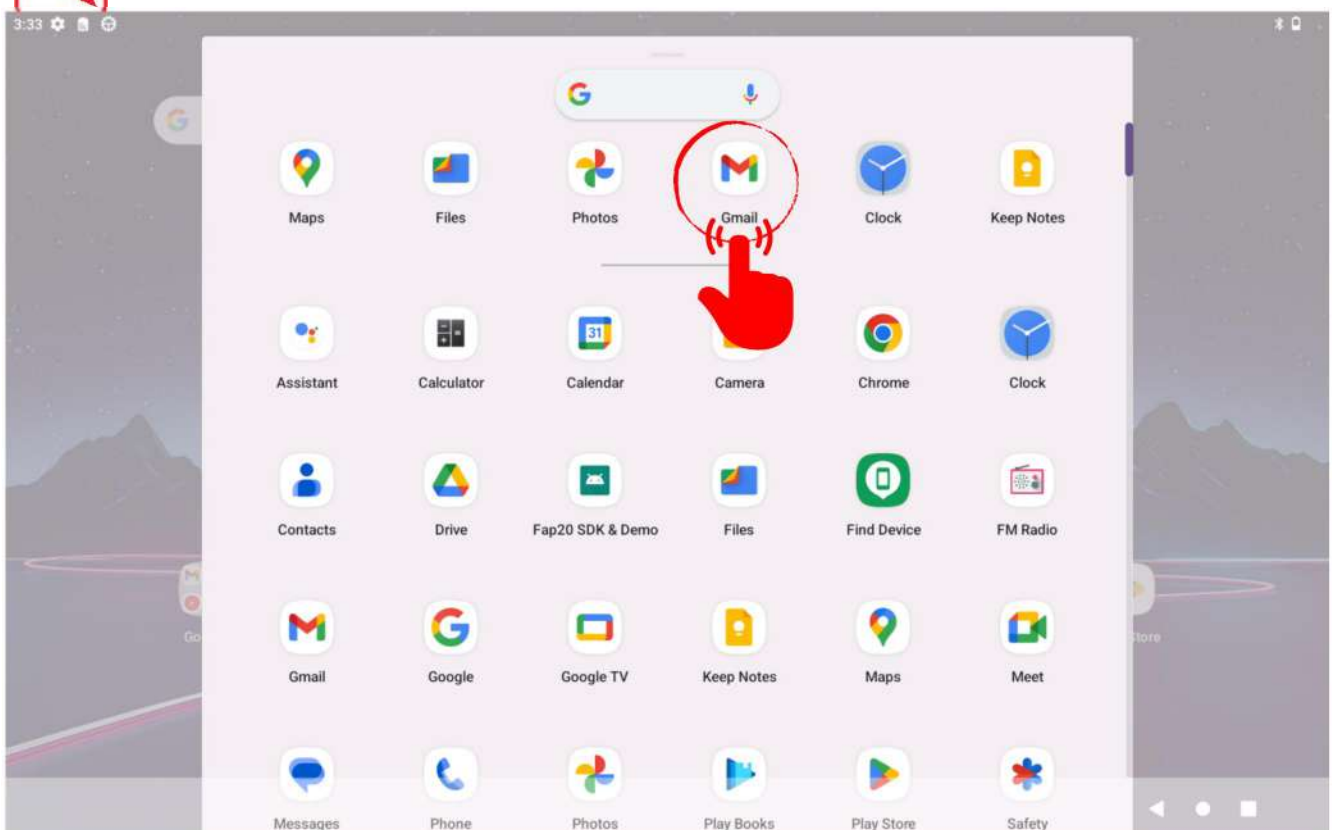

Fap20 SKD & Demo

Tap “Fap20 SKD & Demo” to launch the Fap20 SKD & Demo app

Fap20 SKD & Demo is a new and simple fingerprint collection app, providing an innovative and user-friendly experience for efficient and accurate fingerprint data collection.

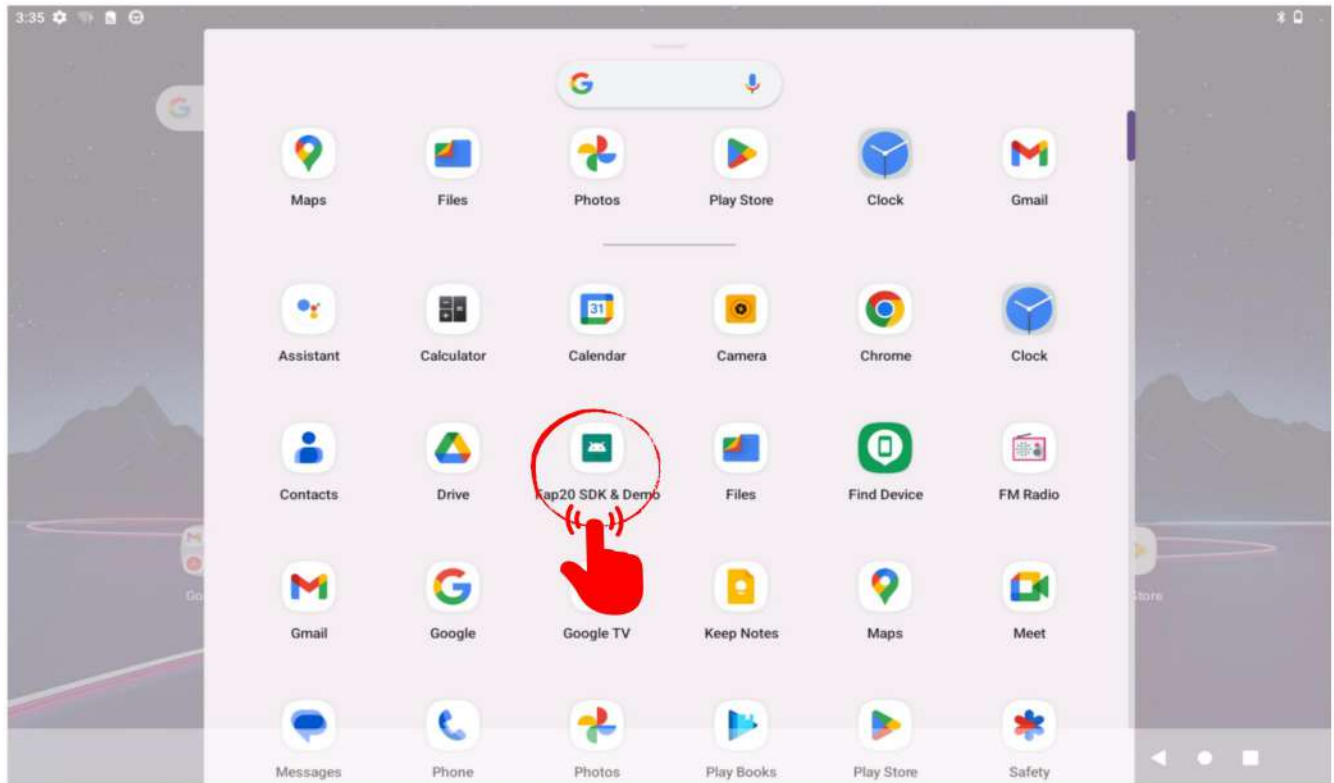

Select "Init", the fingerprint collection window at the lower right corner of the tablet will light up in red. Press your finger on it to complete the fingerprint collection.

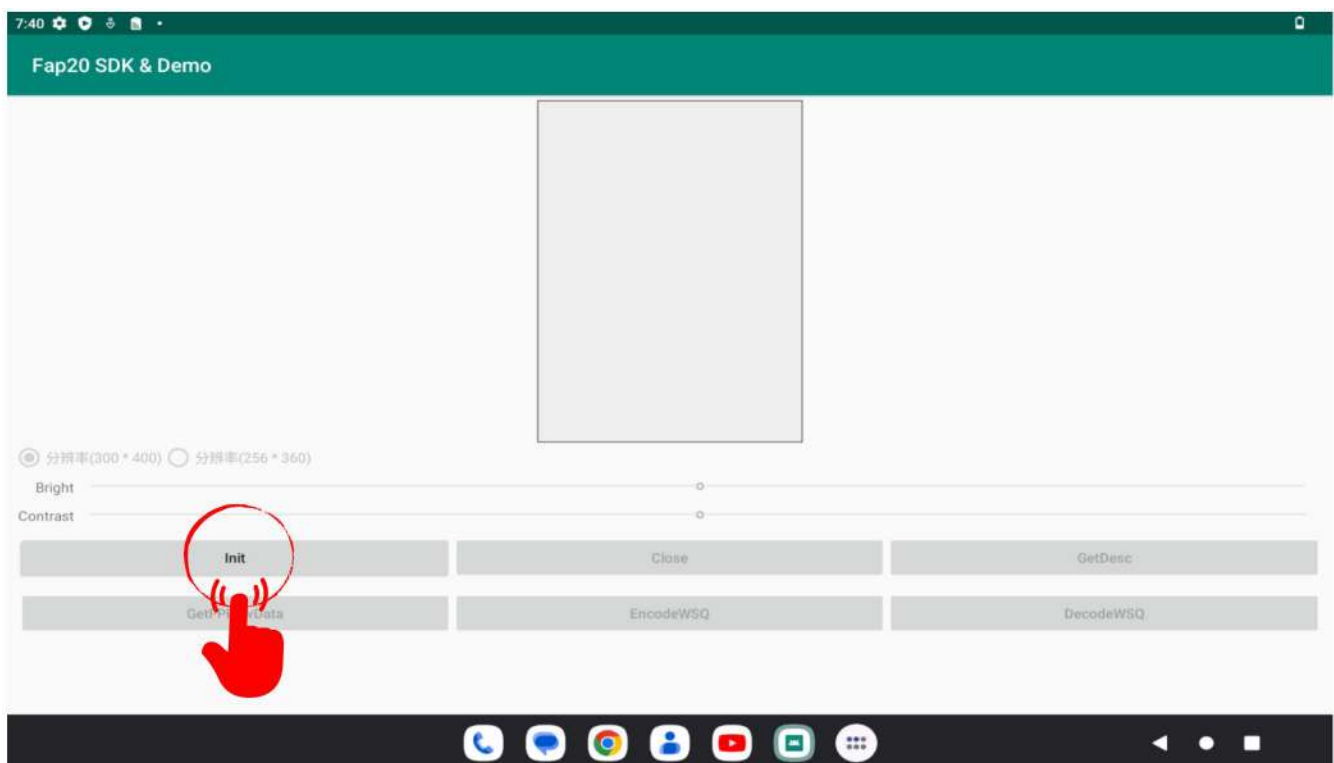

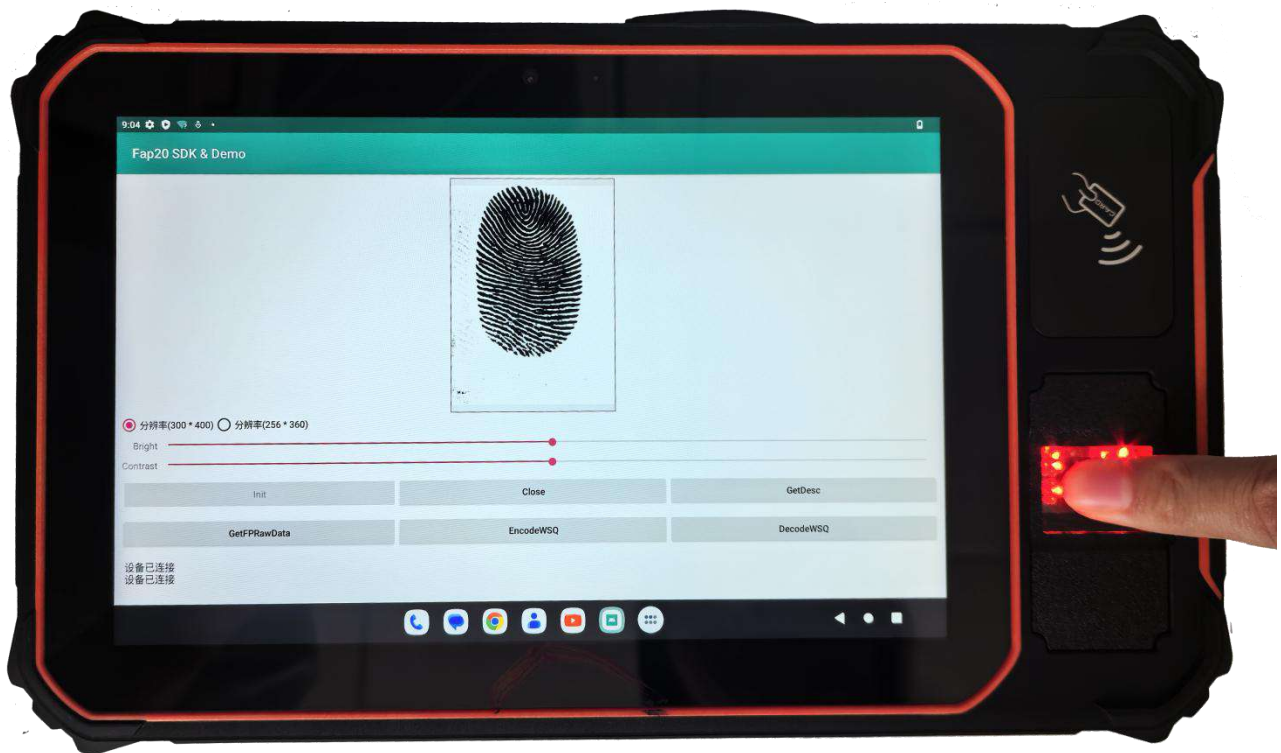

After the fingerprint collection is completed, select "close" to shut down the APP

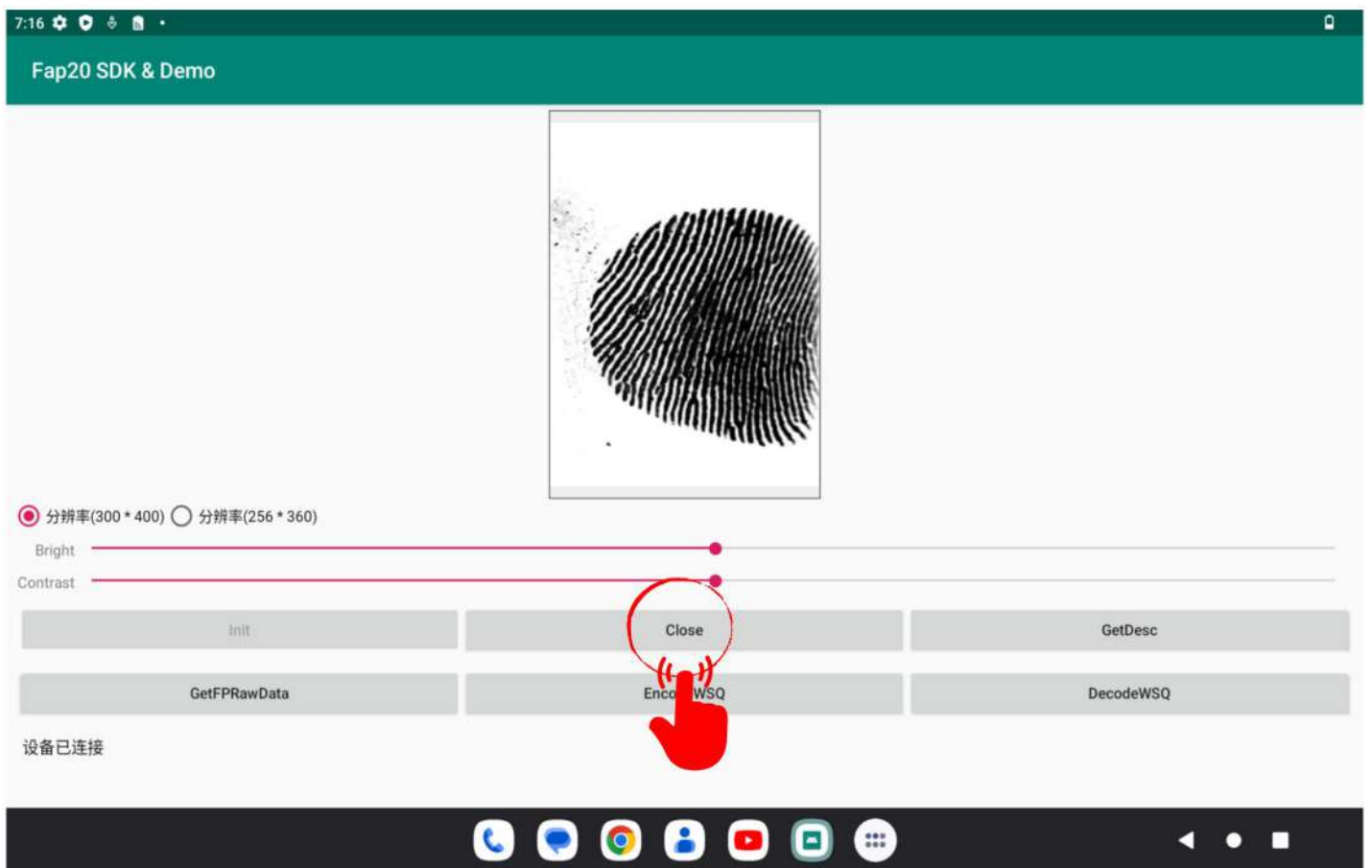

Camera

Tap “Camera” to launch the camera app



Some camera features are not available when you launch the camera app from the locked screen or when the screen is turned off while the screen lock method is set. If photos you take appear blurry, clean the camera lens and try again

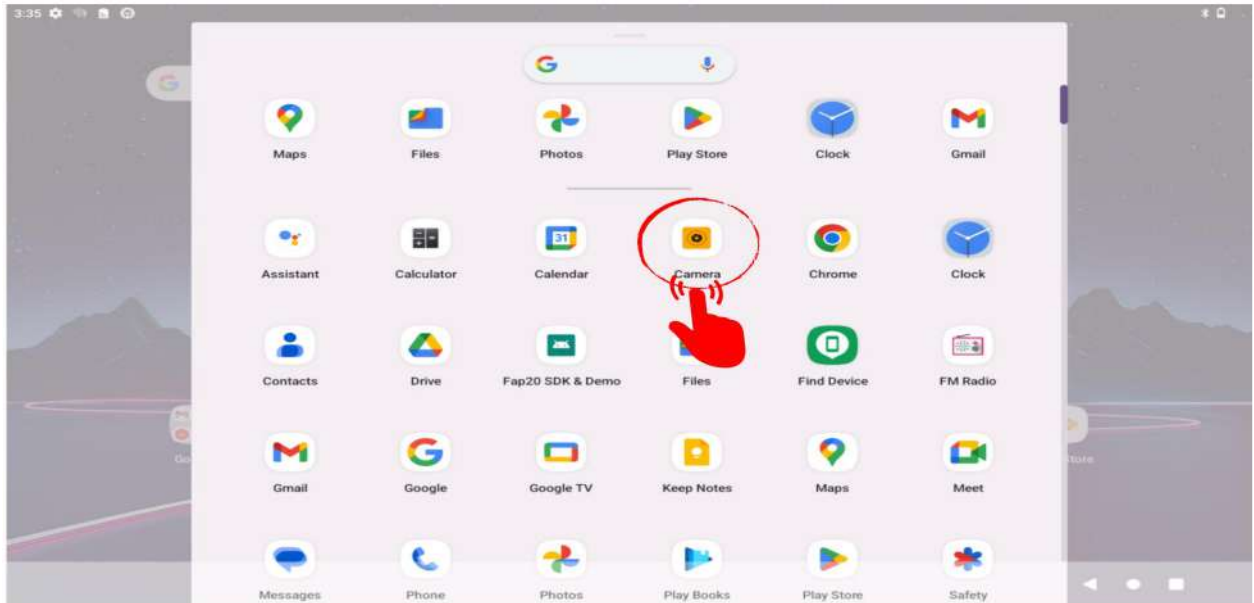

You can use the following functions on camera app

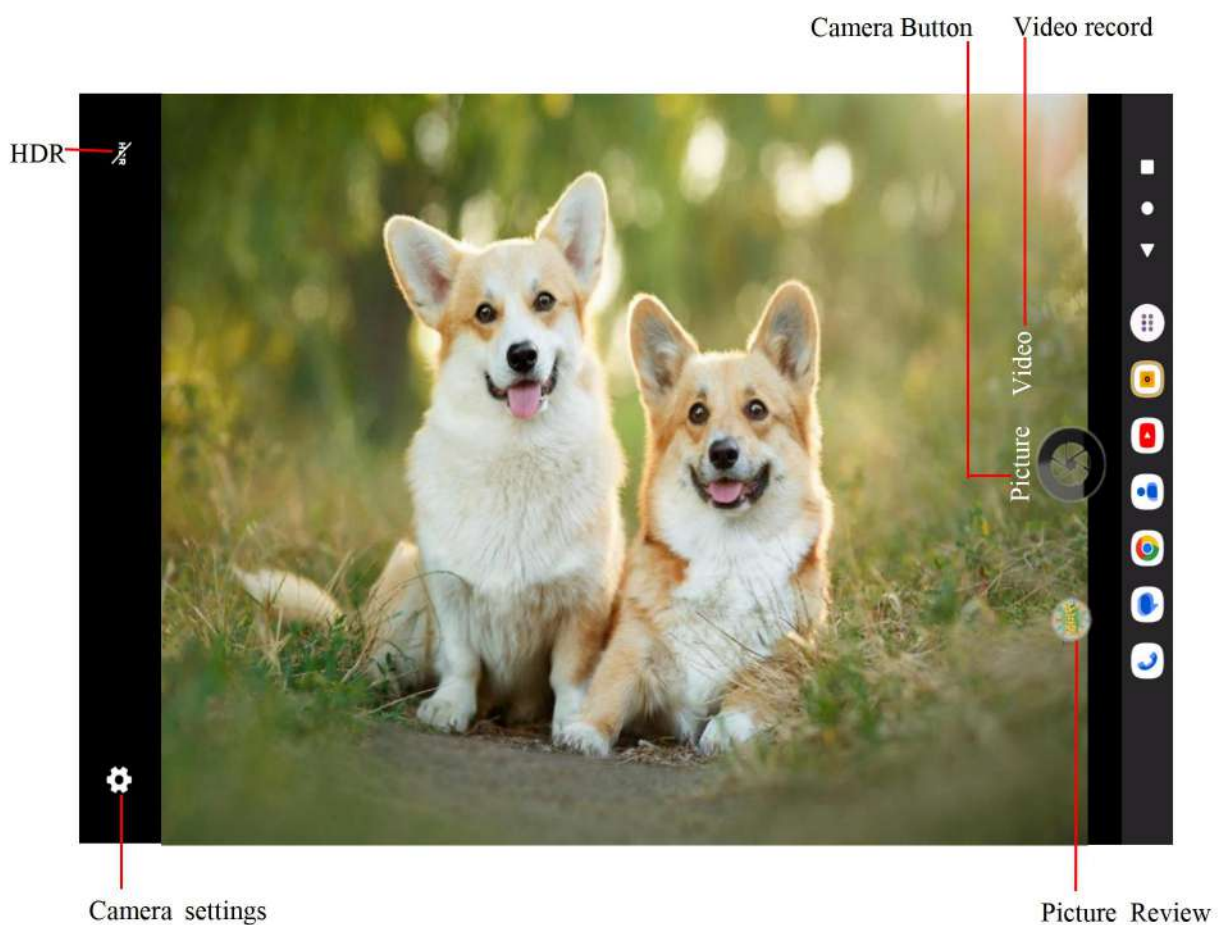

Chapter 6. Troubleshooting

Use the troubleshooting tables in this section to fix problems with the Wi-Fi connection, 802.1x security, or general problems with operating the tablet.

Troubleshoot the Wi-Fi Connection

Use this troubleshooting table to help solve problems with your 802.11 radio connection.

- Q.** When you turn on the tablet after it was suspended for a while (10 to 15 minutes or longer), it can no longer send or receive messages over the network.
- A.** Host may have deactivated or lost current terminal emulation session. In a TCP/IP direct connect network, turn off the “Keep Alive” message from host to maintain the TCP session while the tablet is suspended.
- Q.** The tablet is connected to the network and you move to a new site to collect data. Your tablet now shows you are not connected to the network.
- A.** Move closer to an access point or to a different location to reestablish communications until you reconnect with the network.
- Q.** The tablet appears to be connected to the network, but you cannot establish a terminal emulation session with the host tablet.
- A.** There may be a problem with the host tablet, or with the connection between the access point and the host tablet. Check with the network administrator to make sure the host is running and allowing users to log in to the system.
- Q.** The tablet appears to be connected to the network, but the host tablet is not receiving any information from the tablet.
- A.** There may be a problem with the connection between the access point and the host tablet. Check with the network administrator or use your access point user’s manual.
- Q.** A network connection icon appears in the toolbar, but then disappears.
- A.** The tablet may not be communicating with the intended access point. Make sure the network name matches the access point network name.
The access point may not be communicating with the server. Ensure the access point is turned on, properly configured, and has 802.1x security enabled.

Troubleshoot Operating the Tablet

Use this section to troubleshoot problems that may prevent you from being able to operate the tablet.

Q. You press the Power button and nothing happens.

A. Make sure that power is connected to the tablet.

Q. The tablet appears to be locked up and you cannot enter data.

A. Restart the tablet.

If you experience technical difficulties, please consult your distributor or contact the technical services department, to better assist you have the following information ready:

- Model number
- Serial number
- Operating system and OS versions

Chapter 7. Maintenance

Cleaning the Device



Danger to electric shock when cleaning or maintaining the ET-868.

To avoid electric shock, turn the ET-868 off and disconnect it from the power supply before cleaning or maintaining it.

Housing

- The housing of the ET-868 is best cleaned with a damp cloth.
- Use compressed air, a high-pressure cleaner or vacuum cleaner may damage the surface.
- Use a high-pressure cleaner, the additional risk of water entering the ET-868 may damage the electronics or touch screen.

Touch Screen

- Use neutral detergent or isopropyl alcohol on a clean soft cloth to clean the panel surface.
- Prevent using any kind of chemical solvent, acidic or alkali solution.

Returning the Device

Please put the contents in the original package gently when you need to return the ET-868.

FCC Statement

This equipment has been tested and found to comply with the limits for a Class B digital device, pursuant to part 15 of the FCC Rules. These limits are designed to provide reasonable protection against harmful interference in a residential installation. This equipment generates, uses and can radiate radio frequency energy and, if not installed and used in accordance with the instructions, may cause harmful interference to radio communications. However, there is no guarantee that interference will not occur in a particular installation. If this equipment does cause harmful interference to radio or television reception, which can be determined by turning the equipment off and on, the user is encouraged to try to correct the interference by one or more of the following measures:

- Reorient or relocate the receiving antenna.
- Increase the separation between the equipment and receiver.
- Connect the equipment into an outlet on a circuit different from that to which the receiver is connected.
- Consult the dealer or an experienced radio/TV technician for help.

Caution: Any changes or modifications to this device not explicitly approved by manufacturer could void your authority to operate this equipment.

This device complies with part 15 of the FCC Rules. Operation is subject to the following two conditions: (1) This device may not cause harmful interference, and (2) this device must accept any interference received, including interference that may cause undesired operation.

Specific Absorption Rate (SAR) information:

This Tablet meets the government's requirements for exposure to radio waves. The guidelines are based on standards that were developed by independent scientific organizations through periodic and thorough evaluation of scientific studies. The standards include a substantial safety margin designed to assure the safety of all persons regardless of age or health. FCC RF Exposure Information and Statement the SAR limit of USA (FCC) is 1.6 W/kg averaged over one gram of tissue. Device types: Tablet has also been tested against this SAR limit. This device was tested for typical body-worn operations with the back of the Tablet kept 0mm from the body. To maintain compliance with FCC RF exposure requirements, use accessories that maintain an 0mm separation distance between the user's body and the back of the Tablet. The use of belt clips, holsters and similar accessories should not contain metallic components in its assembly. The use of accessories that do not satisfy these requirements may not comply with FCC RF exposure requirements, and should be avoided.

ISED Statement

English: This device contains licence-exempt transmitter(s)/receiver(s) that comply with Innovation, Science and Economic Development Canada's licence-exempt RSS(s). Operation is subject to the following two conditions:

(1) This device may not cause interference.

(2) This device must accept any interference, including interference that may cause undesired operation of the device.

The digital apparatus complies with Canadian CAN ICES-3 (B)/NMB-3(B).

French: Cet appareil contient des émetteurs/récepteurs exempts de licence qui sont conformes aux RSS exemptés de licence d'Innovation, Sciences et Développement économique Canada.

L'exploitation est soumise aux deux conditions suivantes :

(1) Cet appareil ne doit pas provoquer d'interférences.

(2) Cet appareil doit accepter toute interférence, y compris les interférences susceptibles de provoquer un fonctionnement indésirable de l'appareil.

L'appareil numérique du ciem conforme canadien peut - 3 (b) / nmb - 3 (b).

This device meets the exemption from the routine evaluation limits in section 6.3 of RSS 102 and compliance with RSS 102 RF exposure, users can obtain Canadian information on RF exposure and compliance.

cet appareil est conforme à l'exemption des limites d'évaluation courante dans la section 6.3 du cnr - 102 et conformité avec rss 102 de l'exposition aux rf, les utilisateurs peuvent obtenir des données canadiennes sur l'exposition aux champs rf et la conformité.

This equipment complies with Canada radiation exposure limits set forth for an uncontrolled environment.

Cet équipement est conforme aux limites d'exposition aux rayonnements du Canada établies pour un environnement non contrôlé.

Specific Absorption Rate (SAR) information:

This Tablet meets the government's requirements for exposure to radio waves. The guidelines are based on standards that were developed by independent scientific organizations through periodic and thorough evaluation of scientific studies. The standards include a substantial safety margin designed to assure the safety of all persons regardless of age or health. ISED RF Exposure Information and Statement the SAR limit of Canada(ISED) is 1.6 W/kg averaged over one gram of tissue. Device types: Tablet has also been tested against this SAR limit. This device was tested for typical body-worn operations with the back of the Tablet kept 0mm from the body. To maintain compliance with ISED RF exposure requirements, use accessories that maintain an 0mm separation distance between the user's body and the back of the Tablet . The use of belt clips, holsters and similar accessories should not contain metallic components in its assembly. The use of accessories that do not satisfy these requirements may not comply with ISED RF exposure requirements, and should be avoided.

Informations sur le débit d'absorption spécifique (DAS):

Cette tablette répond aux exigences du gouvernement en matière d'exposition aux ondes radio. Les lignes directrices sont basées sur des normes élaborées par des organisations scientifiques indépendantes à travers une évaluation périodique et approfondie des études scientifiques. Les normes comprennent une marge de sécurité substantielle conçue pour assurer la sécurité de toutes les personnes, quel que soit leur âge ou leur état de santé. Information et déclaration d'ISDE sur l'exposition aux RF la limite DAS du Canada (ISDE) est de 1,6 W / kg en moyenne sur un gramme de tissu. Types d'appareils: la tablette a également été testée par rapport à cette limite SAR. Cet appareil a été testé pour des opérations typiques portées sur le corps avec le dos de la tablette gardé à 0 mm du corps. Pour maintenir la conformité avec les exigences d'exposition RF d'ISDE, utilisez des accessoires qui maintiennent une distance de séparation de 0 mm entre le corps de l'utilisateur et l'arrière de la tablette. L'utilisation de clips de ceinture, d'étuis et d'accessoires similaires ne doit pas contenir de composants métalliques dans son assemblage. L'utilisation d'accessoires qui ne satisfont pas à ces exigences peut ne pas être conforme aux exigences d'exposition aux RF d'ISDE et doit être évitée.