

Box Contents

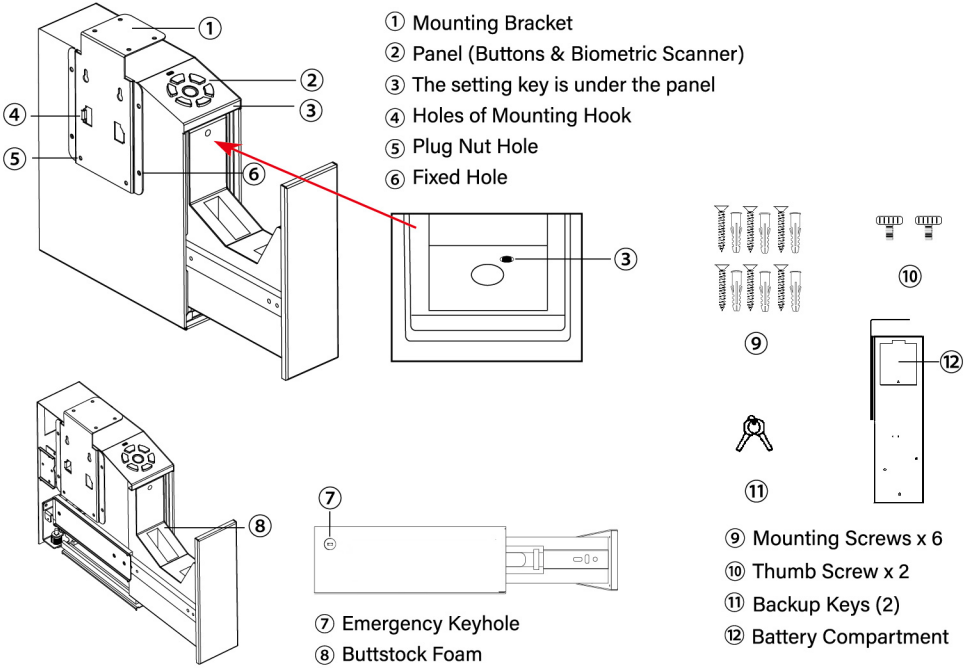

Adjusting the Foam

There are two slots cut on the foam inside the Gun Safe. Before installing the gun safe, adjust the slots on the foam to fit the size of your gun.

1. Take out the little foams of the slots.
2. Cut little foams to adjust your gun size.
3. Put the cut foams back into the slots to hold your gun firmly.

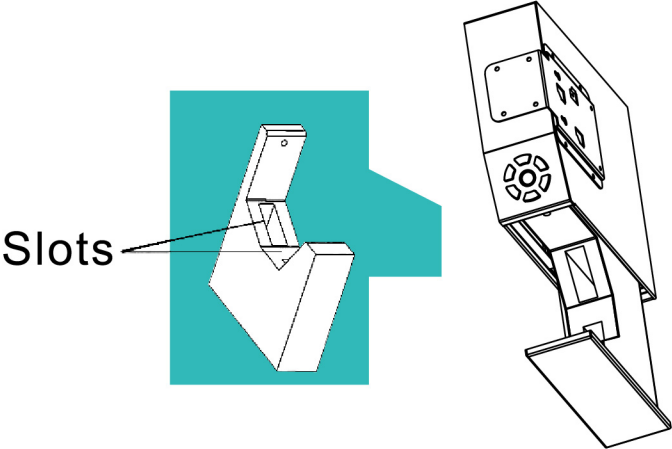

Battery Installation

1. To get started, insert one of your backup keys into the keyhole at the front of the Gun Safe. Push key in and turn it counter clockwise to open the Gun Safe.
2. Find the battery compartment outside the safe and remove the battery cover.
3. Insert 4XAA Alkaline batteries (not Included) into the battery compartment.



Pay attention to the "+" and "-" signs. The "-" end of the batteries go against the spring inside of the compartment

- 4.Repeal above steps for battery replacement.

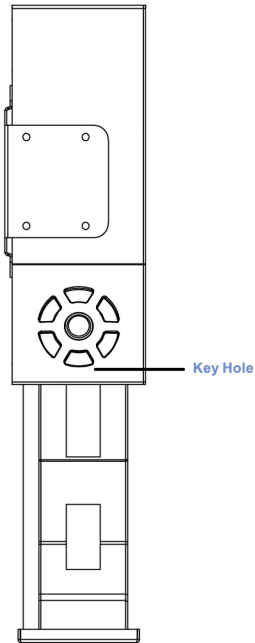

Battery Warnings

- Always insert batteries correctly with regard to polarity (+ and -) as marked on the battery and the product.
- Exhausted batteries should be immediately removed from product and properly disposed.

Low Battery Warning

If the indicator light will light up red 6 times with 6 times beeps when opening the Gun Safe by electronic way.your battery level is critically low and your Gun Safe needs to be replaced the 4 new batteries.

Specifications

Item	Description
Model Name	Gun Safe
Net Weight	12.1lb/5.3Kgs
Dimensions	11.8X10X3.5in (300X256X90mm)
Battery Voltage	DC 6V (4x AA batteries needed)
Password Length	4 digits
Disguised Password Length	6 digits
Standby Current	10ua
Working Current	150ma
Working Temperature	-4°F-158°F(-20℃-70℃)
Warranty	1 Year Limited

一、Important tips

1.Key Description: press the key once, the buzzer "beeps" once, and the green light flashes once at the same time.

2. Factory setting: Password: 1234; Empty fingerprint, open the door with any fingerprint; Sound: on.

3.Password digits: password digits: 3-6 digits (46656 combinations at most);Number of fingerprints: 160

4.If the password is set and the fingerprint is not entered, the empty fingerprint cannot open the door; On the contrary, if the fingerprint is entered and no password is set, the original factory password "1234" cannot open the door (of course,if the password set by the user is 1234, the door can be opened normally)

二、Set password

1. In standby mode, press and hold the setting key for more than 1s until the buzzer "beeps" twice, the green light flashes twice, and the fingerprint window light is on at the same time,At this time, enter the password setting and fingerprint entry mode.

2.Set password:

Directly enter the 3-6-digit new password. There is an interval of 10 seconds after each password is entered. If it exceeds 10 seconds, please restart from the first step; After entering the password, you have 10 seconds to press the setting key to record the new password, otherwise you need to restart from the first step; Press the setting key.If you hear two beeps and the green light flashes twice, it indicates that the password is set successfully; When you hear three beeps of "didi", and the red light flashes three times, it indicates that the password setting fails. Please restart from the first step; If it exceeds 10 seconds, the buzzer "beeps" 3 times, and the red light flashes 3 times,indicating that the setting fails.

3. Input fingerprint:

Put your finger directly on the fingerprint window for 3 times; After each input,the buzzer "beeps" once, and the green light flashes once, remove the finger, and then put the finger on the fingerprint window for 3 consecutive entries; If the finger printis entered successfully, the buzzer "beeps" twice, the green light flashes twice, and the green light of the fingerprint window lights up at the same time; If the input fails, the buzzer "beeps" 3 times, the red light flashes 3 times, and the red light of the fingerprint window lights up at the same time; If the finger is not pressed for more than 10 seconds, the buzzer "beeps" for 3 times, and the red light flashes for 3 times,indicating that the entry fails. (the same finger cannot be registered repeatedly)

三、Open the door with a password

Enter the previously set password. Each time you press the key,you will hear a "tick"sound and a green light flash.

2.After entering the password, the system will automatically verify the accuracy of the password (the verification will start within 1s after you let go). If you hear two beeps, the green light will flash at the same time

If it is always on after 2 times, it indicates that the password is correct and the box is opened; If you hear three beeps of "didi" and the red light flashes three times, it indicates that the password is wrong. Please re-enter Try.

四、Open the door with fingerprints

1. Put your finger on the fingerprint scanner. If the fingerprint is correct, the buzzer will "tick" twice. At the same time, the green light will flash twice and stay on. The box will be opened
2. If the fingerprint is wrong, the buzzer "beeps" 3 times and the red light flashes 3 times.

五、Restore factory settings

Press and hold the setting button for more than 5S (the green light starts to flash after 1s) until the buzzer "beeps" for a long time, indicating that the initialization is successful: the fingerprint is cleared; Password: 1234; Sound: on; If the buzzer beeps 3 times, initialization fails

六、Error alarm

If the password is input incorrectly for 3 consecutive times or the fingerprint is input incorrectly for 5 consecutive times, the panel is locked for 1 minute, the buzzer alarms for 30s (the buzzer calls once every 1s and the red light flashes once), and all keys /fingerprints are invalid during the alarm; After the alarm, press any key or fingerprint, the buzzer will sound 3 times, and the red light will flash 3 times; At the end of locking time, the buzzer "beeps" and the green light flashes once; If the input is wrong again, the panel will be locked for 5 minutes and the buzzer will alarm for 30; Note: the buzzer alarm for 30s is not affected by mute, but will still sound.

七、Mute function

In standby mode, long press 4 keys for more than 2S until the buzzer "beeps" (if the sound is on), and the green light flashes once to turn on / off the sound.

八、Low voltage alarm

If the battery is lower than $4.8 \pm 0.3V$, the indicator light will be red and green when opening the door.

1.
 - 1) Direct search format: Enter the app store in the ISO system, or download "smart life" from the Google App Store.
 - 2) Scan the QR code with the built-in app.



2. When the panel wakes up, press the "1", "1", and "Settings" buttons. The blue light will flash, and the "+" button in the upper right corner will open to add devices. The device that can be added will automatically pop up.

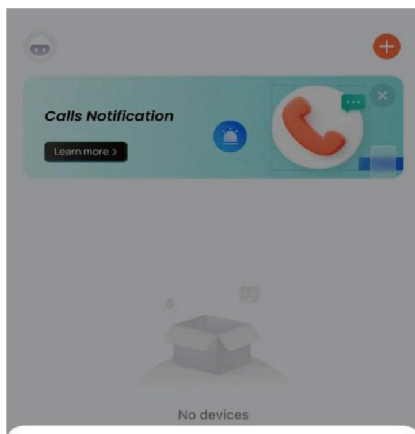
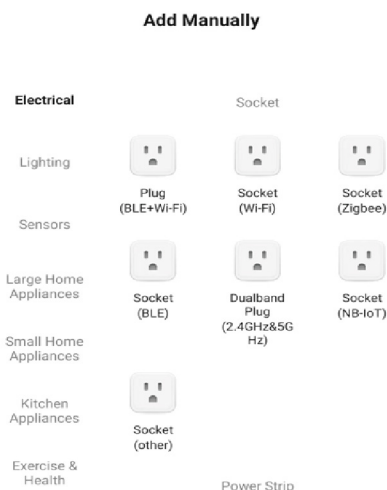
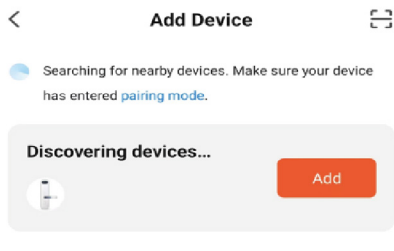

Devices to be added: 1



2. After pairing, the lock can be unlocked with one click, which means using the app to perform unlocking.

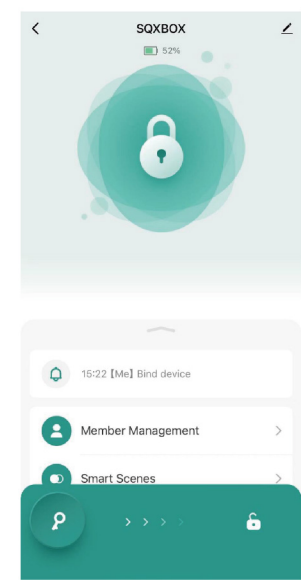

3. You can add fingerprints and change passwords through the app. (Friendly reminder: After entering the app member settings, you need to click on the red font on the app in a timely manner to associate the password with the corresponding member. Secondly, you can only modify the existing password, click on the existing password to modify it, and cannot add it.)

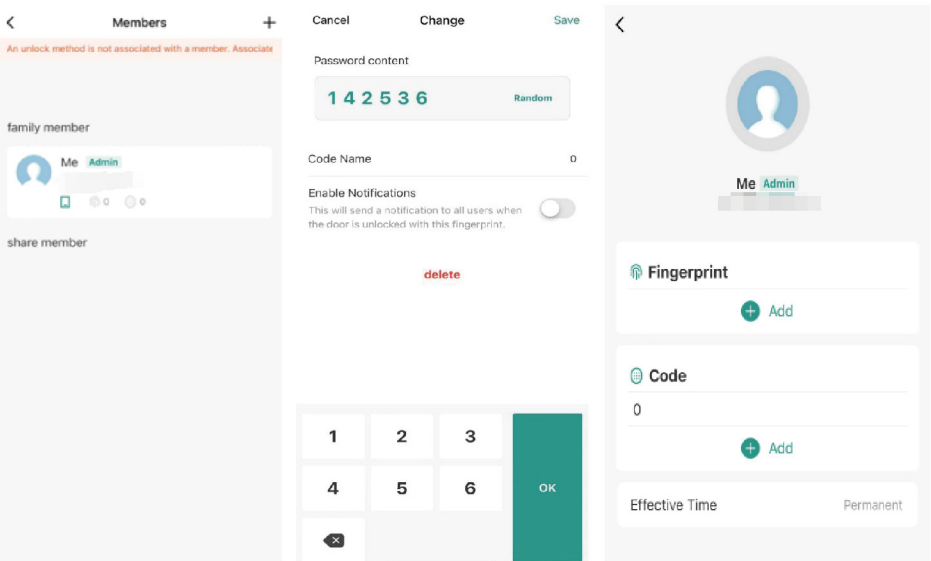

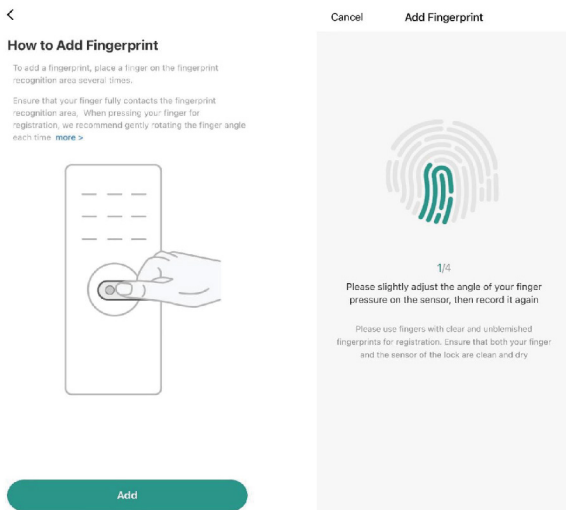

4. Using the app, you can perform mute on/off.

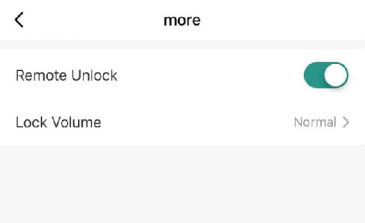

5. You can view information such as door opening records, battery level, and error alarms.

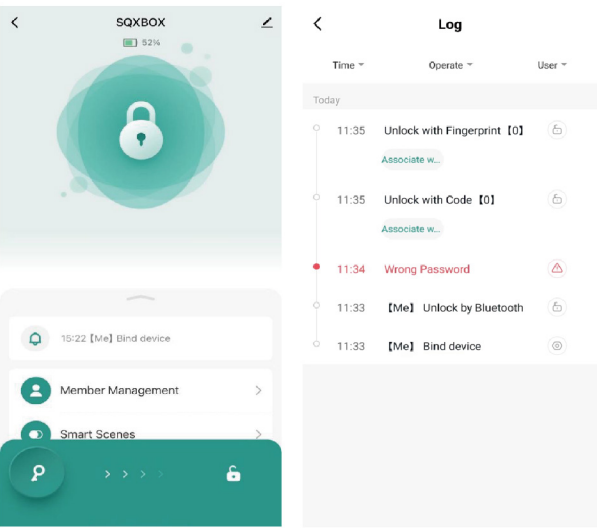

6.When you need to re pair your account, execute the app to remove the device.

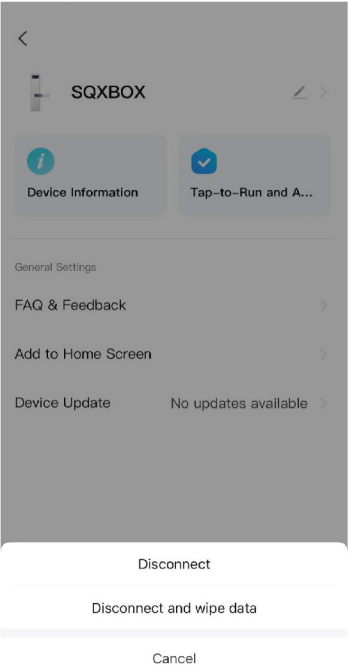

九、 Mounting step

- 1.Take out screwX4,and fix the bracket onto the side of deck/desired place. See photo 1
- 2.After installed the bracket, use the Thumb screw X1 to fix the gun safe box, see photo 2
- 3.After fixed the box,install the drawer back directly

Note:Before installing the drawer back, the spring must be covered, see photo 3

photo 1

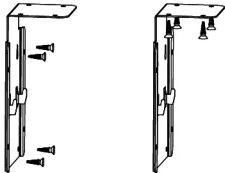

photo 2

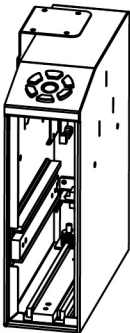
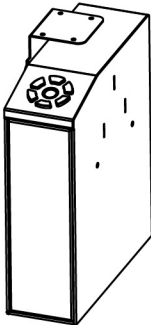

photo 3



十、Warning

This device complies with part 15 of the FCC Rules. Operation is subject to the following two conditions:

(1) This device may not cause harmful interference, and (2) this device must accept any interference received, including interference that may cause undesired operation.

NOTE: This equipment has been tested and found to comply with the limits for a Class B digital device, pursuant to part 15 of the FCC Rules. These limits are designed to provide reasonable protection against harmful interference in a residential installation. This equipment generates, uses and can radiate radio frequency energy and, if not installed and used in accordance with the instructions, may cause harmful interference to radio communications. However, there is no guarantee that interference will not occur in a particular installation. If this equipment does cause harmful interference to radio or television reception, which can be determined by turning the equipment off and on, the user is encouraged to try to correct the interference by one or more of the following measures:

- Reorient or relocate the receiving antenna.
- Increase the separation between the equipment and receiver.
- Connect the equipment into an outlet on a circuit different from that to which the receiver is connected.
- Consult the dealer or an experienced radio/TV technician for help.

Warning: Changes or modifications not expressly approved by the party responsible for compliance could void the user's authority to operate the equipment.

RF Exposure Statement

The distance between user and products should be no less than 20cm.