

## VlogScreen产品介绍

磁吸自拍屏

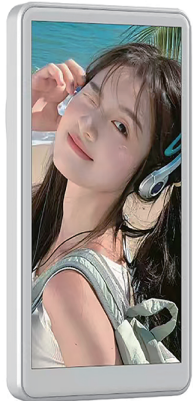

### 强力磁吸

强磁 Magasafe 外硅胶贴合设计，吸附更稳，不伤手机，手感温暖舒适。精准吸附，让后置镜头自拍更方便。



## 功能介绍



**电源开关:**  
拨动开关可打开或关闭机器

**充电指示灯:**  
充电时红灯长亮, 充满后红灯灭

**屏幕旋转按钮:**  
可将屏幕180°旋转, 长按3秒镜像显示

**显示比例按钮:**  
可切换全屏模式与切换1:1模式

**注意: 尽量在关机状态下充电**

### 遥控器示意图



### 连接步骤

开机，搜索AB Shutter3，链接AB Shutter3  
完成手机与遥控器配对，可作遥控器拍摄/录像

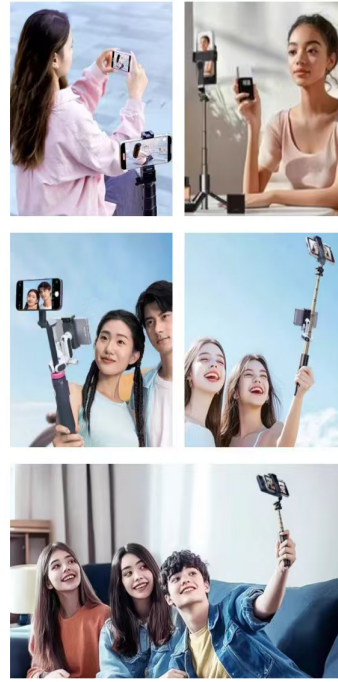

## 使用场景



### 手机连接步骤

步骤一：  
从手机屏幕右上角向下滑动，打开快捷菜单栏

**步骤二：**

找到手机的投屏功能（苹果手机为“屏幕镜像”，  
安卓手机为“无线投屏”）点击打开；  
或者在设置>更多连接>投屏功能。

步骤三：

在搜索设备列表中找到“iScreen\_p2p”，点击链接设备  
(首次连接需输入验证码“1234”)



## 产品参数

型号 T1	电源输入 5V-1A
额定功率 1.85W	电池容量 1800mA聚合物
电源输入端口 TYPE-C	无线网络 WiFi 2.4G/5G 双模
屏幕尺寸 4.02英寸	屏幕分辨率 1136x640像素
屏幕视角方向 IPS 全视角	材质 ABS+硅胶+磁铁
产品尺寸 149.5*59.5*10.5mm	产品净重 100g
适用范围 IOS系统9.0以上、Android2.0以上、HarmonyOS系统3.0以上、MagicOS系统4.0以上等手机	

## VlogScreen

### Product Description

**Magnetic Selfie Screen**

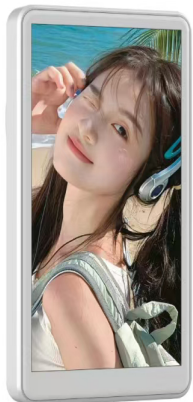

### Strong Magnetic Suction

The strong magnetic Magasafe has a silicone-fitted design on the outside. It adheres more stably and won't harm the phone. The feel is warm and comfortable. The precise adsorption makes it more convenient to take selfies with the rear camera.



## Function Introduction



**Power switch:**  
Turn the switch to turn on or off the machine

**Charging Indicator Light:**  
Red light stays on when charging, red light goes off when full

**Screen rotation button:**  
The screen can be rotated 180°, long press for 3 seconds to mirror the display

**Display scale button:**  
Switchable full screen mode and switchable 1:1 mode

**Note:** Try to charge it in the off state

### Remote Control Diagram

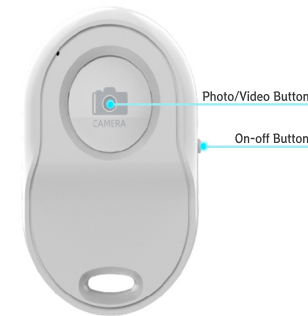

**Connection Step:**

Turn on the power, search for AB Shutter3, connect AB Shutter3, complete the pairing of the mobile phone with the remote control, and can be used as a remote control to shoot/record.



### Usage Scenario



### Mobile Phone Connection Steps

**Step 1:**

Swipe down from the top right corner of your phone screen to open the shortcut menu bar.

**Step 2:**  
Find your phone's screen casting function( 'Screen Mirroring'  for Apple phones and 'Wireless Screen Casting'  for Android phones) and click to open it. Or go to Settings>More Connections>Screen Throw.

**Step 3:**  
Find 'iScreen\_p2p' in the list of searching devices,  
click to connect the device.

(The first time you connect, you need to enter the verification code '1234' )



## Product Parameter

Model T1	Power Input 5V-1A
Rated Power 1.85W	Battery Capacity 1800mA Polymer
Power Input Port TYPE-C	Wireless Network WIFI 2.4G/5G dual mode
Screen Size 4.02 inch	Screen Resolution 1136x640 pixels
Screen View Direction IPS Full View	Material ABS+Silicone+Magnet
Product Size 149.5*59.5*10.5mm	Net Weight 100g
Scope Of Application IOS system above 9.0, Android2.0, HarmonyOS system above 3.0, MagicOS system above 4.0,etc	

#### FCC Statement

This equipment has been tested and found to comply with the limits for a Class B digital device, pursuant to part 15 of the FCC Rules. These limits are designed to provide reasonable protection against harmful interference in a residential installation. This equipment generates, uses and can radiate radio frequency energy and, if not installed and used in accordance with the instructions, may cause harmful interference to radio communications. However, there is no guarantee that interference will not occur in a particular installation. If this equipment does cause harmful interference to radio or television reception, which can be determined by turning the equipment off and on, the user is encouraged to try to correct the interference by one or more of the following measures:

- Reorient or relocate the receiving antenna.
- Increase the separation between the equipment and receiver.
- Connect the equipment into an outlet on a circuit different from that to which the receiver is connected.
- Consult the dealer or an experienced radio/TV technician for help.

Caution: Any changes or modifications to this device not explicitly approved by manufacturer could void your authority to operate this equipment.

This device complies with part 15 of the FCC Rules. Operation is subject to the following two conditions: (1) This device may not cause harmful interference, and (2) this device must accept any interference received, including interference that may cause undesired operation.

#### RF Exposure Information

The device has been evaluated to meet general RF exposure requirement. The device can be used in portable exposure condition without restriction.