

User manual

Connection installation

1. Clean up the area to be pasted, ensuring that the surface to be pasted is clean, flat, and dry. Attach the colored outdoor eaves light to the area to be installed and press it tightly;
2. Cut off the excess part in the mouth of the scissors ; Note that the power must be turned off before cutting
3. Connect the controller of the outdoor colored eaves light to the outdoor colored eaves light in an arrow to arrow manner. If not connected, it will not work. The controller can be fixed with matching tape
4. Plug the power adapter plug into the power outlet, and then plug the power adapter into the controller;
5. Download the app on your phone or pull out the plastic film from the remote control to control the outdoor colored eaves light.



⚠️ Attentions

Outdoor colored eaves light take complete control of your lighting with smart-phone, before you use the App to control the Lights, Please search for and install the application in Google play or Apple store or scan the QR code on the controller , and also scan the QR code in manual. APP name is " **Lotus Lantern** ".



Scan the QR code on the Controller to download App.



Scan the QR code in manual to download App



when you installing the controller. The infrared receiver should be exposed and face to the direction of remote control.

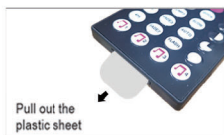

Please pull out the plastic film before use the Controller.

3. IR Remote Control

IR remote control, not only you can adjust the brightness by control the upper multiple keys, but also can enjoy 12 static colors, 4 dynamic modes, 4 music modes, and also adjust brightness and mode speed

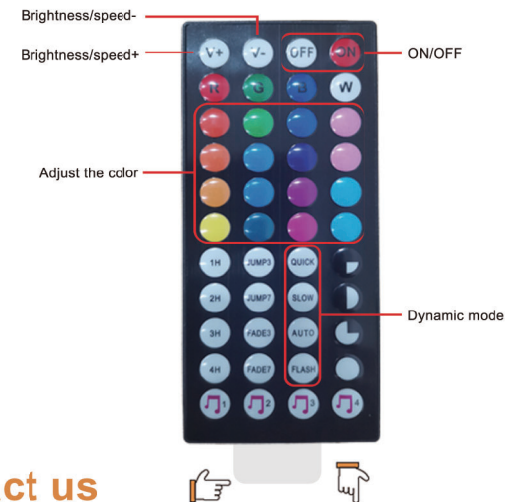

Contact us

Dear Customer,

Thank you so much for your order in our home store , we sincerely hope that you would be satisfied with our items and services.

We always want to provide good customer service and shopping experience to our customers. If you receive a different product or have any problems about using, please feel free to contact us at first time. And we will reply your email within 24 hours.

Email: Smartledlight@outlook.com

② App connection operation

Step1: Please download APP "Lotus Lantern"

Step2: Please make sure your phone is Bluetooth enabled

Step3: Then outdoor eaves light automatically connect to the APP

Step4: If the outdoor eaves light is not displayed on the app, it means that it is not connected, you can close the app and reopen it to see if it is displayed; if it is not displayed, turn off the phone and restart it, and perform the above 2-3 steps again (turn on Bluetooth--open the app--See if it shows)

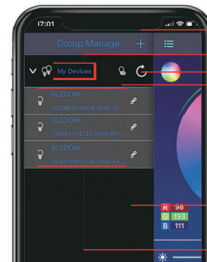

*Click to add grouping and name it

After clicking this area, a light bulb with a green checkmark will be displayed on the right. then all light devices in that group can be synchronized.

Click to refresh the device that can connect to the phone

The light bulb icon shows that can be sync control for all light devices in that group

Connection Status

Disconnected state

light device

③ 【Freely Adjust Colors/ Brightness】

16 million colors and adjustable brightness, make your party more wonderful, creating romance, relaxation, party ambience.

You can adjust the light brightness from 1% to 100%. I think you like the darker light when your child is sleeping, and the brighter light when you watch a movie. The brightest light in everyday life.



Click to show the lamp list

Switch the color wheel

Click to display settings view

Switch light

Adjust the color

Frequent used color (can be changed)

Click square icon to adjust the color

Classic colors

Click to shift the interface

④ 【Freely adjust style / brightness / speed】

22 pre-programmed style modes make your party more exciting, create a romantic, relaxed, party atmosphere adjustable brightness and mode speed from 1% to 100%.



Scroll the selection mode

⑤ 【Music Mode】

Enter Music mode.

Click to start playing music (it will choose from your local music).

Then you'll see the light will change color with the music beats. Wow, such wonderful and stunning scene.



Recycle mode

Previous song

Next song

Pause/Play

⑥ 【Microphone Mode】

Enter Mic mode.

When you talking or sing, it changes color according to the sound volume and rhythm.

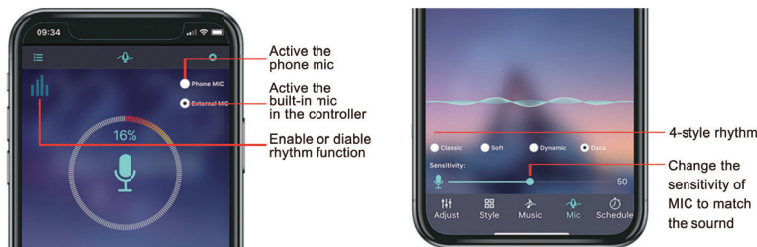

Active the phone mic

Active the built-in mic in the controller

Enable or disable rhythm function

4-style rhythm

Change the sensitivity of MIC to match the sound

⑦ 【Timing Function】

Feel free to set the time in the alarm function according to your own ideas, then the time automatically turns on or off.

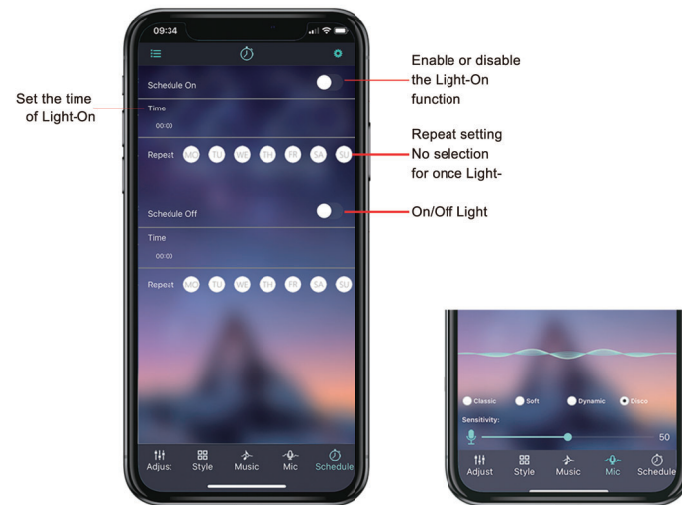

Set the time of Light-On

Enable or disable the Light-On function

Repeat setting No selection for once Light-

On/Off Light

2. Microphone Control

Enter Mic mode when you talking or sing, it changes color according to the sound volume and rhythm

App access-Click the MIC button in the app interface and select 4-style rhythm 4-style mic rhythm, respectively---

Classic: When there is no external sound, the light strip performs a 7-color gradient mode;

Soft: When there is no external sound, the light strip does not light up;

Dynamic: When there is no outside sound, the light is bright red;

Disco: The light strip does not light when there is no outside sound.

a) The statement Remove and immediately recycle or dispose of used batteries according to local regulations and keep away from children. Do NOT dispose of batteries in household trash or incinerate.

b) The statement Even used batteries may cause severe injury or death.

c) The statement Call a local poison control center for treatment information.

d) A statement indicating the compatible battery type (e.g., LR44, CR2032). e) A statement indicating the nominal battery voltage.

f) The statement Non-rechargeable batteries are not to be recharged.

g) The statement Do not recharge, recharge, disassemble, heat above (manufacturer's specified temperature rating) or incinerate. Doing so may result in injury due to venting, leakage or explosion resulting in chemical burns.

a) The statement Ensure the batteries are installed correctly according to polarity (+ and -).

b) The statement Do not mix old and new batteries, different brands or types of batteries

such as alkaline, carbon-zinc, or rechargeable batteries.

c) The statement Remove and immediately recycle or dispose of batteries from equipment not used for an extended period of time according to local regulations.

d) The statement "Always completely secure the battery compartment. If the battery compartment does not close securely stop using the product, remove the batteries, and keep them away from children."

FCC Statement

This equipment has been tested and found to comply with the limits for a Class B digital device, pursuant to part 15 of the FCC Rules. These limits are designed to provide reasonable protection against harmful interference in a residential installation. This equipment generates, uses and can radiate radio frequency energy and, if not installed and used in accordance with the instructions, may cause harmful interference to radio communications. However, there is no guarantee that interference will not occur in a particular installation. If this equipment does cause harmful interference to radio or television reception, which can be determined by turning the equipment off and on, the user is encouraged to try to correct the interference by one or more of the following measures:

- Reorient or relocate the receiving antenna.
- Increase the separation between the equipment and receiver.
- Connect the equipment into an outlet on a circuit different from that to which the receiver is connected.
- Consult the dealer or an experienced radio/TV technician for help.

Caution: Any changes or modifications to this device not explicitly approved by manufacturer could void your authority to operate this equipment.

This device complies with part 15 of the FCC Rules. Operation is subject to the following two conditions: (1) This device may not cause harmful interference, and (2) this device must accept any interference received, including interference that may cause undesired operation.

RF Exposure Information

This equipment complies with FCC radiation exposure limits set forth for an uncontrolled environment. This equipment should be installed and operated with minimum distance 20cm between the radiator and your body.