

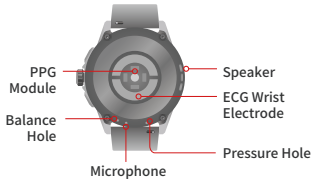

ASTROLINK

QUICK START GUIDE

1.Appearance



SPORT Button

- Short Press to Enter Sports Mode (Customizable: Settings → Preferences)
- Long Press to Activate Smart Voice (Customizable: Settings → Preferences)

MENU Button

- (Watch Face) Short Press to Enter Menu
- (In Sports Mode) Short Press to Pause/Resume Exercise (Except in Sports Mode/Watch Face) Short Press to Return to Watch Face)
- Long Press to Access Alipay (Customizable: Settings → Preferences)

BACK Button

- (Triathlon/Outdoor Climb/Ski Mountaineering) Short Press to Switch Modes
- (Strength/Squats/Push-ups, etc) Short Press to Switch Sets
- (Other) Short Press to Return to the Previous Menu
- Long Press to Restart/Power On

1.Appearance



Rotatable Bezel

- Page flipping/Option switching/Adjusting numerical values



Black area: AMOLED touch screen

- Tap: Selecte the option.
- Swipe up or down: Page flipping/Option switching/Adjusting numerical values
- Swipe right: Return to the previous menu

1. This information applies to ASTROLINK S series, ASTROLINK G series, and similar products.

2. This is for reference only. Product specifications (including but not limited to color, size, screen display, etc.) are subject to actual products. For discrepancies, refer to official website.

2.Charging

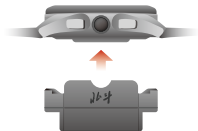

Place the watch steadily on the dedicated charging dock.
Connect the charging cable to the charger and
plug it into a power source.



Charging status

【Attention】

1. Please use a charger with a rated output voltage of 5V, a rated output current of not less than 1A, and with CCC certification and meeting standard requirements to charge the watch.
2. The charging dock supports standard Type-C interface charging cables (charging cables are no longer included to achieve the goal of carbon neutrality by 2030).
3. The charging dock is not waterproof, please ensure it and the device are dry.
4. To protect the battery, charging will pause once the battery is fully charged.

3.App Download and Pairing

► Downloading



Scan the QR code above to download and install the AsWear app, or search "AsWear" in the Android app store or Apple App Store to download the app.

► Pairing



Image1

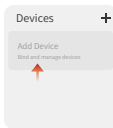

Image2



Image3



Image4

1. Launch app, register & log in. Tap "Add Device" on Home or Devices page . (Image 1/2).
2. Select device model(Image 3), scan the watch QR code, or click "Manual Binding" below, select your device from the list of discovered devices for pairing (Image 4).
3. Follow the subsequent prompts to complete the pairing process.

4.Wearing Instructions

► Replace the watch strap

Adjust buckle holes to fit wrist.

*Pull the strap after installation to ensure secure fit.

For strap removal/installation, see diagram:

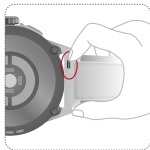

Press down button on the strap with nail to detach from watch.

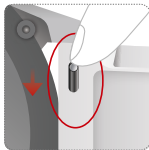

► Daily Wear Instructions

Wear the watch close to skin, PPG sensor evenly touching, 1 finger width from wrist bone.



For accurate heart rate, ensure the back sensor sticks closely to your wrist, no light leakage.

4.Wearing Instructions

► Sport Wear Instructions

During exercise, wear the watch 2 fingers width from wrist bone to avoid shaking or slipping from sweat.



Wear tighter than usual, but not too tight to hinder blood flow.

► ECG Measurement

For left-hand wear, arm flat, right index finger touches 2 o'clock ECG Electrode, avoid touching the edges of the electrode, stay still.

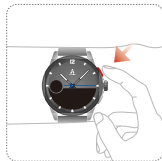

This product is not a medical device.
Health data and suggestions are for reference, not for diagnosis or treatment.

5.Maintenance and Care

1. Waterproof to 50m (5ATM).Dry wrist & watch after water exposure before wearing.
2. Please Use dedicated charging dock. Unauthorized docks may cause fire, explosion, or hazards.
3. To ensure the proper functioning of the charging dock, avoid using it in a car.
4. Not suitable for hot showers, saunas, hot springs,diving, or activities with high water pressure/temp/speed.
5. Avoid using sharp objects to clean the device.
6. Avoid using organic solvents, chemicals, or insect repellents, as they may damage some parts of the device.
7. After exposure to chlorine, saltwater, sunscreen, cosmetics, alcohol, or other chemicals, please thoroughly clean with plenty of water as prolonged contact may cause damage to the device.
8. Gently wipe with a cloth and mild cleanser. Wait for it to dry before wearing.
9. Do not dismantle or replace the watch battery by yourself to to avoid damaging the battery or the device.
10. Try to avoid strong impacts or rough usage, as this may reduce the product's lifespan.

【Attention】

For long-term storage, keep battery at 40%-80% before turning off.

Charge every 6 months to protect battery. Avoid full/empty charge for long to prevent aging.

6. Warranty Statement

► **Warranty Period**

1. We offer a 12-month warranty from purchase date. Free service with valid warranty card.
2. Seller fills out warranty card accurately. It's valid with stamp. Online/store invoices also accepted as proof.

► **Free repair services during the warranty period**

After inspection, the watch malfunctioned due to non-human factors during normal use.

► **Non-warranty items**

* For non-warranty items or expired warranty, paid repair and maintenance services are available.

Warranty service does not cover:

- 1、 Normal wear and tear, aging of exterior parts such as case, band, crystal, buckle, crown, etc;
- 2、 Wear and tear, fading of plating, or coating after the warranty period;
- 3、 Damage to watch components caused by failure to follow the operating instructions;
- 4、 Disassembly of the watch by unauthorized personnel;
- 5、 User bears all costs for non-warranty repairs.

Warranty Card

Product Name:

Product Model:

Customer Name:

Contact Number:

Mailing Address:

Postal Code:

Purchase Channel:

Order Number:

Warranty Period:

Valid for one year from the date of purchase:

[DD/MM/YYYY]

Warranty Terms:

1. Fill in warranty card details carefully. It's your proof of purchase.
2. Keep warranty card and receipt for repairs/warranty services.

7. Hazardous Materials in the Watch

Component	Toxic Materials					
	铅 (Pb)	汞 (Hg)	镉 (Cd)	六价铬 (Cr(VI))	多溴联苯 (PBB)	多溴二苯醚 (PBDE)
主机	×	○	○	○	○	○
表带	○	○	○	○	○	○
电池	×	○	○	○	○	○
充电线	○	○	○	○	○	○

8.Certifications

FCC Statement (FCC ID:XXXXXXX)



Any changes or modifications not expressly approved by the party responsible for compliance could void the user's authority to operate the equipment.

This device complies with Part 15 of the FCC Rules. Operation is subject to the following two conditions:

- (1) this device may not cause harmful interference
- (2) this device must accept any interference received, including interference that may cause undesired operation.

This transmitter must not be co-located or operating in conjunction with any other antenna or transmitter.

Note: This equipment has been tested and found to comply with the limits for a Class B digital device, pursuant to Part 15 of the FCC Rules.

These limits are designed to provide reasonable protection against harmful interference in a residential installation. This equipment generates uses and can radiate radio frequency energy, and if not installed and used in accordance with the instructions, may cause harmful interference to radio communications. However, there is no guarantee that interference will not occur in a particular installation. If this equipment does cause harmful interference to radio or television reception, which can be determined by turning the equipment off and on, the user is encouraged to try to correct the interference by one or more of the following measures:

- Reorient or relocate the receiving antenna.
- Increase the separation between the equipment and receiver.
- Connect the equipment into an outlet on a circuit different from that to which the receiver is connected.
- Consult the dealer or an experienced radio/TV technician for help.

* RF warning for Portable device:

The device has been evaluated to meet general RF exposure requirement. The device can be used inportable exposure condition without restriction.

FCC ID:2BN2S-TA700B

9. Get Service and Assistance

Official Account



- Get product information
- Apply for after-sales service
- View more usage tutorials

User Guide



- Access detailed user guides
- Check common issues

成都天奥电子股份有限公司

CHENGDU SPACEON ELECTRONICS CO.,LTD.

Address: No.66 Shengye Road, Jinniu District, Chengdu, Sichuan, China

Service Hotline: 028-87559999