

隐藏式高清记录仪

使用说明书

REV:01

隐藏式高清记录仪使用说明书

前言：

为了使您尽快轻松自如地操作您的产品，本公司配备了内容详尽的用户手册，使用您的产品之前，请仔细阅读本手册。如果本手册的内容与行车记录仪不符，请以行车记录仪为准。我公司保留变更内容或技术规则而无需事先通知的权利。

本公司对于因软件、硬件的误操作、产品维修、或其它意外情况所引起的数据丢失和个人损坏不负任何责任，也不对此而造成的其它间接损失负责。同时我们无法控制用户对本手册可能造成的误解，因此，本公司将不对在使用本手册过程中可能出现的意外损失负责，并不对因使用该产品而引起的第三方索赔负责。

记录仪设备视频循环录制，重要视频请及时下载保存，以免超出存储时限被循环覆盖。

如果附件与实际产品包装内的物品不符，请以实际产品包装为准。

注意事项：

- 首次安装好产品后，请揭掉镜头保护膜，以免影响录制效果
- 首次使用产品，必须使用手机连接记录仪的WIFI，并打开记录仪APP进入预览界面观看实时视频画面，自动完成同步手机时间。
- 请确保TF卡的插入方向正确，否则可能会导致损坏记录仪或TF存储卡
- 请使用Class10规格的高速TF卡，高速TF卡会有C10的标志，如果存储卡格式与本机不相容时，可能出现不读卡或者不录像问题。请安装好后第一时间用记录仪本机或者APP格式化TF。
- 在使用64GB/128GB大内存TF卡时，必须用记录仪本机或者APP格式化TF卡，否则可能出现不读卡或者不录像问题。

- 最好是每个月把卡取出格式化一次，或者连接APP后，通过手机APP格式化，因为记录仪反复写卡时会出现一些磁盘碎片，从而影响卡的使用速度和寿命。
- 当出现紧急事件，需要调取TF卡内容时，请在发生紧急事件后5至10分钟期间取卡或者下载视频到手机。太提前或者推后都有可能视频被覆盖或者视频保存不完整等问题。

TF卡容量和录制时间对照表：

前后1080P双录产品	
TF卡容量	视频分辨率 1080P 30帧
8GB	约：50分钟(0.8小时)
16GB	约：100分钟(1.6小时)
32GB	约：200分钟(3.2小时)
64GB	约：400分钟(6.4小时)
128GB	约：800分钟(12.8小时)

整机配件：

- ①记录仪主机×1
- ②记录仪电源线×1
- ③后拉延长线×1
- ④后拉镜头×1
- ⑤记录仪保修卡×1
- ⑥记录仪合格证×1

参数和功能介绍：

- 图像处理器：H.264 硬件编码、高清视频编码
- 图像传感器：200W高清像素COMS传感器
- 镜头：140度广角镜头，F2.0光圈
- 视频分辨率：前后1920*1080P30帧
- 视频格式：TS(H.264压缩方式)
- 拍照分辨率：和设置的录像分辨率一样

- TF卡容量：Class10以上TF卡，最大支持128GB内存卡
- 无线传输：内置2.4G WIFI模块
- 缩时录像：缩时录影功能，APP设置（配保险盒取电）
- 移动侦测：移动侦测功能，APP设置
- 一键抓拍：录像状态下点击屏幕拍照图像抓拍
- 麦克风：支持APP打开和关闭
- 时钟记忆：RTC晶电容，保证时间不停止
- 工作温度：- 20℃—70℃/
- SD卡文件存放路径查看如下说明：
- 使用读卡器在电脑上打开TF卡移动磁盘文件夹
- 1 Event：为紧急事件录影视频
- 2 Normal：为正常录影视频
- 3 Photo：照片存放

（产品说明一）：（S203带屏前后双录）

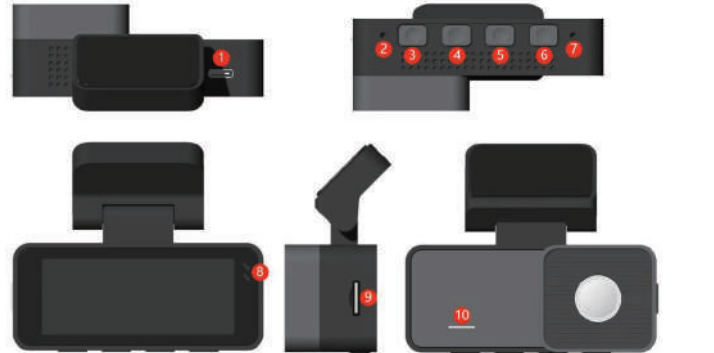

- ①TYPE-C座：供电插口
- ②MIC录音孔：录音收音孔
- ③左翻键：在菜单栏中可左翻
- ④右翻键：在菜单栏中可右翻
- ⑤OK键：短按开始录像/暂停录像，长按3秒拍照
- ⑥菜单键：短按进入菜单，长按3秒关机
- ⑦RST复位孔：短按记录仪复位
- ⑧指示灯：录像时红灯常亮蓝灯闪烁，停止录像时红灯蓝灯常亮
- ⑨TF卡槽：插TF卡
- ⑩喇叭：提示音播报

APP软件下载

- 1、搜索应用下载：安卓系统请用华为应用市场或腾讯应用宝搜索“AUTODVR”安装APP，IOS系统请到applestore搜索“AUTODVR”安装
- 2、扫描二维码下载：扫描下方二维码或外包装盒上面的APP二维码进行安装



扫码下载记录仪APP

APP操作说明：

- 在确保记录仪正常开机，WIFI打开的状态下（参考按键功能介绍），在手机或平板上开启无线局域网，找到记录仪对应的WIFI名称“YH_DVR_****”，连接输入默认密码是：1234567890。



WIFI连接成功后，点击安装的APP，进入APP界面

预览功能图标说明

- 镜头切换：切换前：后摄像头画面显示（注：配有后录产品才能使用此功能）
- 设置：点击进入APP设置菜单界面(注：可在设置菜单里面设置视频分辨率，录音开关，录制视频分段时长，及格式化等功能)
- 全屏切换：切换手机全屏显示画面。
- 拍照：点击拍下当前照片。



- ⑤设备文件：连接记录仪的Wi-Fi后可在线查看录制的视频及照片，可将所需要的视频进行下载保存到本地文件里面。
- ⑥本地文件：查看下载后的视频与照片，可将所需要的视频或者照片选择分享出去。
- ⑦视频枷锁：点击可将正在录制的视频转换为枷锁视频。
- ⑧录像开关：点击开启录像或停止录像。

记录仪安装示意图：



常见故障排除：

- 1，不开机：请确认B+和ACC接线是否正确，确保汽车是点火的状态。
- 2，记录仪无法录制，或录像丢帧或者死机
- ①请使用前，先连接APP通过APP上面的格式化功能，格式化TF卡后在录制
- ②请确认是否使用的是C10以上的高速卡，TF卡速度达不到要求，记录仪工作不正常，严重时会导致记录仪死机
- 3，连接记录仪WIFI后，打开APP无显示
- ①第一次打开APP时的权限需求必须同意，否则APP不能正常使用，需要卸载后重新安装，重新获取权限。
- ②首次连记录仪的WIFI，手机会提示此链接不能上网，是否继续使用，此时一定要点继续使用，否则APP无法显示，需要重新忽略此WIFI后重新连接
- ③请确认手机连接的WIFI名称是记录仪的WIFI，YH-DVR****，否则断开WIFI重新连接记录仪WIFI
- ④确保智能手机没有自动切断记录仪的WIFI，请把智能手机的流量和蓝牙关闭后再连接记录仪WIFI，然后打开APP操作。
- 4，APP预览画面不流畅或者下载速度慢
- ①请确认手机是否有开启蓝牙，如果开启蓝牙的话，传输宽带会受限制，以致缓慢。
- ②清空手机非必要的后台运行的程序，让手机运行更快。
- ③在电磁环境复杂的环境下，也会导致记录仪WIFI受到影响。换个地方再测试。
- ④一边录像一边回放或者下载也会影响速度，可以停止用APP停止录像后再回放或者下载视频。
- 5，下载视频到手机相册后无法观看，或播放卡顿。
- ①由于手机自带的播放器解码能力有限。请下载暴风影音或者QQ影音播放器来播放。
- ②或者扫描下载VLC播放器来播放，推荐使用“VLC播放器”。

Hidden HD recorder

Instruction manual

REV:01

Operation Instruction for Hidden High Definition Recorder

Preface:

The operation instruction is prepared thoughtfully for your effective operation with products in a quick and friendly manner. Please read this operation instruction carefully before using the product. The content of the driving recorder shall be prevailed if there is discrepancy between operation instruction and the driving recorder. Our company reserves the right to change the content or technical rules without prior notice.

Any data loss or personal damage caused by incorrect operation of software or hardware, product maintenance, or other unexpected situations will not be borne by our company, nor are we liable for any other indirect losses resulted accordingly. Meanwhile, any misunderstandings that users may have when using this operation instruction is beyond our control, therefore, our company will not be responsible for any accidental losses that may occur during the use of operation instruction, nor for any third-party claims arising from the use of this product.

The recorder device applies cyclic video recording. Please downloaded and save important videos in a timely manner to avoid being overwritten by cyclic recording beyond the storage time limit.

If the item of accessory bag is inconsistent with actual product package one, the actual product package one shall be prevailed.

Cautions:

■After the first installation of product, please remove the lens protective film to achieve better recording results.

■For the first using of product, please connect to the WIFI of recorder by your mobile phone and open the recorder's APP to enter the preview interface to watch real-time video, which will be automatically synchronized as your phone's time.

■Please ensure the TF card is inserted in the correct direction, otherwise it may cause damage to the recorder or TF storage card.

■Please use the high-speed TF card with Class 10 that will have the C10 logo. If the storage card format is not compatible with the device, there may be issues with non-reading of the card or non-recording of the video. After the installation, please format TF with the recorder or APP as soon as possible.

■When using a large memory TF card, like 64GB/128GB, please format the TF card with the recorder or APP. Otherwise, there may be issues with non-reading of the card or non-recording of the video.

■You are advised to take out the card and format it once a month, or after connecting to the APP, please format it through the mobile APP. The repeated cards writing, there are some possible disk fragments with recorder, which can affect the speed and lifespan of the card.

■When the emergency occurs and the TF card content needs to be read, please take out the card or download the video to your phone within 5min to 10min afterwards. Excessively advance or delay may result in the video being overwritten or the video being saved incompletely.

Comparison of TF Card Capacity and Recording Time:

Front and Back 1080P double recording products	
TF Card Capacity	Video resolution 1080P, 30 frames per second
8GB	Around 50min (0.8 hours)
16GB	Around 100min (1.6 hours)
32GB	Around 200min (3.2 hours)
64GB	Around 400min (6.4 hours)
128GB	Around 800min (12.8 hours)

Product's accessories:

① Recorder host*1 ② Recorder power cord*1 ③ Rear extension cord*1
④ Rear lens*1 ⑤ Recorder warranty card *1 ⑥ Recorder certificate*1

Introduction to parameter and function:

Image processor: H.264 hardware encoding, high-definition video encoding
Image sensor: 200W high definition pixel CMOS sensor
Lens: 140°wide-angle lens, F2.0 aperture
Video resolution: Front and rear 1920 * 1080 P30 frames
Video format: TS (H.264 compression method)
Camera resolution: Same as the set video resolution
TF card capacity: Class 10 or above TF card, maximum 128GB memory card
Wireless transmission: Built-in 2.4G WIFI module
Time lapse recording: Time lapse recording function, APP settings (with fuse box for power supply)
Motion detection: motion detection function, APP settings
One click capture: Click on the screen to take a photo and capture the image while recording

Microphone: Supports APP opening and closing

Clock memory: RTC crystal capacitor ensures uninterrupted time

Working temperature: -20 °C -70 °C/

The following instructions are for your information on the storage route of SD card files:

Please open the TF card mobile disk folder on the computer by the card reader.

1 Event: Recording the video for an emergency event

2 Normal: Normally recording videos

3 Photos: Photo storage

(Introduction to product 1): (S203 front and rear dual recording with screen)

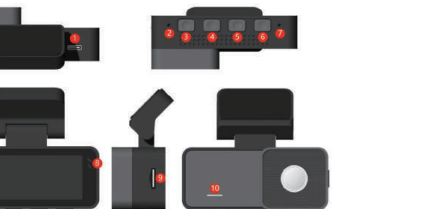

- ① TYPE-C base: Power socket
- ② MIC recording hole: Recording and receiving hole
- ③ Left turning button: Turn left in the menu bar
- ④ Right turning button: Turn right in the menu bar
- ⑤ OK button: Press shortly to start recording/pause recording, press long for 3 seconds to take the photo
- ⑥ Menu button: Press shortly to enter the menu, press long for 3 seconds to shut down
- ⑦ RST reset hole: Press shortly to reset the recorder
- ⑧ Indicator light: Red light stays on and blue light flashes during recording, red light and blue light stay on when recording stops
- ⑨ TF card slot: Insert TF card
- ⑩ Speaker: Prompt sound broadcast

Download of APP software

1. Search and download APP: For Android systems, please use Huawei App Store or Tencent App Store to search for "AUTODVR" for APP installation. For IOS systems, please go to the applestore to search for "AUTODVR" for APP installation.
2. Scan QR code for APP installation: Please scan the APP QR code below or the APP QR code on the outer packaging box for installation



Operation instruction of APP:

Operation instruction of APP:

When the recorder is powered on normally and the WIFI is accessible (refer to the introduction to button function), please turn on the wireless LAN on your phone or tablet and find the corresponding WIFI name "YH_DVR_ * * *" for the recorder. The default password for connecting input is: 1234567890.

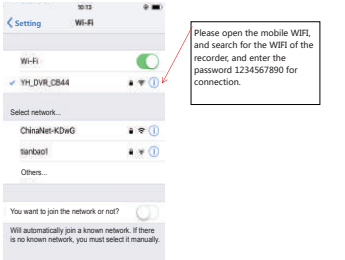

■After successfully connecting to WIFI, please click on the installed APP to enter the APP interface.



■Introduction to preview function icon

- ① Camera switching: Display of switching front and rear camera images (Note: This function will be available with rear recording products)

- ② Settings: Please click and enter the APP settings menu interface (Note: you can set video resolution, recording switch, recording video segmentation duration, and formatting functions in the settings menu)
- ③ Full screen switching: Switch the full display screen of phone.
- ④ Photo: Click to take the photo.
- ⑤ Device files: After connecting to the Wi-Fi of the recorder, you can review recorded videos and photos online, and the required videos can be downloaded and saved to local files.
- ⑥ Local Files: You can view the downloaded videos and photos, and choose to share the desired ones.
- ⑦ Video shackle: You can click to convert the video being recorded into a shackle video.
- ⑧ Video switch: You can click to start or stop recording.

Introduction to the installation of recorder:



Common issues and solutions:

- 1.Failure of power on
Please check whether the B+ and ACC wiring is correct or not, and ensure that the car's engine is running.
- 2.The recorder fails to record, or the recording loses frames or crashes.

- ① Before using, please connect to the APP and apply the formatting function on the APP to format the TF card before recording.
- ② Please check whether you are using a high-speed card of C10 or above. If the TF card speed failed the requirements, the recorder will not work properly, and cause the recorder to crash in severe cases.
- 3.After connecting the recorder WIFI, there is no display when opening the APP.
① The permission application must be granted when opening the APP for the first time. Otherwise, the APP cannot be used normally and needs to be uninstalled and reinstalled to regain permissions.
② When connecting the WIFI of the recorder for the first time, the phone will prompt that this link cannot access the internet, and remind that do you want to continue using it? Please click yes, otherwise, the APP will not display. You can reconnect after ignore this WIFI again.
- ③ Please check that the WIFI name connected to the phone is the recorder's WIFI, YH-DVR****. If not, please disconnect the WIFI and reconnect to the recorder's WIFI.
- ④ Please ensure that the smartphone does not automatically quit the WIFI of the recorder. Please turn off the data and Bluetooth of the smartphone before connecting to the WIFI of the recorder, and then open the APP for operation.
- 4.Non-smooth preview screen of the APP or slow download speed
① Please check whether the phone has Bluetooth enabled. If yes, the transmission bandwidth will be limited, resulting in slow speed.
② You are recommended to terminate the unnecessary background running programs on the phone to realize the faster running.
- ③ Complex electromagnetic environments will influence the WIFI of the recorder. Please retest in another location.
- ④ Simultaneously recording, playing back or downloading will influence the speed. Please stop the APP's recording and then play back or download the video.
5. Failure of watching after downloading the video to the phone album, or the playback stuck.
① Please download Storm Player or QQ Player to play since the limited decoding capability of the built-in player on the phone.
② Or scan and download VLC player for playing, with recommended "VLC player" .

FCC Warning

This device complies with Part 15 of the FCC Rules. Operation is subject to the following two conditions:

(1) This device may not cause harmful interference, and (2) this device must accept any interference received, including interference that may cause undesired operation.

NOTE 1: This equipment has been tested and found to comply with the limits for a Class B digital device, pursuant to part 15 of the FCC Rules. These limits are designed to provide reasonable protection against harmful interference in a residential installation. This equipment generates, uses and can radiate radio frequency energy and, if not installed and used in accordance with the instructions, may cause harmful interference to radio communications. However, there is no guarantee that interference will not occur in a particular installation. If this equipment does cause harmful interference to radio or television reception, which can be determined by turning the equipment off and on, the user is encouraged to try to correct the interference by one or more of the following measures:

- Reorient or relocate the receiving antenna.
- Increase the separation between the equipment and receiver.
- Connect the equipment into an outlet on a circuit different from that to which the receiver is connected.
- Consult the dealer or an experienced radio/TV technician for help.

NOTE 2: Any changes or modifications to this unit not expressly approved by the party responsible for compliance could void the user's authority to operate the equipment.

RF Exposure Statement

To maintain compliance with FCC'S RF Exposure guidelines, This equipment should be installed and operated with minimum distance of 20cm between the radiator and your body. This device and its antenna(s) must not be co-located or operation in conjunction with any other antenna or transmitter.