

Customer Service Email: Dash-Camr-service@outlook.com

Model: **L3A04**

Device Name: Smart Recorder Speaker: Supported

MIC Recording: Supported

Photography Resolution: 800W

Viewing Angle: 150°

Expandable TF Card: Up to 128GB Supported

Video Resolution: 3840x2160P, 2560x1440, 1920x1080 at 30FPS (Front Camera)

Wireless Connectivity: Wi-Fi IEEE802.11b/g/n 2.4

- : Indicates that the content of the hazardous substance in all homogeneous materials of the component is below the limit requirements.
- ✕ : Indicates that the content of the hazardous substance in at least one of the homogeneous materials of the component exceeds the limit requirements.

Note: The product comes in various specifications, refer to the actual product for details.



Screen displays the interface after connecting to a phone

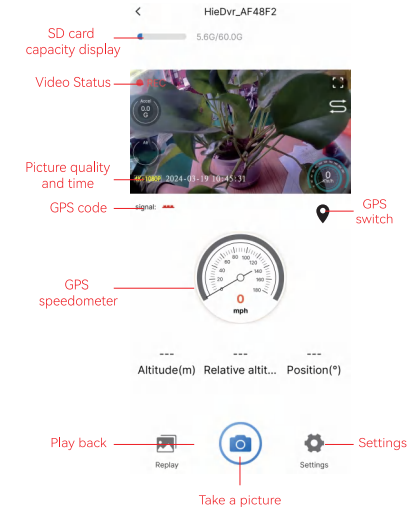

Customer Service Email: Dash-Camr-service@outlook.com

Product Appearance

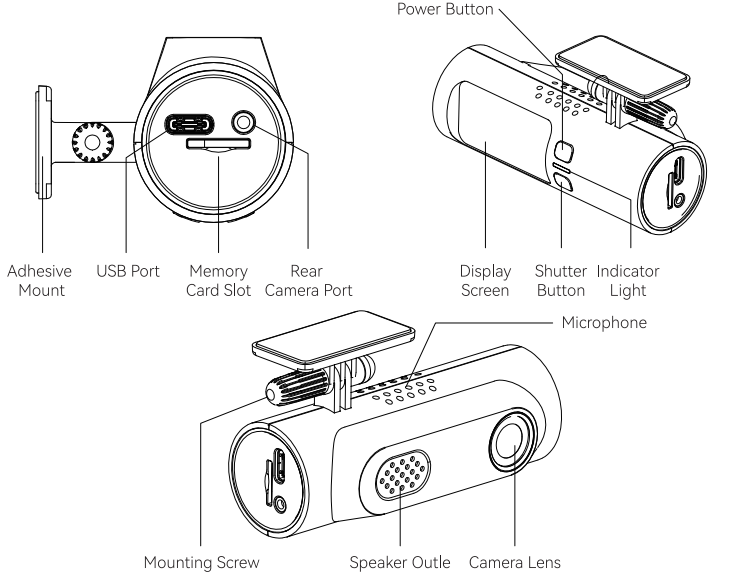

Product Installation

Please install the product as follows.

- 1. Take out the electrostatic sticker from the packaging box and install it on the front windshield within the recommended area shown below. Clean the glass before installation and make sure to squeeze out any air bubbles between the electrostatic sticker and the glass.
- 2. As shown in the right image, peel off the red protective sticker on the dash cam mount and stick the dash cam to the center of the electrostatic sticker. Press down on the mount base with your hand to ensure that the high-temperature resistant adhesive tightly contacts the electrostatic sticker.
- 3. Following the method shown in the diagram on the right, route the car charger cable along the top of the windshield, down the AA pillar, into the passenger-side storage compartment, and then to the cigarette lighter socket, and plug it in for power.

Tips:
The location of the cigarette lighter may vary in different vehicles; the picture is for reference only.
The blue light will flash during normal recording.
If the WiFi is not connected for a long time, the recorder's WiFi will automatically turn off. Press the button to turn it on when you need to connect.

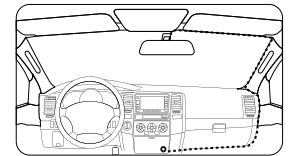
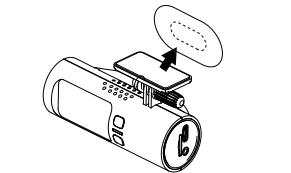
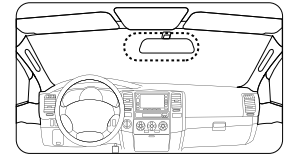

Button Functions

The dash cam has two buttons; the upper button is the power button, and the lower button is the shutter (photo) button. Pressing these buttons a different number of times will perform different functions:

Power Button (Upper Button)	Short Press	Switch QR code display
		Turn on WiFi.
		Power on
	Long Press for 5s	Power off
WiFi turns off automatically after 5 minutes of inactivity		
Shutter Button (Lower)	Short Press	Take a photo
		Turn on WiFi simultaneously
	Long Press for 3s	Switch QR code display
		Turn on WiFi simultaneously
	Long Press for 3s	Reset to factory settings
WiFi turns off automatically after 5 minutes of inactivity		

Explanation of the Main Features in the APP
Settings Interface

Video Encoding Format	H264 (default) / H265
Format TF Card	Format memory card (FAT32 64KB)
Audio Recording Switch	On (default) / Off
Recording Duration	1 minute (default) / 3 minutes / 5 minutes
Emergency Recording Sensitivity	Adjust the collision sensitivity during normal recording, with options for Off / Low / Medium (default) / High
Parking Monitoring Sensitivity	Adjust the collision sensitivity after the dash cam goes into sleep mode, with options for Off (default) / Low / Medium / High
Time-Lapse Recording (Requires dedicated ACC power cable)	Choose Off (default) / 10 minutes / 12 hours / 24 hours / 48 hours (the longer the time, the higher the requirements for the car battery) Note: When the device enters time-lapse recording mode, it will automatically turn off WiFi
Vehicle Battery Protection	When the vehicle battery voltage drops below this option, the device will automatically shut down to protect the battery, with options for Low (11.8V) / Medium (12V) (default) / High (12.2V)
Speaker Volume	Adjust the volume of the dash cam speaker, with options for Mute / Low (default) / Medium / High
Modify Dash Cam WiFi Information	Change WiFi username and password Note: If you forget the WiFi password, you can long press the photo button to restore factory settings
Restore Factory Settings	Reset settings (WiFi will also revert to default username and password)
About Dash Cam	Dash cam firmware information

Download the APP

To use this product, please search for Waycam or Golook in the app store—choose one of the two. Alternatively, scan the QR code below to download and install the APP.



Waycam



GoLook

L3 Dash Cam Wi-Fi Hotspot: Hotspot Name: HieDvr***** Initial Password: 12345678

Service Policy

Our company provides services to consumers who purchase our products in strict accordance with United States law.

Packing List

- 1.Smart Dash Cam ×1
- 2. Power Cable ×1
- 3. Electrostatic Sticker ×1
- 4.High-temperature Adhesive (already applied to the mount base) ×1
- 5. User Manual ×1

Warning

This device complies with part 15 of the FCC Rules. Operation is subject to the following two conditions: (1) This device may not cause harmful interference, and (2) this device must accept any interference received, including interference that may cause undesired operation.

This equipment has been tested and found to comply with the limits for a Class B digital device, pursuant to Part 15 of the FCC Rules. These limits are designed to provide reasonable protection against harmful interference in a residential installation. This equipment generates, uses and can radiate radio frequency energy and, if not installed and used in accordance with the instructions, may cause harmful interference to radio communications. However, there is no guarantee that interference will not occur in a particular installation. If this equipment does cause harmful interference to radio or television reception, which can be determined by turning the equipment off and on, the user is encouraged to try to correct the interference by one or more of the following measures:

- Reorient or relocate the receiving antenna.
- Increase the separation between the equipment and receiver.
- Connect the equipment into an outlet on a circuit different from that to which the receiver is connected.
- Consult the dealer or an experienced radio/TV technician for help.

Changes or modifications not expressly approved by the party responsible for compliance could void the user's authority to operate the equipment.

This equipment complies with FCC radiation exposure limits set forth for an uncontrolled environment. This equipment should be installed and operated with minimum distance 20cm between the radiator and your body.