

Main Unit Diagram

Main unit front side

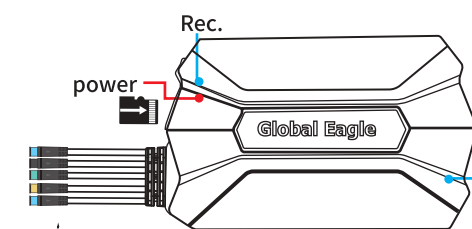

Main unit rear side

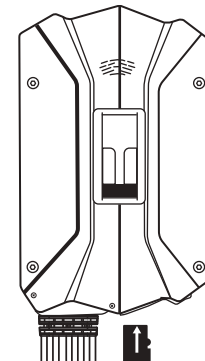

Multi-function button:



1. Recording mode: short press (Red LED will flash once) = lock/ unlock file (file lock according to user recording set time duration)
2. During file lock, blue LED will quick flash
3. Quick press twice = snapshot
4. Long press 10sec. = format
5. Recording mode: blue LED flash = recording blue LED ON = stop recording

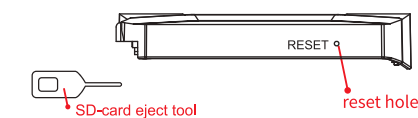

When device failure to proper operate. Please use SD-card eject tool/paper clip and press "Reset" which will re-boot

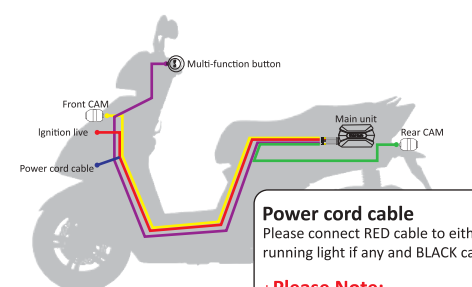

Power cord cable

Please connect RED cable to either ignition switch/ day time running light if any and BLACK cable to solid ground.

*Please Note:

During installation, please avoid high voltage, spark plugs, keyless etc. And make sure cables are flexible during turning cycles of bike

APP Introduction

Step 1: Please download Global Eagle App using QR code



iOS



Android

Step 2: Open the App

Step 3: App start-up info.

Either press "Next" or top right corner "home" icon to exit

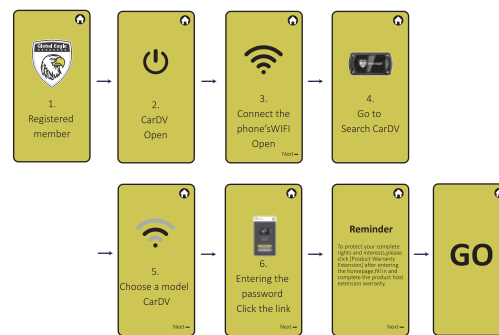

Step 4: Go to your mobile and under settings/Wi-Fi search for your dash camera

★ ID: GlobalEagle MotoDVR_ x x x x (Unique number for each dash camera)

★ Default password: 12345678

Step 5: App main page, press top right corner "Live Video" or "Live Video" button and search for driving recorder.

Once searched and connected successfully, you may now operate your dash camera with the App

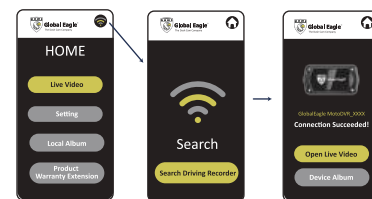

*Note:

Memory card: For first time either new or used, please format before using otherwise your files cannot be saved or activated with App. "Live video" are for emergency viewing as using Wi-Fi to view the files maybe unstable and slow, bigger the file size the longer it will take to upload onto your mobile. For stable and best viewing, we suggest to download the files into your mobile.

APP Function Explained

Live Video

1.Open Live video

*Note: Press to return to previous page

Once App connection successfully, press "Open Live Video" to enter live video recording.



Stop recording



Snapshot



Switch between front and rear camera

2.Device Album

Video = "Video and emergency locked files" can be viewed

*Press the file you want to view and wait for it to be uploaded onto your mobile

Photo = "Photo" files can be viewed

*Press the file you want to view and wait for it to be uploaded onto your mobile

*Note :

To save files onto mobile, please long press the files you want to save and a pop-up information will allow you to either save/ delete/ return the selected files



Saving in progress



Save unsuccessfully please check Wi-Fi connection or restart App



Save successfully

Setting

1.Device settings

- 01.Device video quality = 1080P 30fps / 720P 30fps
- 02.Modify Wi-Fi password = Change password: 8 numeric numbers only
- 03.Single video time = recording time duration
- 04.G-Sensor = Off/ High/Mid/ Low
- 05.Device key tone = Only with "display" ver.
- 06.Device volume = Only with "display" ver.
07. Device recording function = On/ Off (recording with sound)
- 08.Frequency = 50Hz/60Hz
- 09.Screen sleep time = Only with "display" ver.
- 10.Video speed display = On/ Off (display current speed)
- 11.Format SD card = Press to confirm format
- 12.Reset device setting = factory reset
- 13.Device info. = Dash camera information

2.Device diagnose

Press to diagnose device

Local Album

Your saved files can be accessed under local albums: Video, Photo It can also be accessed directly through mobile photo album

Product Warranty Extension

Global Eagle member areas page, for users to subscribe their products for warranty

Specifications

Model	S3
View angle	156°
Resolution	1920*1080
Lens aperture	F2.0
WIFI	Support
Lens IP rating	IP67
Memory card	Max. 128GB (Class 10U±)
Video format	TS code (H.264)
Transmission	AHD
Frame rate	30fps
Battery type	Button cell for time memory only
Operating temp	-20°C ~ 70°C
Language	Simplified/Traditional Chinese, English,Japanese
Manufactured	Taiwan

Remarks

Global Eagle Dash cameras come with a 1yr factory warranty.

- 01.Memory card must be formatted before using.
- 02.Please include warranty card with date of purchase and receipt when returning for warranty repair
- 03.Improper use or trying to disassemble the dash cam will void warranty.
- 04.Use only factory provided accessories such as cables/power cords. Use of non-factory accessories will void the warranty.
- 05.Please avoid high pressure washers directly on dash camera.
- 06.Memory cards have limited read and write life cycle. Please format every month for best performance and it is recommended to replace memory card every year to ensure files are 100% accessible.
- 07.Do not remove memory card while recording, otherwise file will be damaged.
- 08.Please make sure display no pressure is applied to DVR by other objects once installed.
- 09.Do not instantly power ON/OFF again, allow camera time to start up before turning off as this may cause the system to malfunction.
- 10.Do not use the dash camera in contravention to local law regulations for cameras.
- 11.Do not under any circumstances disassemble your dash cam otherwise warranty will be void.
- 12.Please keep camera lens clean for best image quality.
- 13.It is recommended to use GOM, KMP, POT, and MP4 to play recorded files.



Global Eagle Website



Global Eagle YouTube



Global Eagle Facebook

FCC Information

This device complies with part 15 of the FCC Rules. Operation is subject to the following two conditions:

- (1) This device may not cause harmful interference
- (2) This device must accept any interference received, including interference that may cause undesired operation.

RF EXPOSURE WARNING

This device contains transmitters and receivers which emit Radio Frequency (RF) energy. The device is designed to comply with the limits for exposure to RF energy set by the Federal Communications Commission (FCC) of the United States, Industry Canada (IC) of Canada, and the regulating entities of other countries.

WARNING

Changes or modifications to this unit not expressly approved by the party responsible for compliance could void the user's authority to operate the equipment. This equipment has been tested and found to comply with the limits for a Class B digital device, pursuant to part 15 of the FCC Rules. These limits are designed to provide reasonable protection against harmful interference in a residential installation. This equipment generates, uses and can radiate radio frequency energy and, if not installed and used in accordance with the instructions, may cause harmful interference to radio communications. However, there is no guarantee that interference will not occur in a particular installation. If this equipment does cause harmful interference to radio or television reception, which can be determined by turning the equipment off and on, the user is encouraged to try to correct the interference by one or more of the following measures:

- Reorient or relocate the receiving antenna.
- Increase the separation between the equipment and receiver.
- Connect the equipment into an outlet on a circuit different from that to which the receiver is connected.
- Consult the dealer or an experienced radio/TV technician for help.

Global Eagle

5F-5, No. 16, Ln.609, Sec. 5, Chongxin Rd.,
Sanchong Dist., New Taipei City 241 Taiwan

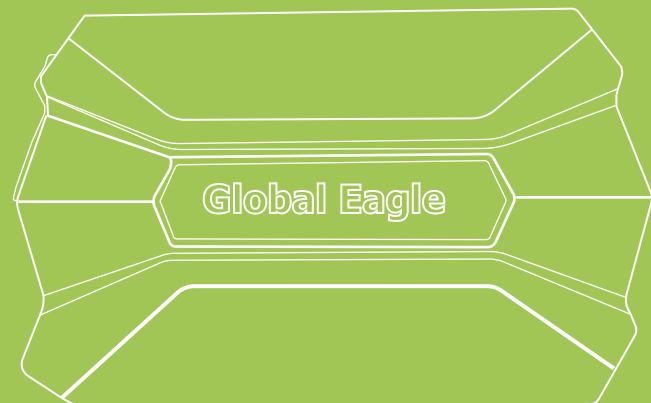

S3

Locomotive driving recorder

User Manual

