

Network surveillance camera

Operation guide v1.7.3

User Tips:

Step 1: Use the provided tool to open the back cover.

الخطوة 1: استخدم الأداة المتوفرة لفتح الغطاء الخلفي.

1 단계: 제공된 도구를 사용하여 후면 덮개를 엽니다.

Schritt 1: Verwenden Sie das mitgelieferte Werkzeug, um die hintere Abdeckung zu öffnen.

Étape 1: utilisez l'outil fourni pour ouvrir le capot arrière.

Passaggio 1: utilizzare lo strumento fornito per aprire la cover posteriore.

Step 1:



Step 2: Remove the insulating paper and slide the power button.

الخطوة 2: إزالة ورق العازل وتمرير زر الطاقة.

2 단계: 절연지를 제거하고 전원 버튼을 밀어주세요.

Schritt 2: Entfernen Sie das Isolierpapier und schieben Sie den Netzschalter.

Étape 2: Retirez le papier isolant et faites glisser le bouton d'alimentation.

Passaggio 2: rimuovere la carta isolante e far scorrere il pulsante di accensione.

Step 2:

TURN ON

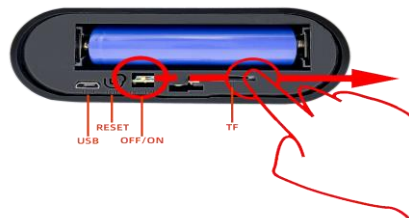

Step 3: Scan the QR code, download HDliveCam from IOS Store or Google Play and configure the network.

الخطوة 3: مسح رمز QR، تنزيل HDliveCam من Google Play أو IOS متجر، ثم تكوين الشبكة.

Schritt 3: Scannen Sie den QR-Code, laden Sie HDliveCam über den IOS Store oder Google Play herunter und konfigurieren Sie das Netzwerk.

Étape 3: Scannez le code QR, téléchargez HDliveCam via IOS Store ou Google Play et configurez le réseau.

Passaggio 3: scansiona il codice QR, scarica HDliveCam tramite IOS Store o Google Play e configura la rete.

Step 3:



Features:

- Real-time Audio & Video Recording
- HD Video Resolution 1920*1080p
- WiFi IP Network Function
- AUTO HD IR Night Vision
- 120 degree Lens View Angle
- Support Smartphone Tablet APP Remote View and Control
- Video cloud storage: support users to open cloud storage according to their needs, at their own expense
- Support 8 users access at the same time
- Battery&charging : Built-in 1200mah battery 18650,Charging time is about 3 hours,working time is about 5 months.
- Charging model: Charge Voltage /DC=5V/2A Battery capacity: 1200 Mah

Installation Precautions

1. Please confirm the power supply voltage before installation. The unmatched power supply may damage the device. Please format the TF card for the first time, otherwise an error may occur.
2. Some router WIFI names and passwords contain Chinese special fonts or special symbols. The device may fail to connect. Please change the WIFI name and password to English letters and numbers.
3. When connecting, please try to make your camera, mobile phone and router close to each other to prevent the signal from being weak.

Connection preparation



After the camera presses the RESET button for 5 seconds, the indicator flashes rapidly and resets until the indicator is always on, indicating that the reset was successful.

Register and login account(support third-party fast login)

Connection method: AP direct connection

The first step

In the "Camera" interface, click on the "+" in the upper right corner.

Add device

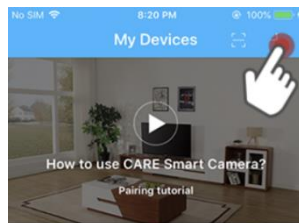

The second step

Please confirm whether the camera is reset, and click "Next". (If it is not reset, press and hold the RESET button on the device for 5 seconds, the indicator flashes quickly and resets until the indicator is always on)

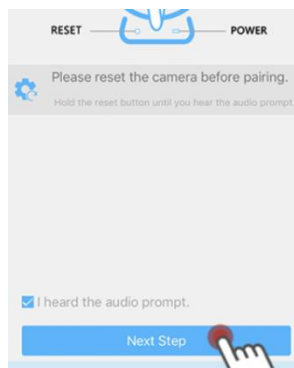

The third step

Click "Go to set WIFI"

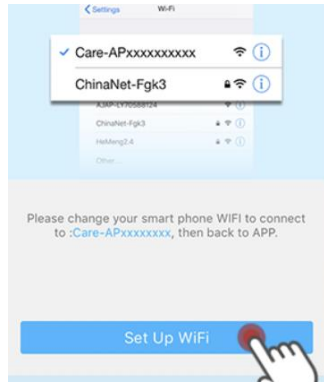

The fourth step

Go to the phone system settings page and click on "WIFI"

Note: Android phone skip this page and go directly to the wifi selection page.



The fifth step

Go to the WIFI selection page and select the device hotspot, Care-AP-xxxx (Android system will directly enter this page)



The sixth step

If the connection is successful, it will pop up the love to see the push, display "has connected the camera wifi successfully, please return to the application" can click to enter the LiveCamera APP

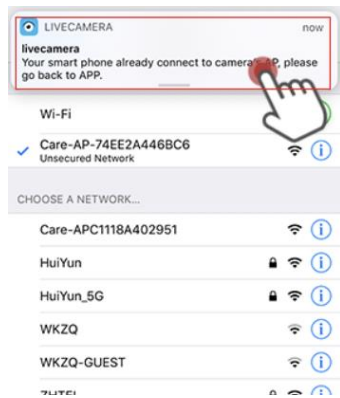

The seventh step

In the "AP connection" mode, only the camera that is currently connected to the hotspot can be displayed. Disconnect the current hotspot and you will return to normal mode.

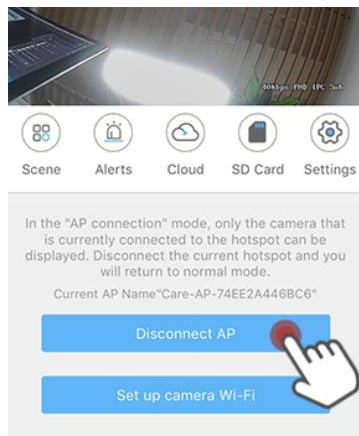

The eighth step

Click "Set up Camera wi-fi" to watch the camera online.

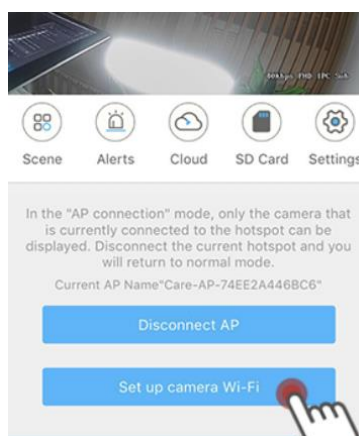

The ninth step

Open the "WIFI" option and select to connect to WIFI



The tenth step

Enter the WIFI password and click on the connection.

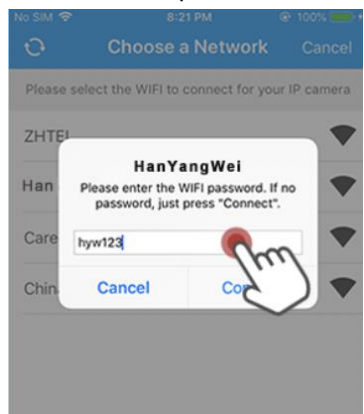

The eleventh step

Waiting for configuration to succeed

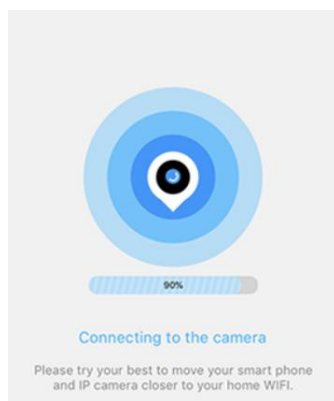

The last step

Enter the name of the device you want to set and click "Next" to

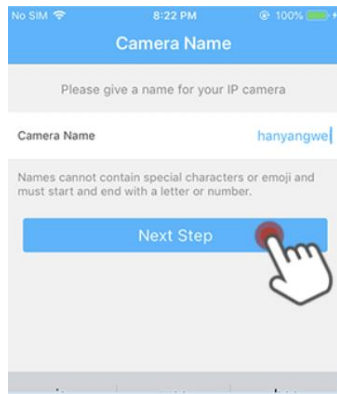

For more tips , please check the app interface “I” → “Help” → “Common problems”

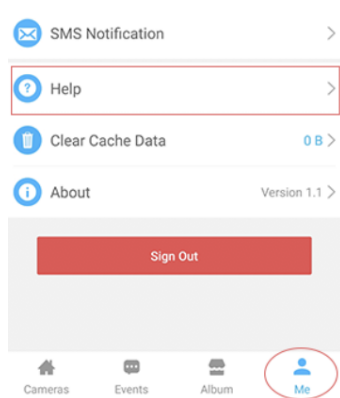

Alarm recording Settings

The first step

Click “Settings”

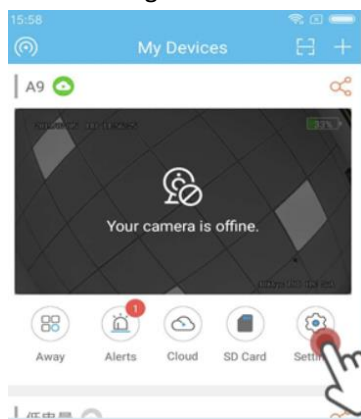

The second step

Click on the “Alert Settings”

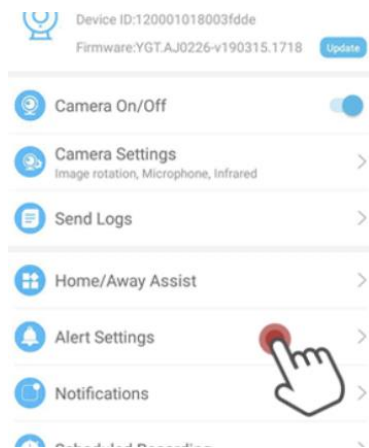

The third step

open "Motion Detection" after click save

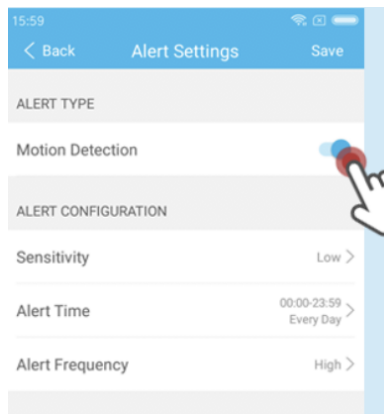

The fourth step

Click "Alarm Notification", then open "Push Alert" and then click "Save".

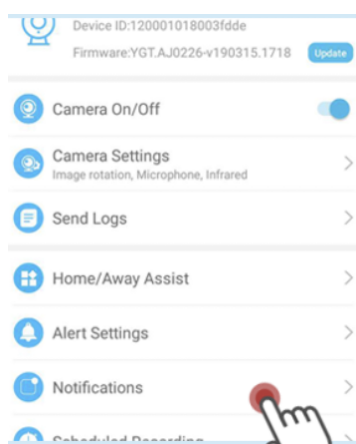

View local video locations

The first step

Click on "Local Album"

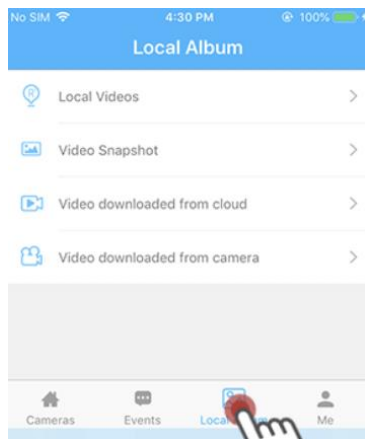

The second step

Click "Local Videos" or "Video Snapshot"

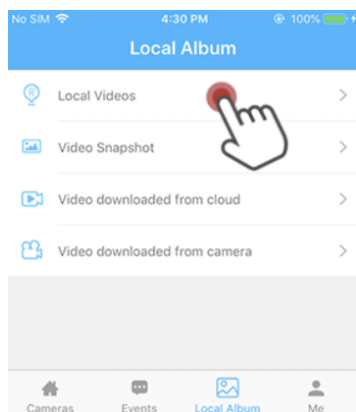

The third step

Find recorded video or snapshot .Click "Delete" or "share"

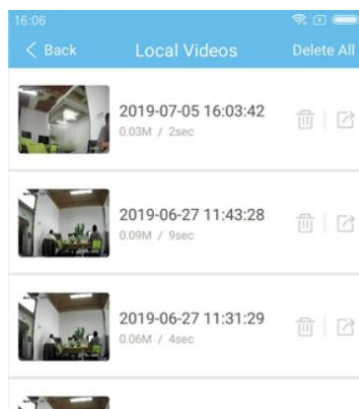

Function is introduced

Function is introduced

Camera list

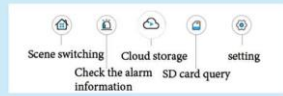

Monitor frame

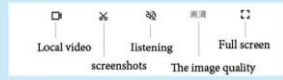

Additional features

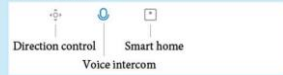

If the above method cannot connect normally, please check:

- ① Make sure your router is properly connected. There is no WiFi disabled or hidden
- ② The name of WiFi cannot contain Chinese characters or special characters
- ③ Insure your router is on a 2.4g network and does not support 5G networks

FCC Caution:

This device complies with part 15 of the FCC Rules. Operation is subject to the following two conditions: (1) This device may not cause harmful interference, and (2) this device must accept any interference received, including interference that may cause undesired operation.

Any Changes or modifications not expressly approved by the party responsible for compliance could void the user's authority to operate the equipment.

Note: This equipment has been tested and found to comply with the limits for a Class B digital device, pursuant to part 15 of the FCC Rules. These limits are designed to provide reasonable protection against harmful interference in a residential installation. This equipment generates uses and can radiate radio frequency energy and, if not installed and used in accordance with the instructions, may cause harmful interference to radio communications. However, there is no guarantee that interference will not occur in a particular installation. If this equipment does cause harmful interference to radio or television reception, which can be determined by turning the equipment off and on, the user is encouraged to try to correct the interference by one or more of the following measures:

- Reorient or relocate the receiving antenna.
- Increase the separation between the equipment and receiver.
- Connect the equipment into an outlet on a circuit different from that to which the receiver is connected.
- Consult the dealer or an experienced radio/TV technician for help.

The device has been evaluated to meet general RF exposure requirement. The device can be used in portable exposure condition without restriction.