

# Instruction Manual

## Introduction of Lamp Body

The product has 2 lighting control zones, one is a spotlight touch switch area and the other is a nightlight touch switch key. Please refer to the following illustration for details.

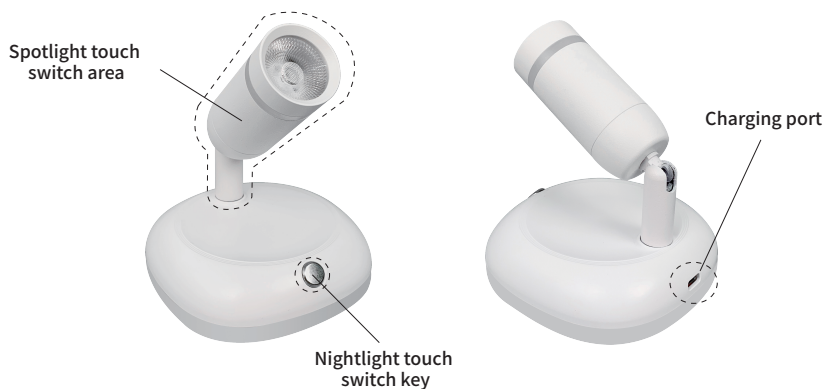

## Spotlight and Night light Function

**(Note: the first time you need to long press the night light switch to activate, the base light double flash that has been successfully activated.)**

\*Single press the spotlight touch switch area can change light color temperature. (Only for spotlight mode)

\*Long press the touch switch area/key can increase or decrease the light brightness.

1. Two control modes: touch control and remote control.
2. Spotlight mode has 3 color temperatures to choose from, 6000K cool light, 4000K natural light and 3000K warm light.
3. The color temperature of night light mode is 3000K warm light.
4. Brightness memory function: when the light is turned on, it will keep the same color temperature and brightness as when it was turned off last time.
5. Brightness adjustable: You can adjust the brightness by long press, or increase/decrease the brightness by +/- buttons on the remote control.
6. Timer Preset: You can use the remote control to set the product timer to 1H, 2H or 4H after turning off the light.
7. Wireless Remote Control: You don't need to point the remote control at the light body, just press the remote control button to control it easily.
8. This product is powered by a rechargeable battery with a capacity of 4000mAh. In order to maintain the optimal service life of the product's battery, please fully charge it before first use. The charging indicator is red when the product is charging and green when the battery is full.

## Introduction of Remote Control

The remote control is shipped with button batteries. We have added a piece of clear PVC insulating film between the battery and the contact point of the remote control, which needs to be pulled out during the first use.

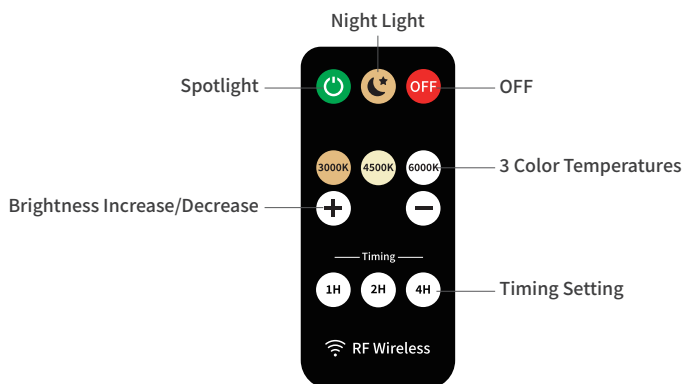

## Installation Methods

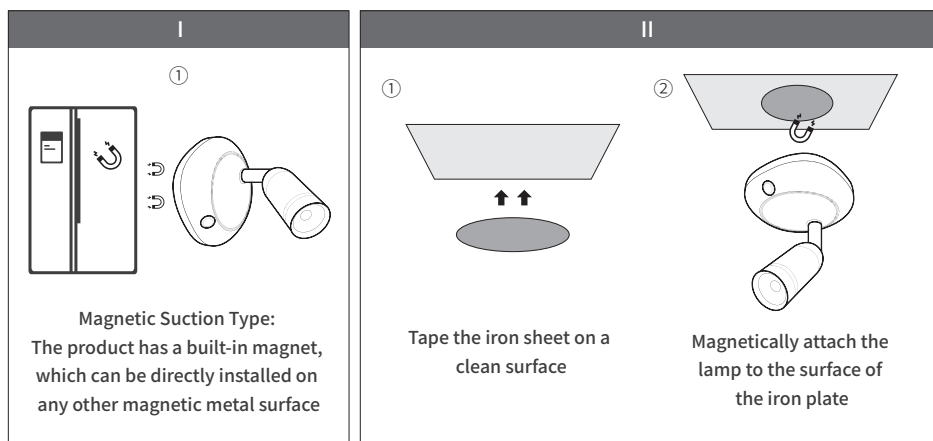

## Specifications

Input current: 2A  
Input voltage: 5V  
Battery Capacity: 4000mAh  
Power: 1.5W

Working hours: 12H-120H (Maximum - Lowest Brightness)  
Product material: Aluminum +ABS  
Size: Base 94mm\*94mm, Height 133mm

This device complies with part 15 of the FCC Rules. Operation is subject to the following two conditions: (1) This device may not cause harmful interference, and (2) this device must accept any interference received, including interference that may cause undesired operation.

Any Changes or modifications not expressly approved by the party responsible for compliance could void the user's authority to operate the equipment.

**Note:** This equipment has been tested and found to comply with the limits for a Class B digital device, pursuant to part 15 of the FCC Rules. These limits are designed to provide reasonable protection against harmful interference in a residential installation. This equipment generates uses and can radiate radio frequency energy and, if not installed and used in accordance with the instructions, may cause harmful interference to radio communications. However, there is no guarantee that interference will not occur in a particular installation. If this equipment does cause harmful interference to radio or television reception, which can be determined by turning the equipment off and on, the user is encouraged to try to correct the interference by one or more of the following measures:

- Reorient or relocate the receiving antenna.
- Increase the separation between the equipment and receiver.
- Connect the equipment into an outlet on a circuit different from that to which the receiver is connected.
- Consult the dealer or an experienced radio/TV technician for help.

#### FCC Radiation Exposure statement

The device has been evaluatec to meel general RF exposure requirement. The device can be used in portable exposure condition without restriction.