

封面

Suquatannic

Stereo Bluetooth Headset

Model: KH157M

User Manual



Need any help?

We're happy to assist you whenever you need us.

Email us at: support@suquatannic.com

We'll help you solve the problem within 24 hours.

Catalog

1.How to Contact us with Product Issues?-----	2
2. Product Overview -----	2
3. Basic Operation -----	3
4. Bluetooth Pairing and Connection -----	4
5. LED Indicator -----	6
6. TTS tone -----	6
7. Charging -----	7
8. Product Specification -----	8
9. Frequently Asked Questions -----	9
10. Kind Tips -----	9
11. Warranty -----	10
12. Register Your Product -----	10

1

1. How to contact us with product issues?

Thank you for choosing KH157M Bluetooth Headset! This user manual will provide you with all of the information you need to get started with your headset.

If you have any problems setting up or using your Bluetooth headset or have any problem with your product or need any help, please do not hesitate to contact us by email at: support@suquatannic.com

We would work to provide you with any help needed, or send you a replacement or refund within 24 hours.

Please read this manual carefully before using the product and keep it properly.

2.Product Overview



2

Packing List

- A. Bluetooth Headset(KH157M) x 1
- B. Charging Base x 1
- C. User Manual x 1

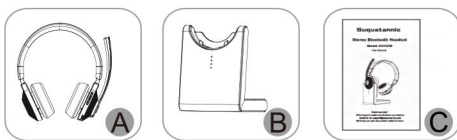

3.Basic Operation

Button	Function	Operation Instruction
MFB Multi-function Button	Power On	Press and hold the MFB for about 2 seconds to power on.
	Power Off	Press and hold the MFB for about 3 seconds to power off.
	Last call redial	In connected status, double-click the MFB to redial the last cell phone call.
	Voice assistant	In connected status, long press for 1 second to activate voice assistant on your phone.
	Answer a call	Single press the MFB once to answer the incoming call.
	Hang up a call	Single press the MFB to hang up the call.
	Reject a call	Press and hold the MFB for 1 second to reject the incoming call.
	Play / Pause	Single press the MFB once to play/pause the music.
	Enter Pairing Mode	a The headset will enter pairing mode automatically after power on. b Disconnect the Bluetooth Manually, and the headset enters pairing mode.
	Three-way calling function	1. During a call, single press the MFB once to answer the new call and hang up the current call. 2. During a call, double-click the MFB to answer the new call and hold the current call. 3. During a call, press and hold the MFB for 1 second to reject the new call. 4. During a three-way calls, double-click to switch audio between the current call and the hold call.
Mute Button	Switch to transparency mode	In ANC ON status, press and hold the "Mute button" for 3 seconds to turn on or turn off the transparency mode.
	Microphone Mute	Single press once the "Mute Button"to mute on or mute off the call.
Volume +	Volume Up	Short press the Volume + to turn up the volume.
Volume -	Next Track	Press and hold the Volume + for 1 second to Next Track.
	Volume Down	Short press the Volume - to turn down the volume.
Combined Button	Previous Track	Press and hold the Volume - for 1 second to Previous Track.
	Clear pairing records	In power on status (no calls and no music), press and hold the MFB and Volume- for 5 seconds to clear the connections. The headset will not connect again automatically, please pair and connect again.

3

4. Bluetooth Pairing and Connection

Headphones Connection via Bluetooth

1.Power on KH157M and make the headphones enter pairing mode:

2.Turn on Bluetooth on your device, eg: cell phone or computer. And search and click "KH157M" to connect with your device, And the LED change to Blue flashes slowly(The blue light flashes once every 10 seconds). The phone displays "KH157M" connected.

3.You can press MFB / Volume+ / Volume- / Microphone Mute button on the Bluetooth headset to control the answer/hang up a call and play/pause of the music, next and previous song. Turn On/down the volume, and mute on /off calls.

4.If you connected the KH157M with your computer, please also set "KH157M" as default audio input device(Microphone) and output device(Speakers) on your computer. Please refer to the steps below:

Right-click the Sound icon> Sound Settings > Select [KH157M] as your output device (Speaker).
Select [KH157M] as your input device (Microphone).
Make sure that [KH157M] has been selected as both the output and input device.
Then close Settings.

If have any problems about this issues, please contact us at support@suquatannic.com.

4

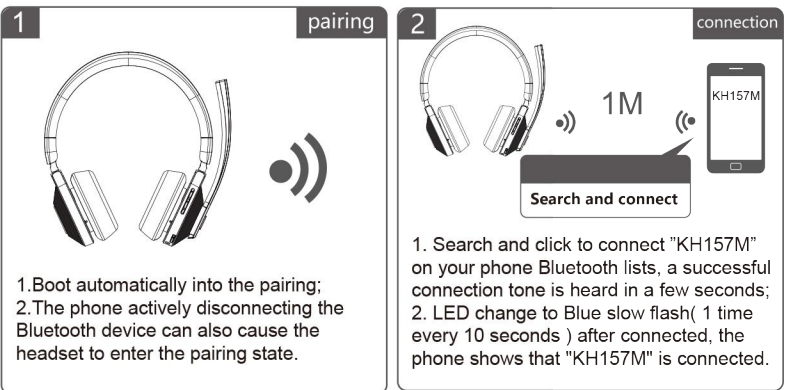

Headphone Connection with Dongle on Computer or Laptop:

1.Plug the dongle into computer/laptop and consecutive hit the button on the dongle for 5 times to clear connections, and then the red and blue lights on the dongle flashes alternately.

2.Make the headphones in pairing mode as well. (Please refer to steps above if you forgot about it.)

3.Put the headphones close to the dongle. When the dongle indicator turns blue and the headphones flashes blue once every 10 seconds, they are paired successfully.

5

5. LED Indicator

Headphones	
Mode	LED Indicator
Power on	Blue LED flashes twice
Power off	Red LED Flashes twice
Pairing mode	Red & Blue LED flashes alternately
Connected standby mode	Blue LED flashes once every 10 seconds
Playing Music	Blue LED flashes once every 10 seconds
Talking	Blue LED flashes once every 10 seconds
Clear pairing record	Red & Blue LED are solid on for 1 second
Charging	Solid Red Light
Full charged	Solid Blue Light
Low battery	Red light flashes

Dongle	
Mode	LED Indicator
Pairing	The red and blue LED flashes alternately
Reconnect	Blue LED flashes once every 1 second
Unconnected Standby	Blue LED flashes once every 5 seconds
Connected Standby	Solid Blue LED
Clear records	Red LED is solid on for 1.5 seconds

6. TTS Tone

Power on	Power on
Enter pairing mode	Pairing
Pair successfully	Paired(At the first time)
Connected	Your headset is connected
Disconnect	Your headset is disconnected
Power off	Power off
Microphone mute on	mute on
Microphone mute off	mute off
Low battery	Battery Low
ANC ON	ANC ON
ANC OFF	ANC OFF
TRANSPARENT MODE ON	TRANSPARENT MODE ON
TRANSPARENT MODE OFF	TRANSPARENT MODE OFF

6

7. Charging

- When the Red LED flashes or you heard "Battery low", Please charge the KH157M. It will take about 2 hours for charging. (The light will change to blue when fully charged.)
- Please connect to the KH157M charging port through the Type-C end of Type-C charging cable included in the package.

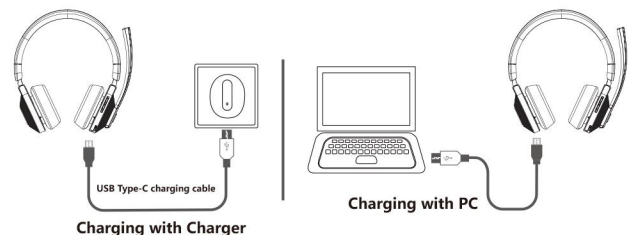

*Note:

- Please charge the headset every two month when the headset is not in use.
- Please use the charging cable in the package to charge the 157M headset.

Wired Connection:

The necessary conditions for using the wired function:

- Please use the cable included in the package.
- The wired cable connection must be used when the headset power on.
- The Bluetooth function and wired function cannot be used as the same time. If you want to use the headphones via the cable, please disconnect the Bluetooth connection first with your computer or cell phone or other devices. And all the buttons will not work when using the wired.

For example:

If you would like to listening to music via cable connection, please turn on the headset first and turn off the Bluetooth function on your computer first, then plug the cable included to your computer, and check the audio input and output. **NOTE: you couldn't adjust the volume or switch songs or play/pause music via the buttons.**

If you heard "battery low" during the meeting, you can changed to wired connection, first, please turn off the Bluetooth on your computer, then plug the Type-C to your computer, and check the audio input and output. **NOTE: you couldn't adjust the volume via the headset.**

7

8. Product Specification

Headphones	
Bluetooth Version	Bluetooth V5.2
Bluetooth Chipset	QCC3044
Operation Range	10 meters
Bluetooth Protocols	HSP HFP A2DP AVRCP
CODEC	aptx-HD aptx AAC SBC
Battery Type	400mAh/3.7V
Charging Time	About 2 hours
Music Time	About 50 hours (70% Volume)
Talk Time	About 25 hours (70% Volume)
Stand-by Time	About 400 hours
Headset Net Weight	About 203g
Headset Dimension	171.56*181.19*68.7mm
Call noise reduction effect	The maximum noise reduction depth is greater than 35db.
	Optimal noise reduction frequency band 200-1000Hz.
	The best noise reduction frequency band has a noise reduction depth greater than 35db. Effective noise reduction bandwidth 200-4000Hz.

Dongle	
Bluetooth Version	V5.3
Frequency Range	2.402-2.480GHz
Bluetooth Protocols	A2DP HFP AVRCP
Bluetooth Chipset	QCC3056
Operation Range	10 meters
Code	aptx-Adaptive, aptx-HD, aptx-L, aptx-SBC
Operating temperature	-10--55℃
Operating voltage range	4.5V-5.8V
Dimension	17.1*38*12mm
Net Weight	About 4.2g

*The above data are all from SKY WING laboratory, and the actual use time, environment and music will be different.

8

9. Frequently Asked Questions

A. How to reconnect and operation when failed to reconnect?

When "KH157M" connected with your phone successfully at the first time, it will search and reconnect the paired device automatically when power on next time.

If the connection is not successful, you can click the "KH157M" in the Bluetooth pairing list to connect.

B. How to clear paired records?

In power on status(no calls and no music), press and hold the MFB and Volume- for 5 seconds to clear the connections. The headset will not connect again automatically, please pair and connect again.

C. What devices could be used for charging the headphones?

Any car chargers, power banks, PC etc, which the DC 5V, charging current more than 500mA.

D.Why my computer can't hear anything?

Please check the sound setting if the audio input and output set as "KH157M" or "KH157M dongle", according to if you use the dongle or not.

10. Kind Tips

Some Tips about the KH157M Bluetooth headphones:

- For the protection of your hearing and comfort, it is recommended to wear it for no more than one hour at a time.
- Please find a suitable position according to your head shape. If the position is not suitable, it may slip off.
- If you feel uncomfortable at the beginning, please don't worry. It takes a few minutes to adapt.
- Please don't listen to music and make conference calls at the same time. The sound quality will be affected.
- If the device has Bluetooth function, please use Bluetooth connection first. For devices without Bluetooth function, please use dongle connection.
- Please charge the headset every two month when the headset is not in use.
- If any issues about our product, please don't hesitate to contact our after-sale service at support@suquatannic.com. We will try our best to assist you.

9

11. Warranty

We stand behind our products, 100%!

If you have any problem with your headset or need any help, we'd appreciate if you could **email us to let us know** so that we can help you solve the problem efficiently at the fastest speed and help you save time and money. Please don't hesitate to contact us via support@suquatannic.com

We'll respond within 24 hours and assist you further, even if the Amazon return window is closed or the product package is missing.

12. Register Your Product

Register your product & Protect your purchase for ever longer

Scan the QR code below to activate:

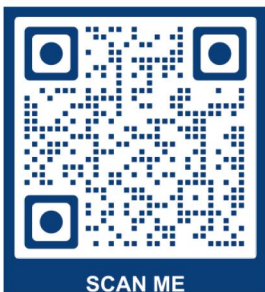

- Lifetime warranty extension
- Technical support for any issues

10

After-sale mailbox: support@suquatannic.com



MADE IN CHINA

封底

SIZE: 120X200MM

材质: 128克铜版纸

折叠 (手风琴式)

单黑印刷

过油

FCC Warning

This device complies with part 15 of the FCC Rules. Operation is subject to the following two conditions: (1) This device may not cause harmful interference, and (2) this device must accept any interference received, including interference that may cause undesired operation.

Any Changes or modifications not expressly approved by the party responsible for compliance could void the user's authority to operate the equipment.

Note: This equipment has been tested and found to comply with the limits for a Class B digital device, pursuant to part 15 of the FCC Rules. These limits are designed to provide reasonable protection against harmful interference in a residential installation. This equipment generates uses and can radiate radio frequency energy and, if not installed and used in accordance with the instructions, may cause harmful interference to radio communications. However, there is no guarantee that interference will not occur in a particular installation. If this equipment does cause harmful interference to radio or television reception, which can be determined by turning the equipment off and on, the user is encouraged to try to correct the interference by one or more of the following measures:

- Reorient or relocate the receiving antenna.
- Increase the separation between the equipment and receiver.
- Connect the equipment into an outlet on a circuit different from that to which the receiver is connected.
- Consult the dealer or an experienced radio/TV technician for help.

The device has been evaluated to meet general RF exposure requirement. The device can be used in portable exposure condition without restriction.

IC Warning

- English: This device contains licence-exempt transmitter(s)/receiver(s) that comply with Innovation, Science and Economic Development Canada's licence-exempt RSS(s). Operation is subject to the following two conditions:

1. This device may not cause interference.
2. This device must accept any interference, including interference that may cause undesired operation of the device.

- French: Cet appareil contient des émetteurs/récepteurs exemptés de licence qui sont conformes aux RSS exemptés de licence d'innovation, sciences et développement économique Canada. Le fonctionnement est soumis aux deux conditions suivantes:

1. Cet appareil ne peut pas causer d'interférences.
2. Cet appareil doit accepter toute interférence, y compris les interférences qui peuvent causer un fonctionnement indésirable de l'appareil.

Radiation Exposure Statement

The device has been evaluated to meet general RF exposure requirement. The device can be used in portable exposure condition without restriction.

L'appareil a été évalué pour répondre aux exigences générales d'exposition aux radiofréquences. L'appareil peut être utilisé en condition d'exposition portable sans restriction.