

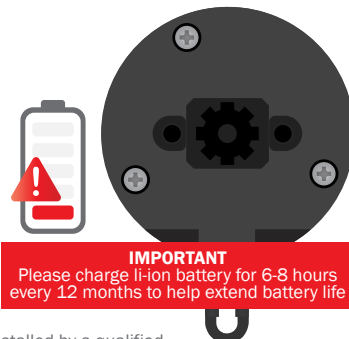

Programming Manual

25mm HC Li-ion Motor Wand Pull 1.1Nm
ZM-131

Rated Torque (Nm)	Rated Speed (Rpm)	Radio Frequency (mHz)	Voltage Supply (V)	Rated Power (W)	Battery Capacity (mAh)	Degree of Protection (IP)	Maximum Limit Turn (turn)	Working Temperature (°C)
1.1	28	N/A	8.0	9.6	4000	IP20	∞	-10~60°C



Thank you for choosing our products. Please read this manual carefully before installing and programming the motor. The motor must be installed by a qualified installer in home automation systems, in accordance with instructions from Z-Motion and within the required applicable country laws and regulations. Any use of the motorization outside of the scope previously described is forbidden and failing to follow the instructions correctly contained in this manual, any liability and warranty becomes void from Z-Motion.

This device has been tested and found to comply with the limits for a Class B digital device, pursuant to Part 15 of the FCC Rules. These limits are designed to provide reasonable protection against harmful interference in a residential installation. This device generates, uses and can radiate radio frequency energy and, if not installed and used in accordance with the instructions, may cause harmful interference to radio communications.

However, there is no guarantee that interference will not occur in a particular installation. If this device does cause harmful interference to radio or television reception, which can be determined by turning the device off and on, the user is encouraged to try to correct the interference by one or more of the following measures:

- Reorient or relocate the receiving antenna
- Increase the separation between the device and receiver
- Connect the device into an outlet on a circuit different from that to which the receiver is connected
- Consult the dealer or an experienced radio/TV technician for help

Changes or modifications not expressly approved by the party responsible for compliance could void the user's authority to operate the equipment.

PAIRING A MOTORIZED BLIND WITH PULLING WAND

Wand Control

IMPORTANT, PLEASE READ PRIOR TO OPERATION: Persons with reduced mental capacity, or lack of experience and knowledge should not be allowed to use this product. Keep pulling wand away from children. Frequently inspect for improper operation. Do not use if repair or adjustment is necessary.

NOTE

By default, all motors are set to Step Mode.

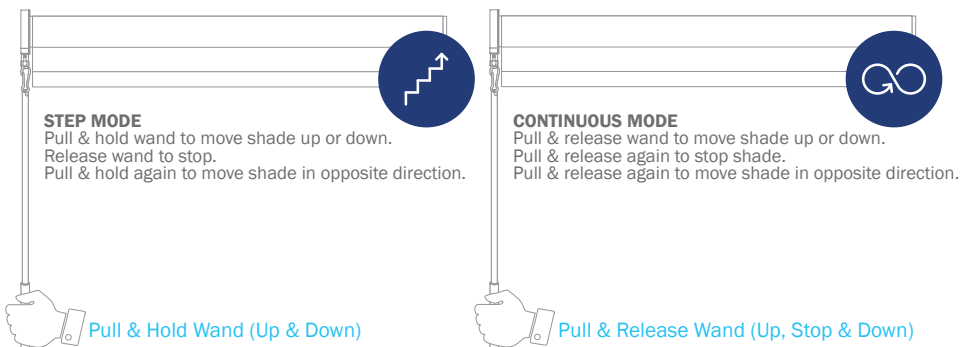

1

Switch motor **ON**, and press and hold **SETTING** button until motor beeps twice. The motor is now in limit setting mode.

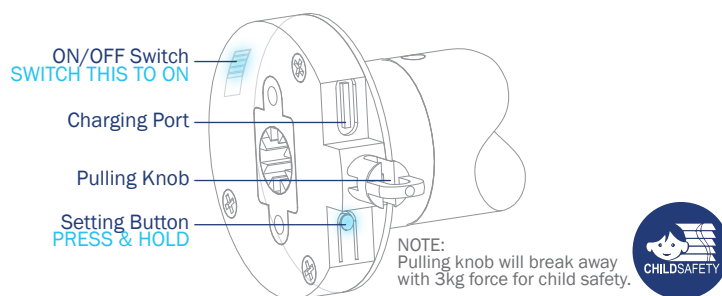

2

Pull wand to test direction. If shade is moving downward, continue to hold until shade is in desired lower limit position. If shade is moving upward, release wand and pull again – continue to hold until shade is in desired lower limit position. Press **SETTING** button one time to confirm and motor will beep twice.

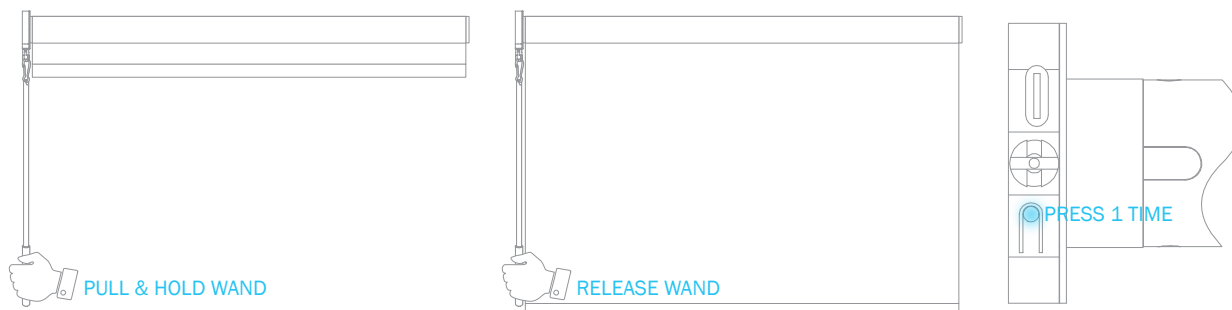

- 3** Pull wand to test direction. If shade is moving upward, continue to hold until shade is in desired upper limit position. If shade is moving downward, release wand and pull again – continue to hold until shade is in desired upper limit position. Press **SETTING** button one time to confirm and motor will beep 4 times.

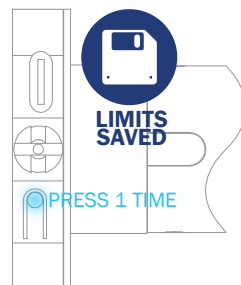

- 4** To switch to Continuous Mode, press **SETTING** button 6 times – motor will beep 2 times. To switch back to Step Mode, press **SETTING** button again 6 times – motor will beep 4 times.

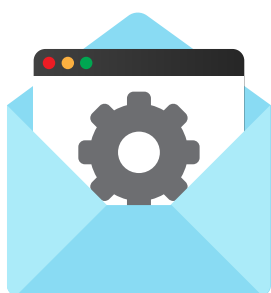
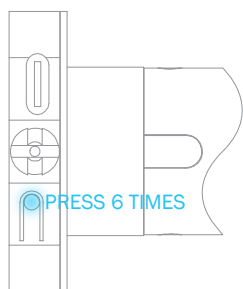

Z-Motion Technical
Support Email:
zmotioncustomerassist@gmail.com

For App Programming
Instructions, please scan
the QR code and follow
the online instructions

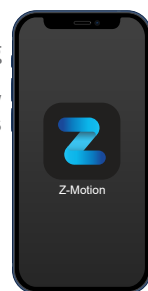

FCC Statement:

This device complies with part 15 of the FCC Rules. Operation is subject to the following

two conditions:

(1) This device may not cause harmful interference, and

(2) this device

must accept any interference received, including interference that may cause undesired operation. This equipment has been tested and found to comply with the limits for a Class B digital

device, pursuant to part 15 of the FCC Rules. These limits are designed to provide reasonable protection against harmful interference in a residential installation. This equipment generates, uses and can radiate radio frequency energy and, if not installed and used in accordance with the

instructions, may cause harmful interference to radio communications. However, there is no guarantee that interference will not occur in a particular installation. If this equipment does cause harmful interference to radio or television reception, which can be determined by turning the

equipment off and on, the

user is encouraged to try to correct the interference by one or more of the following measures:—Reorient or relocate the receiving antenna.

—Increase the separation between the equipment and receiver.

—Connect the equipment into an outlet on a circuit different from that to which the receiver is connected.

—Consult the dealer or an experienced radio/TV technician for help.

Caution: Any changes or modifications not expressly approved by the party responsible

for compliance could void the user's authority to operate the equipment.