

# Translator

## S3 Instruction manual

### 1. Appearance and function instructions of Bluetooth device



- ① Magnetic charging port  
Provides magnetic charging function.
- ② Voice control key  
When the device is connected, long press the control key to use the voice translation and text-to-text functions.  
When sleeping, press the control key to wake up the device.
- ③. Indicator light  
Hibernation/Standby: Lights off  
Bluetooth Not Connected: Flashing Green Light  
Bluetooth connection successful: Green light flashes three times quickly .  
While charging, the red light is always on; when fully charged, the red light turns off.

1

### 2. Product usage process

1. Download APP:The device needs to be used together with the APP.  
Method 1: Scan the QR code, download and install the “TT-Talk” APP;  
Method 2: You can search for “ TT-Talk ” in major app stores to install it.

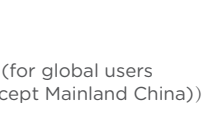

Android Scan Code Download

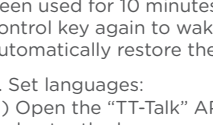

iOS Scan Code Download

( for global users except Mainland China))

2. Connect Bluetooth device:  
(1) Press the Voice control key of the device to wake up the device.At the same time, the device flashes the green light;  
(2) Open “Settings” > “Bluetooth” on your phone, turn on Bluetooth and search for devices, select “ TT-Talk xxxxxx ” from the device list to pair and connect your phone. After the Bluetooth connection is successful, the device will flash the green light three times.

2

- (3) Return to the “ TT-Talk ” APP, the device and the APP will be automatically connected successfully, the “Device not connected” prompt at the top will disappear promptly, and you can start using it.

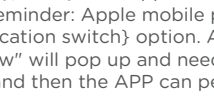

Important reminder: The device will enter sleep mode if it has not been used for 10 minutes. You only need to press the Voice control key again to wake up the device, and the device will automatically restore the connection with your phone.

3. Set languages:  
(1) Open the “TT-Talk” APP installed on your mobile phone and enter the homepage;  
(2) Click a language such as“Chinese (Simplified)” on the left and set it as the source language for the APP to recognize ;  
(3) Click a language such as“English(United States)” on the right and set it as the target language for the APP to translate.



3

- 4.One-click cross-application translation and automatic pasting of the translated contents:  
(1) On the homepage of the “ TT-Talk ” APP, turn on {Translate}, {Read aloud}, and {Cross-application switch};  
Important reminder: Apple mobile phone users must turn on the {cross-application switch} option. After turning it on, the “video small window” will pop up and need to be slidden to the edge of the screen and then the APP can perform the function of pasting texts of across-application automatically! (Android phone users do not have this option and can simply ignore it, because Android supports automatic pasting texts of across-application by default.)  
(2) In the App, or any third-party software to be switched to such as WeChat, QQ, WhatsApp, email, memo and so on.),click the text input box, then press and hold the voice control key of the device, speak a sentence to your phone, release the voice control key after speaking, and the text will immediately appear in the text box. The sample is as follows:

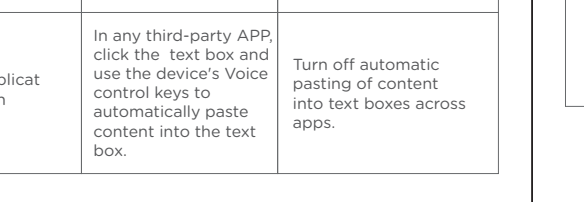

4

### Description of custom options:

Options	Turn On	Turn Off
Translate	Voice translation mode (long press the Voice control keys,speak a sentence to the phone, and the system will automatically translate it into the target language).	Voice-to-text mode (press and hold the Voice control Key and then speak a sentence to the phone, and the system will automatically convert it into text).
Read aloud	Automatically read translations aloud.	Translations are not automatically read
Only show translations	Only display the translation, not the original text.	Display both the translation and its original text.
Cross-application switch (iPhone)	In any third-party APP, click the text box and use the device's Voice control keys to automatically paste content into the text box.	Turn off automatic pasting of content into text boxes across apps.

5

### 3. App cross-application functions

Scenes	Steps
Required steps: Before using the function, open the APP (set language)+ turn on {Translate, Read aloud, cross-application switch}	
Send text messages to foreign friends	(In the chat interface) Click and go into the text input box, press and hold the Voice control key without being let go. After speaking a sentence to the phone, release the Voice control keys. The system will automatically paste the original text and its translation into the input box and you just send it with one click.

6

### 4. App's popular functions

1. Conversation translation: When communicating face-to-face with foreign friends, you can easily use their native language, and the system will instantly translate the conversation content into the other party's language.
2. Simultaneous interpretation: Start with one click in meetings, business, negotiations and other occasions. It can not only serve as a simultaneous interpreter to meet the needs of multi-language communication, but also can be used as a powerful assistant for meeting minutes to achieve more efficient information recording.
- 3.Voice & video call translation: Provide real-time translation services in various scenarios such as global business and remote cooperation, and display bilingual subtitles at the same time to ensure smooth communication and promote cross-language cooperation.
4. Camera translation: When you are abroad, you can instantly interpret street signs, menus, books, homework, etc. with just a snap, eliminating the trouble of translation and allowing you to easily enjoy the convenience and worry-free study and travel abroad.

8

### 5. Installation method

- Please tear off the adhesive-backed centrifuge paper and stick the device to the back of the phone case .If you want to remove the device from your phone case , spray a little alcohol on the adhesive surface and easily tear the device and the device fall off from the case without any glue left. Good looking and easy to carry! It can also be used as a mobile phone stand!

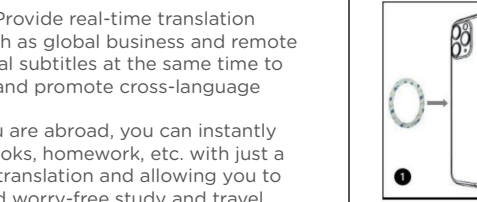

9

### 6. Attachment list

The device, charging cable, back glue film(back-up) and instruction manual.

9

### 7. Safety information

- Before using this product, please read the following safety information.
1. Do not charge with a damaged or untested charger to avoid fire, explosion or other dangers; After the charging cable is connected to the power , it is not permitted to be placed on the metal surface, which will cause a short circuit to damage the service life of the charging cable and even cause a fire.
2. Please keep the device and all accessories out of the reach of children to avoid being swallowed by them and causing suffocation or other risks;
3. The device is not waterproof, please keep it away from any liquid;
4. Please avoid dropping, burning or squeezing the device to avoid damage;
5. Do not expose the product to high temperatures or around heating equipment such as ovens, microwave ovens, etc.;
6. Our company is not responsible for quality problems, equipment failures and safety accidents caused by the use of unofficially approved accessories.

10

### Product warranty card

Dear user:  
Thank you for choosing our company's products. In order to provide you with warranty service, please fill out this card carefully so that you can use this card for future repairs. This voucher is an important basis for the three guarantees of the product, please keep it properly.

Name: \_\_\_\_\_  
·Contact number: \_\_\_\_\_  
·Product Name/Model: \_\_\_\_\_  
·Purchase date: \_\_\_\_\_  
·Purchase location: \_\_\_\_\_  
·Device MAC: \_\_\_\_\_

11

### Warranty instructions

- 1.Please keep this card properly. This card and proof of purchase are required for warranty purposes.
2. From the date of purchase, if the product is used normally in accordance with the product instructions, it will be repaired free of charge if it breaks down within one year.
3. The following situations are not within the scope of free services, but paid maintenance services are available:  
(1) Warranty cards and invoices cannot be produced.  
(2) Alteration of invoice.  
(3) Damage caused by accidental factors or improper use.  
(4) Damage caused by repairing by yourself without our permission.
- (5) If the three-pack validity period has expired, it can still be used after repair.
4. For products that have exceeded the warranty period, our company will continue to provide you with paid services.

12

### FCC Caution:

This device complies with part 15 of the FCC Rules. Operation is subject to the following two conditions: (1) This device may not cause harmful interference, and (2) this device must accept any interference received, including interference that may cause undesired operation.

Any changes or modifications not expressly approved by the party responsible for compliance could void the user's authority to operate the equipment.

NOTE: This equipment has been tested and found to comply with the limits for a Class B digital device, pursuant to Part 15 of the FCC Rules. These limits are designed to provide reasonable protection against harmful interference in a residential installation. This equipment generates, uses and can radiate radio frequency energy and, if not installed and used in accordance with the instructions, may cause harmful interference to radio communications. However, there is no guarantee that interference will not occur in a particular installation.

If this equipment does cause harmful interference to radio or television reception, which can be determined by turning the equipment off and on, the user is encouraged to try to correct the interference by one or more of the following measures:

-- Reorient or relocate the receiving antenna.  
-- Increase the separation between the equipment and receiver.

13

- Connect the equipment into an outlet on a circuit different from that to which the receiver is connected.  
-- Consult the dealer or an experienced radio/TV technician for help.
- The device has been evaluated to meet general RF exposure requirement. The device can be used in portable exposure condition without restriction.

14

