

1 Download the App



2 Unbox and Prepare Components

Included in the Box

- Titan Smart Folding Lock
- CR2 Battery
- Allen Key
- Mounting Bracket
- 2 Bracket Straps
- 2 Screws
- 2 Mechanical Keys
- Pairing Tool

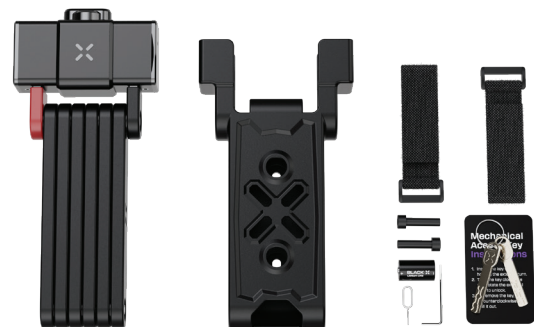

3 Prepare for Activation

1. **Unlock the folding arm:** Insert the mechanical key into the cylinder and hold the knob firmly while turning the key clockwise. Turn the knob clockwise to open the lock. Then, turn the key counterclockwise and remove it.

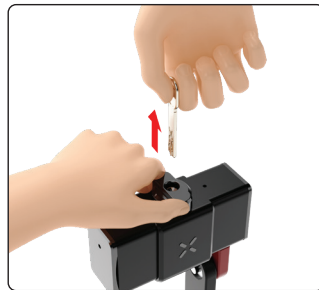
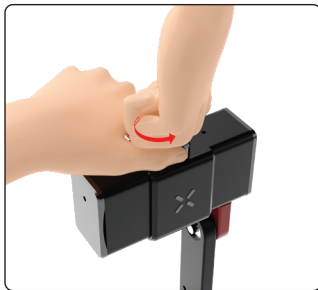
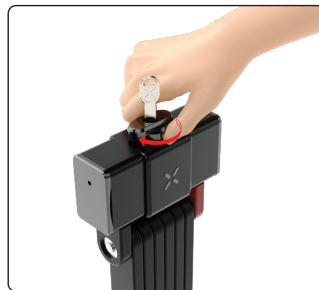
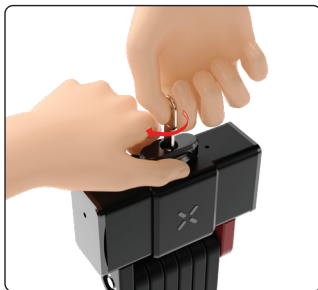

2. **Release the folding arm:** Pull out the unanchored end of the folding arm from the smart lock body.



4 Activating the Smart Device

1. Unlock the battery compartment:

- Locate the designated screw hole: Turn the smart device upside down and locate the small screw hole at the bottom of the smart device.
- Insert an Allen key into the screw and turn it counterclockwise until the screw is fully removed.
- Once you have removed the first Allen screw, you will find a second screw located at the bottom of the lock, where the folding arm was removed. Locate this screw and insert a Phillips screwdriver into the socket, then turn it counterclockwise until the internal screw is fully removed.

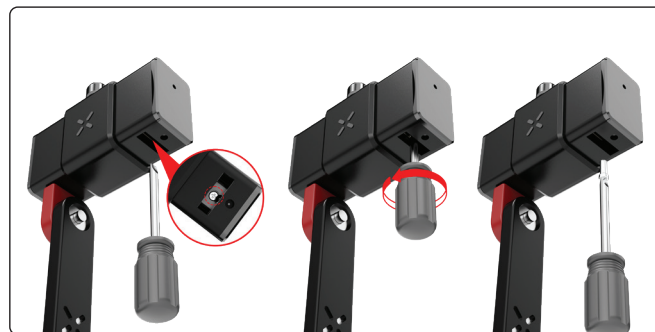
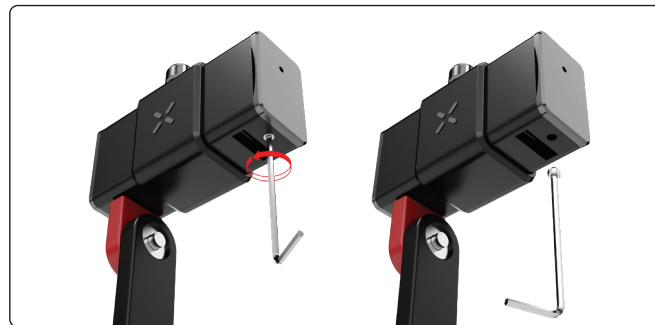

2. **Remove the top cover:** Grip the outer edge and pull the internal battery compartment straight out from the smart device.

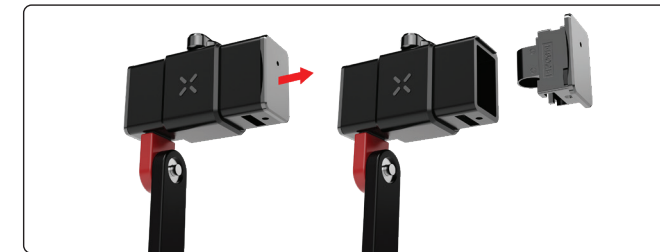

3. **Insert the CR2 battery:** Align the "+" end of the battery with the "+" marking in the compartment, then slide it fully into place.



4. **Reinstall the battery compartment:** Position the battery compartment back into its original recess, ensuring it sits flush.

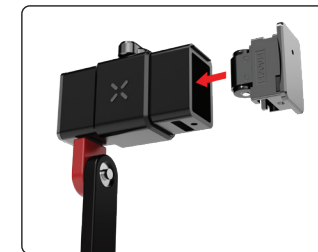

5. **Tighten the internal screw:** Use a Phillips screwdriver to reinsert and tighten the inner screw clockwise to secure the battery compartment.

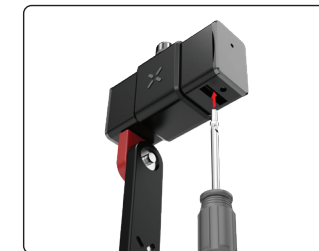

6. **Reinsert the outer screw:** Insert the outer screw into the top hole using an Allen key and turn clockwise until fully tightened.



7. **Reinsert the folding arm:** Align the unanchored end of the folding arm with the slot at the base of the smart lock, then push it firmly into place.



8. **Lock the device:** Once the folding arm is in place, turn the knob counterclockwise to lock it securely.

Note: Always ensure the folding arm clicks firmly into the locked position.



5 Pairing the Lock with BLACK X App

1. Ensure Bluetooth is enabled on your smartphone.
2. Download BLACK X app and register an account.
3. From the main menu, tap on "Install New Lock".
4. Name your lock or select "Bike Lock" from the pre-named list below, and assign it to a home.
5. While in "Discovering Nearby Locks" mode in the BLACK X App, insert the pairing tool into the pairing-button recess on the underside of the smart device and press firmly to start pairing.
6. When the correct lock appears in the pop-up, tap "Connect" to proceed.
7. Congratulations! Your BLACK X Smart Lock is now connected.

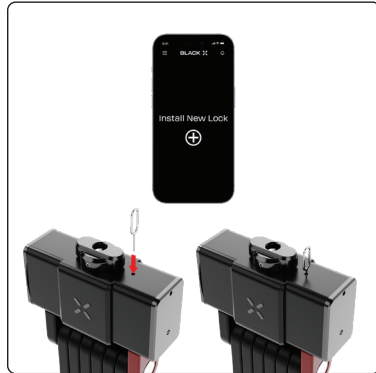

6 Test Functionality

1. Open the BLACK X app and tap the Unlock button.
2. Within 6 seconds, turn the knob clockwise to unlock the lock.
3. Confirm that the lock opens smoothly.
4. **Lock the Lock:** Ensure the folding arm is fully and correctly inserted into the lock body. Then, turn the knob counterclockwise to lock the mechanism securely.

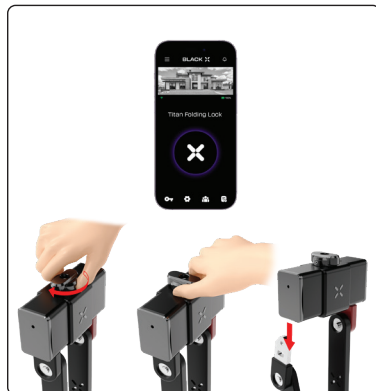

7 Online Instructions

Need help with installation
or have questions?



www.black.inc

Optional - Pairing xKey for Additional Unlocking Method

1. From the main menu, select your lock and tap the settings icon ⚙️.
2. Select "xKey remote" and then tap "Add xKey".
3. Choose the relevant period for authorized access: Timed, Unlimited, or Recurring.
4. Enter the authorized user's details (first name, last name, and the relevant period, if applicable), then select Continue.
5. Activate the BLACK X xKey by pressing and holding the unlock button for 5 seconds.
6. Select the relevant xKey from the list.
7. Congratulations! You have successfully paired your BLACK X xKey.



Using the xKey:

To unlock the lock with the xKey, simply press the button on the xKey within a 2-meter (6 ft) range. The lock will engage the unlock function, just turn the knob clockwise and remove the folding arm.

Note: The xKey is not required to lock the device. Ensure the folding arm is fully and correctly inserted into the lock body. Then, turn the knob counterclockwise to lock the mechanism securely.

FCC Statement

This device complies with part 15 of the FCC Rules. Operation is subject to the following two conditions: (1) This device may not cause harmful interference, and (2) this device must accept any interference received, including interference that may cause undesired operation.

Note: This equipment has been tested and found to comply with the limits for a Class B digital device, pursuant to part 15 of the FCC Rules. These limits are designed to provide reasonable protection against harmful interference in a residential installation. This equipment generates, uses and can radiate radio frequency energy and, if not installed and used in accordance with the instructions, may cause harmful interference to radio communications.

However, there is no guarantee that interference will not occur in a particular installation. If this equipment does cause harmful interference to radio or television reception, which can be determined by turning the equipment off and on, the user is encouraged to try to correct the interference by one or more of the following measures:

- Reorient or relocate the receiving antenna.
- Increase the separation between the equipment and receiver.
- Connect the equipment into an outlet on a circuit different from that to which the receiver is connected.
- Consult the dealer or an experienced radio/TV technician for help.

Note: The Grantee is not responsible for any changes or modifications not expressly approved by the party responsible for compliance. Such modifications could void the user's authority to operate the equipment. The device has been evaluated to meet general RF exposure requirement.

This equipment complies with FCC's RF radiation exposure limits set forth for an uncontrolled environment. This device and its antenna(s) must not be co-located or conjunction with any other antenna or transmitter.

