

M-A25新说明书

折页尺寸: 19 X 39 CM

注意: 红边虚线为拆线位置 实际制作时需要去掉

Quick Installation Guide

Product Name : WIFI Extender
Product Name : M-A25

LED Explanation

Icon	Indication	Status
	POWER LED	NO: The device is power on OFF: The Device is not resolving electrical power
	WLAN LED	Wireless signal
	WPS LED	Flashing: WPS connection is established or WPS signal of another device is expected NO: The LAN port is connected OFF: The LAN port is disconnected Flashing: Transferring data to/from a network device
	LAN LED	

Button Explanation

WPS Button: If your host router supports WPS function, you can press the WPS button and then press the WPS button of the WPS button of the WIFI Repeater to establish a secure connection between the host router and the WIFI Repeater.
Reset Button: This button is used to restore The Repeater's factory default settings.
LAN Port: One 10/100Mbps RJ45 Ethernet port is used to connect an Ethernet-enabled device to a Wi-Fi network, such as Internet TV, DVR, Gaming console and so on. Please note that this port cannot be connected to a router.

REV.2.0

Quick Installation

Working mode Diagram

Note: If you need to connect the network cable, please connect the network cable after the configuration is completed.

Repeater Mode: As a wireless signal extender

A. Extend your Wi-Fi signal without using any cables to reduce wiring troubles.



B. Extend your Wi-Fi signal with a cable, connect your device and extender stably.



AP Mode: As a wired signal extender (access point)

Get better WiFi speed by connecting the router and the extender with network cable in the poor WiFi signal area.



— 1 —

Quick Installation Guide

When the machine work normally, use the mobile phone to search and connect to Repeater-XXXXXX.
(XXXX is the last 6 numbers of the repeater MAC address)

Note: If the mobile phone does not automatically jump to setting page after connecting, please click "forget" the wifi name that has been connected on the mobile in wifi manager, turn off the wifi and then reopen the wifi to search it, or input "192.168.11.1".

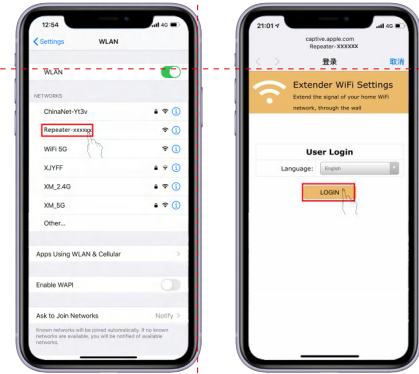

— 2 —

Wi-Fi Repeater mode setup

Step1: Click repeater mode to enter the network search page.

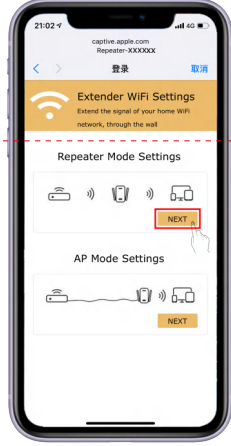

— 3 —

AP mode Setting

Step1: Click to Select "AP" mode to enter the setting page.

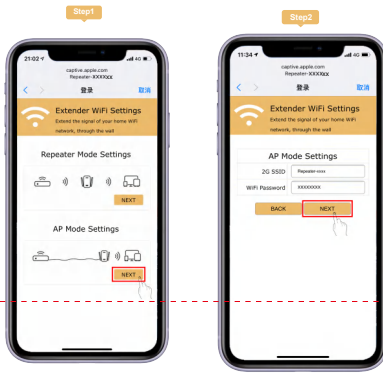

— 6 —

FAQ (Frequently Asked Questions)

Q1: What should I do if I cannot access the Repeater's web management page?

- A1: Make sure your computer is connected to the extended network.
- A2: Make sure your computer is set to obtain an IP address automatically.
- A3: If the Repeater has connected to the router, you should go to your router's DHCP client list to obtain the Repeater's current IP address.
- A4: Reset the Repeater.

Q2: Why does the wireless transmission rate speed down, when the wireless signal is stronger after repeated by the Repeater?

A1: In compliance with the wireless transmission protocol, all the Repeater devices are set to work in half-duplex instead of full-duplex mode. In other words, the Repeater has to process one-way communication between your root Wireless router (or AP) and the terminal clients; so the transmission time will be double-increased, while the speed will be decreased. Recommends that you connect to the extender when your home network connection is poor, or when you want a larger wireless coverage to eliminate "dead zones".

Q3: Why the devices connected to the Repeater cannot get an IP address from the Repeater and cannot access the Internet?

- A1: Maybe you enabled a wireless MAC filter, wireless access control, or access control list (ACL) on your router. To solve this problem, please log into your router and disable the MAC filter, wireless access control or ACL.
- A2: Maybe the Repeater has not been successfully connected to your router, please reset the Repeater and Reconfiguration.
- A3: Maybe the IP address of the router is occupied or the wireless device connected by the router has reached the limit. please reboot your router, then reset the Repeater and Reconfiguration.

— 8 —

快速安装指南

指示灯说明

图标	作用	状态
	电源指示灯	接通电源指示灯常亮
	WiFi指示灯	工作正常时灯常亮
	WPS指示灯	快闪连接中, 慢闪连接成功
	网口指示灯	常亮: 局域网端口连接正常 闪烁: 数据传输

按钮说明

WPS按钮: 如果您的主机路由支持WPS功能, 您可以按WPS按钮, 然后按WiFi中继器的WPS按钮, 在主机路由器和WiFi中继器之间建立安全连接。

重置按钮: 此按钮用于恢复中继器的工厂默认设置。重置中继器的启动, 使用一个复位针/针按下并持续8秒。

局域网口: 一个10/100Mbps RJ45以太网端口用于启用以太网网络, 如互联网电视、DVR、游戏控制台等等。请注意, 此端口不能连接到路由器。

REV.2.0

快速安装手册

工作模式示意图

注意事项: 如果需要接网线, 请在中继器设置之后再接插网线, 避免设置之前接插网线导致设置异常。

中继模式: 作为一个无线信号扩展器

A. 在不使用任何网线的情况下扩展你的Wi-Fi信号, 减少布线的麻烦, 但不能优化Wi-Fi速度



B. 在不使用网线的情况下扩展你的Wi-Fi信号, 通过网线让PC与扩展器建立稳定连接, 但不能优化Wi-Fi速度



AP模式: 作为一个有线信号扩展器 (接入点)

在Wi-Fi信号较差的位置, 为获得更好的Wi-Fi速度, 可用以太网线将路由器与扩展器连接起来



— 1 —

快速操作说明

当机器进入开机状态时, 使用手机通过WiFi搜索连接Repeater-XXXXXX, 点击连接后会跳转到设置页面。

(XXXXXX 是中继器MAC地址的最后6个数字)

注意: 如果手机点击连接后, 不会自动跳转到设置页面, 请点击 "忘记此网络" 然后点击 "关闭" 关闭WiFi, 然后点击 "重新连接" 重新连接WiFi, 若此操作仍然无效, 可在设置中手动输入地址 "192.168.11.1".

进入管理员登录界面后, 可选择语言: 中文 (简体)



— 2 —

中继模式设置

第一步: 选择 "中继模式配置" 并点击 "下一步" 进入网络信号搜索页面



— 3 —

第二步: 选择要扩展的无线信号, 点击连接; 如果是隐藏网络, 需要手动添加

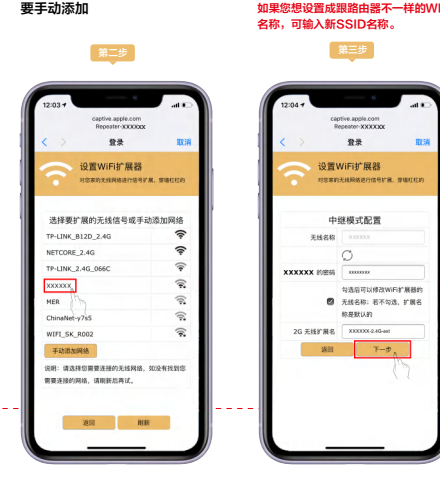

— 4 —

第三步: 输入你的路由器密码和 password with more than 8 digits (the wireless name and password can be set according to personal preference).



— 5 —

第四步: 点击 "完成配置" 按钮, 完成中继模式配置 (扩展器的WiFi密码与路由器的默认密码一致)



— 6 —

AP模式设置

第一步: 选择 "AP模式配置" **第二步:** 设置无线名称和8位数密码, 点击 "下一步" 进入设置 (无线名称和密码可以根据个人喜好进行设置)



— 6 —

FAQ (常见问题解答)

Q1: 如果不能访问Repeater的网页管理页面, 我该怎么办?

- A1: 确保您的计算机连接到此扩展网络设备上。
- A2: 确保您的计算机设置为自动获取IP地址。
- A3: 如果中继器已连接到路由器, 则应转到路由器的DHCP客户端列表以获得中继器的当前IP地址。
- A4: 重新设置中继器。

Q2: 为什么无线传输速率下降, 而无线信号在重启后更强?

A1: 在符合无线传输协议中, 所有中继器设备都设置为半双工工作, 而不是全双工模式, 换句话说, 中继器处于跟无线路由器 (或AP) 和终端客户端之间的单向通信; 因此传输时间将加倍增加, 而速度将降低。当你的家庭网络连接很差, 或者当你想要一个更大的无线覆盖来消除 "死区" 时, 建议您重启扩展器。

Q3: 为什么连接到中继器的设备无法从中继器获得IP地址, 无法访问Internet?

- A1: 也许您的上级路由器上启用了无线MAC过滤器、无线访问控制或访问控制列表。为了解决这个问题, 请登录到您的路由器, 并禁用MAC地址过滤, 无线访问控制或移除控制列表。
- A2: 中继器还没有成功地连接到您的路由器, 请重置中继器和重新配置。
- A3: 路由器的IP地址被占用了, 或者路由器连接的无线设备已经达到极限, 请重新启动路由器, 然后重置中继器和重新配置。

— 7 —

— 8 —

正面 英文

背面 中文

FCC Caution:

This device complies with part 15 of the FCC Rules. Operation is subject to the following two conditions: (1) this device may not cause harmful interference, and (2) this device must accept any interference received, including interference that may cause undesired operation. Any changes or modifications not expressly approved by the party responsible for compliance could void the user's authority to operate the equipment.

NOTE: This equipment has been tested and found to comply with the limits for a Class B digital device, pursuant to Part 15 of the FCC Rules. These limits are designed to provide reasonable protection against harmful interference in a residential installation. This equipment generates, uses and can radiate radio frequency energy and, if not installed and used in accordance with the instructions, may cause harmful interference to radio communications. However, there is no guarantee that interference will not occur in a particular installation. If this equipment does cause harmful interference to radio or television reception, which can be determined by turning the equipment off and on, the user is encouraged to try to correct the interference by one or more of the following measures:

- Reorient or relocate the receiving antenna.
- Increase the separation between the equipment and receiver.
- Connect the equipment into an outlet on a circuit different from that to which the receiver is connected.
- Consult the dealer or an experienced radio/TV technician for help.

To maintain compliance with FCC 's RF Exposure guidelines, This equipment should be installed and operated with minimum distance between 20cm the radiator your body: Use only the supplied antenna.