

CLEMM
User Manual

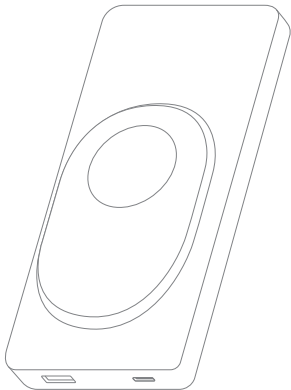

Wireless Power Bank
Clemm Source 10,000 mAh

Model CEB-10WR

What's in the box:
Power bank – 1 unit,
USB Type-C charging cable – 1 unit,
user manual – 1 unit

Contents

1. Safety Precautions
2. External Features
3. Specifications
4. Charging Your Power Bank
5. Charging a Device with a Cable
6. Charging a Device Wirelessly
7. MagSafe Wireless Charging
8. Power Bank Charge Indicator
9. Powering On and Off
10. Disposal and Additional Information

1. Safety Precautions

1. Fully charge the power bank before its first use. A new power bank requires 2 to 3 charge–discharge cycles to reach its maximum capacity.
2. Use a power supply with an output of at least 5 V/1 A to charge the power bank.
3. To extend the battery life of your power bank, charge it at least once a month, even if you're not using it.
4. The typical lifespan of the power bank is 800 charge–discharge cycles. After this, the power bank's effective capacity may decrease.
5. Use a cable with the correct specifications to charge the power bank. Using the wrong cable can affect the charging speed and potentially damage the power bank's battery.
6. To disconnect the cable from the power bank, grasp the plug, not the cord.
7. Do not store or charge the power bank near heat sources or flammable materials. The recommended operating temperature is 0°C to +40°C (32°F to 104°F).
8. Do not expose the power bank to direct sunlight for extended periods.
9. Do not subject the power bank to impacts and mechanical shocks. Do not disassemble or repair the power bank yourself. Any modifications will void the manufacturer's warranty. Contact an authorized service center to repair the power bank.
10. Prevent moisture, dust, and dirt from entering the power bank, and do not immerse it in liquid.
11. Keep the power bank out of reach of children. Adult supervision is required when charging the power bank.
12. Do not insert foreign objects into the power bank's ports. Contact between the power bank and metal objects can cause a short circuit and malfunction.

13. Clean the power bank with a dry, soft cloth. Do not use cleaning agents or detergents.
14. Do not charge devices that are USB incompatible or do not meet the power specifications.

2. External Features

1. MagSafe charging area
2. USB Type-A port
3. USB Type-C port
4. Power bank charge indicator
5. Power button

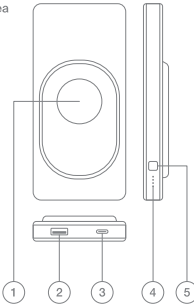

3. Specifications

CLEMM SOURCE 10,000 mAh with MagSafe wireless charging,
Graphite CEB-10WR-GRY

CLEMM SOURCE 10,000 mAh with MagSafe wireless charging,
Milk CEB-10WR-IVR

CLEMM SOURCE 10,000 mAh with MagSafe wireless charging,
Lavender CEB-10WR-LVN

Battery type: lithium polymer

Capacity: 10,000 mAh

Input voltage:

USB-C (PD)	5 V=2.4 A; 9 V=2.22 A; 12 V=L67 A
------------	-----------------------------------

Output voltage:

USB-C (PD)	5 V=2.4 A; 9 V=2.22 A; 12 V=L67 A
------------	-----------------------------------

USB-A (QC)	5 V= 3A; 9 V=2 A; 12 V=L5 A
------------	-----------------------------

Maximum power: 20 W

Charging 2 devices simultaneously: 5 V=2.4 A (12 W)

Maximum wireless charging power: 10 W

Supported wired device charging protocols:
PPS/PD3.0/PD2.0, QC3.0/QC2.0, AFC, FCP, High-Voltage
SCP, PE2.0/PE1.1, SFCP

Supported wired power bank charging protocols:
PD3.0/PD2.0, AFC, FCP, PE1.1

Wireless charging output varies depending on the device.

4. Charging Your Power Bank

The power bank may be partially charged out of the box, but it should be fully charged before its first use.

Connect the charging cable to a power source (wall outlet or computer) first and then to the power bank's USB-C port.

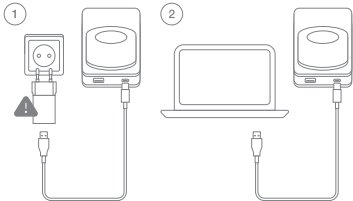

Note: Power adapter is not included.

While the power bank is charging, the charge indicator will display one of the following:

State	Power bank charge indicator
Charging in progress	Charge level
Fully charged	Indicator off

Note: To prevent overheating, the indicator will turn off if the power bank's temperature exceeds the safe operating range during charging. Unplug the device and let it cool down completely before resuming charging.

5. Charging a Device with a Cable

To charge an external device using a USB cable, connect the USB Type-A or USB Type-C end of the cable to the appropriate port on the power bank and connect the other end of the cable to the device you want to charge.

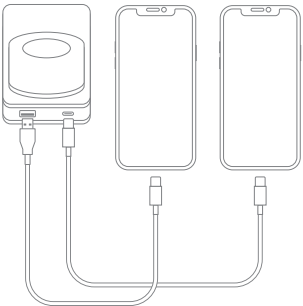

While the power bank is charging, the charge indicator will display one of the following:

State	Power bank charge indicator
Charging in progress	Charge level
Fully charged	Indicator off

6. Charging a Device Wirelessly

To wirelessly charge an external device, place the device on top of the power bank, ensuring the area with the wireless charging coil on the device aligns with the circular area marked on the power bank's surface.

Wireless charging will start automatically once the compatible device is correctly placed on the power bank.

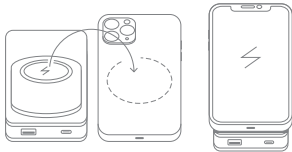

The wireless charging indicator will display one of the following states:

State	Power bank charge indicator
Wireless charging activated	Charge level
Charging in progress	Charge level
Fully charged	Indicator off

7. MagSafe Wireless Charging

When wirelessly charging an iPhone 12 or later, the smartphone will be securely held in place by the MagSafe magnet.

8. Power Bank Charge Indicator

1. During power bank charging:

Indicator	Power bank battery charge
• • • •	Fully charged
• • • ◦	75~100%
• • • ◦ x	50 ~75%
• ◦ x x	25 ~ 50%
◦ x x x	Below 25%

2. During device charging:

Indicator	Power bank battery charge
◦ x x x	Below 3%
x x x x	Fully discharged

LED state symbols

•	LED on
◦	LED flashing
x	LED off

9. Powering On and Off

The power bank will automatically turn on when connected to external devices or a charger, and the LED indicators will light up.

The power bank will automatically turn off when external devices (or the charger) are disconnected or fully charged.

10. Disposal and Additional Information

Once the power bank's battery reaches the end of its service life, dispose of it according to local regulations or recycle it at a certified collection point.

The specifications provided in this user manual may differ from the actual performance of the device.

The manufacturer may make changes to this user manual without prior notice.

The images used in this user manual are for illustrative purposes only. All registered trademarks are the property of their respective owners.

Address: 100 Peck Seah street #10-18 PS100, 079333 Singapore
E-mail: support@univent-engineering.com

FCC Statement

This equipment has been tested and found to comply with the limits for a Class B digital device, pursuant to part 15 of the FCC Rules. These limits are designed to provide reasonable protection against harmful interference in a residential installation. This equipment generates, uses and can radiate radio frequency energy and, if not installed and used in accordance with the instructions, may cause harmful interference to radio communications. However, there is no guarantee that interference will not occur in a particular installation. If this equipment does cause harmful interference to radio or television reception, which can be determined by turning the equipment off and on, the user is encouraged to try to correct the interference by one or more of the following measures:

- Reorient or relocate the receiving antenna.
- Increase the separation between the equipment and receiver.
- Connect the equipment into an outlet on a circuit different from that to which the receiver is connected.
- Consult the dealer or an experienced radio/TV technician for help.

Caution: Any changes or modifications to this device not explicitly approved by manufacturer could void your authority to operate this equipment.

This device complies with part 15 of the FCC Rules. Operation is subject to the following two conditions: (1) This device may not cause harmful interference, and (2) this device must accept any interference received, including interference that may cause undesired operation.

RF Exposure Information

The device has been evaluated to meet general RF exposure requirement. The device can be used in portable exposure condition without restriction.

FCC-ID: 2BMEY-CEB10WR
CAUTION: Risk of Fire and Burns.
Do Not Open, Crush, Heat Above 60°C or incinerate.
Follow Manufacturer's instructions.

