

# 说明书-英文-V2

封面

User Manual



## Preface

Dear NarTick users, to quickly understand the product, please read this instruction manual carefully before use and keep it properly.

## Packing List

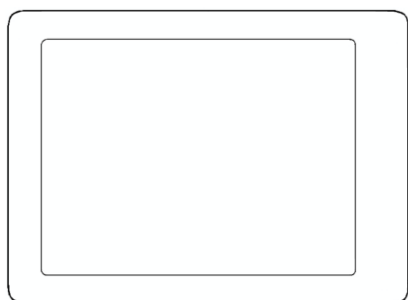

NarTick

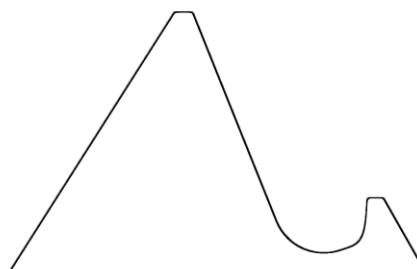

Holder

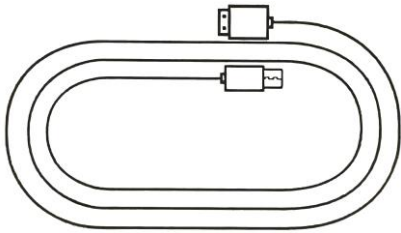
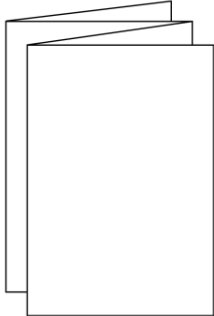
x 1	x 1
 <p>Data Cable</p> <p>x 1</p>	 <p>Manual</p> <p>x 1</p>

## Using Instructions

### 1. Power on

Long press the button on the right side, to power on the device.

#### Notes

1. If you want to shut down, please long press the button.
2. After shutting down, the screen will still display content, but it does not consume power, which is a characteristic of eink screens.

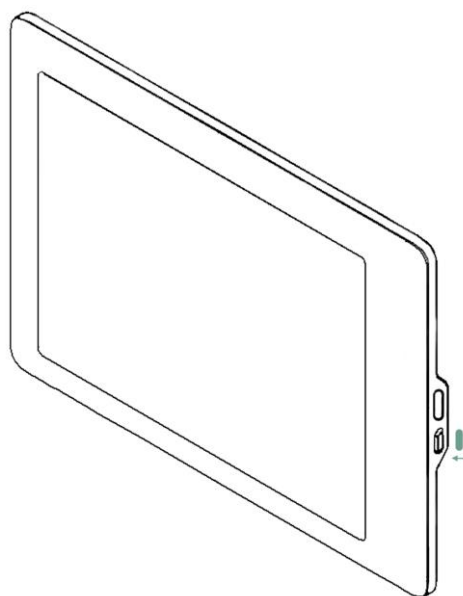

### 2. Connect Network

1. Click the [Settings] icon on the lower left corner, then click [Network].
2. Click [Scan], then click the WiFi you want to connect to, enter the WiFi password, and click [Connect].
3. After the connection is successful, you can log in to your account.

## Notes

1. If you want to connect hidden WiFi, please click [Join others] and enter the WiFi name and password.
2. Currently we only support 2.4G WiFi, if the WiFi is 5G, please turn on WiFi compatibility mode, and give 2.4G WiFi a different name.

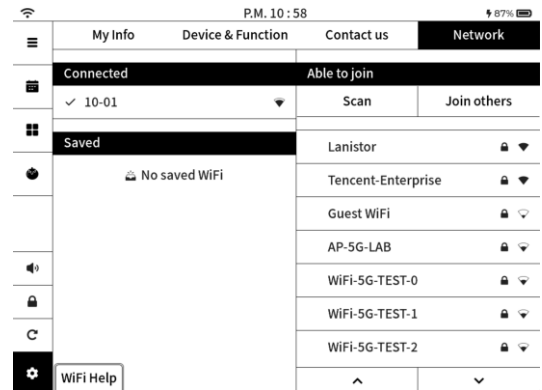

## 3. Download APP

1. Scan the QR code to download the [NarTick APP].
2. Sign up with a phone number or email.
3. Click [Mine] - [Scan]. This will be needed in the next step.



Download NarTick APP

## 4. Log In

1. Click [My Info] on NarTick E-Calendar, then click [Login].
2. Use the NarTick APP to scan the QR code on the screen and click [Confirm Login].
3. The login status will be automatically synchronized on the device; if it is not synchronized, click [Have logged].

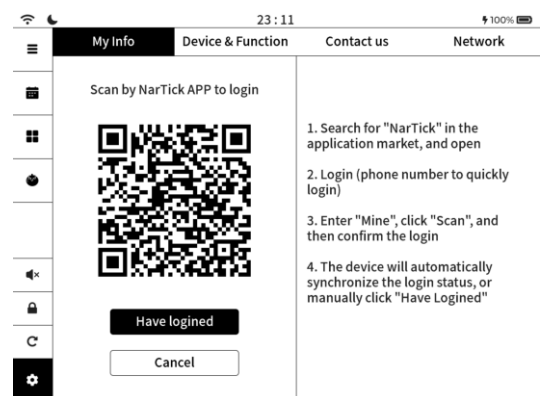

4. After successful, the current page will display your account information.

## 5. Experience Features

After successful login, the schedule data in NarTick APP will be automatically synchronized to the device.

1. Switch to [List] in the mobile APP, then click [+] in the lower right corner to create a task, and add a time for the task. You will be reminded at the preset time.
2. Click the first navigation in the top-left corner of E-Calendar, and your data will be synchronized to the device.
3. When the preset time of the task item arrives, NarTick will play sound to remind you.

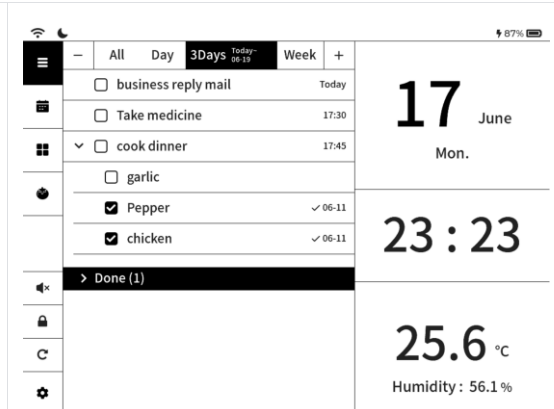

## Notice for use

1. You can subscribe Google, Apple, and Outlook calendars, and NarTick will automatically synchronize schedules and remind you.
2. NarTick supports sharing tasks with others. You can create tasks for your family remotely, and then E-Calendar will remind your family.
3. E-Calendar will synchronize data from the server every 15 minutes; when you need to refresh immediately, click the [Refresh] icon in the lower left corner.
4. There will be refresh afterimages on the e-ink screen. You can click the [refresh] icon clear the afterimages.
5. The device will turn on the Dont-disturb mode by default at night, then notifications will be mute, and the frequency of data synchronization will be reduced. Your can change Dont-disturb mode time.

## Device parameters

Product Name	NarTick (With Full Name "NarTick E-Calendar")
Dimensions	159mm * 116mm * 10.8mm
Screen type	E-ink screen
Screen Resolution	6 inches, 1024*758 pixels, 212ppi, 122mm * 90mm
Touch Screen	Capacitive touch screen
Temperature & Humidity	High-precision temperature and humidity sensor
Battery Type	lithium battery, 3.7v, 3200mAh
Charging Adapter	DC, 5V, ≤2A, <b>No QC/PD fast charging support</b>
Charging port	Type-C Port
Wireless	2.4G/WiFi, No 5G/WiFi support
Housing Material	ABS+PC

## Customer Service

You can join the group to communicate with our team at any time for any usage issues and suggestions.

There are also online documents here, you can scan the QR code below to view the detailed tutorial.



Chat With Us



User Manual

## 尾页

Service website: [nartick.com](http://nartick.com)

Service email: [cs@nartick.com](mailto:cs@nartick.com)

Manufacturer: Beijing Muye Technology Co., Ltd.

Business Cooperation: [bs@nartick.com](mailto:bs@nartick.com)

### FCC WARNING

This device complies with part 15 of the FCC Rules. Operation is subject to the following two conditions: (1) this device may not cause harmful interference, and (2) this device must accept any interference received, including interference that may cause undesired operation.

Any changes or modifications not expressly approved by the party responsible for compliance could void the user's authority to operate the equipment.

NOTE: This equipment has been tested and found to comply with the limits for a Class B digital device, pursuant to Part 15 of the FCC Rules. These limits are designed to provide reasonable protection against harmful interference in a residential installation. This equipment generates, uses and can radiate radio frequency energy and, if not installed and used in accordance with the instructions, may cause harmful interference to radio communications.

However, there is no guarantee that interference will not occur in a particular installation. If this equipment does cause harmful interference to radio or television reception,

which can be determined by turning the equipment off and on, the user is encouraged to try to correct the interference by one or more of the following measures:

- Reorient or relocate the receiving antenna.
- Increase the separation between the equipment and receiver.
- Connect the equipment into an outlet on a circuit different from that to which the receiver is connected.
- Consult the dealer or an experienced radio/TV technician for help.

To maintain compliance with FCC's RF Exposure guidelines, This equipment should be installed and operated with minimum 20cm distance between the radiator and your body: Use only the supplied antenna.