

CONTENTS AND GETTING STARTED

Contents

- 1 Doodle Sweets Shop Vehicle
- 1 Remote Control
- 1 Driver with Accessory
- 1 Dog Passenger with Accessory
- 1 Surfboard
- 1 Table
- 4 Wipeable Color Markers
- 2 Sticker Sheets
- 1 USB-C Charging Cable

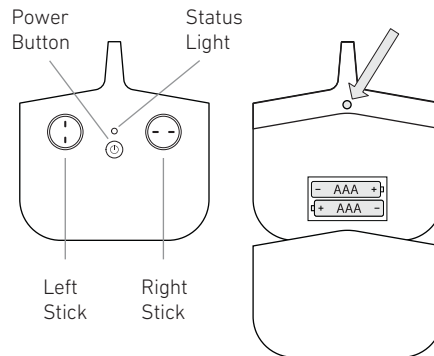

Getting Started

The remote control requires 2 AAA 1.5V batteries (not included).

Vehicle

1. Make sure the power switch on the bottom of the vehicle is in the off position.
2. Plug the USB-C end of the charging cable into the charging port on the bottom of the vehicle.
3. Plug the USB-A end of the charging cable into a powered USB-A port or a USB-A power adapter (not included). The status light will flash while the vehicle is charging and will turn off when the vehicle is fully charged.
4. Wait for the vehicle to fully charge and then unplug the charging cable.

Remote control

1. Use a tool to press and hold the battery cover release on the back of the remote control and then slide down the battery cover.
2. Insert 2 AAA 1.5V batteries (not included) into the battery compartment according to the battery diagram.
3. Slide the battery cover back into place securely.

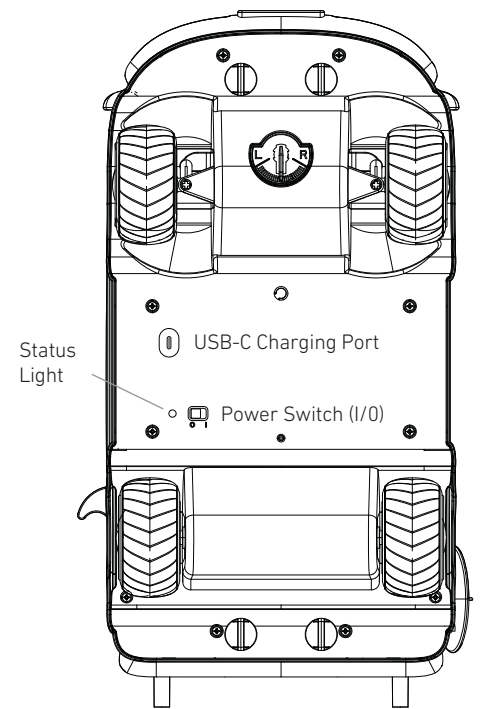

ACCESSORIES AND CUSTOM ART

ACCESSORIES

1. The surfboard goes on the van.

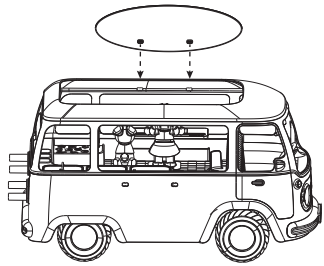

2. The side table goes on the side of the van.

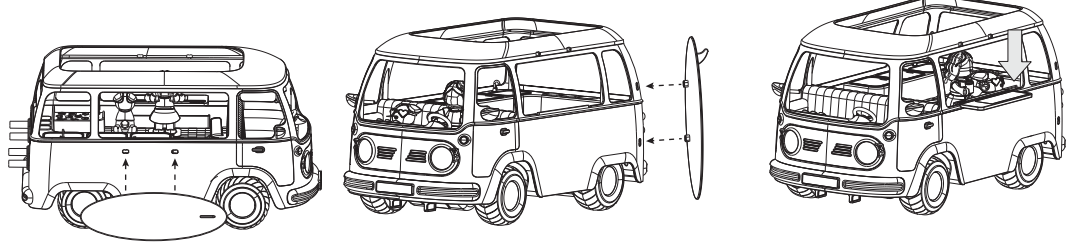

CUSTOM ART

1. Doodle on the body of the vehicle using the included wipeable color markers.

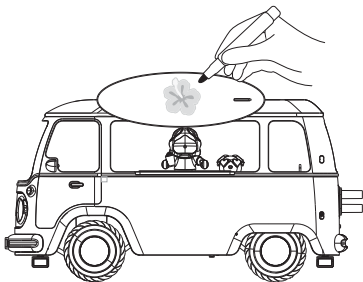

2. Store the wipeable color markers in the slots on the back of the vehicle with the caps facing outward to create fun multicolor tailpipes.

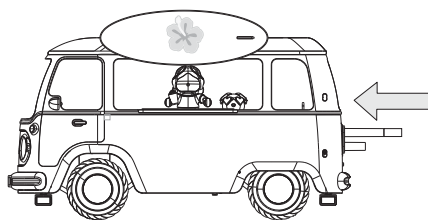

3. Wait for your doodles to dry and then finish decorating your vehicle with the included reusable stickers.

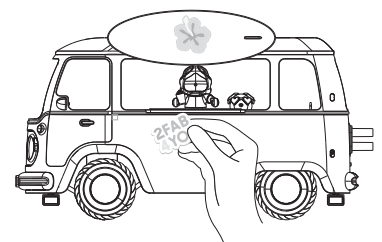

IMPORTANT:

Immediately after play, clean your doodles off the vehicle using a soft, non-abrasive cloth lightly moistened with water only. Leaving doodles on the vehicle overnight may make cleaning more difficult or may permanently stain the vehicle.

HOW TO PLAY

Power and Pairing

- 1. Make sure both the remote control and vehicle are powered off.
- 2. Press the power button on the remote control to power on the remote control. The status light will glow red, fading on and off, to indicate the remote control is in pairing mode and ready to pair with the vehicle.
- 3. Flip the switch on the bottom of the vehicle to the on position to power on the vehicle. The status light will glow, fading on and off, to indicate the vehicle is in pairing mode. The vehicle will automatically begin pairing with the remote control.
- 4. Wait for the status light on the remote control to quit fading on and off. It will stay solidly lit when pairing is successful.
- 5. If pairing is unsuccessful within 60 seconds, power off both the remote control and vehicle and then repeat steps 2 through 4.
- 6. Start driving!
- 7. If pairing is interrupted or out of range, the remote control and vehicle will both enter pairing mode and attempt to reconnect. Move the remote control and vehicle closer together. If pairing is unsuccessful within 60 seconds, power off both the remote control and vehicle and then repeat steps 2 through 4.
- 8. When finished driving, press the power button on the remote control to power off the remote control and flip the switch on the bottom of the vehicle to the off position to power off the vehicle.

Note: To save battery life, the remote control and vehicle automatically enter sleep mode after 5 minutes of inactivity. To wake from sleep mode, power off and then power on the remote control and vehicle.

Multiple Drivers

The remote control connects to the vehicle using 2.4GHz digital channel selection that allows up to 16 drivers to race side by side in the same wireless range without interference. Pair each vehicle and remote separately.

Forward or Reverse

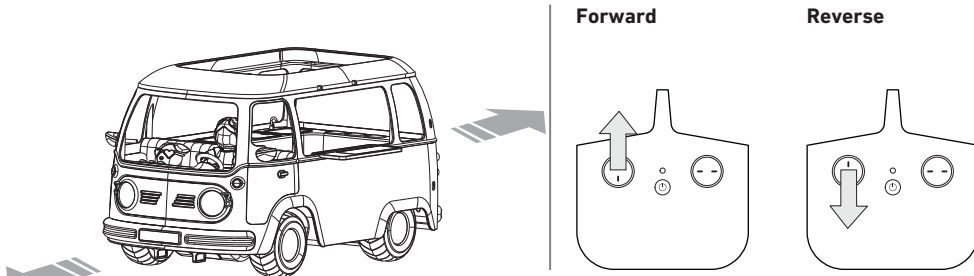

Left or Right Turn

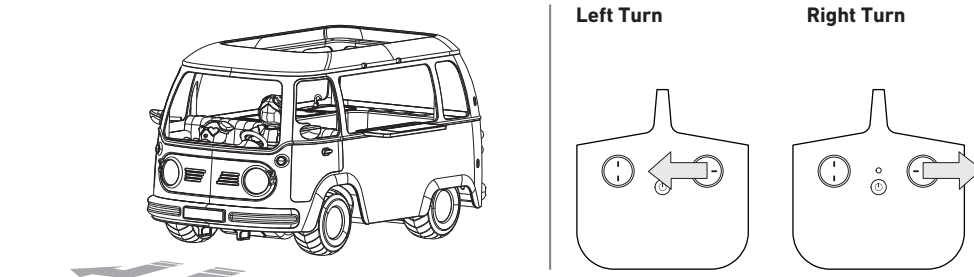

Drift Trim

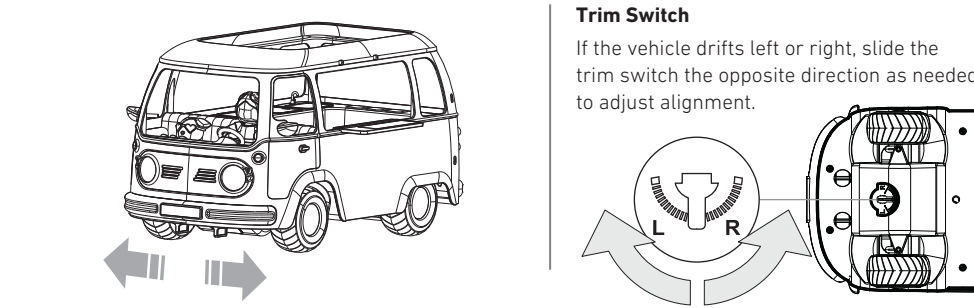

SAFETY PRECAUTIONS

- Adult supervision is recommended when operating the vehicle.
- Always drive responsibly and make sure driving paths are clear. Never drive towards or in close proximity to people or animals. Never drive on streets or roadways to avoid traffic hazards.
- Keep fingers, hair, and loose clothing away from tires and all moving parts while the vehicle is in motion.
- Avoid exposing the vehicle and remote control to water. Avoid driving through water. Never drive outdoors in rain or snow. Never leave the vehicle or remote control outdoors overnight.
- Do not expose the vehicle or remote control to extreme temperatures.
- Do not leave the vehicle or remote control near sources of heat or under direct sunlight for extended periods.
- Do not sit, step, stand, or place objects on the vehicle. It is not designed to support extra weight.
- Do not disassemble or modify the vehicle or remote control.
- Thoroughly inspect the vehicle and remote control before every use. If the vehicle or remote control appears worn, frayed, splintered, cracked, or broken in any manner, discontinue use and discard immediately.

RECHARGEABLE BATTERY WARNINGS

- This product contains batteries that are non-replaceable.
- There is a risk of fire and personal injury if battery is punctured, damaged, or misused.
- Do not dismantle, crush, incinerate or short-circuit battery.
- Never expose battery to extreme temperatures or moisture.
- Keep away from flammable materials and direct sunlight.
- Only charge using the provided charger, cable, and/or adapters.
- Rechargeable battery is only to be charged by an adult.
- Adult supervision is required while charging the battery.
- Allow battery to cool to room temperature before charging.
- Charge on a non-flammable surface and keep away from flammable products.
- Discontinue charging if battery becomes hot, swells, smokes, or gives off a strong odor.
- Battery chargers used with the product are to be regularly examined for damage to the cord, plug, enclosure, and other parts. In the event of such damage, chargers must not be used until the damage has been repaired.
- Recycle or dispose of battery according to federal, state, and local laws.
- Keep these instructions for future reference.

ALKALINE BATTERY WARNINGS

- Do not mix old and new batteries.
- Do not mix alkaline, standard (carbon-zinc), or rechargeable batteries.
- Alkaline batteries are recommended. Use only the specified voltage.
- Insert batteries using the correct polarity. Always use, replace, and recharge (if applicable) batteries under adult supervision.
- Do not attempt to charge non-rechargeable batteries.
- Do not short-circuit the battery supply terminals.
- Do not dispose of batteries in fire: batteries may explode or leak.
- Remove batteries before storing.
- Recycle or dispose of batteries according to federal, state, and local laws.
- Keep these instructions for future reference.

This device complies with Part 15 of the FCC Rules. Operation is subject to the following two conditions: (1) this device may not cause harmful interference, and (2) this device must accept any interference received, including interference that may cause undesired operation.

Note: This equipment has been tested and found to comply with the limits for a Class B digital device, pursuant to Part 15 of the FCC Rules. These limits are designed to provide reasonable protection against harmful interference in a residential installation. This equipment generates, uses and can radiate radio frequency energy and, if not installed and used in accordance with the instructions, may cause harmful interference to radio communications.

However, there is no guarantee that interference will not occur in a particular installation. If this equipment does cause harmful interference to radio or television reception, which can be determined by turning the equipment off and on, the user is encouraged to try to correct the interference by one or more of the following measures:

- Reorient or relocate the receiving antenna.
- Increase the separation between the equipment and receiver.
- Connect the equipment into an outlet on a circuit different from that to which the receiver is connected.
- Consult the dealer or an experienced radio/TV technician for help.

Conforms to ASTM D4236

Warning: Changes or modifications to this unit not expressly approved by the party responsible for compliance could void the user's authority to operate the equipment.

Sharper Image® name and logos (including the 77 logo) are trademarks or registered trademarks. Distributed by and © 2024 MerchSource, LLC. Irvine, CA 92618. All rights reserved.
Pat.: www.ms-patents.com
Model No.: 1018817

WARNING:
CHOKING HAZARD - Small Parts.
Not for Children under 3 years of age.



KEEP THIS INSTRUCTION MANUAL AS IT CONTAINS IMPORTANT INFORMATION FOR FUTURE REFERENCE.
Due to continuous product improvements, the pictures on this manual may differ slightly from the actual product.

Printed in China

FOR CUSTOMER SUPPORT,
PLEASE CALL
1-800-374-2744