

INSTRUCTIONS FOR USE



P One

SMART PIXEL MOBILE ELECTRONIC SCREEN

BASIC PARAMETERS

COLOR: BLACK

VOLTAGE: TYPE-C DC 5V

STABDBY TIME: \approx 10Days (Which is equivalent to one day of normal mobile phone use)

BATTERY CAPACITY

If extending the display time, increasing the brightness, or frequent high-frequency displays, may lead to reduced usage time of the phone case due to low battery, which is a normal phenomenon. Simply charge the phone for 5-10 minutes could resolve it.

QUICK OVERVIEW

P-One is a smart pixel mobile phone screen that not only provides phone protection, but also displays and switches the rich and interesting retro Mosaic images on the back of the phone case through the mobile APP.



To experience the charm of POne, please follow the steps below for setup. You can also scan the QR code to view the introductory video.



PICBUTTON User Manual

- In the power-off state, press and hold for 2 seconds to power on, then you can scan, Click to view the Bluetooth device code and connect to the corresponding name.
- In the power-on state, press and hold for 2 seconds to enter rhythm mode. In rhythm mode, press and hold for 2 seconds to exit rhythm mode. In the power-on state, press and hold for 7 seconds to power off.
- In HiD mode, there are three button modes available (single click, doubleclick, triple click).

You can customize the shortcut functions for the corresponding modes.

Under normal usage conditions, the phone case can be charged while the.

This device does not use mobile phone battery power, do not worry about mobile phone battery life reduction.

The TYPE-C interface at the bottom is inserted into the mobile phone to better protect the dust of the mobile phone interface.

When installing the phone case, please pay attention to the bottom Angle of the phone (the Angle should not be too large). Insert the TYPE-C port diagonally, and then push the top of the phone to install the phone cover

Connect Device

1. Please long press for 2 seconds to scan after the device is powered on. Click to view the corresponding name of the Bluetooth device code for connection.

2. Search for PICDANCE in the APPSTORE to download. 

3. Enter the phone system setting-Bluetooth, turn on Bluetooth, open the PICDANCE APP to connect P-ONE device.

PicDance app Function Authorization and Bluetooth Connection

1. Open the Picdance app to connect to the device

2. According to your P-One device ID to Bluetooth connection

3. Please allow device pairing

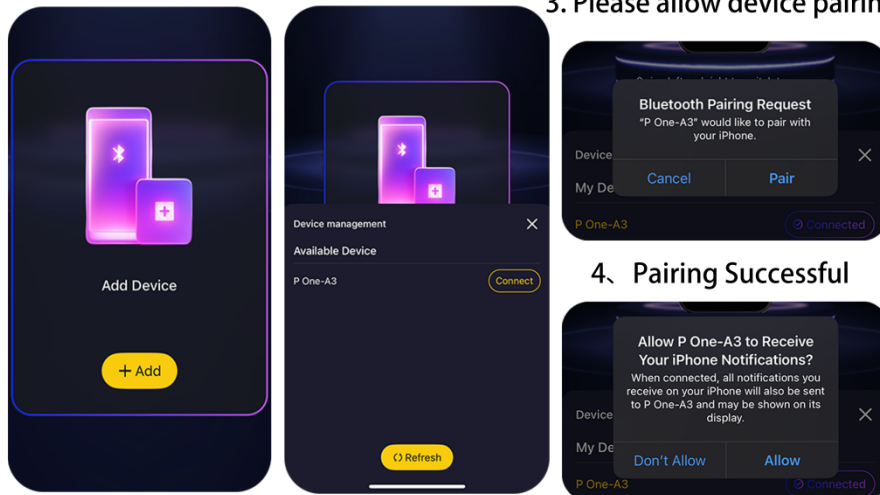

4. Pairing Successful

Once your device is successfully connected to P-One, PicDance app will allow you to edit.

The connection pairing must be authorized; otherwise, the device cannot be used.

Phone Case Image Setting

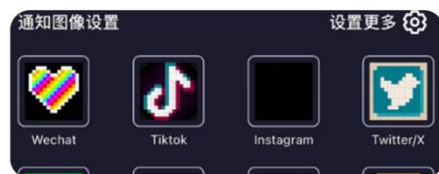
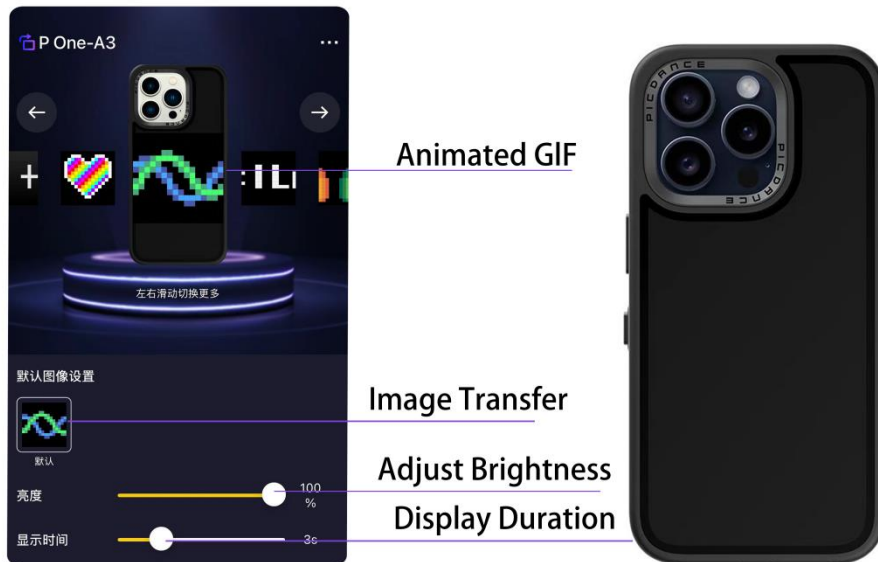

Image editing for APP Message Notifications

You can edit the notification content of the corresponding APP

FUNCTION KEY BUTTON

Create buttons manually after pairing

1. The following takes the "Click" operation as an example: Go to "Accessibility - Touch" in system Settings and open "Accessibility Touch".

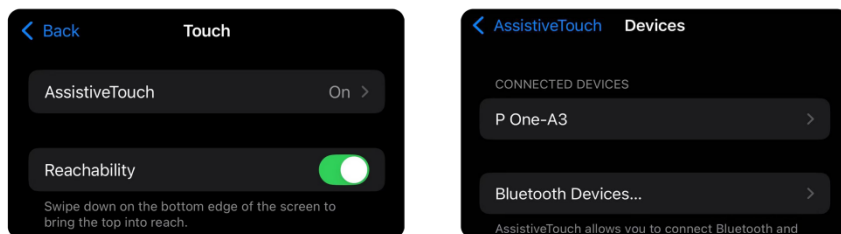

2. Then find and enter the "Device" menu, select "P-ONE Define more button", which can enter the setting state, a pop-up window will appear at this time.

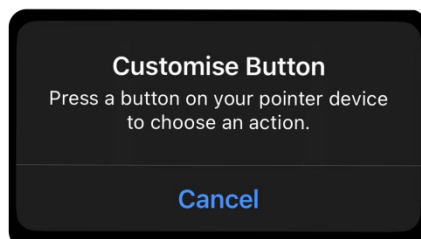

FUNCTION KEY BUTTON

3. At this point, click the Picdance Button, which creates a button for the appropriate corresponding action in IOS. If the creation is successful, a button option will be added to the menu.

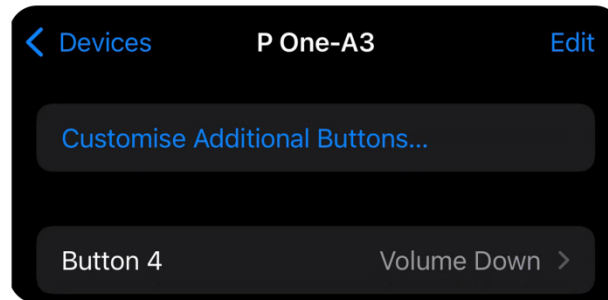

After the button is created, you can enter the menu of the corresponding button to assign system functions or shortcut commands to the button. The initial setup of P-One is complete and you can change the Settings at any time in the system Setting. The number and type of shortcut commands in this menu depend on the shortcut commands already installed in the shortcut APP.

****Button names depend on the order in which the buttons were created.**

This device complies with part 15 of the FCC Rules. Operation is subject to the following two conditions: (1) this device may not cause harmful interference, and (2) this device must accept any interference received including interference that may cause undesired operation.

Any changes or modifications not expressly approved by the party responsible for compliance could void the user's authority to operate the equipment.

NOTE: This equipment has been tested and found to comply with the limits for a Class B digital device, pursuant to Part 15 of the FCC Rules. These limits are designed to provide reasonable protection against harmful interference in a residential installation. This equipment generates, uses and can radiate radio frequency energy and, if not installed and used in accordance with the instructions, may cause harmful interference to radio communications. However, there is no guarantee that interference will not occur in a particular installation. If this equipment does cause harmful interference to radio or television reception,

which can be determined by turning the equipment off and on, the user is encouraged to try to correct the interference by one or more of the following measures:

- Reorient or relocate the receiving antenna.
- Increase the separation between the equipment and receiver.
- Connect the equipment into an outlet on a circuit different from that to which the receiver is connected.
- Consult the dealer or an experienced radio/TV technician for help.

The device has been evaluated to meet general RF exposure requirement. The device can be used in portable exposure condition without restriction

Usage of Pic Button

Get shortcut instruction

A shortcut command allows you to complete one or more tasks using an App. You are advised to add a shortcut command to the App.

1. Open the shortcut command app in your phone (installed by default. If it has been uninstalled, you can search for "shortcut instructions" in the AppStore to download it again) .
2. Click "Shortcuts Gallery" and click any shortcut command you like.
3. Click "Add shortcut command" and your first shortcut command has been added.

How to use the “Pic Button”

Picdance Button provides two key modes: one click and double click. Each button can be registered in the iOS system Settings to set up a corresponding system function or shortcut command. For details about how to set the button, please refer to the section "Create Button for the First Time".

If you do not want to display the assistive touch menu (commonly known as “white dot”) on the screen, you can choose to turn off the “Always Show menu” in the system Settings “Accessibility” – “Assistive Touch” .
