

# Vtag-OBD

English

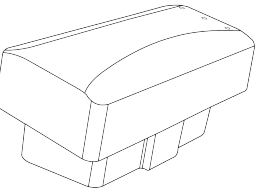

Specification	
model	Vtag-OBD
size	4.8x2.45x1.9cm
weight	13g
Battery	None
working voltage	DC 12-24V
working current	Standby current 5 uA/maximum current 50mA
wireless	BLE 6.0
Wireless transmission distance	40m(open visual distance)
buzzer	Built-in 75 db(at 10cm)
working temperature	-5°C to 45°C(23°F to 113°F)
Working humidity	95%(no condensation)

## Quick Instructions

### 1. Pair The Device

- Open Apple Find My App on mobile device.
- Hold the device close to your iPhone, tap the items tab, tap (+) and then add Other Item.

### 2. Enable Lost Mode

- Click device connection.
- Type a name for your device, select an emoji.
- Tap Agree to acknowledge that this item will be linked to your Apple ID.
- Tap Finish.

### 3. Remove The Device

- Open Apple Find My App, tap the items tab, then tap your item.
- Under Lost Mode, tap Enable.
- Read the instructions, tap Continue and enter a phone number or email address.
- Confirm the information, customise the lost message, and tap activate to complete the setup.
- Open Apple Find My App, tap the items tab, then tap your item, tap Remove item and then tap Remove to complete the operation.

Note: After removing the device from the application, the device will emit a beep sound, will not turn off, and will be in pairing mode (after opening the device or removing the device from the application). If the device is not paired within 10 minutes, it will leave pairing mode (at which point the device cannot pair with the Apple Find My app). If you need to pair the device, you will need to reinsert the OBD interface, and the device will play a beep sound. At this point, the device enters pairing mode and can be paired with the Apple Find My App again.

## FAQ

### 1. When Can The Smart Tag Be Located?

When an item is separated from its owner for a period of time, it can be found by other Apple devices (require iOS V14.5 or above) that are part of Apple Find My network, and the owner can start to get the location of the device.

### 2. How To Confirm Whether The Device Has Been Turned On?

When reloading the device, it will emit a beep sound to indicate that the device is working. If the device does not ring, it has been turned off.

### 3. How Is The Device Designed To Discourage Unwanted Tracking?

If any Find My network accessory separated from its owner is seen moving with you over time, you'll be notified in one of two ways: > If you have an iPhone, iPad, Find My App will send a notification to your Apple device. This feature is available on iOS V14.5 or above. > If you don't have an iOS device or a smartphone, a Find My network accessory that isn't with its owner for a period of time will emit a sound when it's moved. These features were created specifically to discourage people from trying to track you without your knowledge.

### 4. How Is My Privacy Protected?

Only you can see where your item is. Your location data and history are never stored on the item itself. Devices that relay the location of your item also stay anonymous, and that location data is encrypted every step of the way. So not even Apple knows the location of your device or the identity of the device that helps find it.

### 5. What Is The Find My Network? And How Does It Work?

The Apple Find My network provides an easy, secure way to locate compatible personal items on a map using Apple Find My App on your iPhone, iPad. Simply pair your compatible product with Apple Find My App to view it right alongside your Apple devices. If your item ever goes missing, you can put it in Lost Mode to display a message and contact information to anyone who might find it. The Find My network is encrypted and anonymous, so no one else, not even Apple, can view its location.

### 6. There Is no "Items" In Apple Find My App

The mobile phone system needs to be upgraded to iOS V14.5 or above, then Apple Find My App supports the items function. Please upgrade the mobile phone system version.

### 7. Product reset

Please plug and unplug the OBD port five times in a row after hearing the prompt sound. After plugging it in again, different prompt sounds will be emitted, indicating that the product has been reset and can be reconnected to the new device.

### 8. Apple Find My Device Location Isn't Updated For a Long Time

If the location update is not real-time and updates every 20 minutes. Need to have Apple device with Bluetooth turned on nearby (20 meters) to update the location (it cannot always be the same Apple device).

### 9. The Positioning Error Of The Find My Device Is Too Large

The iPhone search to Apple Find My device, then the iPhone will record the location and upload it. The location is generated by the iPhone. There will be errors in the location obtained by the phone under different environments.

### 10. There Is No Reminder For Items Left Behind On The Find My Device

Notify when left behind are notified by Apple Find My app. This function requires the item to be kept close (20 meters) to the phone for a certain period of time. When you carry the phone away from the item and need to move a far distance (move 200-300 meters), trigger iPhone far position movement condition, then this function will be triggered.

## Usage method

Plug into the OBD port in the car

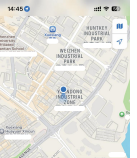
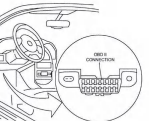

1 find items

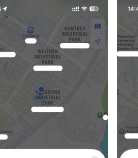

2 Add other supported items

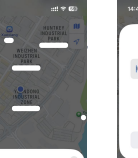

3 Search for the product or Smart Tag

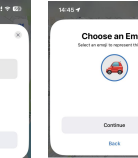

4 Connect the naming

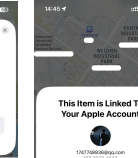

5 Select the emotions

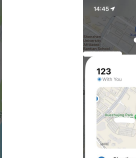

6 Agree to register

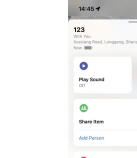

7 Complete the registration

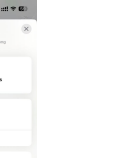

8 Find My APP the feature page

Tips: If you need are fund, please be sure to remove the equipment before returning it, to avoid your privacy leakage

## Regulatory Safety Information

Without permission, any company, firm or user shall not alter the frequency, increase the power, or change the characteristics and functions of the original design of the certified lower power frequency electric machinery.

The application of low power frequency electric machinery shall not affect the navigation safety nor interfere a legal communication, if an interference is found, the service will be suspended until improvement is made and the interference no longer exists. The foregoing legal communication refers to the wireless telecommunication operated according to the telecommunications laws and regulations. The low power frequency electric machinery should be able to tolerate the interference of the electric wave radiation electric machinery and equipment for legal communications or industrial and scientific applications.

Use of the Works with Apple badge means that a product has been designed to work specifically with the technology identified in the badge and has been certified by the product manufacturer to meet Apple Find My network product specifications and requirements. Apple is not responsible for the operation of this device or use of this product or its compliance with safety and regulatory standards.

Apple, Apple Find My, Apple Watch, Find My, iPhone, iPad, iOS, Mac, macOS and watchOS are the trademarks of Apple Inc. iOS is a trademark or registered trademark of Cisco in the U.S. and other countries and is used under license.

## FCC WARNING

This device complies with part 15 of the FCC Rules. Operation is subject to the following two conditions: (1) This device may not cause harmful interference, and (2) this device must accept any interference received, including interference that may cause undesired operation. Note: This equipment has been tested and found to comply with the limits for a Class B digital device, pursuant to part 15 of the FCC Rules. These limits are designed to provide reasonable protection against harmful interference in a residential installation. This equipment generates, uses and can radiate radio frequency energy and, if not installed and used in accordance with the instructions, may cause harmful interference to radio communications. However, there is no guarantee that interference will not occur in a particular installation. If this equipment does cause harmful interference to radio or television reception, which can be determined by turning the equipment off and on, the user is encouraged to try to correct the interference by one or more of the following measures:

- Reorient or relocate the receiving antenna.
  - Increase the separation between the equipment and receiver.
  - Connect the equipment into an outlet on a circuit different from that to which the receiver is connected.
  - Consult the dealer or an experienced radio/TV technician for help.
- Note: The Grantee is not responsible for any changes or modifications not expressly approved by the party responsible for compliance. Such modifications could void the user's authority to operate the equipment.
- The device has been evaluated to meet general RF exposure requirements. To maintain compliance with FCC's RF exposure guidelines, the distance must be at least 20 cm between the radiator and your body, and fully supported by the operating and installation configurations of the transmitter and its antenna(s).