



 **HELIOQ**

User Manual

Getting Started with Your Helioq NodeX Computing Server

Table of contents

User Manual	1
Inside the Box	3
Hardware Solution	3
Device Introduction	4
Device Status Indicators	6
Add device to start	9
● Install mobile App	9
● Bluetooth Connection	9
● Wired Network Connection	9
● Wireless Network Connection	10
● Add Device	10
FCC Statement	11

Inside the Box

- Helioq NodeX device
- Power adapter
- Network cable (for wired connection)

Hardware Solution

Main control	QCS8250 special module
Memory	12GB LPDDR5 + 256GB UFS 3.1
Wireless	WIFI6 2T2R + BT5.2
Encryption	CIU98_B
Network port	1000M GE LAN
USB	USB3.0
System	Android 10

Device Introduction

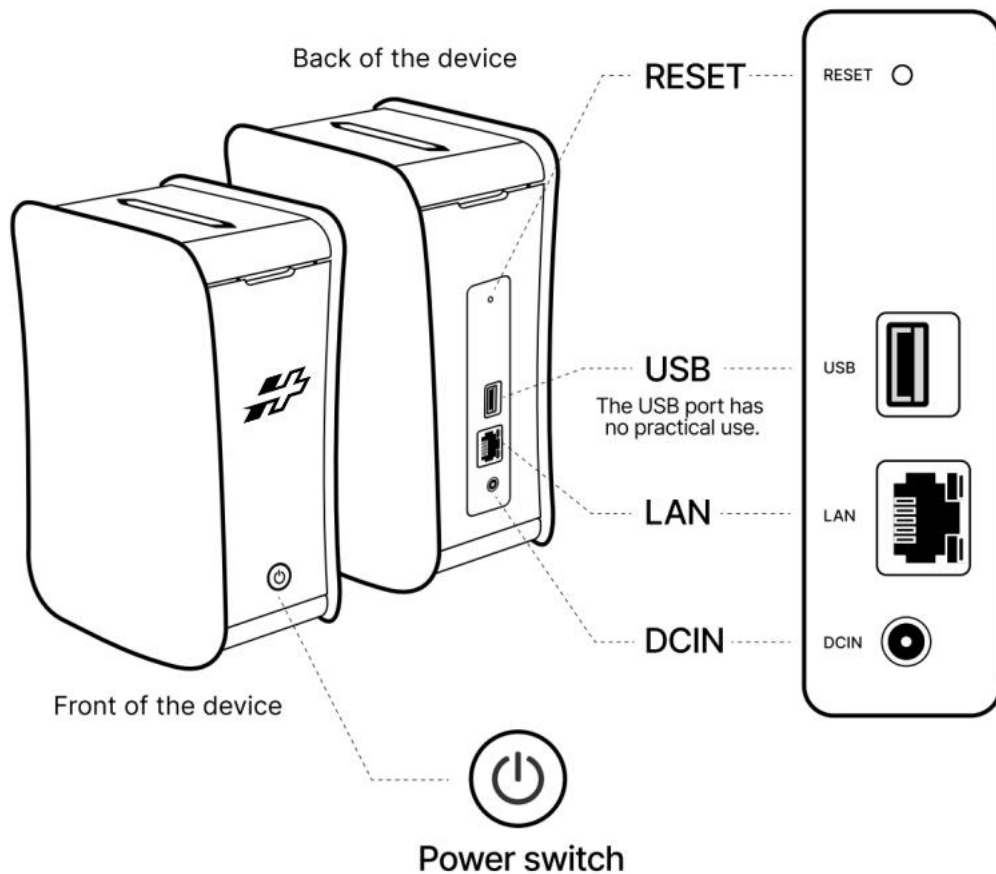

We reserve the right to modify the product design. The product you purchased may have improvements not reflected in the manual, without prior notice. Please refer to the actual product. However, its performance and usage will remain unchanged. Rest assured in its use.

Power On

Connect the adapter to a power source.

It is recommended to use a wired connection, connect one end of the Ethernet cable to the device and the other to your network port.

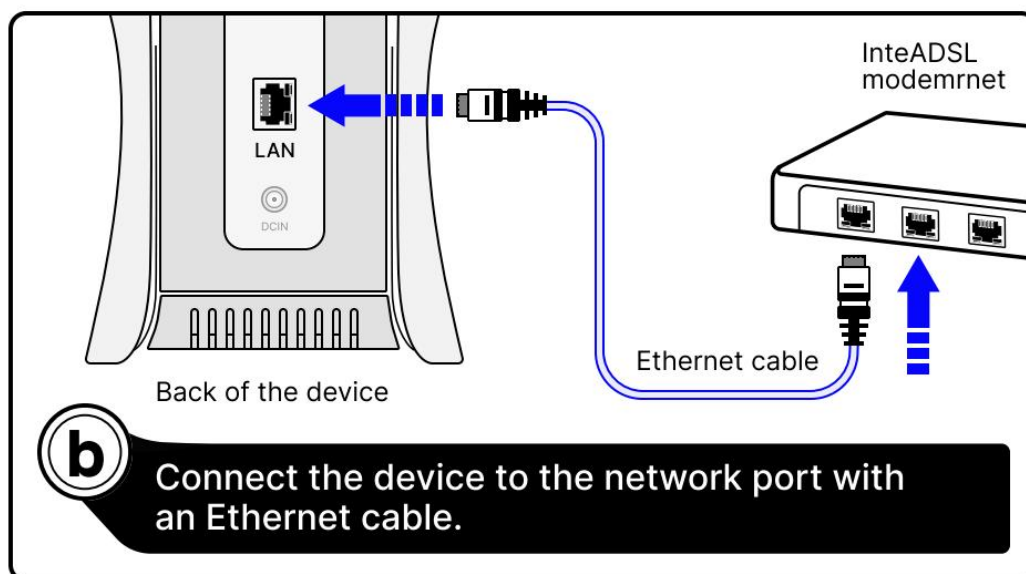
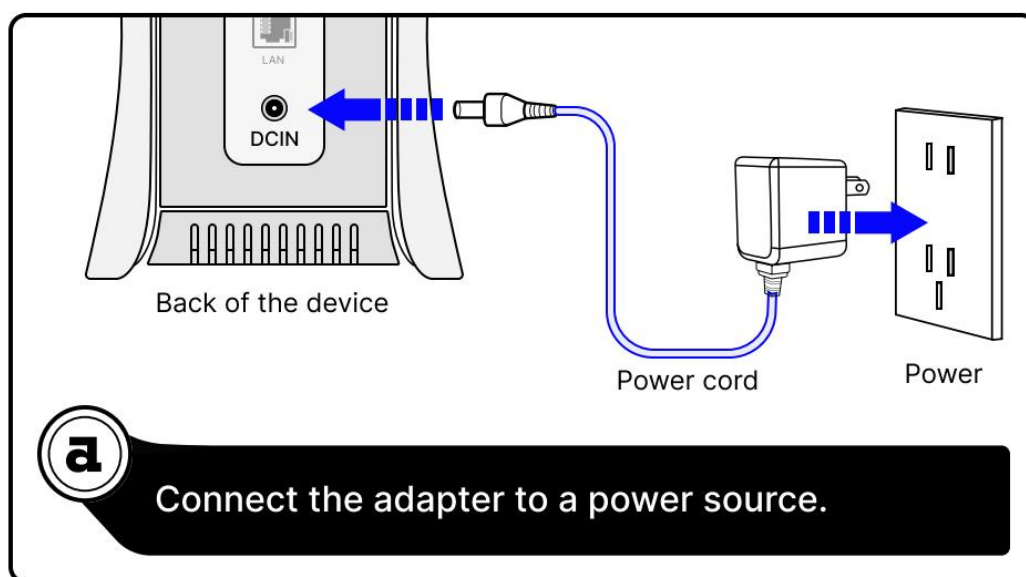

Press and hold the power button about 6s, then release. The shutdown animation will appear on the device screen, and the screen turning off indicates the device is shut down.

Device Status Indicators

The device's various statuses will be displayed on the front screen, allowing users to operate the device and understand its operating status intuitively.

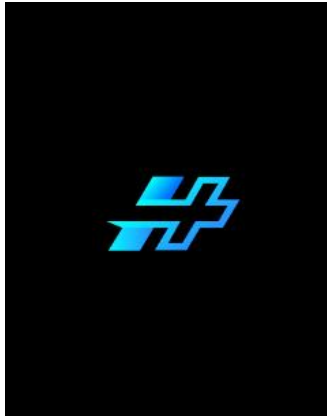

① Startup Screen

When powering on, the device displays a startup icon.



② Waiting for Network

Indicating the device is ready to connect to a network.

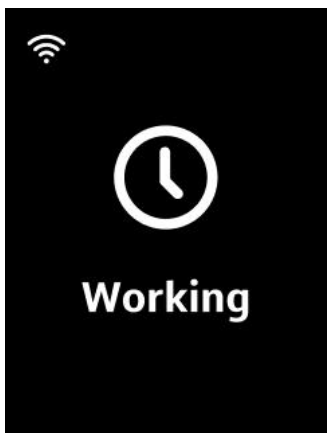

③ Working

Indicates the device is actively processing tasks.



④ Unauthorized

Indicates the device is Not in the legal area or other abnormalities.

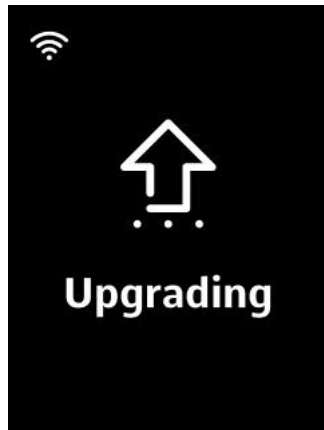

⑤ Under Maintenance

Signifies that the device is under going maintenance updates or repair.



⑥ QR Code Expired

Indicates the device is the QR Code had been expired, need re-flush

Add device to start

● Install mobile App



Search for and download the "Helioq NodePilot" mobile app and install it

● Bluetooth Connection

Enable Bluetooth on your mobile device. Pair with the Helioq NodeX device by selecting it from the available devices list.

● Wired Network Connection

To set up a wired connection, access the settings via the device screen and follow instructions to connect via DHCP or set manually if DHCP is not supported.

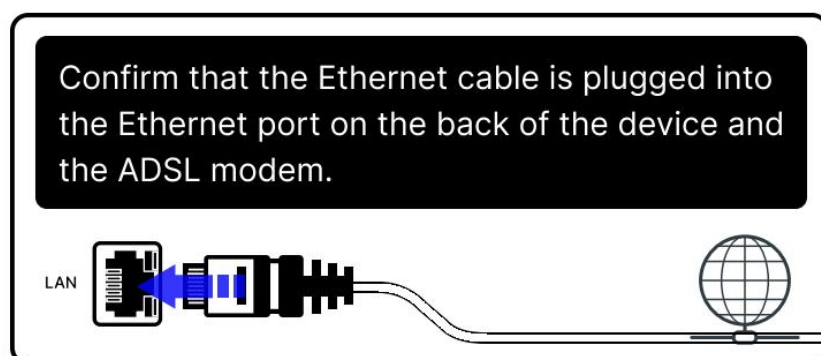
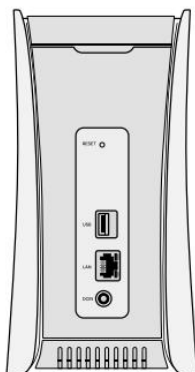

● **Wireless Network Connection**

For wireless setup, select the 'Wireless Network' option on the device screen, find your Wi-Fi network in the list, and enter the password.

In the "Helioq NodePilot" app, go to settings to manage your network configuration. You can switch between wireless and wired connections or adjust current Wi-Fi settings.

● **Add Device**

Open the "Helioq NodePilot" mobile app and navigate to the Add a new device section.

Follow the instructions and Scan the QR code on the Helioq NodeX device. Enter the verification code as prompted to bind your device.

FCC Statement

This equipment has been tested and found to comply with the limits for a Class B digital device, pursuant to part 15 of the FCC Rules. These limits are designed to provide reasonable protection against harmful interference in a residential installation. This equipment generates, uses and can radiate radio frequency energy and, if not installed and used in accordance with the instructions, may cause harmful interference to radio communications. However, there is no guarantee that interference will not occur in a particular installation. If this equipment does cause harmful interference to radio or television reception, which can be determined by turning the equipment off and on, the user is encouraged to try to correct the interference by one or more of the following measures:

- Reorient or relocate the receiving antenna.
- Increase the separation between the equipment and receiver.
- Connect the equipment into an outlet on a circuit different from that to which the receiver is connected.
- Consult the dealer or an experienced radio/TV technician for help.

Caution: Any changes or modifications to this device not explicitly approved by manufacturer could void your authority to operate this equipment.

This device complies with part 15 of the FCC Rules. Operation is subject to the following two conditions: (1) This device may not cause harmful interference, and (2) this device must accept any interference received, including interference that may cause undesired operation.

RF Exposure Information

This equipment complies with FCC radiation exposure limits set forth for an uncontrolled environment. This equipment should be installed and operated with minimum distance 20cm between the radiator and your body.